

For KCC Use: 1-13-07
 Effective Date: 3
 District # 3
 SGA? Yes No

KANSAS CORPORATION COMMISSION
 OIL & GAS CONSERVATION DIVISION
NOTICE OF INTENT TO DRILL

Form C-1
 December 2002
Form must be Typed
Form must be Signed
All blanks must be Filled

Must be approved by KCC five (5) days prior to commencing well

Expected Spud Date 1-19-07
month day year

OPERATOR: License# 32887
 Name: Endeavor Energy Resources, LP
 Address: PO Box 40
Delaware, OK 74027
 Contact Person: Joe Driskill
 Phone: 918-467-3111

CONTRACTOR: License# 33072
 Name: Well Refined Drilling

Well Drilled For:	Well Class:	Type Equipment:
<input type="checkbox"/> Oil	<input type="checkbox"/> Enh Rec	<input checked="" type="checkbox"/> Infield
<input checked="" type="checkbox"/> Gas	<input type="checkbox"/> Storage	<input type="checkbox"/> Pool Ext.
<input type="checkbox"/> OWWO	<input type="checkbox"/> Disposal	<input type="checkbox"/> Wildcat
<input type="checkbox"/> Seismic; # of Holes	<input type="checkbox"/> Other	<input type="checkbox"/> Mud Rotary
<input type="checkbox"/> Other		<input checked="" type="checkbox"/> Air Rotary
		<input type="checkbox"/> Cable

If OWWO: old well information as follows:
 Operator: NA
 Well Name: NA
 Original Completion Date: NA Original Total Depth: NA
 Directional, Deviated or Horizontal wellbore? Yes No
 If Yes, true vertical depth: NA
 Bottom Hole Location: NA
 KCC DKT #: NA

Spot NW SW SW Sec. 21 Twp. 34 S. R. 17
 East West
835 feet from N / S Line of Section
330 feet from E / W Line of Section
 Is SECTION Regular Irregular?

(Note: Locate well on the Section Plat on reverse side)

County: Montgomery
 Lease Name: Cooke Well #: 21-1
 Field Name: Coffeyville
 Is this a Prorated / Spaced Field? Yes No
 Target Formation(s): Weir-Pitt, Rowe, Riverton
 Nearest Lease or unit boundary: 330
 Ground Surface Elevation: 760' feet MSL
 Water well within one-quarter mile: Yes No
 Public water supply well within one mile: Yes No
 Depth to bottom of fresh water: 20
 Depth to bottom of usable water: 100-150
 Surface Pipe by Alternate: 1 2
 Length of Surface Pipe Planned to be set: 20
 Length of Conductor Pipe required: None
 Projected Total Depth: 1000'
 Formation at Total Depth: Mississippi Lime
 Water Source for Drilling Operations:
 Well Farm Pond Other _____
 DWR Permit #: _____
 (Note: Apply for Permit with DWR)
 Will Cores be taken? Yes No
 If Yes, proposed zone: _____

AFFIDAVIT

The undersigned hereby affirms that the drilling, completion and eventual plugging of this well will comply with K.S.A. 55 et. seq.

It is agreed that the following minimum requirements will be met:

1. Notify the appropriate district office **prior** to spudding of well;
2. A copy of the approved notice of intent to drill **shall be** posted on each drilling rig;
3. The minimum amount of surface pipe as specified below **shall be set** by circulating cement to the top; in all cases surface pipe **shall be set** through all unconsolidated materials plus a minimum of 20 feet into the underlying formation.
4. If the well is dry hole, an agreement between the operator and the district office on plug length and placement is necessary **prior to plugging**;
5. The appropriate district office will be notified before well is either plugged or production casing is cemented in;
6. If an ALTERNATE II COMPLETION, production pipe shall be cemented from below any usable water to surface within **120 days** of spud date. Or pursuant to Appendix "B" - Eastern Kansas surface casing order #133,891-C, which applies to the KCC District 3 area, alternate II cementing must be completed within 30 days of the spud date or the well shall be plugged. **In all cases, NOTIFY district office** prior to any cementing.

I hereby certify that the statements made herein are true and to the best of my knowledge and belief.

Date: 1-5-07 Signature of Operator or Agent: Joe Driskill Title: Operations Superintendent

For KCC Use ONLY
 API # 15 - 125-31287-0000
 Conductor pipe required None feet
 Minimum surface pipe required 20 feet per Alt. X2
 Approved by: RH 1-8-07
 This authorization expires: 7-8-07
 (This authorization void if drilling not started within 6 months of approval date.)
 Spud date: _____ Agent: _____

Remember to:

- File Drill Pit Application (form CDP-1) with Intent to Drill;
- File Completion Form ACO-1 within 120 days of spud date;
- File acreage attribution plat according to field proration orders;
- Notify appropriate district office 48 hours prior to workover or re-entry;
- Submit plugging report (CP-4) after plugging is completed;
- Obtain written approval before disposing or injecting salt water.
- If this permit has expired (See: authorized expiration date) please check the box below and return to the address below.

Well Not Drilled - Permit Expired
 Signature of Operator or Agent: _____
 Date: _____

RECEIVED
 KANSAS CORPORATION COMMISSION

Mail to: KCC - Conservation Division, 130 S. Market - Room 2078, Wichita, Kansas 67202

CONSERVATION DIVISION
 WICHITA, KS

21
34
17E

JAN 08 2007

IN ALL CASES PLOT THE INTENDED WELL ON THE PLAT BELOW

Plat of acreage attributable to a well in a prorated or spaced field

If the intended well is in a prorated or spaced field, please fully complete this side of the form. If the intended well is in a prorated or spaced field complete the plat below showing that the well will be properly located in relationship to other wells producing from the common source of supply. Please show all the wells and within 1 mile of the boundaries of the proposed acreage attribution unit for gas wells and within 1/2 mile of the boundaries of the proposed acreage attribution unit for oil wells.

API No. 15 - 125-31287-0000
Operator: Endeavor Energy Resources, LP
Lease: Cooke
Well Number: 21-1
Field: Coffeyville
Number of Acres attributable to well: 155
QTR / QTR / QTR of acreage: SW - SW

Location of Well: County: Montgomery
835 feet from N / S Line of Section
330 feet from E / W Line of Section
Sec. 21 Twp. 34 S. R. 17 East West
Is Section: Regular or Irregular
If Section is Irregular, locate well from nearest corner boundary.
Section corner used: NE NW SE SW

PLAT

*(Show location of the well and shade attributable acreage for prorated or spaced wells.)
(Show footage to the nearest lease or unit boundary line.)*

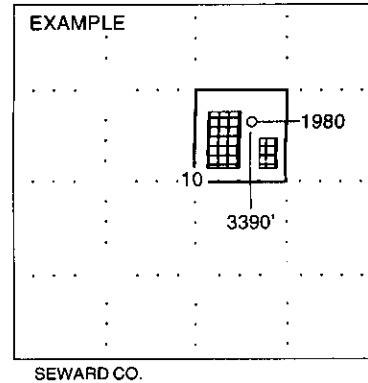
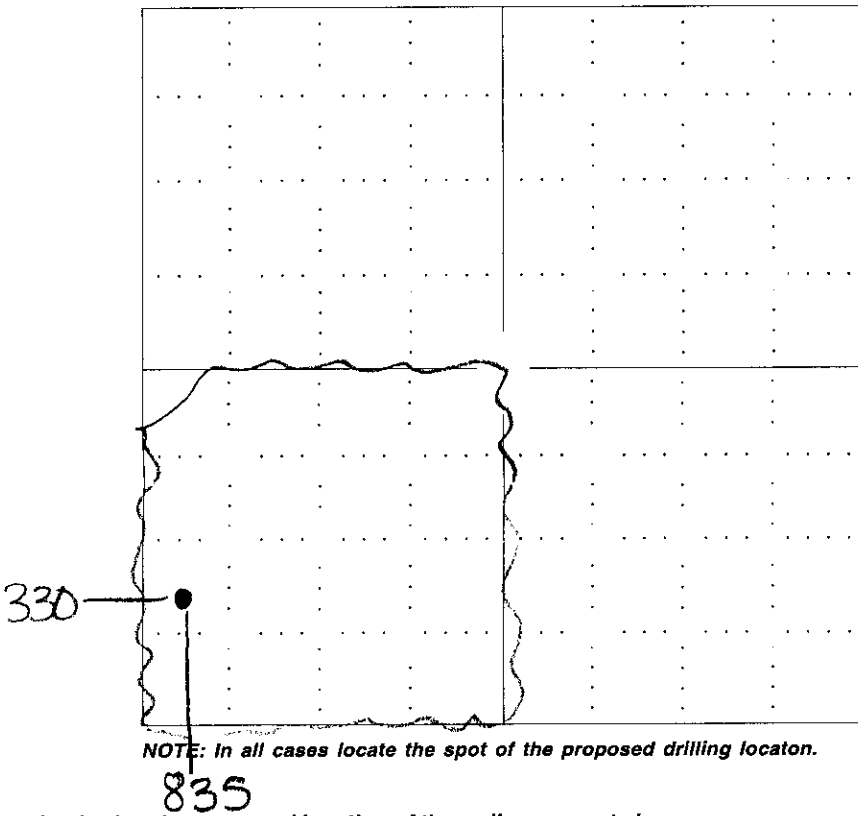

NOTE: In all cases locate the spot of the proposed drilling location.

In plotting the proposed location of the well, you must show:

1. The manner in which you are using the depicted plat by identifying section lines, i.e. 1 section, 1 section with 8 surrounding sections, 4 sections, etc.
2. The distance of the proposed drilling location from the section's south / north and east / west.
3. The distance to the nearest lease or unit boundary line.
4. If proposed location is located within a prorated or spaced field a certificate of acreage attribution plat must be attached (CG-8 for gas wells; CG-8 for oil wells).

RECEIVED
KANSAS CORPORATION COMMISSION
JAN 08 2007
CONSERVATION DIVISION
WICHITA, KS

**KANSAS CORPORATION COMMISSION
OIL & GAS CONSERVATION DIVISION
APPLICATION FOR SURFACE PIT**

Form CDP-1
April 2004
Form must be Typed

Submit in Duplicate

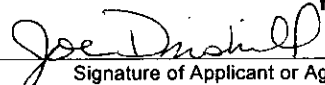
Operator Name: Endeavor Energy Resources, LP		License Number: 32887
Operator Address: PO Box 40 Delaware, OK 74027		
Contact Person: Joe Driskill		Phone Number: (918) 467 - 3111
Lease Name & Well No.: Cooke 21-1		Pit Location (QQQQ): <u> NW SW SW</u>
Type of Pit: <input type="checkbox"/> Emergency Pit <input type="checkbox"/> Burn Pit <input type="checkbox"/> Settling Pit <input checked="" type="checkbox"/> Drilling Pit <input type="checkbox"/> Workover Pit <input type="checkbox"/> Haul-Off Pit <small>(If WP Supply API No. or Year Drilled)</small>	Pit is: <input checked="" type="checkbox"/> Proposed <input type="checkbox"/> Existing If Existing, date constructed: _____ Pit capacity: _____ (bbls)	Sec. <u>21</u> Twp. <u>34</u> R. <u>17</u> <input checked="" type="checkbox"/> East <input type="checkbox"/> West <u>835</u> Feet from <input type="checkbox"/> North / <input checked="" type="checkbox"/> South Line of Section <u>330</u> Feet from <input type="checkbox"/> East / <input checked="" type="checkbox"/> West Line of Section Montgomery County
Is the pit located in a Sensitive Ground Water Area? <input type="checkbox"/> Yes <input checked="" type="checkbox"/> No		Chloride concentration: _____ mg/l <small>(For Emergency Pits and Settling Pits only)</small>
Is the bottom below ground level? <input checked="" type="checkbox"/> Yes <input type="checkbox"/> No	Artificial Liner? <input type="checkbox"/> Yes <input checked="" type="checkbox"/> No	How is the pit lined if a plastic liner is not used? natural clay / earth
Pit dimensions (all but working pits): <u>30</u> Length (feet) <u>10</u> Width (feet) _____ N/A: Steel Pits Depth from ground level to deepest point: <u>6</u> (feet)		
If the pit is lined give a brief description of the liner material, thickness and installation procedure. NA		Describe procedures for periodic maintenance and determining liner integrity, including any special monitoring. NA
Distance to nearest water well within one-mile of pit <u>NA</u> feet Depth of water well <u>unknown</u> feet		Depth to shallowest fresh water <u>unknown</u> feet. Source of information: _____ measured _____ well owner <input checked="" type="checkbox"/> electric log _____ KDWR
Emergency, Settling and Burn Pits ONLY: Producing Formation: _____ Number of producing wells on lease: _____ Barrels of fluid produced daily: _____ Does the slope from the tank battery allow all spilled fluids to flow into the pit? <input type="checkbox"/> Yes <input type="checkbox"/> No		Drilling, Workover and Haul-Off Pits ONLY: Type of material utilized in drilling/workover: <u>Air</u> Number of working pits to be utilized: <u>1</u> Abandonment procedure: <u>dewater and backfill</u> _____ Drill pits must be closed within 365 days of spud date.
I hereby certify that the above statements are true and correct to the best of my knowledge and belief.		
<u>1-5-07</u> Date	 Signature of Applicant or Agent	RECEIVED KANSAS CORPORATION COMMISSION JAN 08 2007 CONSERVATION DIVISION WICHITA, KS
KCC OFFICE USE ONLY		
Date Received: <u>1/8/07</u>	Permit Number: _____	Permit Date: <u>1/8/07</u> Lease Inspection: <input type="checkbox"/> Yes <input checked="" type="checkbox"/> No

15-125-31887-0222