

OWWO

For KCC Use: Effective Date: 1-14-07 District # 1 SGA? Yes No

KANSAS CORPORATION COMMISSION OIL & GAS CONSERVATION DIVISION

NOTICE OF INTENT TO DRILL

Must be approved by KCC five (5) days prior to commencing well

Form C-1 December 2002 Form must be Typed Form must be Signed All blanks must be Filled

Expected Spud Date February 11 2007 month day year

OPERATOR: License# 3959 Name: Siroky Oil Management Address: P.O. Box 464 City/State/Zip: Pratt, Kansas 67124 Contact Person: Scott Alberg Phone: 620-672-5625

CONTRACTOR: License# 33610 Name: FOSSIL DRILLING INC

Well Drilled For: Oil, Gas, OWWO, Seismic; # of Holes, Other. Well Class: Enh Rec, Storage, Disposal, Other. Type Equipment: Mud Rotary, Air Rotary, Cable.

If OWWO: old well information as follows: Operator: Devon-Leduc Oil LTD & W B Guyer Well Name: #1 AA Doerr Original Completion Date: April 4, 1953 Original Total Depth: 4200

Directional, Deviated or Horizontal wellbore? Bottom Hole Location: KCC DKT #: Plugging record NA.

Spot SE SE NE Sec. 13 Twp. 23 S. R. 16W 2970 feet from N / S Line of Section 330 feet from E / W Line of Section Is SECTION Regular Irregular?

(Note: Locate well on the Section Plat on reverse side) County: Pawnee Lease Name: Doerr Well #: 1 Field Name: Is this a Prorated / Spaced Field? Target Formation(s): Conglomerate Nearest Lease or unit boundary: 330 Ground Surface Elevation: 2035 feet MSL Water well within one-quarter mile: Public water supply well within one mile: Depth to bottom of fresh water: 200 Depth to bottom of usable water: 225 Surface Pipe by Alternate: 1 Length of Surface Pipe Planned to be set: 365' already set Length of Conductor Pipe required: None Projected Total Depth: 4200 Formation at Total Depth: Arbuckle Water Source for Drilling Operations: Well Farm Pond Other DWR Permit #: Contractor to apply for

AFFIDAVIT

The undersigned hereby affirms that the drilling, completion and eventual plugging of this well will comply with K.S.A. 55 et. seq. It is agreed that the following minimum requirements will be met: 1. Notify the appropriate district office prior to spudding of well; 2. A copy of the approved notice of intent to drill shall be posted on each drilling rig; 3. The minimum amount of surface pipe as specified below shall be set by circulating cement to the top; in all cases surface pipe shall be set through all unconsolidated materials plus a minimum of 20 feet into the underlying formation. 4. If the well is dry hole, an agreement between the operator and the district office on plug length and placement is necessary prior to plugging; 5. The appropriate district office will be notified before well is either plugged or production casing is cemented in; 6. If an ALTERNATE II COMPLETION, production pipe shall be cemented from below any usable water to surface within 120 days of spud date. Or pursuant to Appendix "B" - Eastern Kansas surface casing order #133,891-C, which applies to the KCC District 3 area, alternate II cementing must be completed within 30 days of the spud date or the well shall be plugged. In all cases, NOTIFY district office prior to any cementing. I hereby certify that the statements made herein are true and to the best of my knowledge and belief.

Date: January 5, 2007 Signature of Operator or Agent: Title: Operations Manager

For KCC Use ONLY API # 15 - 145-00036-00-01 Conductor pipe required None feet Minimum surface pipe required 365 feet per Alt. 1 Approved by: LUT 1-9-07 This authorization expires: 7-9-07 (This authorization void if drilling not started within 6 months of approval date.) Spud date: Agent:

Remember to: - File Drill Pit Application (form CDP-1) with Intent to Drill; - File Completion Form ACO-1 within 120 days of spud date; - File acreage attribution plat according to field proration orders; - Notify appropriate district office 48 hours prior to workover or re-entry; - Submit plugging report (CP-4) after plugging is completed; - Obtain written approval before disposing or injecting salt water. - If this permit has expired (See: authorized expiration date) please check the box below and return to the address below. Well Not Drilled - Permit Expired Signature of Operator or Agent: Date: RECEIVED KANSAS CORPORATION COMMISSION

Mail to: KCC - Conservation Division, 130 S. Market - Room 2078, Wichita, Kansas 67202 JAN 08 2007

CONSERVATION DIVISION WICHITA, KS

13 23 16W

IN ALL CASES PLOT THE INTENDED WELL ON THE PLAT BELOW

Plat of acreage attributable to a well in a prorated or spaced field

If the intended well is in a prorated or spaced field, please fully complete this side of the form. If the intended well is in a prorated or spaced field complete the plat below showing that the well will be properly located in relationship to other wells producing from the common source of supply. Please show all the wells and within 1 mile of the boundaries of the proposed acreage attribution unit for gas wells and within 1/2 mile of the boundaries of the proposed acreage attribution unit for oil wells.

API No. 15 - 145-00036-00-01
Operator: Siroky Oil Management
Lease: Doerr
Well Number: 1
Field: _____
Number of Acres attributable to well: _____
QTR / QTR / QTR of acreage: SE - SE - NE

Location of Well: County: Pawnee
2970 feet from N / S Line of Section
330 feet from E / W Line of Section
Sec. 13 Twp. 23 S. R. 16W East West

Is Section: Regular or Irregular

If Section is Irregular, locate well from nearest corner boundary.

Section corner used: NE NW SE SW

PLAT

*(Show location of the well and shade attributable acreage for prorated or spaced wells.)
(Show footage to the nearest lease or unit boundary line.)*

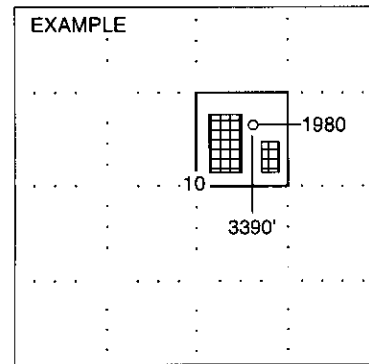
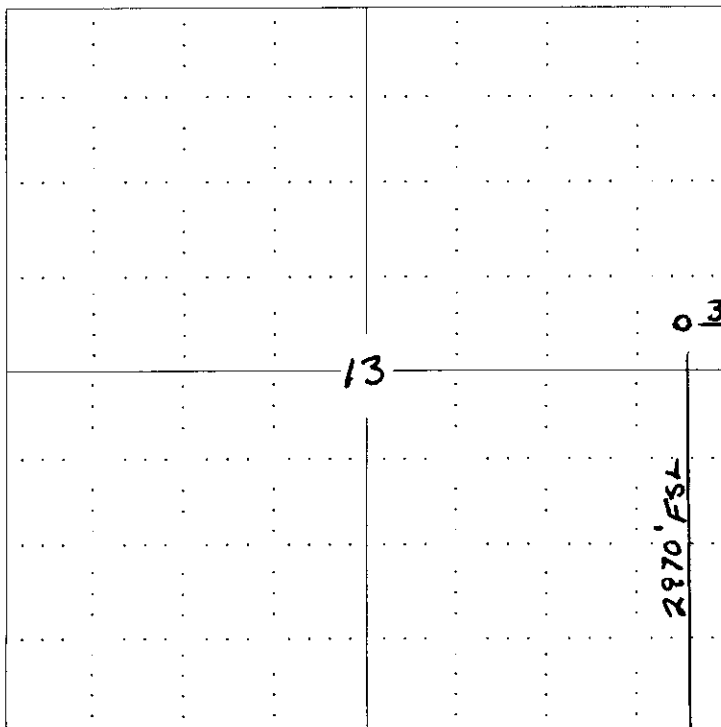

NOTE: In all cases locate the spot of the proposed drilling location.

In plotting the proposed location of the well, you must show:

1. The manner in which you are using the depicted plat by identifying section lines, i.e. 1 section, 1 section with 8 surrounding sections, 4 sections, etc.
2. The distance of the proposed drilling location from the section's south / north and east / west.
3. The distance to the nearest lease or unit boundary line.
4. If proposed location is located within a prorated or spaced field a certificate of acreage attribution plat must be attached (CG-7 for oil wells; CG-8 for gas wells).

RECEIVED
KANSAS CORPORATION COMMISSION

JAN 08 2007

CONSERVATION DIVISION
WICHITA, KS

**KANSAS CORPORATION COMMISSION
OIL & GAS CONSERVATION DIVISION
APPLICATION FOR SURFACE PIT**

Form CDP-1
April 2004
Form must be Typed

Submit in Duplicate

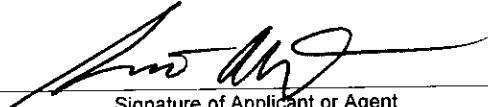
Operator Name: Siroky Oil Management		License Number: 3959
Operator Address: P.O. Box 464, Pratt, Kansas 67124		
Contact Person: Scott Alberg		Phone Number: (620) 672 - 5625
Lease Name & Well No.: Doerr #1		Pit Location (QQQQ): _____ SE _____ SE _____ NE
Type of Pit: <input type="checkbox"/> Emergency Pit <input type="checkbox"/> Burn Pit <input type="checkbox"/> Settling Pit <input checked="" type="checkbox"/> Drilling Pit <input type="checkbox"/> Workover Pit <input type="checkbox"/> Haul-Off Pit <small>(If WP Supply API No. or Year Drilled)</small>	Pit is: <input checked="" type="checkbox"/> Proposed <input type="checkbox"/> Existing If Existing, date constructed: _____ Pit capacity: 5000 _____ (bbls)	Sec. 13 Twp. 23S R. 16W <input type="checkbox"/> East <input checked="" type="checkbox"/> West 2970 Feet from <input type="checkbox"/> North / <input checked="" type="checkbox"/> South Line of Section 330 Feet from <input checked="" type="checkbox"/> East / <input type="checkbox"/> West Line of Section Pawnee _____ County
Is the pit located in a Sensitive Ground Water Area? <input checked="" type="checkbox"/> Yes <input type="checkbox"/> No		Chloride concentration: _____ mg/l <small>(For Emergency Pits and Settling Pits only)</small>
Is the bottom below ground level? <input checked="" type="checkbox"/> Yes <input type="checkbox"/> No	Artificial Liner? <input type="checkbox"/> Yes <input type="checkbox"/> No	How is the pit lined if a plastic liner is not used? Bentonite and Native Mud
Pit dimensions (all but working pits): _____ 80 _____ Length (feet) _____ 80 _____ Width (feet) _____ N/A: Steel Pits Depth from ground level to deepest point: 4 _____ (feet)		
If the pit is lined give a brief description of the liner material, thickness and installation procedure.		Describe procedures for periodic maintenance and determining liner integrity, including any special monitoring.
Distance to nearest water well within one-mile of pit _____ 800 _____ feet Depth of water well _____ 74 _____ feet		Depth to shallowest fresh water 31 _____ feet. Source of information: _____ measured _____ well owner _____ electric log <input checked="" type="checkbox"/> KDWR
Emergency, Settling and Burn Pits ONLY: Producing Formation: _____ Number of producing wells on lease: _____ Barrels of fluid produced daily: _____ Does the slope from the tank battery allow all spilled fluids to flow into the pit? <input type="checkbox"/> Yes <input type="checkbox"/> No		Drilling, Workover and Haul-Off Pits ONLY: Type of material utilized in drilling/workover: Fresh Water-Chemical Number of working pits to be utilized: 3 Abandonment procedure: Remove Free Fluids, Evaporate and restore to native conditions Drill pits must be closed within 365 days of spud date.
I hereby certify that the above statements are true and correct to the best of my knowledge and belief.		
_____ January 5, 2007 _____ Date		 Signature of Applicant or Agent
KCC OFFICE USE ONLY		
Date Received: 1/8/07	Permit Number: _____	Permit Date: 1/9/07 RECEIVED _____ <input type="checkbox"/> Yes <input type="checkbox"/> No KANSAS CORPORATION COMMISSION

15-145-00036-00-01

Mail to: KCC - Conservation Division, 130 S. Market - Room 2078, Wichita, Kansas **JAN 08 2007**

CONSERVATION DIVISION
WICHITA, KS

KANSAS

CORPORATION COMMISSION

KATHLEEN SEBELIUS, GOVERNOR
BRIAN J. MOLINE, CHAIR
ROBERT E. KREHBIEL, COMMISSIONER
MICHAEL C. MOFFET, COMMISSIONER

January 9, 2007

Mr. Scott Alberg
Siroky Oil Management
PO Box 464
Pratt, KS 67124

RE: Drilling Pit Application
Doerr Lease Well No. 1
NE/4 Sec. 13-23S-16W
Pawnee County, Kansas

Dear Mr. Alberg:

District staff has inspected the above referenced location and has determined that the reserve pit shall be constructed **without slots**, the bottom shall be flat and reasonably level, and the free fluids must be removed. The fluids are to be removed from the reserve pit as soon as practical after drilling operations have ceased.

If production casing is set all completion fluids shall be removed from the working pits daily. NO completion fluids or non-exempt wastes shall be placed in the reserve pit.

The fluids should be taken to an authorized disposal well. Please call the District Office at (620) 225-8888 when the fluids have been removed. Please file form CDP-5 (August 2004), Exploration and Production Waste Transfer, within 30 days of fluid removal. Conservation division forms are available through our office and on the KCC web site: www.kcc.state.ks.us/conservation/forms.

A copy of this letter should be posted in the doghouse along with the approved Intent to Drill. If you have any questions or concerns please feel free to contact the undersigned at the above address.

Sincerely,

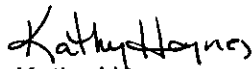
Kathy Haynes

Environmental Protection and Remediation Department

cc: File