

For KCC Use:
 Effective Date: 1-22-07
 District # 1
 SGA? Yes No

KANSAS CORPORATION COMMISSION
 OIL & GAS CONSERVATION DIVISION

Form C-1
 December 2002
 Form must be Typed
 Form must be Signed
 All blanks must be Filled

NOTICE OF INTENT TO DRILL

Must be approved by KCC five (5) days prior to commencing well

Expected Spud Date JANUARY 21, 2007
 month day year

OPERATOR: License# 5316
 Name: FALCON EXPLORATION INC.
 Address: 125 N. MARKET, SUITE 1252
 City/State/Zip: WICHITA, KS 67202
 Contact Person: RON SCHRAEDER/MIKE MITCHELL
 Phone: 316-262-1378

CONTRACTOR: License# 5822
 Name: VAL ENERGY INC.

Well Drilled For:	Well Class:	Type Equipment:
<input checked="" type="checkbox"/> Oil	<input type="checkbox"/> Enh Rec	<input checked="" type="checkbox"/> Mud Rotary
<input checked="" type="checkbox"/> Gas	<input type="checkbox"/> Storage	<input type="checkbox"/> Air Rotary
<input type="checkbox"/> OWWO	<input type="checkbox"/> Disposal	<input type="checkbox"/> Cable
<input type="checkbox"/> Seismic; # of Holes	<input checked="" type="checkbox"/> Wildcat	
<input type="checkbox"/> Other	<input type="checkbox"/> Other	

If OWWO: old well information as follows:
 Operator: _____
 Well Name: _____
 Original Completion Date: _____ Original Total Depth: _____
 Directional, Deviated or Horizontal wellbore? Yes No
 If Yes, true vertical depth: _____
 Bottom Hole Location: _____
 KCC DKT #: _____

Spot 10' W & East
160' S NE NW NE Sec. 10 Twp. 31S S. R. 22 West
490 feet from N / S Line of Section
1660 feet from E / W Line of Section
 Is SECTION Regular Irregular?

(Note: Locate well on the Section Plat on reverse side)
 County: CLARK
 Lease Name: GILES RANCH Well #: 2-10
 Field Name: W/C
 Is this a Prorated / Spaced Field? Yes No
 Target Formation(s): MORROW;MISSISSIPPIAN
 Nearest Lease or unit boundary: 490'
 Ground Surface Elevation: 2146 feet MSL
 Water well within one-quarter mile: Yes No
 Public water supply well within one mile: Yes No
 Depth to bottom of fresh water: 220' 120'
 Depth to bottom of usable water: 280' 180'
 Surface Pipe by Alternate: 1 2
 Length of Surface Pipe Planned to be set: 650'
 Length of Conductor Pipe required: NONE
 Projected Total Depth: 5500'
 Formation at Total Depth: MISSISSIPPIAN
 Water Source for Drilling Operations:
 Well Farm Pond Other _____
 DWR Permit #: 20060363
 (Note: Apply for Permit with DWR)
 Will Cores be taken? Yes No
 If Yes, proposed zone: _____

AFFIDAVIT

RECEIVED
 KANSAS CORPORATION COMMISSION

JAN 16 2007

CONSERVATION DIVISION
 WICHITA, KS

The undersigned hereby affirms that the drilling, completion and eventual plugging of this well will comply with KCC rules and regulations. It is agreed that the following minimum requirements will be met:

1. Notify the appropriate district office **prior** to spudding of well;
2. A copy of the approved notice of intent to drill **shall be** posted on each drilling rig;
3. The minimum amount of surface pipe as specified below **shall be set** by circulating cement to the top; in all cases surface pipe **shall be set** through all unconsolidated materials plus a minimum of 20 feet into the underlying formation.
4. If the well is dry hole, an agreement between the operator and the district office on plug length and placement is necessary **prior to plugging**;
5. The appropriate district office will be notified before well is either plugged or production casing is cemented in;
6. If an ALTERNATE II COMPLETION, production pipe shall be cemented from below any usable water to surface within **120 days** of spud date. Or pursuant to Appendix "B" - Eastern Kansas surface casing order #133,891-C, which applies to the KCC District 3 area, alternate II cementing must be completed within 30 days of the spud date or the well shall be plugged. **In all cases, NOTIFY district office** prior to any cementing.

I hereby certify that the statements made herein are true and to the best of my knowledge and belief.
 Date: 1/16/07 Signature of Operator or Agent: Ronald Schraeder Title: ENGINEER

For KCC Use ONLY
 API # 15 - 025-21398-0000
 Conductor pipe required None feet
 Minimum surface pipe required 200 feet per Alt. 1
 Approved by: Ron 1-17-07
 This authorization expires: 7-17-07
 (This authorization void if drilling not started within 6 months of approval date.)
 Spud date: _____ Agent: _____

Remember to:

- File Drill Pit Application (form CDP-1) with Intent to Drill;
- File Completion Form ACO-1 within 120 days of spud date;
- File acreage attribution plat according to field proration orders;
- Notify appropriate district office 48 hours prior to workover or re-entry;
- Submit plugging report (CP-4) after plugging is completed;
- Obtain written approval before disposing or injecting salt water.

- If this permit has expired (See: authorized expiration date) please check the box below and return to the address below.
 Well Not Drilled - Permit Expired
 Signature of Operator or Agent: _____
 Date: _____

10
31
22W

IN ALL CASES PLOT THE INTENDED WELL ON THE PLAT BELOW

Plat of acreage attributable to a well in a prorated or spaced field

If the intended well is in a prorated or spaced field, please fully complete this side of the form. If the intended well is in a prorated or spaced field complete the plat below showing that the well will be properly located in relationship to other wells producing from the common source of supply. Please show all the wells and within 1 mile of the boundaries of the proposed acreage attribution unit for gas wells and within 1/2 mile of the boundaries of the proposed acreage attribution unit for oil wells.

API No. 15 - 025-21398-0000
 Operator: FALCON EXPLORATION INC.
 Lease: GILES RANCH
 Well Number: 2-10
 Field: W/C
 Number of Acres attributable to well: _____
 QTR / QTR / QTR of acreage: 160' S - NE - NW NE

Location of Well: County: CLARK
 490 _____ feet from N / S Line of Section
 1660 _____ feet from E / W Line of Section
 Sec. 10 Twp. 31S S. R. 22 East West
 Is Section: Regular or Irregular
If Section is Irregular, locate well from nearest corner boundary.
 Section corner used: NE NW SE SW

PLAT

*(Show location of the well and shade attributable acreage for prorated or spaced wells.)
 (Show footage to the nearest lease or unit boundary line.)*

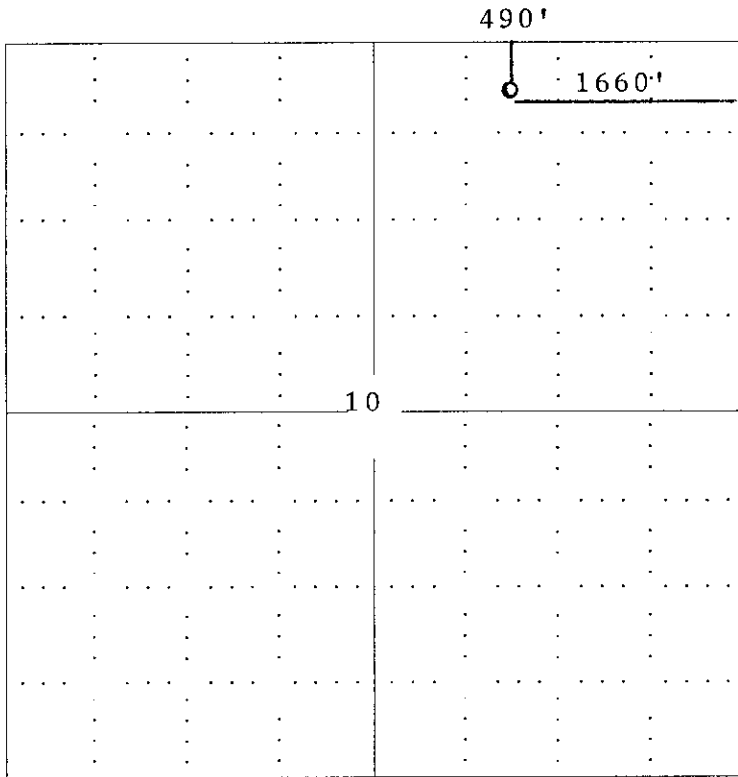

RECEIVED
KANSAS CORPORATION COMMISSION
JAN 16 2007
CONSERVATION DIVISION
WICHITA, KS

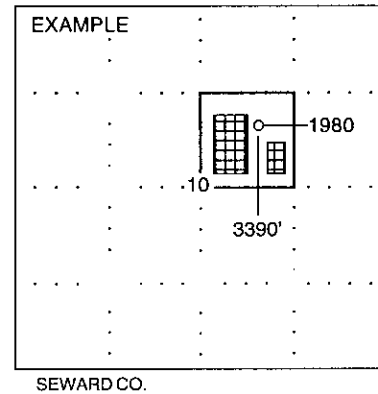

NOTE: In all cases locate the spot of the proposed drilling locaton.

In plotting the proposed location of the well, you must show:

1. The manner in which you are using the depicted plat by identifying section lines, i.e. 1 section, 1 section with 8 surrounding sections, 4 sections, etc.
2. The distance of the proposed drilling location from the section's south / north and east / west.
3. The distance to the nearest lease or unit boundary line.
4. If proposed location is located within a prorated or spaced field a certificate of acreage attribution plat must be attached: (CO-7 for oil wells; CG-8 for gas wells).

**KANSAS CORPORATION COMMISSION
OIL & GAS CONSERVATION DIVISION
APPLICATION FOR SURFACE PIT**

Form CDP-1
April 2004
Form must be Typed

Submit in Duplicate

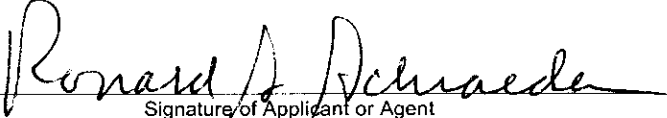
Operator Name: FALCON EXPLORATION, INC.		License Number: 5316
Operator Address: 125 N. MARKET, SUITE 1252, WICHITA, KS 67202		
Contact Person: RON SCHRAEDER		Phone Number: (316) 262 - 1378
Lease Name & Well No.: GILES RANCH #2-10		Pit Location (QQQQ): 160' S . NE . NW . NE
Type of Pit: <input type="checkbox"/> Emergency Pit <input type="checkbox"/> Burn Pit <input type="checkbox"/> Settling Pit <input checked="" type="checkbox"/> Drilling Pit <input type="checkbox"/> Workover Pit <input type="checkbox"/> Haul-Off Pit <small>(If WP Supply API No. or Year Drilled)</small>	Pit is: <input checked="" type="checkbox"/> Proposed <input type="checkbox"/> Existing If Existing, date constructed: _____ Pit capacity: _____ (bbbls)	Sec. 10 Twp. 31S R. 22 <input type="checkbox"/> East <input checked="" type="checkbox"/> West _____ Feet from <input checked="" type="checkbox"/> North / <input type="checkbox"/> South Line of Section 1660 Feet from <input checked="" type="checkbox"/> East / <input type="checkbox"/> West Line of Section CLARK _____ County
Is the pit located in a Sensitive Ground Water Area? <input checked="" type="checkbox"/> Yes <input type="checkbox"/> No		Chloride concentration: _____ mg/l <small>(For Emergency Pits and Settling Pits only)</small>
Is the bottom below ground level? <input checked="" type="checkbox"/> Yes <input type="checkbox"/> No	Artificial Liner? <input type="checkbox"/> Yes <input checked="" type="checkbox"/> No	How is the pit lined if a plastic liner is not used? NATIVE CLAY AND MUD
Pit dimensions (all but working pits): <u>80</u> Length (feet) <u>100</u> Width (feet) N/A: Steel Pits Depth from ground level to deepest point: <u>3.5</u> (feet)		
If the pit is lined give a brief description of the liner material, thickness and installation procedure.		Describe procedures for periodic maintenance and determining liner integrity, including any special monitoring.
		RECEIVED KANSAS CORPORATION COMMISSION JAN 16 2007 CONSERVATION DIVISION WICHITA, KS
Distance to nearest water well within one-mile of pit <u>APX 825'</u> feet Depth of water well <u>46</u> feet		Depth to shallowest fresh water <u>15 (KGS)</u> feet. Source of information: _____ measured _____ well owner _____ electric log _____ KDWR
Emergency, Settling and Burn Pits ONLY: Producing Formation: _____ Number of producing wells on lease: _____ Barrels of fluid produced daily: _____ Does the slope from the tank battery allow all spilled fluids to flow into the pit? <input type="checkbox"/> Yes <input type="checkbox"/> No		Drilling, Workover and Haul-Off Pits ONLY: Type of material utilized in drilling/workover: <u>CHEMICAL MUD</u> Number of working pits to be utilized: <u>3</u> Abandonment procedure: <u>HAUL OFF FREE FLUIDS; ALLOW TO DRY THEN BACKFILL</u> Drill pits must be closed within 365 days of spud date.
I hereby certify that the above statements are true and correct to the best of my knowledge and belief.		
<u>1/16/07</u> Date	 Signature of Applicant or Agent	

15-025-21398-0000

KCC OFFICE USE ONLY		RFS+K
Date Received: <u>1/16/07</u>	Permit Number: _____	Permit Date: <u>1/17/07</u> Lease Inspection: <input checked="" type="checkbox"/> Yes <input type="checkbox"/> No

Mail to: KCC - Conservation Division, 130 S. Market - Room 2078, Wichita, Kansas 67202

KANSAS

CORPORATION COMMISSION

KATHLEEN SEBELIUS, GOVERNOR
BRIAN J. MOLINE, CHAIR
ROBERT E. KREHBIEL, COMMISSIONER
MICHAEL C. MOFFET, COMMISSIONER

January 17, 2007

Mr. Ron Schraeder
Falcon Exploration, Inc.
125 N. Market Ste 1252
Wichita, KS 67202

RE: Drilling Pit Application
Giles Ranch Lease Well No. 2-10
NE/4 Sec. 10-31S-22W
Clark County, Kansas

Dear Mr. Schraeder:

District staff has inspected the above referenced location and has determined that the reserve pit shall be constructed **without slots**, the bottom shall be flat and reasonably level and the free fluids must be removed. The fluids are to be removed from the reserve pit as soon as the Hutchinson Salt section has been drilled through and displacement of the fluids into the reserve pit has occurred. The fluids should be removed again as soon as practical after drilling operations have ceased.

If production casing is set all completion fluids shall be removed from the working pits daily. NO completion fluids or non-exempt wastes shall be placed in the reserve pit.

The fluids should be taken to an authorized disposal well. Please call the District Office at (620) 225-8888 when the fluids have been removed. Please file form CDP-5 (August 2004), Exploration and Production Waste Transfer, within 30 days of fluid removal. Conservation division forms are available through our office and on the KCC web site: www.kcc.state.ks.us/conservation/forms.

A copy of this letter should be posted in the doghouse along with the approved Intent to Drill.

If you have any questions or concerns please feel free to contact the undersigned at the above address.

Sincerely,

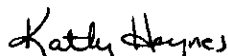

Kathy Haynes
Department of Environmental Protection and Remediation

cc: File