

STATE OF KANSAS
STATE CORPORATION COMMISSION

WELL PLUGGING RECORD

Give All Information Completely
Make Required Affidavit
Mail or Deliver Report to:
Conservation Division
State Corporation Commission
212 No. Market
Wichita, Kansas

Rooks County. Sec. 3 Twp. 9s Rge. 18 (EX) (W)
Location as "NE/CNW%SW%" or footage from lines SW NW NW
Lease Owner Petroleum, Inc.,
Lease Name Wildrix Well No. 1
Office Address R.R. #2, Great Bend, Kansas
Character of Well (completed as Oil, Gas or Dry Hole) oil
Date well completed October 24 19 66
Application for plugging filed April 11 19 68
Application for plugging approved April 12 19 68
Plugging commenced April 18 19 68
Plugging completed April 20 19 68
Reason for abandonment of well or producing formation

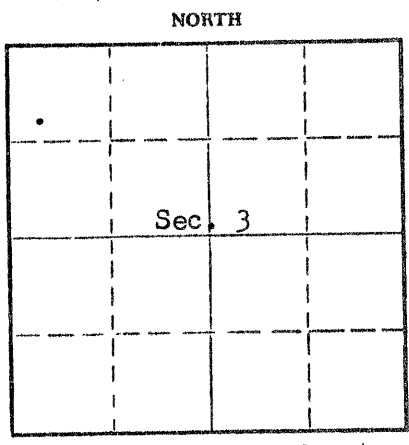

Locate well correctly on above Section Plat

If a producing well is abandoned, date of last production April 15 19 68
Was permission obtained from the Conservation Division or its agents before plugging was commenced? yes

Name of Conservation Agent who supervised plugging of this well Leo Massey
Producing formation kansas city Depth to top 3182' Bottom Total Depth of Well 3475' Feet
Show depth and thickness of all water, oil and gas formations.

OIL, GAS OR WATER RECORDS

CASING RECORD

FORMATION	CONTENT	FROM	TO	SIZE	PUT IN	PULLED OUT
kansas city	slight amount of water & oil	3220'	3226'	8-5/8"	213	none
				5-1/2"	3474'	2793'

Describe in detail the manner in which the well was plugged, indicating where the mud fluid was placed and the method or methods used in introducing it into the hole. If cement or other plugs were used, state the character of same and depth placed, from feet to feet for each plug set.

set plug @ 3218', run 5 sacks cement from 3210' to 3180'
pumped 5 sacks of hulls, 25 sacks of mud with 5 sacks of hulls and 150 sacks of cement to top of hole.

RECEIVED
STATE CORPORATION COMMISSION
APR 30 1968
CONSERVATION DIVISION
Wichita, Kansas

(If additional description is necessary, use BACK of this sheet)
Name of Plugging Contractor Glenn & Smith Pipe Pulling Company
Address Box 156, Ellinwood, Kansas

STATE OF Kansas, COUNTY OF Barton, ss.
Monte Chadd (employee of owner) or (owner or operator) of the above-described well, being first duly sworn on oath, says: That I have knowledge of the facts, statements, and matters herein contained and the log of the above-described well as filed and that the same are true and correct. So help me God. Monte Chadd, Dist. Prod. Supt.
(Signature)

R.R. #2, Great Bend, Kansas
(Address)

SUBSCRIBED AND SWORN TO before me this 26 day of April, 19 68

Richard H. Dumbler
Notary Public.

My commission expires May 28, 1969

WELL LOG

R

COMPANY **Petroleum, Incorporated**

SEC. 3 T. 9S R. 18W

FARM **Wildrix** NO. 1

LOC. **SW NW NW**

TOTAL DEPTH **3475'**

COUNTY **Rooks**

COMM. **9-24-66** COMP. **10-2-66**

CONTRACTOR **Garvey Drilling Company**

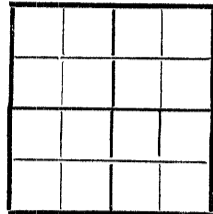

CASING **8 5/8" @ 213' w/165 sx**

5 1/2" @ 3474' w/140 sx

ELEVATION **2002' K.B.**

PRODUCTION **Arbuckle**

FIGURES INDICATE BOTTOM OF FORMATIONS

- 40' Clay and Post Rock
- 110' Sand
- 213' Shale
- 915' Shale and Shells
- 1050' Shale and Sand
- 1386' Shale
- 1422' Anhydrite
- 1535' Red Bed
- 1800' Shale and Shells
- 2010' Shale and Lime
- 3065' Lime and Shale
- 3125' Shale and Lime
- 3191' Lime and Shale
- 3235' Lime
- 3274' Lime and Shale
- 3320' Lime
- 3360' Lime and Shale
- 3440' Lime
- 3455' Arbuckle
- 3475' Arbuckle Lime
- 3475' RTD

RECEIVED
STATE CORPORATION COMMISSION
APR 30 1968
CONSERVATION DIVISION
Wichita, Kansas

State of Kansas }
County of Barton } SS

I, Sam N. Stephens of Garvey Drilling Company

upon oath state the above and foregoing is a true and correct copy of the log of the Wildrix No. 1 well.

Sam N. Stephens

Subscribed and sworn to before me this 12th day of October 19 66

My Commission Expires: November 5, 1969

Richard A. Boy
NOTARY PUBLIC