

STATE OF KANSAS  
STATE CORPORATION COMMISSION  
CONSERVATION DIVISION  
200 Colorado Derby Building  
Wichita, Kansas 67202

FORM CP-1  
Rev. 03/92

**WELL PLUGGING APPLICATION FORM**  
(PLEASE TYPE FORM and File ONE Copy)

API # 15-163-21,025-00-00 (Identifier number of this well). This must be listed for wells drilled since 1967; if no API# was issued, indicate spud or completion date.

WELL OPERATOR GRAHAM-MICHAELIS CORPORATION KCC LICENSE # 5134 6/97  
(owner/company name) (operator's)

ADDRESS 211 North Broadway CITY Wichita

STATE Kansas ZIP CODE 67202 CONTACT PHONE # (316) 264-8394

LEASE HRABE WELL# 6-26 SEC. 26 T. 8S R. 17W (East West)

-SE - SE - NW SPOT LOCATION/QQQQ COUNTY Rooks

2970 FEET (in exact footage) FROM S/N (circle one) LINE OF SECTION (NOT Lease Line)

2970 FEET (in exact footage) FROM E/W (circle one) LINE OF SECTION (NOT Lease Line)

Check One: OIL WELL  GAS WELL  D&A  SWD/ENHR WELL  DOCKET# \_\_\_\_\_

CONDUCTOR CASING SIZE \_\_\_\_\_ SET AT \_\_\_\_\_ CEMENTED WITH \_\_\_\_\_ SACKS

SURFACE CASING SIZE 8-5/8" SET AT 259' CEMENTED WITH 150 SACKS

PRODUCTION CASING SIZE 4-1/2" SET AT 3463' CEMENTED WITH 50 SACKS

LIST (ALL) PERFORATIONS and BRIDGEPLUG SETS: Bridge Plug set @ 3315', Packer set @ 3300'

ELEVATION 1992 GR/1197 KBT.D. 3465' PBTD \_\_\_\_\_ ANHYDRITE DEPTH 1283' - 1325'  
(G.L./K.B.) (Stone Corral Formation)

CONDITION OF WELL: GOOD  POOR  CASING LEAK  JUNK IN HOLE

PROPOSED METHOD OF PLUGGING Per KCC Instructions

\_\_\_\_\_  
(If additional space is needed attach separate page)

IS WELL LOG ATTACHED TO THIS APPLICATION AS REQUIRED? yes IS ACO-1 FILED? No

If not explain why? \_\_\_\_\_

PLUGGING OF THIS WELL WILL BE DONE IN ACCORDANCE WITH K.S.A. 55-101 et. seq. AND THE RULES AND REGULATIONS OF THE STATE CORPORATION COMMISSION.

LIST NAME OF COMPANY REPRESENTATIVE AUTHORIZED TO BE IN CHARGE OF PLUGGING OPERATIONS:

NORMAN-RODIE PHONE# ( ) 913-483-3136

ADDRESS P.O. Box 232 City/State Russell, KS 67665

PLUGGING CONTRACTOR Graham-Michaelis Corp. KCC LICENSE # 5134 6/97

ADDRESS P.O. Box 232, Russell, KS 67665 (company name) (contractor's)  
PHONE # ( ) 913-483-3136

PROPOSED DATE AND HOUR OF PLUGGING (if known?) As Soon As Possible

PAYMENT OF THE PLUGGING FEE (K.A.R. 82-3-118) WILL BE GUARANTEED BY OPERATOR OR AGENT

DATE: 10/3/96 AUTHORIZED OPERATOR/AGENT: Jack L. Yinger  
(signature) Vice President

4

OVER

KANSAS CORP.  
FEB 11 1997  
OCT 4 A 51

PERFORATED 2 SHOTS PER FOOT:  
Lansing B 3177' - 3182'  
Lansing G 3240' - 3244'  
Lansing I 3301' - 3305'

**KANSAS DRILLERS LOG**

S. 26 T. 8S R17 <sup>E</sup>/<sub>W</sub>

API No. 15 — 163 — 21,025-00-00  
County Number

Loc. SE SE NW

County Rooks

Operator  
Graham-Michaelis Corporation

Address  
P. O. Box 247, Wichita, Kansas 67201

Well No. 6-26 Lease Name Hrabe

Footage Location  
330 feet from (S) line 330 feet from (E) line NW 1/4

Principal Contractor Dreiling Oil, Inc. Geologist Charles Spradlin

Spud Date January 16, 1980 Total Depth 3465' P.B.T.D.

Date Completed February 11, 1980 Oil Purchaser Koch Oil Company

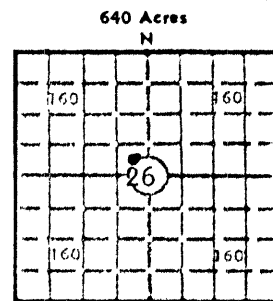

Locate well correctly  
 Elev.: Gr. 1992'  
 DF 1995' KB 1997'

**CASING RECORD**

Report of all strings set — surface, intermediate, production, etc.

Purpose of string	Size hole drilled	Size casing set (in O.D.)	Weight lbs/ft.	Setting depth	Type cement	Sacks	Type and percent additives
To protect fresh water		8 5/8'	23#	259'	common	150	3% gel; 3% cc
Production		4 1/2'		3463'	common	150	10% salt

**LINER RECORD**

**PERFORATION RECORD**

Top, ft.	Bottom, ft.	Sacks cement	Shots per ft.	Size & type	Depth interval
none					

**TUBING RECORD**

Size	Setting depth	Packer set at	
2 3/8"	3398'		2 3177-3305 overall

**ACID, FRACTURE, SHOT, CEMENT SQUEEZE RECORD**

Amount and kind of material used	Depth interval treated
12,000 gals 28% acid	overall above perms. 10-4-87

**INITIAL PRODUCTION**

Date of first production <u>February 10, 1980</u>		Producing method (flowing, pumping, gas lift, etc.) <u>Swabbing</u>			
RATE OF PRODUCTION PER 24 HOURS	Oil <u>120</u> bbls.	Gas <u>none</u> MCF	Water <u>CFPB</u> bbls.	Gas-oil ratio	
Disposition of gas (vented, used on lease or sold)			Producing interval (s) <u>2177-3305'</u>		

INSTRUCTIONS: As provided in KCC Rule 82-2-125, within 90 days after completion of a well, one completed copy of this Drillers Log shall be transmitted to the State Geological Survey of Kansas, 4150 Monroe Street, Wichita, Kansas 67209. Copies of this form are available from the Conservation Division, State Corporation Commission, 3830 So. Meridian (P.O. Box 17027), Wichita, Kansas 66217. Phone AC 316-522-2206. If confidential custody is desired, please note Rule 82-2-125. Drillers Logs will be on an open file in the Oil and Gas Division, State Geological Survey of Kansas, Lawrence, Kansas 66044.

PLEASE HOLD THIS INFORMATION CONFIDENTIAL

Operator Graham-Michaelis Corporation		DESIGNATE TYPE OF COMP.: OIL, GAS, DRY HOLE, SWDW, ETC.:
Well No. 6-26	Lease Name Hrabe	Oil
S 26 T 8S R 17 W SE SE NW, Rooks County, Kansas		

**WELL LOG**

Show all important zones of porosity and contents thereof; cored intervals, and all drill-stem tests, including depth interval tested, cushion used, time tool open, flowing and shut-in pressures, and recoveries.

SHOW GEOLOGICAL MARKERS, LOGS RUN, OR OTHER DESCRIPTIVE INFORMATION.

FORMATION DESCRIPTION, CONTENTS, ETC.	TOP	BOTTOM	NAME	DEPTH
Top Soil-Post Rock	0	80	Petrolog - Borehole Compensated Sonic Log & Radiation Guard Log	
Shale	80	785		
Sand	785	988		
Shale	988	1283		
Anhydrite	1283	1325		
Shale	1325	1727		
Shale & Lime	1727	2400		
Lime and Shale	2400	2605		
Shale	2605	2879		
Lime and Shale	2879	2930		
Lime and Arbuckle	2930	3465		
T.D.	3465'			
NO DRILL STEM TESTS RUN.				

RECEIVED  
 KANSAS GEOLOGICAL SURVEY  
 1977 OCT -4 11:52

USE ADDITIONAL SHEETS, IF NECESSARY, TO COMPLETE WELL RECORD.

Date Received	Muriel F. C. Jeram Signature Geological Secretary Title February 27, 1980 Date
---------------	---

PLEASE HOLD THIS INFORMATION CONFIDENTIAL

## GRAHAM-MICHAELIS CORPORATION

## COMPLETION REPORT

HRABE #6-26

15-163-2102S-00-00

DRILLING CONTRACTOR: Dreiling Oil, Inc.

DRILLING COMMENCED: January 16, 1980

DRILLING COMPLETED: February 11, 1980

LOCATION: SE SE NW  
Section 26-8S-17W  
Rooks County, KansasCASING RECORD: 8-5/8" set @ 259'.  
84 jts. - 51 plain, 33 coated - 4 1/2" set @ 3463'.  
109 jts. - 2-3/8" tubing, set @ 3398'

ELEVATION: GL 1992' KB: 1997'

T.D.: 3465'

January 16, 1980

Set 8-5/8" casing @ 259' and cemented with 150 sacks cement 1% gal and 3% cal. chl. Plug down @ 11:50 p.m.

January 21, 1980

Drilling at 3465'. Ran open hole log and laid down drill pipe. Ran 4 1/2" pipe, set at 3463'. Cemented with 150 sacks 10% salt and pumped 10 bbls. salt flush ahead of cement. Had good cir. throughout job. Ran 84 jts. of 4 1/2" - 51 plain and 33 coated. Plug down at 3:30 p.m.

February 2, 1980

Moved in completion unit. Swabbed down.

February 4, 1980

Ran correlation log and perforated 2 shots per foot:

Lansing "B" zone	3177' to 3182'
Lansing "G" zone	3240' to 3244'
Lansing "I" zone	3301' to 3305'

Ran tubing, bridge plug and packer. Set plug at 3315' and packer at 3300'. Acidized with 400 gal. 28% mud acid. Maximum pressure 500#, broke to zero, treated at 1/2 bbl. per min. at zero pressure. Broke down and swabbed load back up tested 1 hr. - .87 bbl., all oil.

February 5, 1980

Shut in 14 hrs., 800' of fill up, all oil. Swabbed back 3.48 bbl., all oil, and testing:

"I" zone	1st hr.	29 bbls.	all oil
	2nd hr.	29 bbls.	all oil
	3rd hr.	29 bbls.	all oil
	4th hr.	29 bbls.	all oil

Acidized with 4000 gal. 28%. Treating 1 bbl. per min. at zero pressure. Communicated with the "G" zone at 3240' to 3244' after getting out 42 bbls. of acid. Released packer and treated all zones together 6 bbls. per min. at 500#. Pulled tubing, bridge plug and packer.

February 6, 1980

Total load 154 bbls., recovered 56 bbls. Went on oil swabbing test:

RECEIVED  
KANSAS CORP. CONT.  
1980 OCT -11 AM-52

## GRAHAM-MICHAELIS CORPORATION

HRABE #6-26

COMPLETION REPORT

Page 2

February 6, 1980 (cont'd.)

1st hr.	12.18 bbls.	80% oil
2nd hr.	10.73 bbls.	75% oil
3rd hr.	9.28 bbls.	65% oil
4th hr.	8.70 bbls.	76% oil
5th hr.	7.25 bbls.	78% oil
6th hr.	7.25 bbls.	88% oil

February 7, 1980

Well shut in approximately 14 hrs. Fill up 300'. Swabbed down and acidized with 12,000 gal. 28%. Treated at zero pressure at 6.75 bbls. per min. Well on vacuum when pump shut down. Started swabbing well kicked off and flowed back 120 bbls. Shut down for the night.

February 8, 1980

Shut in approximately 14 hrs. 1400' of fill up. Swabbed down and started test. Swabbed all zones together:

1st hr.	22.12 bbls.	42% oil
2nd hrs.	23.28 bbls.	46% oil
3rd hr.	24.44 bbls.	50% oil
4th hr.	22.12 bbls.	52% oil

February 11, 1980

Ran tubing and rods and put well on pump. Ran 109 jts. of 2-3/8" tubing and 15.80 mud anchor and one 4' sub set at 3398'. Ran 136 rods, 2' sub and 4' sub and 6' gas anchor. 2 x 1 1/2 x 12' pump. 1 1/2 x 16' polish rod and 1 1/2 x 1 1/4 x 6' polish rod liner.

Materials Used in Well

109 jts. - 2-3/8" tubing  
 1 - 15.80 mud anchor  
 1 - 4' sub  
 136 - rods  
 1 - 2' sub  
 1 - 4' sub  
 1 - 6' gas anchor  
 1 - 2 x 1 1/2 x 12' pump  
 1 - 1 1/2 x 16' polish rod  
 1 - 1 1/2 x 1 1/4 x 6' polish rod liner  
 84 jts. - 4 1/2" casing  
 1 - 2" Rock-Nord plug valve  
 1 - 2" bull plug  
 1 - 2" x 6" Std. blk. pipe nipple  
 1 - 8-5/8", 8 RD male x 4 1/2" Hercules casing head with 2 - 2" side outlets  
 1 - 4 1/2 x SJ K-55 Short thread casing coupling

1987 OCT -11 A 11:52  
 RECEIVED  
 KANSAS OIL & GAS



## Kansas Corporation Commission

Bill Graves, Governor Timothy E. McKee, Chair Susan M. Seltsam, Commissioner John Wine, Commissioner  
Judith McConnell, Executive Director David J. Heinemann, General Counsel

### NOTICE OF RECEIPT OF WELL PLUGGING APPLICATION (CP-1)

October 4, 1996

Graham-Michaelis Corporation  
211 N Broadway  
Wichita KS 67202

Hrabe #6-26  
API 15-163-21,025  
2970 FSL 2970 FEL  
Sec. 26-08S-17W  
Rooks County

80-00

Dear Norman Rodie,

This letter is to notify you that the Conservation Division is in receipt of your plugging proposal, form CP-1, for the above-captioned well.

Your CP-1 has been reviewed by the Conservation Division central office for completeness and to verify license numbers. The plugging proposal will now be forwarded to the district office listed below for review of your proposed method of plugging.

Please contact the district office for approval of your proposed plugging method at least at five (5) days before plugging the well, pursuant to K.A.R. 82-3-113 (b). If a workover pit will be used during the plugging of the well it must be permitted. A CDP-1 form must be filed and approved prior to the use of the pit.

The Conservation Division's review of form CP-1, either in the central or district office, does not include an inquiry into well ownership or the filing operator's legal right to plug the well.

This notice in no way constitutes authorization to plug the above-captioned well by persons not having legal rights of ownership or interest in the well. This notice is void after ninety (90) days from the above date.

Sincerely,

David P. Williams  
Production Supervisor

District: #4  
2301 E 13th  
Hays KS 67601  
(913) 628-1200