

STATE OF KANSAS  
STATE CORPORATION COMMISSION  
CONSERVATION DIVISION  
200 Colorado Derby Building  
Wichita, Kansas 67202

FORM CP-1  
Rev. 03/92

WELL PLUGGING APPLICATION FORM  
(PLEASE TYPE FORM and File ONE Copy)

API # 15-163-20,976-00-00 (Identifier number of this well). This must be listed for wells drilled since 1967; if no API# was issued, indicate spud or completion date.

WELL OPERATOR Graham-Michaelis Corporation KCC LICENSE # 5134 6/96  
(owner/company name) (operator's)

ADDRESS P. O. Box 247 CITY Wichita  
STATE Kansas ZIP CODE 67201 CONTACT PHONE # (316) 264-8394

LEASE Hrabe "B" WELL# 4-26 SEC. 26 T. 8S R. 17 ~~XXXXX~~ (East/West)

C - SE - NW - NE SPOT LOCATION/QQQQ COUNTY Rooks

4290  
990 FEET (in exact footage) FROM S (circle one) LINE OF SECTION (NOT Lease Line)

1650  
990 FEET (in exact footage) FROM E (circle one) LINE OF SECTION (NOT Lease Line)

Check One: OIL WELL  GAS WELL  D&A  SWD/ENHR WELL  DOCKET# \_\_\_\_\_

CONDUCTOR CASING SIZE \_\_\_\_\_ SET AT \_\_\_\_\_ CEMENTED WITH \_\_\_\_\_ SACKS

SURFACE CASING SIZE 8-5/8" SET AT 256' CEMENTED WITH 165 SACKS

PRODUCTION CASING SIZE 4-1/2" SET AT 3449' CEMENTED WITH 150 SACKS

LIST (ALL) PERFORATIONS and BRIDGEPLUG SETS: 3165-68', 3229'-32', 3292'-95'

ELEVATION 1986'/1991' T.D. 3450' PBTD \_\_\_\_\_ ANHYDRITE DEPTH 1277-1316'  
(G.L./K.B.) (Stone Corral Formation)

CONDITION OF WELL: GOOD  POOR  CASING LEAK  JUNK IN HOLE

PROPOSED METHOD OF PLUGGING Per KCC Instructions

(If additional space is needed attach separate page)

IS WELL LOG ATTACHED TO THIS APPLICATION AS REQUIRED? Yes IS ACO-1 FILED? \_\_\_\_\_  
If not explain why? \_\_\_\_\_

PLUGGING OF THIS WELL WILL BE DONE IN ACCORDANCE WITH K.S.A. 55-101 et. seq. AND THE RULES AND REGULATIONS OF THE STATE CORPORATION COMMISSION.

LIST NAME OF COMPANY REPRESENTATIVE AUTHORIZED TO BE IN CHARGE OF PLUGGING OPERATIONS:

Norman Rodie PHONE# (316) 483-3136  
ADDRESS P. O. Box 232, City/State Russell, KS 67665

PLUGGING CONTRACTOR Graham-Michaelis Corp. KCC LICENSE # 5134 6/96  
(company name) (contractor's)

ADDRESS P.O. Box 232, Russell, KS PHONE # ( ) 316-483-3136

PROPOSED DATE AND HOUR OF PLUGGING (If Known?) As Soon As Possible

PAYMENT OF THE PLUGGING FEE (K.A.R. 82-3-118) WILL BE GUARANTEED BY OPERATOR OR AGENT

DATE: 7-5-96 AUTHORIZED OPERATOR/AGENT: Jack L. Yinger  
(signature) Vice President

JUL 08 1996

CONSERVATION DIVISION  
WICHITA, KS

7-8-96

✓

4

**KANSAS DRILLERS LOG**

S. 26 T. 8S R. 17W <sup>E</sup><sub>W</sub>

API No. 15 — 163 — 20,976  
County Number

Loc. C SE<sup>1</sup>/<sub>4</sub> NW<sup>1</sup>/<sub>4</sub> NE<sup>1</sup>/<sub>4</sub>

County Rooks

Operator Graham-Michaelis Corporation

Address P. O. Box 247, Wichita, Kansas 67201

Well No. 4-26 Lease Name Hrabe "B"

Footage Location 990 4290 feet from (N) (S) line 990 1650 feet from (E) (W) line SE<sup>1</sup>/<sub>4</sub> NE<sup>1</sup>/<sub>4</sub>

Principal Contractor Dreiling Oil, Inc. Geologist Richard E. Rowland

Spud Date Sept. 22, 1979 Total Depth 3450' P.B.T.D.

Date Completed Oct. 23, 1979 Oil Purchaser Koch Oil Company

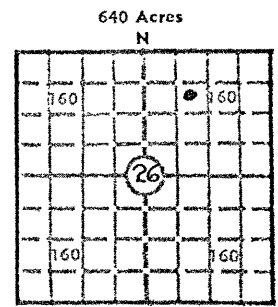

Elev.: Gr. 1986'

DF \_\_\_\_\_ KB 1991'

**CASING RECORD**

Report of all strings set— surface, intermediate, production, etc.

Purpose of string	Size hole drilled	Size casing set (in O.D.)	Weight lbs/ft.	Setting depth	Type cement	Sacks	Type and percent additives
To protect fresh wtr.	12 1/4"	8 5/8"	28#	256'	common	165	
Production		4 1/2"		3449'	common	150	

**LINER RECORD**

**PERFORATION RECORD**

Top, ft.	Bottom, ft.	Socks cement	Shots per ft.	Size & type	Depth interval
none					
<b>TUBING RECORD</b>			2		3292-95; 3229-32
Size	Setting depth	Packer set at	2		3165-68'
2 3/8"	3359.10'				

**ACID, FRACTURE, SHOT, CEMENT SQUEEZE RECORD**

Amount and kind of material used	Depth interval treated
10,000 gals 28% acid	over all

**INITIAL PRODUCTION**

Date of first production <u>October 23, 1979</u>		Producing method (flowing, pumping, gas lift, etc.) <u>swab test - 3 hours</u>	
RATE OF PRODUCTION PER 24 HOURS	Oil <u>4 bbls/hour</u> bbls.	Gas _____ MCF	Water _____ bbls. <u>Gas-Oil ratio</u>
Disposition of gas (vented, used on lease or sold)		Producing interval (s) <u>JUL 08 1980</u>	

INSTRUCTIONS: As provided in KCC Rule 82-2-125, within 90 days after completion of a well, one completed copy of this Drillers Log shall be transmitted to the State Geological Survey of Kansas, 4150 Monroe Street, Wichita, Kansas 67209. Copies of this form are available from the Conservation Division, State Corporation Commission, 3830 So. Meridian (P.O. Box 17027), Wichita, Kansas 66217. Phone AC 316-222-2205. If confidential custody is desired, please note Rule 82-2-125. Drillers Logs will be on open file in the Oil and Gas Division, State Geological Survey of Kansas, Lawrence, Kansas 66044.

PLEASE HOLD THIS INFORMATION CONFIDENTIAL

Operator Graham-Michaelis Corporation		DESIGNATE TYPE OF COMP.: OIL, GAS, DRY HOLE, SWDW, ETC.:
Well No. 4-26	Lease Name Hrabe "B"	Oil Well
S 26 T 8S R 17 <sup>-E</sup> / <sub>W</sub> SE <sup>1</sup> / <sub>4</sub> NW <sup>1</sup> / <sub>4</sub> NE <sup>1</sup> / <sub>4</sub> ; Rooks County, Kansas		

**WELL LOG**

Show all important zones of porosity and contents thereof; cored intervals, and all drill-stem tests, including depth interval tested, cushion used, time tool open, flowing and shut-in pressures, and recoveries.

SHOW GEOLOGICAL MARKERS, LOGS RUN, OR OTHER DESCRIPTIVE INFORMATION.

FORMATION DESCRIPTION, CONTENTS, ETC.	TOP	BOTTOM	NAME	DEPTH
Clay and Sand	0	100'	Ran PETRO-LOG and Borehole	Radiation Guard Compensated Soni.
Shale	100	750'		
Sand and Shale	750	1277'		
Anhydrite	1277	1316'		
Shale	1316	1955'		
Lime and Shale	1955	2663'		
Shale	2663	3128'		
Lime	3128	3450'		
T.D.	3450'			
NO DRILL STEM TESTS WERE RUN				

USE ADDITIONAL SHEETS, IF NECESSARY, TO COMPLETE WELL RECORD.

Date Received	<i>Muriel F. C. Jeram</i>
	Signature
	Geological Secretary
	Title
	October 30, 1979
	Date

PLEASE HOLD THIS INFORMATION CONFIDENTIAL



## Kansas Corporation Commission

Bill Graves, Governor Timothy E. McKee, Chair Susan M. Seltsam, Commissioner John Wine, Commissioner  
Judith McConnell, Executive Director David J. Heinemann, General Counsel

### NOTICE OF RECEIPT OF WELL PLUGGING APPLICATION (CP-1)

July 8, 1996

Graham-Michaelis Corporation  
P O Box 247  
Wichita KS 67201

Hrabe "B" #4-26  
API 15-163-20,976-06-00  
990 FNL 990 FWL  
Sec. 26-08S-17W  
Rooks County

Dear Norman Rodie,

This letter is to notify you that the Conservation Division is in receipt of your plugging proposal, form CP-1, for the above-captioned well.

Your CP-1 has been reviewed by the Conservation Division central office for completeness and to verify license numbers. The plugging proposal will now be forwarded to the district office listed below for review of your proposed method of plugging.

Please contact the district office for approval of your proposed plugging method at least at five (5) days before plugging the well, pursuant to K.A.R. 82-3-113 (b). If a workover pit will be used during the plugging of the well it must be permitted. A CDP-1 form must be filed and approved prior to the use of the pit.

The Conservation Division's review of form CP-1, either in the central or district office, does not include an inquiry into well ownership or the filing operator's legal right to plug the well.

**This notice in no way constitutes authorization to plug the above-captioned well by persons not having legal rights of ownership or interest in the well. This notice is void after ninety (90) days from the above date.**

Sincerely,

A handwritten signature in cursive script, appearing to read "David P. Williams".

David P. Williams  
Production Supervisor

District: #4  
2301 E 13th  
Hays KS 67601  
(913) 628-1200