

STATE OF KANSAS
STATE CORPORATION COMMISSION
CONSERVATION DIVISION
200 Colorado Derby Building
Wichita, Kansas 67202

FORM CP-1
Rev. 03/92

WELL PLUGGING APPLICATION FORM
(PLEASE TYPE FORM and File ONE Copy)

API # 15-163-20,670-00-00 (Identifier number of this well). This must be listed for wells drilled since 1967; if no API# was issued, indicate spud or completion date.

WELL OPERATOR Graham-Michaelis Corporation KCC LICENSE # 5134 6/96
ADDRESS P. O. Box 247 (owner/company name) CITY Wichita (operator's)

STATE Kansas ZIP CODE 67201 CONTACT PHONE # (316) 264-8394

LEASE HRABE WELL# 1-26 SEC. 26 T. 8S R. 17 (Bank) (West)

- NE - SE - NW SPOT LOCATION/0000 COUNTY Rooks

1650 FEET (in exact footage) FROM S (N) (circle one) LINE OF SECTION (NOT Lease Line)

3300 FEET (in exact footage) FROM (E) (circle one) LINE OF SECTION (NOT Lease Line)

Check Gas: OIL WELL XX GAS WELL D&A SWD/ENHR WELL DOCKET#

CONDUCTOR CASING SIZE SET AT CEMENTED WITH SACKS

SURFACE CASING SIZE 8-5/8" SET AT 253' CEMENTED WITH 160 SACKS

PRODUCTION CASING SIZE 4-1/2" SET AT 3458' CEMENTED WITH 150 SACKS

LIST (ALL) PERFORATIONS and BRIDGEPLUG SETS: 3232'-36', 3172'-3176', 3186'-3188'

ELEVATION 1989'/1994' T.D. 3460' PSTD ANHYDRITE DEPTH 1284'-1319'
(G.L./K.B.) (Stone Corral Formation)

CONDITION OF WELL: GOOD X POOR CASING LEAK JUNK IN HOLE

PROPOSED METHOD OF PLUGGING Per KCC Instructions

(If additional space is needed attach separate page)

IS WELL LOG ATTACHED TO THIS APPLICATION AS REQUIRED? Yes IS ACO-1 FILED?

If not explain why?

PLUGGING OF THIS WELL WILL BE DONE IN ACCORDANCE WITH K.S.A. 55-101 et. seq. AND THE RULES AND REGULATIONS OF THE STATE CORPORATION COMMISSION.

LIST NAME OF COMPANY REPRESENTATIVE AUTHORIZED TO BE IN CHARGE OF PLUGGING OPERATIONS:

Norman Rodie PHONE# (913) 483-3136

ADDRESS P. O. Box 232 City/State Russell, KS 67665

PLUGGING CONTRACTOR Graham-Michaelis Corp. KCC LICENSE # 5134 6/96

ADDRESS P.O. Box 232, Russell, KS (company name) PHONE # (913) 483-3136 (contractor's)

PROPOSED DATE AND HOUR OF PLUGGING (If Known?) As Soon As Possible

PAYMENT OF THE PLUGGING FEE (K.A.R. 82-3-118) WILL BE GUARANTEED BY OPERATOR OR AGENT

DATE: 7-5-96 AUTHORIZED OPERATOR/AGENT: Jack L. Yinger

Jack L. Yinger (signature)
Vice President
KANSAS CORPORATION COMMISSION
CONSERVATION DIVISION
WICHITA, KS

KANSAS DRILLERS LOG

IMPORTANT
 Kans. Geo. Survey request
 samples on this well.

S. 26 T. 8 R. 17W ^E
 Loc. NE SE NW
 County Rooks

API No. 15 — 163 — 20670
 County Number

Operator Graham-Michaelis Corp.

Address P. O. Box 247 Wichita, Kansas 67201

Well No. #1-26 Lease Name Hrabe

Footage Location 1650 feet from (N) line 2970 feet from (E) line of SW NW
330

Principal Contractor Red Tiger Drilling Company Geologist William Sladek

Spud Date July 27, 1977 Total Depth 3460' P.B.T.D.

Date Completed August 25, 1977 Oil Purchaser Koch Oil Company

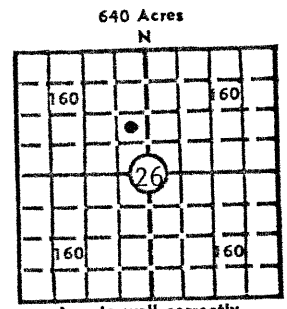

Elev.: Gr. 1989'
 DF 1991' KB 1994'

CASING RECORD

Report of all strings set — surface, intermediate, production, etc.

Purpose of string	Size hole drilled	Size casing set (in O.D.)	Weight lbs/ft.	Setting depth	Type cement	Sacks	Type and percent additives
To protect fresh water	12 1/4"	8 5/8"	23#	253'	common	160	2% gel, 3% c.c.
Production		4 1/2"	10.5 & 11.6#	3458'	Class A	150	10% salt, 2% gel 3/4 of 1% FR2

LINER RECORD

PERFORATION RECORD

Top, ft.	Bottom, ft.	Sacks cement	Shots per ft.	Size & type	Depth interval
none			4		3232-3236'
					3172-3176'
					3186-3188'

TUBING RECORD

Size	Setting depth	Packer set at
2 3/8"	3255.50'	none

ACID, FRACTURE, SHOT, CEMENT SQUEEZE RECORD

Amount and kind of material used	Depth interval treated
500 gals acid	overall

INITIAL PRODUCTION

RECEIVED
 KANSAS CORPORATION COMMISSION

Date of first production <u>August 25, 1977</u>	Producing method (flowing, pumping, gas lift, etc.) <u>Pumping</u>
RATE OF PRODUCTION PER 24 HOURS <u>65 bbls/day</u>	Gas <u>none</u> MCF
Disposition of gas (vented, used on lease or sold)	Water <u>none</u> bbls. CFPB
	Producing interval (s) <u>1996</u>

INSTRUCTIONS: As provided in KCC Rule 82-2-125, within 90 days after completion of a well, one completed copy of this Drillers Log shall be transmitted to the State Geological Survey of Kansas, 4150 Monroe Street, Wichita, Kansas 67209. Copies of this form are available from the Conservation Division, State Corporation Commission, 3830 So. Meridian (P.O. Box 17027), Wichita, Kansas 66217. Phone AC 316-522-2206. If confidential custody is desired, please note Rule 82-2-125. Drillers Logs will be on open file in the Oil and Gas Division, State Geological Survey of Kansas, Lawrence, Kansas 66044.

Operator Graham-Michaelis Corporation		DESIGNATE TYPE OF COMP.: OIL, GAS, DRY HOLE, SWDW, ETC.:
Well No. 1-26	Lease Name HRABE	Oil
S 26 T 8S R 17 NE SE NW - Rooks County, Kansas		

WELL LOG

Show all important zones of porosity and contents thereof; cored intervals, and all drill-stem tests, including depth interval tested, cushion used, time tool open, flowing and shut-in pressures, and recoveries.

SHOW GEOLOGICAL MARKERS, LOGS RUN, OR OTHER DESCRIPTIVE INFORMATION.

FORMATION DESCRIPTION, CONTENTS, ETC.	TOP	BOTTOM	NAME	DEPTH
Post Rock	0	195	Petro Log - Radiation Guard Log Borehole Compensated Sonic Log.	
Shale	195	785		
Sand	785	980		
Red Bed	980	1284		
Anhydrite	1284	1319		
Shale	1319	1790		
Shale & Lime Streaks	1790	2032		
Shale	2032	2150		
Shale & Lime	2150	2630		
Lime & Shale	2630	2761		
Shale & Lime	2761	2875		
Lime	2875	3460		
R.T.D.		3460		
<u>DRILL STEM TEST #1 - 3137-3180</u>		<u>DRILL STEM TEST #4 - 3281-3302</u>		
Open 90"		Open 60"		
Rec. 860' gassy muddy oil		Rec: 7' mud		
IFP: 31-187/30"		IFP: 20-20/30"		
FFP: 187-355/60"		FFP: 20-20/30"		
ISIP: 1186/45"		ISIP: 62#/30"		
FSIP: 1186/90"		FSIP: 41#/30"		
<u>DRILL STEM TEST #2 - 3181-3228</u>		<u>DRILL STEM TEST #5 - 3299-3370</u>		
Open 90"		Open 60"		
Rec.: 250' gassy slightly oil cut mud		Rec.: 10' mud		
IFP: 73-114/30 min.		IFP: 57-57#/30"		
FFP: 125-156/60"		FFP: 57-57#/30"		
ISIP: 1061#/45"		ISIP: 365#/30"		
FSIP: 967#/90"		FSIP: 198#/30"		
<u>DRILL STEM TEST #3 - 3230-3240</u>				
Open 90"				
Rec: 915' gas in pipe, 63' clean oil, 477' muddy gassy oil, 10' filtrate water.				
IFP: 47-94/30"				
FFP: 114-208/60"				
ISIP: 708#/45"				
FSIP: 718#/90"				

USE ADDITIONAL SHEETS, IF NECESSARY, TO COMPLETE WELL RECORD.

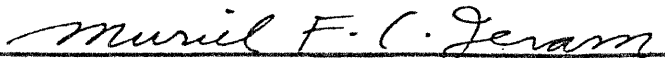
Date Received	 Signature Muriel F. C. Jeram Geological Secretary Title November 29, 1977 Date
---------------	--



Kansas Corporation Commission

Bill Graves, Governor Timothy E. McKee, Chair Susan M. Seltsam, Commissioner John Wine, Commissioner
Judith McConnell, Executive Director David J. Heinemann, General Counsel

NOTICE OF RECEIPT OF WELL PLUGGING APPLICATION (CP-1)

July 8, 1996

Graham-Michaelis Corporation
P O Box 247
Wichita KS 67201

Hrabe #1-26
API 15-163-20,670-00-00
1650 FNL 330 FEL
Sec. 26-08S-17W
Rooks County

Dear Norman Rodie,

This letter is to notify you that the Conservation Division is in receipt of your plugging proposal, form CP-1, for the above-captioned well.

Your CP-1 has been reviewed by the Conservation Division central office for completeness and to verify license numbers. The plugging proposal will now be forwarded to the district office listed below for review of your proposed method of plugging.

Please contact the district office for approval of your proposed plugging method at least at five (5) days before plugging the well, pursuant to K.A.R. 82-3-113 (b). If a workover pit will be used during the plugging of the well it must be permitted. A CDP-1 form must be filed and approved prior to the use of the pit.

The Conservation Division's review of form CP-1, either in the central or district office, does not include an inquiry into well ownership or the filing operator's legal right to plug the well.

This notice in no way constitutes authorization to plug the above-captioned well by persons not having legal rights of ownership or interest in the well. This notice is void after ninety (90) days from the above date.

Sincerely,

A handwritten signature in cursive script, appearing to read "David P. Williams".

David P. Williams
Production Supervisor

District: #4
2301 E 13th
Hays KS 67601
(913) 628-1200