

FOR KCC USE:

EFFECTIVE DATE: 2-5-07

DISTRICT # 3

SGA7...X...No

State of Kansas

CATHODIC PROTECTION BOREHOLE INTENT

Must be approved by the K.C.C. sixty (60) days prior to commencing well.

FORM CB-1 12/93

FORM MUST BE TYPED

FORM MUST BE SIGNED

ALL BLANKS MUST BE FILLED IN

Expected Spud (Starting) Date .....

OPERATOR: License # 33887 month day year

Name: Coffeyville Resources

Address: 701 East Martin Street

City/State/Zip: Coffeyville, Kansas 67337

Contact Person: Scott Ecklund

Phone: (918) 336-1221

CONTRACTOR: License # 33860

Name: SESOCO/Bills Water Drilling

Type Drilling Equipment: X Mud Rotary X Cable  
X Air Rotary X Other

CONSTRUCTION FEATURES

Length of Cathodic Surface (Non-Metallic) Casing

Planned to be set: 25 ft.

Length of Conductor pipe (if any?): ..... ft.

Size of the borehole (I.D.): 14 inches

Cathodic surface casing size: 8 inches

Cathodic surface casing centralizers set at depths of: 18;

5 ; ..... ; ..... ; ..... ; ..... ; ..... ; ..... ; ..... ; ..... ;

Cathodic surface casing will terminate at:

... Above surface ... Surface Vault X Below Surface Vault

Pitless casing adaptor will be used: ... Yes/No at Depth ....ft.

Anode installation depths are: 238'; 226'; 214'; 202';

190'; 178'; 166'; 154'; 142'; 130';

..... ; ..... ; ..... ; ..... ; ..... ; ..... ; ..... ; ..... ; ..... ;

Spot (Location) NW SE NE Sec 36.. Twp 34.. S. Rg 16.. X East  
1005' feet from South / North line of Section  
1075' feet from East / West line of Section  
(Circle directions from nearest outside corner boundaries)

IS SECTION X REGULAR IRREGULAR?

(Spot well on the Section Plat on Reverse Side)

County: Montgomery

Lease Name: Coffeyville Resources Well #: CP-4

Facility Name: Coffeyville Resources Nitrogen

Ground Surface Elevation: 750-800 Est 720 Twp

Cathodic Borehole Total Depth ..... ft.

Depth to Bedrock ..... ft.

WATER INFORMATION:

Aquifer Penetration: .... None X Single X Multiple

Depth to bottom of fresh water: 100±

Depth to bottom of usable water: 150

Water well within one-quarter mile: X Yes X No

Public water supply well within one mile: .... yes X ... no

Water Source for Drilling Operations:

.... well .... farm pond .... stream X ... other

Water Well Location: .....

DUR Permit #: ..... 26

Standard Dimension Ratio (SDR) is = ..... 26

(cathodic surface OD csg. in inches / MWT in inches = SDR)

Annular space between borehole and casing will be grouted

with: .... Concrete .... Bentonite Cement

.... Neat cement X Bentonite clay

Anode vent pipe will be set at: 3 ft. above surface

Anode conductor (backfill) material TYPE: Loresco SWS

Depth to BASE of Backfill installation material: 250 Ft.

Depth to TOP of Backfill installation material: 110 Ft.

AFFIDAVIT

The undersigned hereby affirms that the drilling, completion and eventual plugging of this well will comply with K.S.A. 55-101, et. seq. It is agreed that the following minimum requirements will be met:

1. Notify the appropriate district office prior to spudding of and again before plugging well;
2. A copy of the approved notice of intent to drill shall be posted on each drilling rig;
3. The minimum amount of cathodic surface casing as specified below shall be set by grouting to the top.
4. An agreement between the operator and the district office on plugs and placement is necessary prior to plugging;
5. The appropriate district office will be notified before well is either plugged or casing is grouted in;
6. IN ALL CASES, NOTIFY DISTRICT OFFICE PRIOR TO ANY CEMENTING.

I hereby certify that the statements made herein are true and to the best of my knowledge and belief.

Date: 01/08/07 Signature of Operator or Agent: Scott W. Ecklund Title: President

FOR KCC USE:

API # 15- 625-31299-0000

Conductor pipe required NOM feet

Minimum cathodic surface casing required 25 feet Alt 3

Approved by: Keith 1-31-07

This authorization expires: 7-31-07

(This authorization void if drilling not started within 6 months of effective date.)

Spud date: \_\_\_\_\_ Agent: \_\_\_\_\_

REMEMBER TO:

- File Drill Pit Application (form CDP-1) with Intent to Install;
- File Completion Form CB-2 within 30 days of spud date;
- Notify appropriate district office 48 hours prior to workover or re-entry;
- Submit plugging report (CB-4) within 30 days after plugging is completed.

RECEIVED

JAN 23 2007

KCC WICHITA

30-34-10E

**IN ALL CASES PLOT THE INTENDED WELL ON THE PLAT BELOW**

Show the relationship to other wells or facilities proposed to be serviced by the intended cathodic borehole. Please show all the wells, existing cathodic boreholes, pipelines or facilities within 1/2 mile of the proposed borehole.

API NO. 15- 125-31299-0000  
OPERATOR Coffeyville Resources  
LEASE \_\_\_\_\_  
WELL NUMBER CP-4  
FACILITY NAME Coffeyville Resources

LOCATION OF WELL: COUNTY Montgomery  
1805' feet from south north line of section  
1075' feet from east west line of section  
SECTION 36 TWP 34S RG 16E

SPOT: QTR/QTR/QTR/QTR OF ACREAGE  
SW - NW - SE - NE

IS SECTION \_\_\_\_\_ REGULAR or \_\_\_\_\_ IRREGULAR  
**IF SECTION IS IRREGULAR, LOCATE WELL FROM NEAREST CORNER BOUNDARY.**

Section corner used: \_\_\_\_\_ NE \_\_\_\_\_ NW \_\_\_\_\_ SE \_\_\_\_\_ SW

**PLAT**

(Show location of intended cathodic borehole.)

(Show footage from nearest lease, unit or outside section boundary line.)

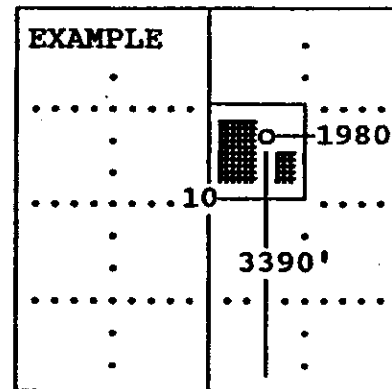
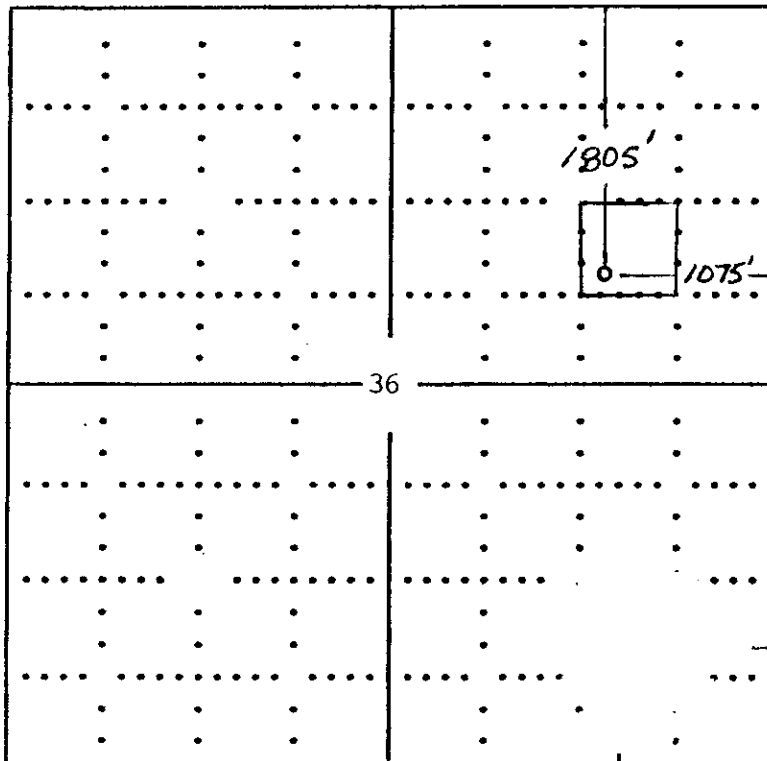

SEWARD CO.

**In plotting the proposed location of the well, you must show:**

- 1) The manner in which you are using the depicted plat by identifying section lines, i.e. 1 section, 1 section with 8 surrounding sections, 4 sections, etc.;
- 2) the distance of the proposed drilling location from the section's south/north and east/west; and
- 3) the distance to the nearest lease, unit or outside section boundary line.

RECEIVED

JAN 25 1988

KCC WICHIT/

KANSAS CORPORATION COMMISSION  
OIL & GAS CONSERVATION DIVISION  
**APPLICATION FOR SURFACE PIT**

Form CDP-1  
April 2004  
Form must be Typed

Submit in Duplicate

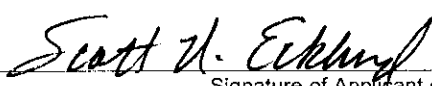
Operator Name: <b>Coffeyville Resources</b>		License Number: <b>33887</b>	
Operator Address: <b>701 East Martin St.</b>			
Contact Person: <b>Scott Ecklund</b>		Phone Number: ( <b>918</b> ) <b>336 - 1221</b>	
Lease Name & Well No.: <b>Coffeyville Resources, CP-4</b>		Pit Location (QQQQ): <b>SW - NW - SE - NE</b> Sec. <b>36</b> Twp. <b>34S</b> R. <b>16</b> <input checked="" type="checkbox"/> East <input type="checkbox"/> West <b>1805</b> Feet from <input checked="" type="checkbox"/> North / <input type="checkbox"/> South Line of Section <b>1075</b> Feet from <input checked="" type="checkbox"/> East / <input type="checkbox"/> West Line of Section <b>Montgomery</b> County	
Type of Pit: <input type="checkbox"/> Emergency Pit <input type="checkbox"/> Burn Pit <input type="checkbox"/> Settling Pit <input checked="" type="checkbox"/> Drilling Pit <input type="checkbox"/> Workover Pit <input type="checkbox"/> Haul-Off Pit (If WP Supply API No. or Year Drilled)	Pit is: <input type="checkbox"/> Proposed <input type="checkbox"/> Existing If Existing, date constructed: _____ Pit capacity: _____ (bbls)		
Is the pit located in a Sensitive Ground Water Area? <input type="checkbox"/> Yes <input checked="" type="checkbox"/> No		Chloride concentration: _____ mg/l (For Emergency Pits and Settling Pits only)	
Is the bottom below ground level? <input type="checkbox"/> Yes <input checked="" type="checkbox"/> No	Artificial Liner? <input type="checkbox"/> Yes <input checked="" type="checkbox"/> No	How is the pit lined if a plastic liner is not used?	
Pit dimensions (all but working pits): _____ Length (feet) _____ Width (feet) <b>X</b> N/A: Steel Pits Depth from ground level to deepest point: _____ (feet)			
If the pit is lined give a brief description of the liner material, thickness and installation procedure.		Describe procedures for periodic maintenance and determining liner integrity, including any special monitoring.	
Distance to nearest water well within one-mile of pit <b>163</b> feet Depth of water well <b>17</b> feet		Depth to shallowest fresh water <b>17</b> feet. Source of information: _____ measured _____ well owner <b>(10)</b> electric log _____ KDWR	
<b>Emergency, Settling and Burn Pits ONLY:</b> Producing Formation: _____ Number of producing wells on lease: _____ Barrels of fluid produced daily: _____ Does the slope from the tank battery allow all spilled fluids to flow into the pit? <input type="checkbox"/> Yes <input type="checkbox"/> No		<b>Drilling, Workover and Haul-Off Pits ONLY:</b> Type of material utilized in drilling/workover: _____ Number of working pits to be utilized: _____ Abandonment procedure: _____ Drill pits must be closed within 365 days of spud date.	
I hereby certify that the above statements are true and correct to the best of my knowledge and belief.  <div style="display: flex; justify-content: space-between;"><div>Date: <b>1-25-07</b></div><div> Signature of Applicant or Agent</div><div><b>RECEIVED</b> <b>JAN 25</b></div></div>			
<b>KCC OFFICE USE ONLY</b> <div style="display: flex; justify-content: space-between;"><div>Date Received: <b>1/29/07</b> Permit Number: _____</div><div>Permit Date: <b>1/29/07</b> Lease Inspection: <input type="checkbox"/> Yes <input checked="" type="checkbox"/> No</div></div> <div style="text-align: right;"><b>KCC WICHITA</b> Steel Pit</div>			

Mail to: KCC - Conservation Division, 130 S. Market - Room 2078, Wichita, Kansas 67202

# KANSAS

CORPORATION COMMISSION

KATHLEEN SEBELIUS, GOVERNOR

BRIAN J. MOLINE, CHAIR

ROBERT E. KREHBIEL, COMMISSIONER

MICHAEL C. MOFFET, COMMISSIONER

January 29, 2007

Mr. Scott Ecklund  
Coffeyville Resources  
701 East Martin St  
Coffeyville, KS 67337

RE: Drilling Pit Application  
Coffeyville Resources Lease Well No. CP-4  
NE/4 Sec. 36-34S-16E  
Montgomery County, Kansas

Dear Mr. Ecklund:

This office has been informed that steel pits are to be used at the above referenced location. **If a haul-off pit is necessary please file form CDP-1, Application for Surface Pit.** This location will have to be inspected prior to approval of the haul-off pit application.

If fluids are taken to an authorized disposal well, please call the District Office at (620) 432-2300. Please file form CDP-5, Exploration and Production Waste Transfer, within 30 days of fluid removal.

Conservation division forms are available through our office and on the KCC web site: [www.kcc.state.ks.us/conservation/forms](http://www.kcc.state.ks.us/conservation/forms).

Sincerely,

  
Kathy Haynes

Environmental Protection and Remediation Department

Cc: S Korf

# KANSAS

CORPORATION COMMISSION

KATHLEEN SEBELIUS, GOVERNOR

BRIAN J. MOLINE, CHAIR

ROBERT E. KREHBIEL, COMMISSIONER

MICHAEL C. MOFFET, COMMISSIONER

## HAUL-OFF PIT APPLICATION FILING REQUIREMENTS

### 82-3-607. DISPOSAL OF DIKE AND PIT CONTENTS.

- (a) Each operator shall perform one of the following when disposing of dike or pit contents:
- (1) Remove the liquid contents to a disposal well or other oil and gas operation approved by the commission or to road maintenance or construction locations approved by the department;
  - (2) dispose of reserve pit waste down the annular space of a well completed according to the alternate I requirements of K.A.R. 82-3-106, if the waste to be disposed of was generated during the drilling and completion of the well; or
  - (3) dispose of the remaining solid contents in any manner required by the commission. The requirements may include any of the following:
    - (A) Burial in place, in accordance with the grading and restoration requirements in K.A.R. 82-3-602 (f);
    - (B) removal and placement of the contents in an on-site disposal area approved by the commission;
    - (C) removal and placement of the contents in an off-site disposal area on acreage owned by the same landowner or to another producing lease or unit operated by the same operator, if prior written permission from the landowner has been obtained; or
    - (D) removal of the contents to a permitted off-site disposal area approved by the department.
- (b) Each violation of this regulation shall be punishable by the following:
- (1) A \$1,000 penalty for the first violation;
  - (2) a \$2,500 penalty for the second violation; and
  - (3) a \$5,000 penalty and an operator license review for the third violation.

### **Complete and return with Haul-Off Pit Application, Form CDP1(2004)**

Haul-off pit will be located in an on-site disposal area: ☐ Yes ☐ No

Haul-off pit is located in an off-site disposal area on acreage owned by the same landowner:

☐ Yes ☐ No If yes, written permission from the land owner must be obtained. Attach written permission to haul-off pit application.

Haul-off pit is located in an off-site disposal area on another **producing** lease or unit operated by the same operator: ☐ Yes ☐ No If yes, written permission from the land owner must be obtained. Attach permission and a copy of the lease assignment that covers the acreage where the haul-off pit is to be located, to the haul-off pit application.

Conservation Division, Finney State Office Building, 130 S. Market, Room 2078, Wichita, KS 67202-3802

Voice 316.337.6200 Fax 316.337.6211 www.kcc.state.ks.us