

OWWO

For KCC Use: Effective Date: 2-6-07 District # _____ SGA? Yes No

KANSAS CORPORATION COMMISSION OIL & GAS CONSERVATION DIVISION NOTICE OF INTENT TO DRILL

Form C-1 December 2002 Form must be Typed Form must be Signed All blanks must be Filled

Must be approved by KCC five (5) days prior to commencing well

Expected Spud Date: 2 month, 16 day, 2007 year

Spot ne se sw Sec. 33 Twp. 15 S. R. 20W East West

OPERATOR: License# 33786 Name: Double "D,s" LLC Address: 133 East 12th ST City/State/Zip: Hays, Kansas 67601 Contact Person: Duane Bieker Phone: 785-230-0113

per plugging record

660 990 feet from N / S Line of Section 330 2310 feet from E / W Line of Section Is SECTION Regular Irregular?

CONTRACTOR: License# 33771 Name: Ultimate Well Service

(Note: Locate well on the Section Plat on reverse side) County: Ellis

Lease Name: Brenner Well #: 1-A SWD Field Name: Wallace

Is this a Prorated / Spaced Field? Yes No

Target Formation(s): Cedar Hill sand

Nearest Lease or unit boundary:

Ground Surface Elevation: 2299 kb feet MSL

Water well within one-quarter mile: Yes No

Public water supply well within one mile: Yes No

Depth to bottom of fresh water: 140'

Depth to bottom of usable water: 800'

Surface Pipe by Alternate: 1 2

Length of Surface Pipe Planned to be set: 208'

Length of Conductor Pipe required:

Projected Total Depth: 1700'

Formation at Total Depth: Anhydrite

Water Source for Drilling Operations: Well Farm Pond Other lease

DWR Permit #: (Note: Apply for Permit with DWR)

Will Cores be taken? Yes No

If Yes, proposed zone:

Well Drilled For: Oil Gas OWWO Seismic; # of Holes Other double drum pulling unit Well Class: Enh Rec Storage Disposal Wildcat Other Infield Pool Ext Wildcat Other Type Equipment: Mud Rotary Air Rotary Cable

If OWWO: old well information as follows: Operator: Rains & Williamson Oil Co. Well Name: Edwards #2 Original Completion Date: 11/27/66 Original Total Depth: 4052

Directional, Deviated or Horizontal wellbore? Yes No

If Yes, true vertical depth:

Bottom Hole Location:

KCC DKT #:

AFFIDAVIT

The undersigned hereby affirms that the drilling, completion and eventual plugging of this well will comply with K.S.A. 55 et. seq.

It is agreed that the following minimum requirements will be met:

- 1. Notify the appropriate district office prior to spudding of well; 2. A copy of the approved notice of intent to drill shall be posted on each drilling rig; 3. The minimum amount of surface pipe as specified below shall be set by circulating cement to the top; in all cases surface pipe shall be set through all unconsolidated materials plus a minimum of 20 feet into the underlying formation. 4. If the well is dry hole, an agreement between the operator and the district office on plug length and placement is necessary prior to plugging; 5. The appropriate district office will be notified before well is either plugged or production casing is cemented in; 6. If an ALTERNATE II COMPLETION, production pipe shall be cemented from below any usable water to surface within 120 days of spud date. Or pursuant to Appendix "B" - Eastern Kansas surface casing order #133.891-C, which applies to the KCC District 3 area, alternate II cementing must be completed within 30 days of the spud date or the well shall be plugged. In all cases, NOTIFY district office prior to any cementing.

I hereby certify that the statements made herein are true and to the best of my knowledge and belief.

Date: 1/28/2007 Signature of Operator or Agent: Duane Bieker Title: Partner

For KCC Use ONLY API # 15 - 051-30398-00-01 Conductor pipe required None feet Minimum surface pipe required 208 feet per Alt. X2 Approved by: [Signature] 2-1-07 This authorization expires: 8-1-07 (This authorization void if drilling not started within 6 months of approval date.) Spud date: Agent:

Remember to:

- File Drill Pit Application (form CDP-1) with Intent to Drill; - File Completion Form ACO-1 within 120 days of spud date; - File acreage attribution plat according to field proration orders; - Notify appropriate district office 48 hours prior to workover or re-entry; - Submit plugging report (CP-4) after plugging is completed; - Obtain written approval before disposing or injecting salt water. - If this permit has expired (See: authorized expiration date) please check the box below and return to the address below.

Well Not Drilled - Permit Expired Signature of Operator or Agent: Date:

RECEIVED

Mail to: KCC - Conservation Division, 130 S. Market - Room 2078, Wichita, Kansas 67202

JAN 31 2007

CONSERVATION DIVISION WICHITA, KS

33 15 2007

IN ALL CASES PLOT THE INTENDED WELL ON THE PLAT BELOW

Plat of acreage attributable to a well in a prorated or spaced field

If the intended well is in a prorated or spaced field, please fully complete this side of the form. If the intended well is in a prorated or spaced field complete the plat below showing that the well will be properly located in relationship to other wells producing from the common source of supply. Please show all the wells and within 1 mile of the boundaries of the proposed acreage attribution unit for gas wells and within 1/2 mile of the boundaries of the proposed acreage attribution unit for oil wells.

API No. 15 - 051-30398-00-01
 Operator: Double "D.s" LLC
 Lease: Brenner
 Well Number: 1-A SWD'
 Field: Wallace
 Number of Acres attributable to well: _____
 QTR / QTR / QTR of acreage: ne - se - sw

Location of Well: County: Ellis
 _____ feet from N / S Line of Section
 _____ feet from E / W Line of Section
 Sec. 33 Twp. 15 S. R. 20th East West

Is Section: Regular or Irregular

If Section is Irregular, locate well from nearest corner boundary.
 Section corner used: NE NW SE SW

PLAT

(Show location of the well and shade attributable acreage for prorated or spaced wells.)

(Show footage to the nearest lease or unit boundary line.)

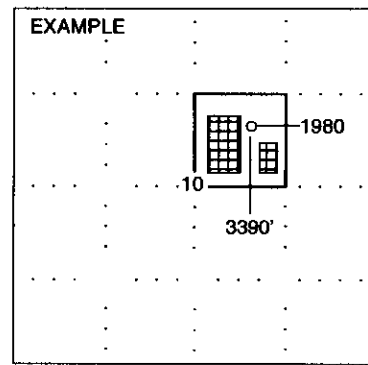
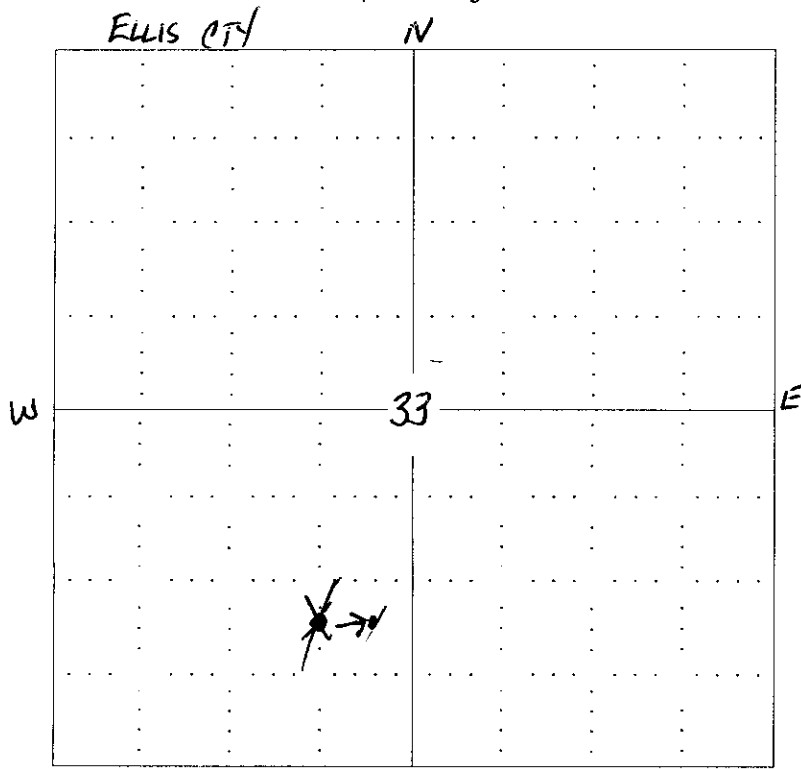

NOTE: In all cases locate the spot of the proposed drilling location.

In plotting the proposed location of the well, you must show:

1. The manner in which you are using the depicted plat by identifying section lines, i.e. 1 section, 1 section with 8 surrounding sections, 4 sections, etc.
2. The distance of the proposed drilling location from the section's south / north and east / west.
3. The distance to the nearest lease or unit boundary line.
4. If proposed location is located within a prorated or spaced field a certificate of acreage attribution plat must be attached: (CG-8 for gas wells).

RECEIVED
 KANSAS CORPORATION COMMISSION

JAN 3 1 2007

CONSERVATION DIVISION
 WICHITA, KS

**KANSAS CORPORATION COMMISSION
OIL & GAS CONSERVATION DIVISION
APPLICATION FOR SURFACE PIT**

Form CDP-1
April 2004
Form must be Typed

Submit in Duplicate

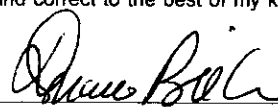
Operator Name: Double "D" s LLC		License Number: 33786	
Operator Address: 133 East 12th St			
Contact Person: Duane Bieker		Phone Number: (785) 230 - 0113	
Lease Name & Well No.: Brenner #1-A SWD		Pit Location (QQQQ): <u>ne</u> <u>se</u> <u>sw</u> <u>_____</u>	
Type of Pit: <input type="checkbox"/> Emergency Pit <input type="checkbox"/> Burn Pit <input type="checkbox"/> Settling Pit <input checked="" type="checkbox"/> Drilling Pit <input type="checkbox"/> Workover Pit <input type="checkbox"/> Haul-Off Pit <i>(If WP Supply API No. or Year Drilled)</i>		Pit is: <input checked="" type="checkbox"/> Proposed <input type="checkbox"/> Existing If Existing, date constructed: _____ Pit capacity: <u>200</u> (bbls)	
		Sec. <u>33</u> Twp. <u>15</u> R. <u>20</u> <input type="checkbox"/> East <input checked="" type="checkbox"/> West <u>850 990</u> Feet from <input type="checkbox"/> North / <input checked="" type="checkbox"/> South Line of Section <u>330 2310</u> Feet from <input checked="" type="checkbox"/> East / <input checked="" type="checkbox"/> West Line of Section Ellis _____ County	
Is the pit located in a Sensitive Ground Water Area? <input type="checkbox"/> Yes <input checked="" type="checkbox"/> No		Chloride concentration: _____ mg/l <i>(For Emergency Pits and Settling Pits only)</i>	
Is the bottom below ground level? <input checked="" type="checkbox"/> Yes <input type="checkbox"/> No		Artificial Liner? <input checked="" type="checkbox"/> Yes <input type="checkbox"/> No	
How is the pit lined if a plastic liner is not used?			
Pit dimensions (all but working pits): <u>10'</u> Length (feet) <u>5'</u> Width (feet) <u>N/A</u> : Steel Pits Depth from ground level to deepest point: <u>8'</u> (feet)			
If the pit is lined give a brief description of the liner material, thickness and installation procedure. Plastic pit liner		Describe procedures for periodic maintenance and determining liner integrity, including any special monitoring.	
Distance to nearest water well within one-mile of pit <u>N/A</u> feet Depth of water well _____ feet		Depth to shallowest fresh water _____ feet. Source of information: _____ measured _____ well owner _____ electric log _____ KDWR	
Emergency, Settling and Burn Pits ONLY: Producing Formation: _____ Number of producing wells on lease: _____ Barrels of fluid produced daily: _____ Does the slope from the tank battery allow all spilled fluids to flow into the pit? <input type="checkbox"/> Yes <input type="checkbox"/> No		Drilling, Workover and Haul-Off Pits ONLY: Type of material utilized in drilling/workover: <u>saltwater</u> Number of working pits to be utilized: <u>2</u> Abandonment procedure: <u>backfill with dirt</u> _____ Drill pits must be closed within 365 days of spud date.	
I hereby certify that the above statements are true and correct to the best of my knowledge and belief.			
<u>11/28/2007</u> Date		 Signature of Applicant or Agent	

15-051-30398-00-01

KCC OFFICE USE ONLY			
Date Received: <u>1/31/07</u>	Permit Number: _____	Permit Date: <u>2/1/07</u>	Lease Inspection: <input type="checkbox"/> Yes <input type="checkbox"/> No

RECEIVED

Mail to: KCC - Conservation Division, 130 S. Market - Room 2078, Wichita, Kansas 67202

JAN 31 2007

CONSERVATION DIVISION
WICHITA, KS

15-051-30398-0000

STATE OF KANSAS
STATE CORPORATION COMMISSION

Form CP-4

WELL PLUGGING RECORD

See All Information Completely
Make Required Affidavit
Mail or Deliver Report to:
Conservation Division
State Corporation Commission
212 No. Market
Wichita, Kansas

Ellis County, Sec. 33 Twp. 15S Rge. (E) 20(W)
Location as "NE/CNWKSWW" or footage from lines NE SE SW
Lease Owner Rains & Williamson Oil Co.
Lease Name Edwards Well No. 2
Office Address 1425 Wichita Plaza Bldg., Wichita, Kansas
Character of Well (completed as Oil, Gas or Dry Hole) Dry Hole
Date well completed 12-7 1966
Application for plugging filed 12-7 1966
Application for plugging approved 12-7 1966
Plugging commenced 12-7 1966
Plugging completed 12-7 1966
Reason for abandonment of well or producing formation no oil or gas found in commercial quantities
If a producing well is abandoned, date of last production 19
Was permission obtained from the Conservation Division or its agents before plugging was commenced? yes

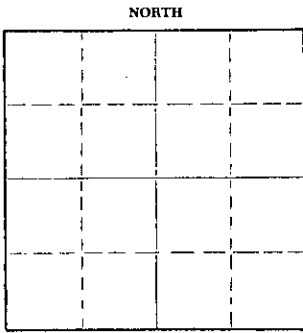

Locate well correctly on above
Section Plat

Name of Conservation Agent who supervised plugging of this well Leo Massey, Hays, Kansas
Producing formation _____ Depth to top _____ Bottom _____ Total Depth of Well 4052 Feet
Show depth and thickness of all water, oil and gas formations.

OIL, GAS OR WATER RECORDS

CASING RECORD

FORMATION	CONTENT	FROM	TO	SIZE	PUT IN	PULLED OUT
				8-5/8"	208.06'	

Describe in detail the manner in which the well was plugged, indicating where the mud fluid was placed and the method or methods used in introducing it into the hole. If cement or other plugs were used, state the character of same and depth placed, from _____ feet to _____ feet for each plug set.

Pushed plug to 600'. Spotted with 25 sacks cement. Mud back to 200'.
Pushed plug and spotted with 20 sacks cement. Mud back to 40'. Set
solid bridge and capped with 8 sacks, 2 sacks in rat hole.

RECEIVED
STATE CORPORATION COMMISSION

DEC 19 1966

CONSERVATION DIVISION
WICHITA, KANSAS

(If additional description is necessary, use BACK of this sheet)

Name of Plugging Contractor Rains & Williamson Oil Co.
Address 1425 Wichita Plaza Bldg., Wichita, Kansas

STATE OF Kansas, COUNTY OF Sedgwick, ss.
Wilson Rains (employee of owner) or (owner or operator) of the above-described well, being first duly sworn on oath, says: That I have knowledge of the facts, statements, and matters herein contained and the log of the above-described well as filed and that the same are true and correct. So help me God.

(Signature) Wilson Rains
WILSON RAINS
1425 Wichita Plaza Bldg., Wichita, Kansas
(Address)

SUBSCRIBED AND SWORN to before me this 12th day of December, 1966

Mary J. Brown
Notary Public.

My commission expires 3-3-70

KANSAS

CORPORATION COMMISSION

KATHLEEN SEBELIUS, GOVERNOR

BRIAN J. MOLINE, CHAIR

ROBERT E. KREHBIEL, COMMISSIONER

MICHAEL C. MOFFET, COMMISSIONER

NOTICE TO OPERATORS FILING INTENT TO DRILL FOR DISPOSAL OR ENHANCED RECOVERY INJECTION WELLS, (CLASS II INJECTION WELL)

The attached approved Notice of Intent to Drill indicates the proposed well is to be used for injection. An approved "Intent to Drill" does not approve injection authority as a Class II Injection Well in Kansas.

Before any well is used for injection purposes, the operator must file an application for injection authority in accordance with K.A.R. 82-3-401 and provide notice in accordance with K.A.R. 82-3-402. The Conservation Division must issue a written permit granting the application before commencement of injection.

The Conservation Division requirements and restrictions associated with Class II Injection are identified in **K.A.R. 82-3-400 et seq** of our regulations. Associated regulations governing drilling, completion and injection applications may be found in K.A.R. 82-3-135, Table I, Table II, in the Cedar Hills Sandstone Moratorium, (Docket #156,397-C), and the Eastern Kansas Surface Casing Order, (Docket #133,891-C).

If you have questions regarding the approval of injection authority, an injection application may be filed as a "Design Approval" before actual drilling and completion of the well occurs. If you have any questions or concerns regarding Class II injection wells or regulations, call the Underground Injection Control Department at 316-337-6200.

Failure to obtain commission approval before beginning injection is punishable by a penalty, shut-in of the well or both.