

For KCC Use:
 Effective Date: 2-10-07
 District #: 2
 SGA? Yes No

KANSAS CORPORATION COMMISSION
 OIL & GAS CONSERVATION DIVISION
NOTICE OF INTENT TO DRILL

Form C-1
 December 2002
Form must be Typed
Form must be Signed
All blanks must be Filled

Must be approved by KCC five (5) days prior to commencing well

Expected Spud Date 03-15-07
month day year

OPERATOR: License# 30483
 Name: Les Kremeier
 Address: 3183 US Hwy 56
 City/State/Zip: Herington KS 67449
 Contact Person: Les Kremeier
 Phone: 785-366-6249

CONTRACTOR: License# 32548
 Name: Kan-Drill

Well Drilled For:	Well Class:	Type Equipment:
<input checked="" type="checkbox"/> Oil	<input type="checkbox"/> Enh Rec	<input type="checkbox"/> Infield
<input type="checkbox"/> Gas	<input type="checkbox"/> Storage	<input checked="" type="checkbox"/> Pool Ext.
<input type="checkbox"/> OWWO	<input type="checkbox"/> Disposal	<input type="checkbox"/> Wildcat
<input type="checkbox"/> Seismic; # of Holes	<input type="checkbox"/> Other	<input type="checkbox"/> Cable
<input type="checkbox"/> Other		

If OWWO: old well information as follows:
 Operator: _____
 Well Name: _____
 Original Completion Date: _____ Original Total Depth: _____

Directional, Deviated or Horizontal wellbore? Yes No

If Yes, true vertical depth: _____

Bottom Hole Location: _____

KCC DKT #: _____

Oil & Gas Lease Attached

Spot East
 W 1/2 SW 1/4 Sec. 20 Twp. 19s S. R. 6 West
1910 feet from N / S Line of Section
100 feet from E / W Line of Section

Is SECTION Regular Irregular?
 (Note: Locate well on the Section Plat on reverse side)

County: Chase
 Lease Name: Ruby Slippers LLC Well #: 1
 Field Name: Viola Unnamed

Is this a Prorated / Spaced Field? Yes No
 Target Formation(s): Viola

→ Nearest Lease or unit boundary: 330 per operator
 Ground Surface Elevation: 1418 feet MSL

Water well within one-quarter mile: Yes No
 Public water supply well within one mile: Yes No

Depth to bottom of fresh water: 40ft
 Depth to bottom of usable water: 180ft

Surface Pipe by Alternate: 1 2
 Length of Surface Pipe Planned to be set: 200ft

Length of Conductor Pipe required: _____
 Projected Total Depth: 2200

Formation at Total Depth: viola
 Water Source for Drilling Operations:

Well Farm Pond Other _____
 DWR Permit #: _____

(Note: Apply for Permit with DWR)
 Will Cores be taken? Yes No

If Yes, proposed zone: _____

AFFIDAVIT

The undersigned hereby affirms that the drilling, completion and eventual plugging of this well will comply with K.S.A. 55 et. seq.
 It is agreed that the following minimum requirements will be met:

1. Notify the appropriate district office **prior** to spudding of well;
2. A copy of the approved notice of intent to drill **shall be** posted on each drilling rig;
3. The minimum amount of surface pipe as specified below **shall be set** by circulating cement to the top; in all cases surface pipe **shall be set** through all unconsolidated materials plus a minimum of 20 feet into the underlying formation.
4. If the well is dry hole, an agreement between the operator and the district office on plug length and placement is necessary **prior to plugging**;
5. The appropriate district office will be notified before well is either plugged or production casing is cemented in;
6. If an ALTERNATE II COMPLETION, production pipe shall be cemented from below any usable water to surface within **120 days** of spud date. Or pursuant to Appendix "B" - Eastern Kansas surface casing order #133,891-C, which applies to the KCC District 3 area, alternate II cementing must be completed within 30 days of the spud date or the well shall be plugged. **In all cases, NOTIFY district office** prior to any cementing.

I hereby certify that the statements made herein are true and to the best of my knowledge and belief.

Date: 1-31-07 Signature of Operator or Agent: Les Kremeier Title: Owner/Operator

For KCC Use ONLY
 API # 15 - 017-20895-0000
 Conductor pipe required None feet
 Minimum surface pipe required 200 feet per Alt. 1
 Approved by: Path 2-507
 This authorization expires: 8-5-07
 (This authorization void if drilling not started within 6 months of approval date.)
 Spud date: _____ Agent: _____

Remember to:

- File Drill Pit Application (form CDP-1) with Intent to Drill;
 - File Completion Form ACO-1 within 120 days of spud date;
 - File acreage attribution plat according to field proration orders;
 - Notify appropriate district office 48 hours prior to workover or re-entry;
 - Submit plugging report (CP-4) after plugging is completed;
 - Obtain written approval before disposing or injecting salt water.
- If this permit has expired (See: authorized expiration date) please check the box below and return to the address below.

Well Not Drilled - Permit Expired

Signature of Operator or Agent: _____
 Date: _____

Mail to: KCC - Conservation Division, 130 S. Market - Room 2078, Wichita, Kansas 67202

RECEIVED
 FEB 01 2007
 KCC WICHITA

20
19
06

IN ALL CASES PLOT THE INTENDED WELL ON THE PLAT BELOW

Plat of acreage attributable to a well in a prorated or spaced field

If the intended well is in a prorated or spaced field, please fully complete this side of the form. If the intended well is in a prorated or spaced field complete the plat below showing that the well will be properly located in relationship to other wells producing from the common source of supply. Please show all the wells and within 1 mile of the boundaries of the proposed acreage attribution unit for gas wells and within 1/2 mile of the boundaries of the proposed acreage attribution unit for oil wells.

API No. 15 - 017-20895-0000
 Operator: Les Kremerier
 Lease: Ruby Slippers LLC
 Well Number: 1
 Field: Viola

Number of Acres attributable to well: _____
 QTR / QTR / QTR of acreage: W 1/2 - SW - 1/4

Location of Well: County: Chase
1910 feet from N / S Line of Section
100 feet from E / W Line of Section
 Sec. 20 Twp. 19s S. R. 6 East West

Is Section: Regular or Irregular

If Section is Irregular, locate well from nearest corner boundary.

Section corner used: NE NW SE SW

PLAT

*(Show location of the well and shade attributable acreage for prorated or spaced wells.)
 (Show footage to the nearest lease or unit boundary line.)*

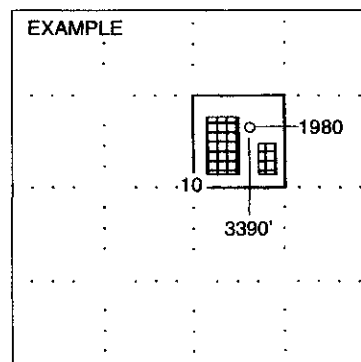
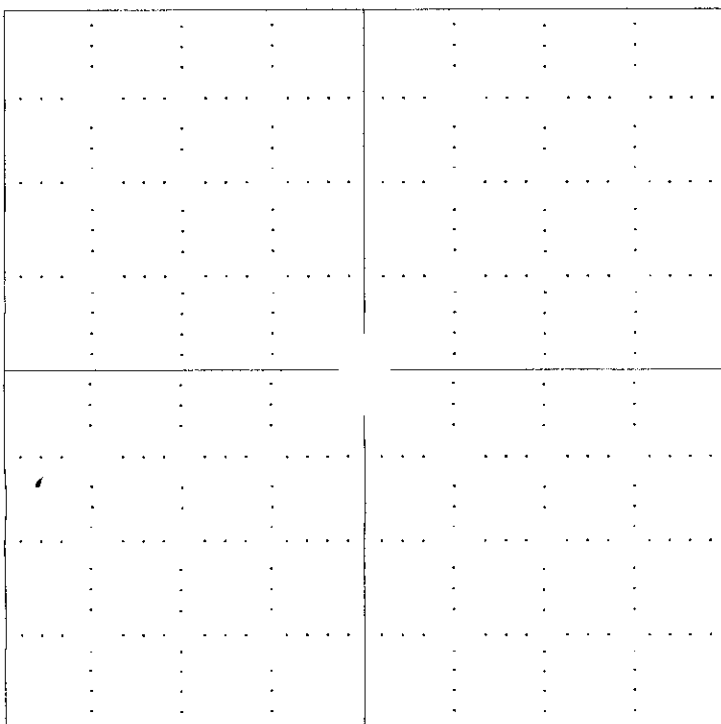

NOTE: In all cases locate the spot of the proposed drilling location.

In plotting the proposed location of the well, you must show:

1. The manner in which you are using the depicted plat by identifying section lines, i.e. 1 section, 1 section with 8 surrounding sections, 4 sections, etc.
2. The distance of the proposed drilling location from the section's south / north and east / west.
3. The distance to the nearest lease or unit boundary line.
4. If proposed location is located within a prorated or spaced field a certificate of acreage attribution plat must be attached. (CG-7 for oil wells; CG-8 for gas wells).

RECEIVED
FEB 01 2007
KCC WICHITA

KREMEIER PRODUCTION & OPERATING COMPANY, INC
RUBY SLIPPERS LLC LEASE
SW. 1/4, SECTION 20, T19S, R6E
CHASE COUNTY, KANSAS

15-017-20895-0000

NO ROAD

Notes:

1. Set iron rod at location site.
2. All flagging Red & Yellow.
3. Overhead power available in NE-1/4, Sec.19.
4. Kansas One Call System Inc. should be notified before excavation (1-800-344-7233).
5. CAUTION: Various pipelines in Sec.20.
6. Cattle in area at date of staking.
7. Contact landowner for best access.

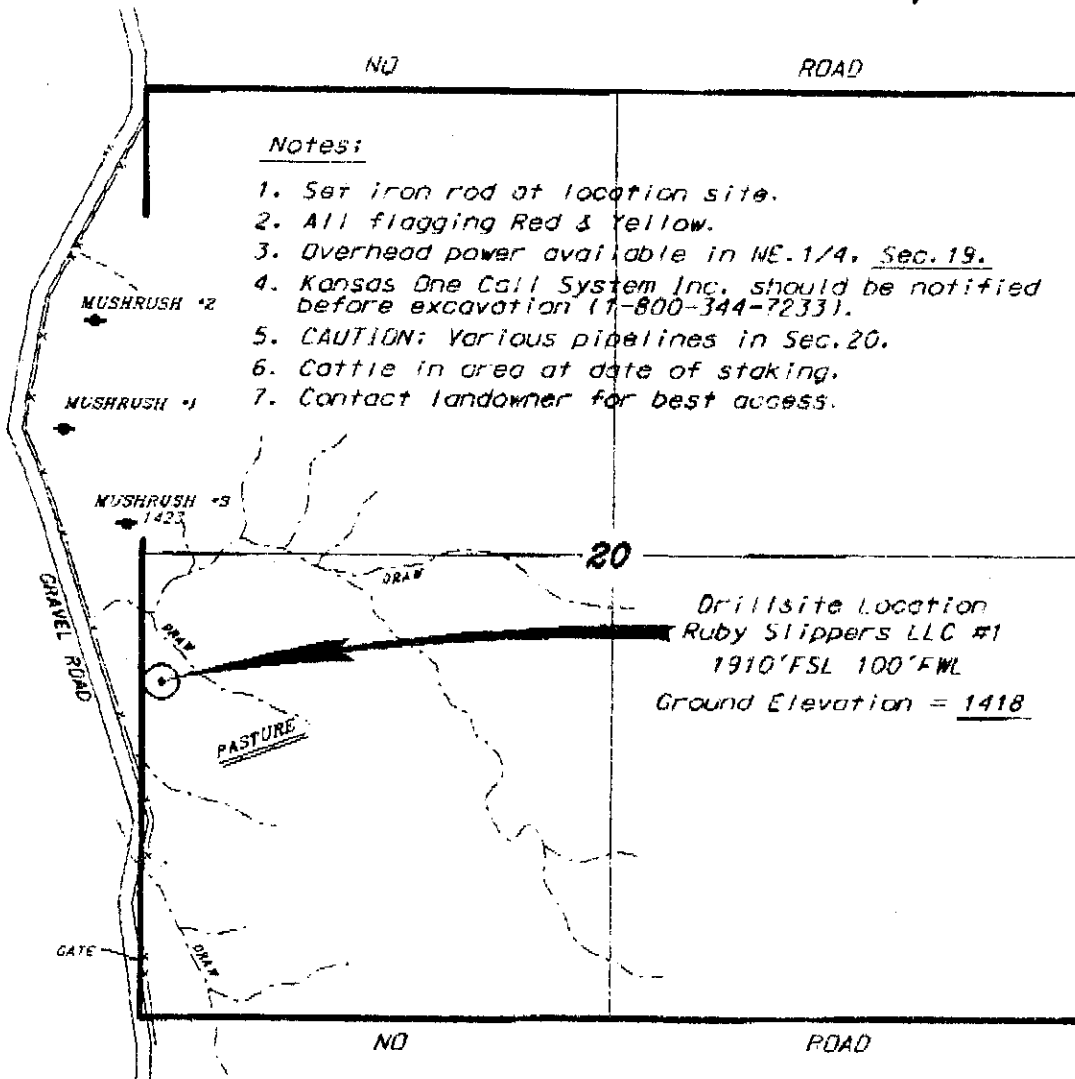

*Ingress and egress to location as shown on this plot is for usage only and may not be legally opened for public use. Contact landowner, tenant and county road department for access.

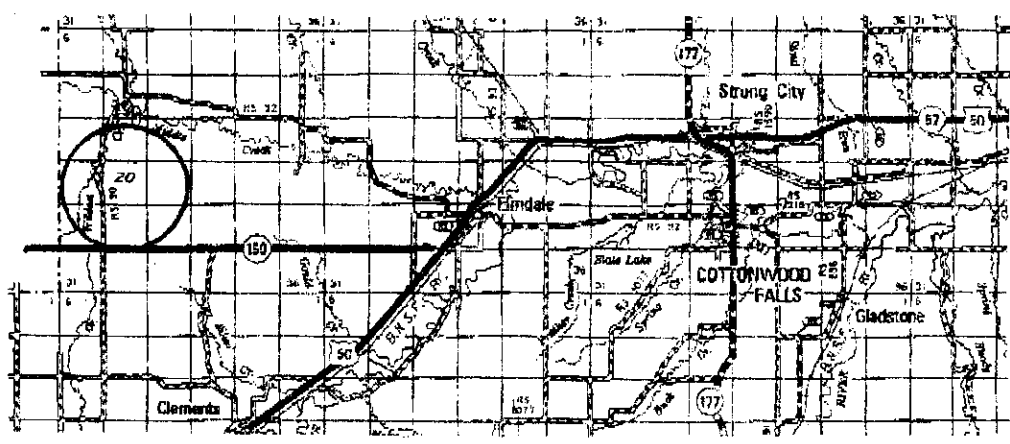
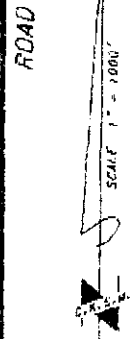

* Controlling data is based upon the best available photogrammetric data to us and upon a regular section of land containing the section.

* Separate section lines are determined using the normal standards of care of oilfield surveys conducted in the state of Kansas. The section corners, which establish the precise section lines, were not necessarily located, and the exact location of the drillsite location in the section is not guaranteed. Therefore, the operator requiring this service and occupying this plot are all other parties relying thereon agree to hold Central Kansas Oilfield Services, Inc., its officers and employees harmless from all losses, costs and expenses and hold it harmless from any liability from incidental or consequential damages.

* Elevations derived from National Geodetic Vertical Datum.

Date July 31, 2006

CENTRAL KANSAS OILFIELD SERVICES, INC. (620)792-1977

RECEIVED
FEB 01 2007
KCC WICHITA

**KANSAS CORPORATION COMMISSION
OIL & GAS CONSERVATION DIVISION
APPLICATION FOR SURFACE PIT**

Form CDP-1
April 2004
Form must be Typed

Submit in Duplicate

Operator Name: Kremeier Production & Operating		License Number: 30483
Operator Address: 3183 US Hwy 56 Herington KS 67449		
Contact Person: Les Kremeier		Phone Number: (785) 366 - 6249
Lease Name & Well No.: Ruby Slippers LLC #1		Pit Location (QQQQ): <u>Sw. NW - SW</u> Sec. <u>20</u> Twp. <u>19S</u> R. <u>6</u> <input checked="" type="checkbox"/> East <input type="checkbox"/> West <u>660</u> Feet from <input checked="" type="checkbox"/> North / <input type="checkbox"/> South Line of Section <u>400</u> Feet from <input type="checkbox"/> East / <input checked="" type="checkbox"/> West Line of Section <u>Chase</u> County
Type of Pit: <input type="checkbox"/> Emergency Pit <input type="checkbox"/> Burn Pit <input type="checkbox"/> Settling Pit <input checked="" type="checkbox"/> Drilling Pit <input type="checkbox"/> Workover Pit <input type="checkbox"/> Haul-Off Pit <small>(If WP Supply API No. or Year Drilled)</small>	Pit is: <input checked="" type="checkbox"/> Proposed <input type="checkbox"/> Existing If Existing, date constructed: _____ Pit capacity: _____ (bbls)	
Is the pit located in a Sensitive Ground Water Area? <input type="checkbox"/> Yes <input checked="" type="checkbox"/> No		Chloride concentration: _____ mg/l <small>(For Emergency Pits and Settling Pits only)</small>
Is the bottom below ground level? <input checked="" type="checkbox"/> Yes <input type="checkbox"/> No	Artificial Liner? <input checked="" type="checkbox"/> Yes <input type="checkbox"/> No	How is the pit lined if a plastic liner is not used?
Pit dimensions (all but working pits): <u>40</u> Length (feet) <u>10</u> Width (feet) <u>N/A: Steel Pits</u> Depth from ground level to deepest point: <u>5</u> (feet)		
If the pit is lined give a brief description of the liner material, thickness and installation procedure. 3 mil		Describe procedures for periodic maintenance and determining liner integrity, including any special monitoring. water meter on pump
Distance to nearest water well within one-mile of pit <u>4,000</u> feet Depth of water well <u>60</u> feet		Depth to shallowest fresh water <u>60</u> feet. Source of information: _____ measured <input checked="" type="checkbox"/> well owner _____ electric log _____ KDWR
Emergency, Settling and Burn Pits ONLY: Producing Formation: _____ Number of producing wells on lease: _____ Barrels of fluid produced daily: _____ Does the slope from the tank battery allow all spilled fluids to flow into the pit? <input type="checkbox"/> Yes <input type="checkbox"/> No		Drilling, Workover and Haul-Off Pits ONLY: Type of material utilized in drilling/workover: <u>mud</u> Number of working pits to be utilized: _____ Abandonment procedure: <u>Let dry and cover</u> Drill pits must be closed within 365 days of spud date.
I hereby certify that the above statements are true and correct to the best of my knowledge and belief.		
<u>1-31-07</u> Date	 Signature of Applicant or Agent	

15-017-20985-0000

KCC OFFICE USE ONLY			
Date Received: <u>2/1/07</u>	Permit Number: _____	Permit Date: <u>2/1/07</u>	Lease Inspection: <input type="checkbox"/> Yes <input checked="" type="checkbox"/> No

Mail to: KCC - Conservation Division, 130 S. Market - Room 2078, Wichita, Kansas 67202

RECEIVED
FEB 01 2007
KCC WICHITA