



skid Rig

For KCC Use: 2-11-07
Effective Date: 2-11-07
District # 4
SGA? Yes No

KANSAS CORPORATION COMMISSION 1007880
OIL & GAS CONSERVATION DIVISION

Form C-1
November 2005
Form must be Typed
Form must be Signed
All blanks must be Filled

NOTICE OF INTENT TO DRILL

Must be approved by KCC five (5) days prior to commencing well

Expected Spud Date: 02/06/2007
month day year

OPERATOR: License# 30606
Name: Murfin Drilling Co., Inc.
Address 1: 250 N. Water, Ste 300
Address 2:
City: Wichita State: KS Zip: 67202 +
Contact Person: Shauna Gunzelman
Phone: 316-267-3241

CONTRACTOR: License# 30606
Name: Murfin Drilling Co., Inc.

Well Drilled For: Oil Gas Seismic; # of Holes Other:
Well Class: Enh Rec Storage Disposal Other:
Well Class: Infield Pool Ext. Wildcat Other:
Type Equipment: Mud Rotary Air Rotary Cable

If OWWO: old well information as follows:
Operator:
Well Name:
Original Completion Date: Original Total Depth:

Directional, Deviated or Horizontal wellbore? Yes No
If Yes, true vertical depth:
Bottom Hole Location:
KCC DKT #:

Skid rig from 15-039-20996-0000

Spot Description: 15' E
W2 - SE - SW - NW Sec. 10 Twp. 3 S. R. 27 E W
(000/00) 2,310 feet from N / S Line of Section
840 feet from E / W Line of Section

Is SECTION: Regular Irregular?
(Note: Locate well on the Section Plat on reverse side)
County: Decatur

Lease Name: Martin "X" Well #: 1-10
Field Name: Wildcat

Is this a Prorated / Spaced Field? Yes No
Target Formation(s): Lansing, Arbuckle

Nearest Lease or unit boundary line (in footage): 330 ✓
Ground Surface Elevation: 2636 feet MSL

Water well within one-quarter mile: Yes No ✓
Public water supply well within one mile: Yes No ✓

Depth to bottom of fresh water: 225
Depth to bottom of usable water: 1500

Surface Pipe by Alternate: Alt I ✓
Length of Surface Pipe Planned to be set: 2220

Length of Conductor Pipe (if any): 0
Projected Total Depth: 4100 ✓
Formation at Total Depth: Arbuckle ✓

Water Source for Drilling Operations:
 Well Farm Pond Other: trucking ✓

DWR Permit #: (Note: Apply for Permit with DWR) ✓
Will Cores be taken? Yes No

If Yes, proposed zone:

AFFIDAVIT

The undersigned hereby affirms that the drilling, completion and eventual plugging of this well will comply with K.S.A. 55 et. seq.
It is agreed that the following minimum requirements will be met:

RECEIVED
KANSAS CORPORATION COMMISSION
FEB 06 2007

CONSERVATION DIVISION
WICHITA, KS

1. Notify the appropriate district office **prior** to spudding of well;
2. A copy of the approved notice of intent to drill **shall be** posted on each drilling rig;
3. The minimum amount of surface pipe as specified below **shall be set** by circulating cement to the top; in all cases surface pipe shall be set through all unconsolidated materials plus a minimum of 20 feet into the underlying formation.
4. If the well is dry hole, an agreement between the operator and the district office on plug length and placement is necessary **prior to plugging**;
5. The appropriate district office will be notified before well is either plugged or production casing is cemented in;
6. If an ALTERNATE II COMPLETION, production pipe shall be cemented from below any usable water to surface within **120 DAYS** of spud date. Or pursuant to Appendix "B" - Eastern Kansas surface casing order #133,891-C, which applies to the KCC District 3 area, alternate II cementing must be completed within 30 days of the spud date or the well shall be plugged. **In all cases, NOTIFY district office** prior to any cementing.

I hereby certify that the statements made herein are true and to the best of my knowledge and belief.

Date: 2/6/07 Signature of Operator or Agent: Shauna Gunzelman Title: Agent for Operator

For KCC Use ONLY
API # 15 - 039-20997-0000
Conductor pipe required 0 feet
Minimum surface pipe required 275' 1550' feet per ALT. I II
Approved by: Yuh 2-6-07
This authorization expires: 8-6-07
(This authorization void if drilling not started within 6 months of approval date.)
Spud date: Agent:

- Remember to:
- File Drill Pit Application (form CDP-1) with Intent to Drill;
 - File Completion Form ACO-1 within 120 days of spud date;
 - File acreage attribution plat according to field proration orders;
 - Notify appropriate district office 48 hours prior to workover or re-entry;
 - Submit plugging report (CP-4) after plugging is completed (within 60 days);
 - Obtain written approval before disposing or injecting salt water.
 - If this permit has expired (See: authorized expiration date) please check the box below and return to the address below.
- Well Not Drilled - Permit Expired Date: Signature of Operator or Agent:

10
3
27
 E
 W

IN ALL CASES PLOT THE INTENDED WELL ON THE PLAT BELOW

Plat of acreage attributable to a well in a prorated or spaced field

If the intended well is in a prorated or spaced field, please fully complete this side of the form. If the intended well is in a prorated or spaced field complete the plat below showing that the well will be properly located in relationship to other wells producing from the common source of supply. Please show all the wells and within 1 mile of the boundaries of the proposed acreage attribution unit for gas wells and within 1/2 mile of the boundaries of the proposed acreage attribution unit for oil wells.

API No. 15 - 039-20997-000
Operator: Murfin Drilling Co., Inc.
Lease: Martin "X"
Well Number: 1-10
Field: Wildcat

Location of Well: County: Decatur
2,310 feet from N / S Line of Section
840 feet from E / W Line of Section
Sec. 10 Twp. 3 S. R. 27 E W

Number of Acres attributable to well: _____
QTR/QTR/QTR/QTR of acreage: W2 - SE - SW - NW

Is Section: Regular or Irregular

If Section is Irregular, locate well from nearest corner boundary.

Section corner used: NE NW SE SW

PLAT

(Show location of the well and shade attributable acreage for prorated or spaced wells.)

(Show footage to the nearest lease or unit boundary line.)

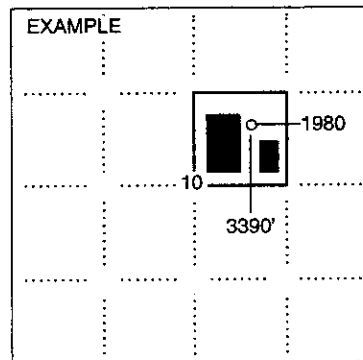
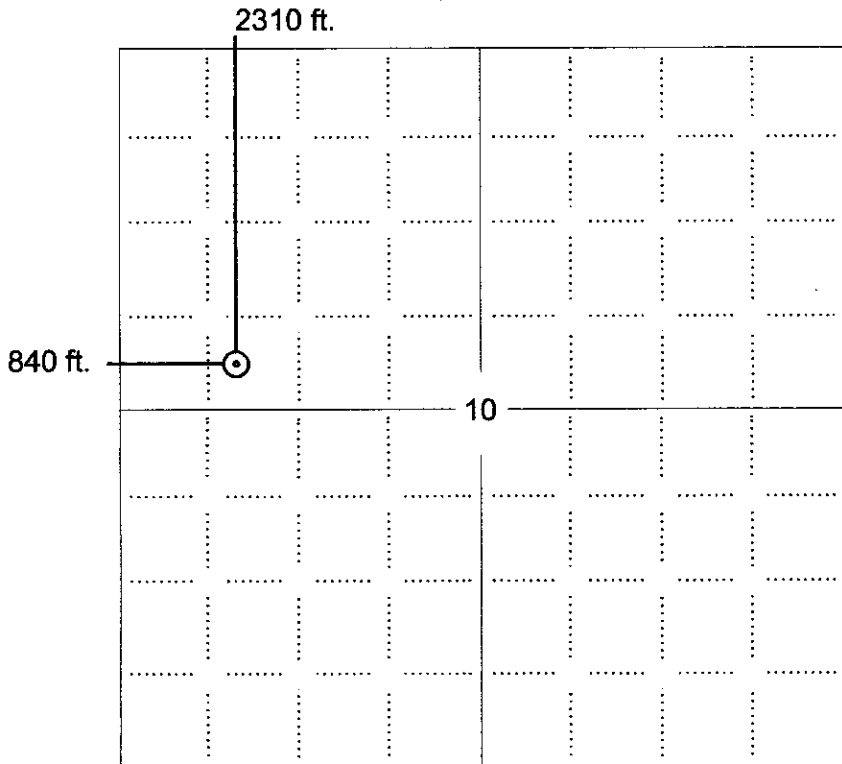

SEWARD CO.

NOTE: In all cases locate the spot of the proposed drilling location.

In plotting the proposed location of the well, you must show:

1. The manner in which you are using the depicted plat by identifying section lines, i.e. 1 section, 1 section with 8 surrounding sections, 4 sections, etc.
2. The distance of the proposed drilling location from the south / north and east / west outside section lines.
3. The distance to the nearest lease or unit boundary line (in footage).
4. If proposed location is located within a prorated or spaced field a certificate of acreage attribution plat must be attached: (CO-7 for oil wells; CG-8 for gas wells).



KANSAS CORPORATION COMMISSION 1007880
OIL & GAS CONSERVATION DIVISION

Form CDP-1
April 2004
Form must be Typed

APPLICATION FOR SURFACE PIT

Submit in Duplicate

Operator Name: Murfin Drilling Co., Inc.		License Number: 30606	
Operator Address: 250 N. Water, Ste 300		Wichita KS 67202	
Contact Person: Shauna Gunzelman		Phone Number: 316-267-3241	
Lease Name & Well No.: Martin "X" 1-10		Pit Location (QQQQ): W2 SE SW NW Sec. 10 Twp. 3 R. 27 <input type="checkbox"/> East <input checked="" type="checkbox"/> West 2,310 Feet from <input checked="" type="checkbox"/> North / <input type="checkbox"/> South Line of Section 840 Feet from <input type="checkbox"/> East / <input checked="" type="checkbox"/> West Line of Section Decatur County	
Type of Pit: <input type="checkbox"/> Emergency Pit <input type="checkbox"/> Burn Pit <input type="checkbox"/> Settling Pit <input checked="" type="checkbox"/> Drilling Pit <input type="checkbox"/> Workover Pit <input type="checkbox"/> Haul-Off Pit <small>(If WP Supply API No. or Year Drilled)</small>	Pit is: <input type="checkbox"/> Proposed <input checked="" type="checkbox"/> Existing If Existing, date constructed: 1/29/07 Pit capacity: 600 (bbls)	Is the pit located in a Sensitive Ground Water Area? <input type="checkbox"/> Yes <input checked="" type="checkbox"/> No Chloride concentration: _____ mg/l <small>(For Emergency Pits and Settling Pits only)</small>	
Is the bottom below ground level? <input checked="" type="checkbox"/> Yes <input type="checkbox"/> No	Artificial Liner? <input type="checkbox"/> Yes <input checked="" type="checkbox"/> No	How is the pit lined if a plastic liner is not used? Bentonite and solids from drilling operations self seal pits	
Pit dimensions (all but working pits): 100 Length (feet) 100 Width (feet) <input type="checkbox"/> N/A: Steel Pits Depth from ground level to deepest point: 4 (feet) <input type="checkbox"/> No Pit		If the pit is lined give a brief description of the liner material, thickness and installation procedure.	
		Describe procedures for periodic maintenance and determining liner integrity, including any special monitoring. RECEIVED KANSAS CORPORATION COMMISSION FEB 06 2007 CONSERVATION DIVISION WICHITA, KS	
Distance to nearest water well within one-mile of pit NA feet Depth of water well _____ feet	Depth to shallowest fresh water 150 feet. Source of information: <input type="checkbox"/> measured <input type="checkbox"/> well owner <input type="checkbox"/> electric log <input checked="" type="checkbox"/> KDWR		
Emergency, Settling and Burn Pits ONLY: Producing Formation: _____ Number of producing wells on lease: _____ Barrels of fluid produced daily: _____ Does the slope from the tank battery allow all spilled fluids to flow into the pit? <input type="checkbox"/> Yes <input type="checkbox"/> No	Drilling, Workover and Haul-Off Pits ONLY: Type of material utilized in drilling/workover: Bentonite Number of working pits to be utilized: 4 Abandonment procedure: Allow pits to evaporate until dry, then backfill when conditions allow. Drill pits must be closed within 365 days of spud date.		
I hereby certify that the above statements are true and correct to the best of my knowledge and belief.			
2/6/07 Date		<i>Shauna Gunzelman, Agent for Operator</i> Signature of Applicant or Agent	

15-039-20997-0000

KCC OFFICE USE ONLY		RFAC <input type="checkbox"/>	RFAS <input type="checkbox"/>
Date Received: 2/6/07	Permit Number: _____	Permit Date: 2/6/07	Lease Inspection: <input type="checkbox"/> Yes <input checked="" type="checkbox"/> No

Mail to: KCC - Conservation Division, 130 S. Market - Room 2078, Wichita, Kansas 67202