

For KCC Use:  
Effective Date: 2-13-07  
District #: 4  
SGA?  Yes  No

KANSAS CORPORATION COMMISSION  
OIL & GAS CONSERVATION DIVISION  
**NOTICE OF INTENT TO DRILL**

Form C-1  
December 2002  
Form must be Typed  
Form must be Signed  
All blanks must be Filled

Must be approved by KCC five (5) days prior to commencing well

Expected Spud Date February 15, 2007  
month day year

OPERATOR: License# 30537  
Name: Venture Resources, Inc.  
Address: P. O. Box 101234  
City/State/Zip: Denver CO 80250  
Contact Person: Ron Mackey  
Phone: 303-722-2899

CONTRACTOR: License# 33493  
Name: American Eagle Drilling, LLC

Well Drilled For:	Well Class:	Type Equipment:
<input checked="" type="checkbox"/> Oil	<input checked="" type="checkbox"/> Infield	<input checked="" type="checkbox"/> Mud Rotary
<input type="checkbox"/> Gas	<input type="checkbox"/> Pool Ext.	<input type="checkbox"/> Air Rotary
<input type="checkbox"/> OWWO	<input type="checkbox"/> Wildcat	<input type="checkbox"/> Cable
<input type="checkbox"/> Seismic; # of Holes	<input type="checkbox"/> Other	
<input type="checkbox"/> Other		

If OWWO: old well information as follows:  
Operator: \_\_\_\_\_  
Well Name: \_\_\_\_\_  
Original Completion Date: \_\_\_\_\_ Original Total Depth: \_\_\_\_\_  
Directional, Deviated or Horizontal wellbore?  Yes  No  
If Yes, true vertical depth: \_\_\_\_\_  
Bottom Hole Location: \_\_\_\_\_  
KCC DKT #: \_\_\_\_\_

Spot  East  
NE SE SW Sec. 1 Twp. 11S S. R. 18W  West  
893' \_\_\_\_\_ feet from  N /  S Line of Section  
2310' \_\_\_\_\_ feet from  E /  W Line of Section  
Is SECTION  Regular  Irregular?

(Note: Locate well on the Section Plat on reverse side)

County: Ellis  
Lease Name: Ridler G Well #: 6  
Field Name: Bemis-Shutts  
Is this a Prorated / Spaced Field?  Yes  No  
Target Formation(s): Arbuckle  
Nearest Lease or unit boundary: 330  
Ground Surface Elevation: 1887.9 feet MSL  
Water well within one-quarter mile:  Yes  No  
Public water supply well within one mile:  Yes  No  
Depth to bottom of fresh water: 180'  
Depth to bottom of usable water: 580'  
Surface Pipe by Alternate:  1  2  
Length of Surface Pipe Planned to be set: 210'  
Length of Conductor Pipe required: None  
Projected Total Depth: 3525'  
Formation at Total Depth: Arbuckle  
Water Source for Drilling Operations:  
 Well  Farm Pond  Other  
DWR Permit #: 20060346

(Note: Apply for Permit with DWR )

Will Cores be taken?  Yes  No  
If Yes, proposed zone: \_\_\_\_\_

**AFFIDAVIT**

The undersigned hereby affirms that the drilling, completion and eventual plugging of this well will comply with K.S.A. 55 et. seq.  
It is agreed that the following minimum requirements will be met:

1. Notify the appropriate district office **prior** to spudding of well;
2. A copy of the approved notice of intent to drill **shall be** posted on each drilling rig;
3. The minimum amount of surface pipe as specified below **shall be set** by circulating cement to the top; in all cases surface pipe **shall be set** through all unconsolidated materials plus a minimum of 20 feet into the underlying formation.
4. If the well is dry hole, an agreement between the operator and the district office on plug length and placement is necessary **prior to plugging**;
5. The appropriate district office will be notified before well is either plugged or production casing is cemented in;
6. If an ALTERNATE II COMPLETION, production pipe shall be cemented from below any usable water to surface within **120 days** of spud date.  
Or pursuant to Appendix "B" - Eastern Kansas surface casing order #133,891-C, which applies to the KCC District 3 area, alternate II cementing must be completed within 30 days of the spud date or the well shall be plugged. **In all cases, NOTIFY district office** prior to any cementing.

I hereby certify that the statements made herein are true and to the best of my knowledge and belief.

Date: 2-05-07 Signature of Operator or Agent: Ronald Mackey Title: CEO

**For KCC Use ONLY**  
API # 15 - 051-25614-0000  
Conductor pipe required None feet  
Minimum surface pipe required 200 feet per Alt.   
Approved by: Ron Mackey 2-8-07  
This authorization expires: 8-8-07  
(This authorization void if drilling not started within 6 months of approval date.)  
Spud date: \_\_\_\_\_ Agent: \_\_\_\_\_

**Remember to:**

- File Drill Pit Application (form CDP-1) with Intent to Drill;
- File Completion Form ACO-1 within 120 days of spud date;
- File acreage attribution plat according to field proration orders;
- Notify appropriate district office 48 hours prior to workover or re-entry;
- Submit plugging report (CP-4) after plugging is completed;
- Obtain written approval before disposing or injecting salt water.

If this permit has expired (See: authorized expiration date) please check the box below and return to the address below.

Well Not Drilled - Permit Expired

Signature of Operator or Agent: \_\_\_\_\_

Date: \_\_\_\_\_

RECEIVED  
Mall to: KCC - Conservation Division, 130 S. Market - Room 2078, Wichita, KANSAS CORPORATION COMMISSION

FEB 07 2007

CONSERVATION DIVISION  
WICHITA, KS

**IN ALL CASES PLOT THE INTENDED WELL ON THE PLAT BELOW**

*Plat of acreage attributable to a well in a prorated or spaced field*

**If the intended well is in a prorated or spaced field, please fully complete this side of the form.** If the intended well is in a prorated or spaced field complete the plat below showing that the well will be properly located in relationship to other wells producing from the common source of supply. Please show all the wells and within 1 mile of the boundaries of the proposed acreage attribution unit for gas wells and within 1/2 mile of the boundaries of the proposed acreage attribution unit for oil wells.

API No. 15 - 051-25614-0000  
 Operator: Venture Resources, Inc.  
 Lease: Ridler G  
 Well Number: 6  
 Field: Bemis-Shutts  
 Number of Acres attributable to well: 10  
 QTR / QTR / QTR of acreage: NE - SE - SW

Location of Well: County: Ellis  
 893' \_\_\_\_\_ feet from  N /  S Line of Section  
 2310' \_\_\_\_\_ feet from  E /  W Line of Section  
 Sec. 1 Twp. 11S S. R. 18W  East  West

Is Section:  Regular or  Irregular

**If Section is irregular, locate well from nearest corner boundary.**  
 Section corner used:  NE  NW  SE  SW

**PLAT**

*(Show location of the well and shade attributable acreage for prorated or spaced wells.)  
 (Show footage to the nearest lease or unit boundary line.)*

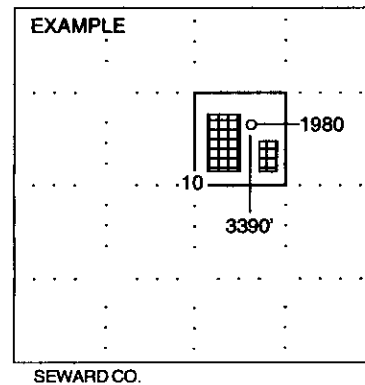
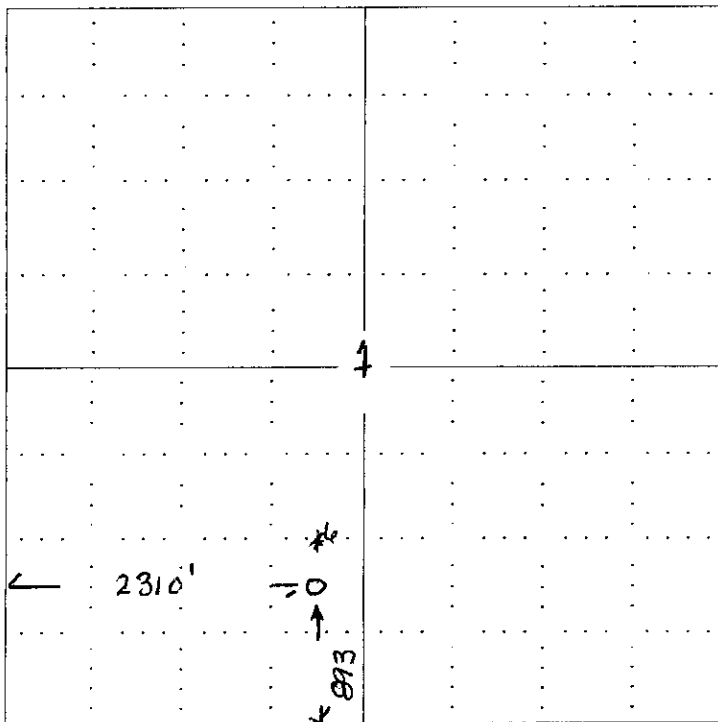

**NOTE: In all cases locate the spot of the proposed drilling location.**

**In plotting the proposed location of the well, you must show:**

1. The manner in which you are using the depicted plat by identifying section lines, i.e. 1 section, 1 section with 8 surrounding sections, 4 sections, etc.
2. The distance of the proposed drilling location from the section's south / north and east / west.
3. The distance to the nearest lease or unit boundary line.
4. If proposed location is located within a prorated or spaced field a certificate of acreage attribution plat must be attached: (CO-7 for oil wells; CG-8 for gas wells).

**RECEIVED**  
 KANSAS CORPORATION COMMISSION

**FEB 07 2007**

CONSERVATION DIVISION  
 WICHITA, KS

**KANSAS CORPORATION COMMISSION  
OIL & GAS CONSERVATION DIVISION  
APPLICATION FOR SURFACE PIT**

Form CDP-1  
April 2004  
Form must be Typed

*Submit in Duplicate*

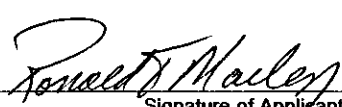
Operator Name: <b>Venture Resources, Inc.</b>		License Number: <b>30537</b>
Operator Address: <b>P. O. Box 101234 Denver CO. 80250</b>		
Contact Person: <b>Ron Mackey</b>		Phone Number: ( <b>303</b> ) <b>722 - 2899</b>
Lease Name & Well No.: <b>Ridler G #6</b>		Pit Location (QQQQ): _____ <b>NE</b> _____ <b>SE</b> _____ <b>SW</b> Sec. <b>1</b> Twp. <b>11S</b> R. <b>18W</b> <input type="checkbox"/> East <input checked="" type="checkbox"/> West <b>893'</b> Feet from <input type="checkbox"/> North / <input checked="" type="checkbox"/> South Line of Section <b>2310'</b> Feet from <input type="checkbox"/> East / <input checked="" type="checkbox"/> West Line of Section <b>Ellis</b> County
Type of Pit: <input type="checkbox"/> Emergency Pit <input type="checkbox"/> Burn Pit <input type="checkbox"/> Settling Pit <input checked="" type="checkbox"/> Drilling Pit <input type="checkbox"/> Workover Pit <input type="checkbox"/> Haul-Off Pit <small>(If WP Supply API No. or Year Drilled)</small>	Pit is: <input checked="" type="checkbox"/> Proposed <input type="checkbox"/> Existing If Existing, date constructed: _____ Pit capacity: <b>1000</b> (bbls)	
Is the pit located in a Sensitive Ground Water Area? <input type="checkbox"/> Yes <input checked="" type="checkbox"/> No		Chloride concentration: <b>30000</b> mg/l <small>(For Emergency Pits and Settling Pits only)</small>
Is the bottom below ground level? <input checked="" type="checkbox"/> Yes <input type="checkbox"/> No	Artificial Liner? <input type="checkbox"/> Yes <input checked="" type="checkbox"/> No	How is the pit lined if a plastic liner is not used? <b>Natural clays and mud</b>
Pit dimensions (all but working pits): <b>100</b> Length (feet) <b>50</b> Width (feet) _____ N/A: <b>Steel Pits</b> Depth from ground level to deepest point: <b>6</b> (feet)		
If the pit is lined give a brief description of the liner material, thickness and installation procedure. <b>NA</b>		Describe procedures for periodic maintenance and determining liner integrity, including any special monitoring. <b>NA</b>
Distance to nearest water well within one-mile of pit _____ <b>NA</b> <b>528</b> feet    Depth of water well _____ <b>NA</b> <b>75</b> feet		Depth to shallowest fresh water <b>NA</b> <b>15</b> feet. Source of information: _____ measured _____ well owner <b>(b)</b> electric log _____ KDWR
<b>Emergency, Settling and Burn Pits ONLY:</b> Producing Formation: _____ Number of producing wells on lease: _____ Barrels of fluid produced daily: _____ Does the slope from the tank battery allow all spilled fluids to flow into the pit? <input type="checkbox"/> Yes <input type="checkbox"/> No		<b>Drilling, Workover and Haul-Off Pits ONLY:</b> Type of material utilized in drilling/workover: <b>Native and natural mud</b> Number of working pits to be utilized: <b>3</b> Abandonment procedure: <b>Hauled liquids to swd and refill with original soils</b> Drill pits must be closed within 365 days of spud date.
I hereby certify that the above statements are true and correct to the best of my knowledge and belief.		
_____ 2-05-07 Date	 _____ Signature of Applicant or Agent	

15-051-25614-000

KCC OFFICE USE ONLY			
Date Received: <b>2/7/07</b>	Permit Number: _____	Permit Date: <b>2/7/07</b>	Lease Inspection: <input type="checkbox"/> Yes <input checked="" type="checkbox"/> No

Mail to: KCC - Conservation Division, 130 S. Market - Room 2078, Wichita, Kansas 67202

**RECEIVED**  
**KANSAS CORPORATION COMMISSION**  
**FEB 07 2007**  
 CONSERVATION DIVISION  
 WICHITA, KS