

For KCC Use: 2-14-07  
 Effective Date: \_\_\_\_\_  
 District # \_\_\_\_\_  
 SGA?  Yes  No

KANSAS CORPORATION COMMISSION  
 OIL & GAS CONSERVATION DIVISION  
**NOTICE OF INTENT TO DRILL**

Form C-1  
 December 2002  
**Form must be Typed**  
**Form must be Signed**  
**All blanks must be Filled**

Must be approved by KCC five (5) days prior to commencing well

Expected Spud Date February 25 2007

Spot \_\_\_\_\_ East   
 \_\_\_\_\_ West   
 C - NW - NW Sec. 17 Twp. 35 S. R. 43  
660' feet from  N /  S Line of Section  
660' feet from  E /  W Line of Section  
 Is SECTION  Regular  Irregular?

OPERATOR: License# 31722  
 Name: Glacier Petroleum Company, OKLA, Inc.  
 Address: 9400 North Broadway Extension, Suite 610  
 City/State/Zip: Oklahoma City, Oklahoma 73114  
 Contact Person: Kit Throgmorton  
 Phone: 405-840-2625

County: Morton  
 Lease Name: Grassland Well #: 1-17  
 Field Name: Elkhart West

CONTRACTOR: License# 30606  
 Name: Murfin Drilling Company

Is this a Prorated / Spaced Field?  Yes  No  
 Target Formation(s): Permian Sands, Morrow, Purdy (A), Purdy (B)  
 Nearest Lease or unit boundary: 660'

Well Drilled For:  Oil  Enh Rec  Infield  Pool Ext.  Mud Rotary  Air Rotary  Cable  
 Gas  Storage  Wildcat  Cable  
 OWWO  Disposal  Wildcat  Cable  
 Seismic; \_\_\_\_\_ # of Holes  Other  
 Other \_\_\_\_\_

Ground Surface Elevation: 3650 feet MSL  
 Water well within one-quarter mile:  Yes  No  
 Public water supply well within one mile:  Yes  No

Depth to bottom of fresh water: 280'  
 Depth to bottom of usable water: 280'  
 Surface Pipe by Alternate:  1  2

Length of Surface Pipe Planned to be set: 1400'  
 Length of Conductor Pipe required: None  
 Projected Total Depth: 5000'  
 Formation at Total Depth: Mississippi

Water Source for Drilling Operations:  
 Well  Farm Pond  Other Truck from city water  
 DWR Permit #: NA

(Note: Apply for Permit with DWR)   
 Will Cores be taken?  Yes  No  
 If Yes, proposed zone: \_\_\_\_\_

If OWWO: old well information as follows:  
 Operator: \_\_\_\_\_  
 Well Name: \_\_\_\_\_  
 Original Completion Date: \_\_\_\_\_ Original Total Depth: \_\_\_\_\_

Directional, Deviated or Horizontal wellbore?  Yes  No

If Yes, true vertical depth: \_\_\_\_\_

Bottom Hole Location: \_\_\_\_\_

KCC DKT #: \_\_\_\_\_

\* PRORATED & SPACED HOBOTON & GREENWOOD \*

**AFFIDAVIT**

The undersigned hereby affirms that the drilling, completion and eventual plugging of this well will comply with K.S.A. 55 et. seq.  
 It is agreed that the following minimum requirements will be met:

1. Notify the appropriate district office **prior** to spudding of well;
2. A copy of the approved notice of intent to drill **shall be** posted on each drilling rig;
3. The minimum amount of surface pipe as specified below **shall be set** by circulating cement to the top; in all cases surface pipe **shall be set** through all unconsolidated materials plus a minimum of 20 feet into the underlying formation.
4. If the well is dry hole, an agreement between the operator and the district office on plug length and placement is necessary **prior to plugging**;
5. The appropriate district office will be notified before well is either plugged or production casing is cemented in;
6. If an ALTERNATE II COMPLETION, production pipe shall be cemented from below any usable water to surface within **120 days** of spud date.  
 Or pursuant to Appendix "B" - Eastern Kansas surface casing order #133,891-C, which applies to the KCC District 3 area, alternate II cementing must be completed within 30 days of the spud date or the well shall be plugged. **In all cases, NOTIFY district office** prior to any cementing.

I hereby certify that the statements made herein are true and to the best of my knowledge and belief.

Date: 2-7-07 Signature of Operator or Agent: \_\_\_\_\_ Title: President

**Remember to:**

- File Drill Pit Application (form CDP-1) with Intent to Drill;
- File Completion Form ACO-1 within 120 days of spud date;
- File acreage attribution plat according to field proration orders;
- Notify appropriate district office 48 hours prior to workover or re-entry;
- Submit plugging report (CP-4) after plugging is completed;
- Obtain written approval before disposing or injecting salt water.
- If this permit has expired (See: authorized expiration date) please check the box below and return to the address below.

Well Not Drilled - Return to KANSAS CORPORATION COMMISSION  
 Signature of Operator or Agent: \_\_\_\_\_  
 Date: FEB 08 2007

For KCC Use ONLY  
 API # 15 - 129-21795-0000  
 Conductor pipe required None feet  
 Minimum surface pipe required 300 feet per Alt. 1  
 Approved by: Kit 2-9-07  
 This authorization expires: 8-9-07  
 (This authorization void if drilling not started within 6 months of approval date.)  
 Spud date: \_\_\_\_\_ Agent: \_\_\_\_\_

RECEIVED

FEB 09 2007

KCC WICHITA

17  
35  
43W

# IN ALL CASES PLOT THE INTENDED WELL ON THE PLAT BELOW

*Plat of acreage attributable to a well in a prorated or spaced field*

*If the intended well is in a prorated or spaced field, please fully complete this side of the form.* If the intended well is in a prorated or spaced field complete the plat below showing that the well will be properly located in relationship to other wells producing from the common source of supply. Please show all the wells and within 1 mile of the boundaries of the proposed acreage attribution unit for gas wells and within 1/2 mile of the boundaries of the proposed acreage attribution unit for oil wells.

API No. 15 - 129-21795-0000  
 Operator: Glacier Petroleum Company, OKLA, Inc.  
 Lease: Grassland  
 Well Number: 1-17  
 Field: Elkhart West  
 Number of Acres attributable to well: \_\_\_\_\_  
 QTR / QTR / QTR of acreage: C - NW - NW

Location of Well: County: Morton  
660' feet from  N /  S Line of Section  
660' feet from  E /  W Line of Section  
 Sec. 17 Twp. 35 S. R. 43  East  West  
 Is Section:  Regular or  Irregular  
 If Section is Irregular, locate well from nearest corner boundary.  
 Section corner used:  NE  NW  SE  SW

## PLAT

(Show location of the well and shade attributable acreage for prorated or spaced wells.)  
 (Show footage to the nearest lease or unit boundary line.)

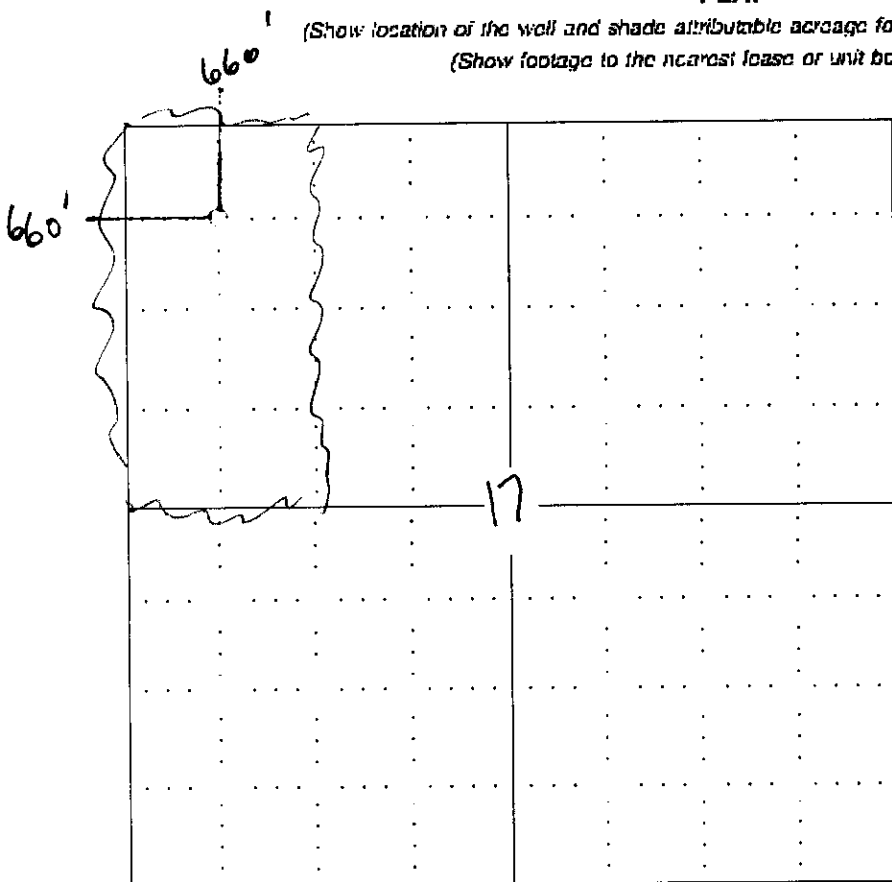

RECEIVED  
 FEB 09 2007  
 KCC WICHITA

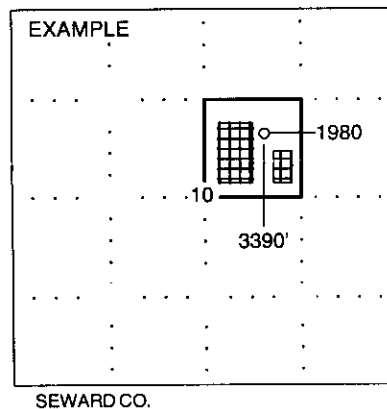

SEWARD CO.

NOTE: In all cases locate the spot of the proposed drilling location.

### In plotting the proposed location of the well, you must show:

1. The manner in which you are using the depicted plat by identifying section lines, i.e. 1 section, 1 section with 8 surrounding sections, 4 sections, etc.
2. The distance of the proposed drilling location from the section's south / north and east / west.
3. The distance to the nearest lease or unit boundary line.
4. If proposed location is located within a prorated or spaced field a certificate of acreage attribution plat must be attached: (CO-7 for oil wells; CG-8 for gas wells).

RECEIVED  
 KANSAS CORPORATION COMMISSION  
 FEB 08 2007  
 CONSERVATION DIVISION  
 WICHITA, KS

**KANSAS CORPORATION COMMISSION  
OIL & GAS CONSERVATION DIVISION  
APPLICATION FOR SURFACE PIT**

Form CDP-1  
April 2004  
Form must be Typed

*Submit in Duplicate*

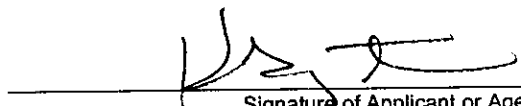
Operator Name: <b>Glacier Petroleum Company, OKLA, INC</b>		License Number: <b>31722</b>
Operator Address: <b>9400 North Broadway Ext., Suite 610</b>		
Contact Person: <b>Kit Throgmorton</b>		Phone Number: <b>( 405 ) 840 - 2625</b>
Lease Name & Well No.: <b>Glassland 1-17</b>		Pit Location (QQQQ): <b>C . NW . NW .</b>
Type of Pit: <input type="checkbox"/> Emergency Pit <input type="checkbox"/> Burn Pit <input type="checkbox"/> Settling Pit <input checked="" type="checkbox"/> Drilling Pit <input type="checkbox"/> Workover Pit <input type="checkbox"/> Haul-Off Pit <small>(If W/P Supply API No. or Year Drilled)</small>	Pit is: <input checked="" type="checkbox"/> Proposed <input type="checkbox"/> Existing If Existing, date constructed: _____ Pit capacity: <b>8900</b> (bbls)	Sec. <b>17</b> Twp. <b>35S</b> R. <b>43</b> <input type="checkbox"/> East <input checked="" type="checkbox"/> West <b>500</b> Feet from <input checked="" type="checkbox"/> North / <input type="checkbox"/> South Line of Section <b>500</b> Feet from <input type="checkbox"/> East / <input checked="" type="checkbox"/> West Line of Section <b>Morton</b> County
Is the pit located in a Sensitive Ground Water Area? <input checked="" type="checkbox"/> Yes <input checked="" type="checkbox"/> No		Chloride concentration: <b>na</b> mg/l <small>(For Emergency Pits and Settling Pits only)</small>
Is the bottom below ground level? <input checked="" type="checkbox"/> Yes <input type="checkbox"/> No	Artificial Liner? <input type="checkbox"/> Yes <input checked="" type="checkbox"/> No	How is the pit lined if a plastic liner is not used? <b>soil compaction</b>
Pit dimensions (all but working pits): <b>100</b> Length (feet) <b>100</b> Width (feet) <b>N/A: Steel Pits</b> Depth from ground level to deepest point: <b>5</b> (feet)		
If the pit is lined give a brief description of the liner material, thickness and installation procedure.		Describe procedures for periodic maintenance and determining liner integrity, including any special monitoring.
Distance to nearest water well within one-mile of pit <b>4443</b> feet    Depth of water well <b>312</b> feet		Depth to shallowest fresh water <b>200</b> feet. <span style="float:right">6</span> Source of information: <b>JR-KGS</b> _____ measured _____ well owner _____ electric log _____ KDWR
<b>Emergency, Settling and Burn Pits ONLY:</b> Producing Formation: _____ Number of producing wells on lease: _____ Barrels of fluid produced daily: _____ Does the slope from the tank battery allow all spilled fluids to flow into the pit? <input type="checkbox"/> Yes <input type="checkbox"/> No		<b>Drilling, Workover and Haul-Off Pits ONLY:</b> Type of material utilized in drilling/workover: <b>Fresh Water Mud</b> Number of working pits to be utilized: <b>ONE</b> Abandonment procedure: <b>Dewater and Backfill</b> _____ Drill pits must be closed within 365 days of spud date.
I hereby certify that the above statements are true and correct to the best of my knowledge and belief.		
<b>2-7-07</b> Date	 Signature of Applicant or Agent	<b>RECEIVED</b> <b>FEB 09 2007</b> <b>KCC WICHITA</b>

15-129-21795-000  
0000-5612-6812

**KCC OFFICE USE ONLY**

Date Received: **2/9/07** Permit Number: \_\_\_\_\_ Permit Date: **2/9/07** Lease Inspection:  Yes  No

Mail to: KCC - Conservation Division, 130 S. Market - Room 2078, Wichita, Kansas 67202