

For KCC Use: Effective Date: 2-14-07 District # 3 SGA?  Yes  No

KANSAS CORPORATION COMMISSION OIL & GAS CONSERVATION DIVISION NOTICE OF INTENT TO DRILL

Must be approved by KCC five (5) days prior to commencing well

CORRECTED

Expected Spud Date February 13, 2007 month day year

OPERATOR: License# 33344 Name: Quest Cherokee LLC Address: 9520 North May Avenue, Suite 300 City/State/Zip: Oklahoma City, Oklahoma 73120 Contact Person: Richard Marlin Phone: (405) 288-9316

CONTRACTOR: License# Will be licensed by the KCC Name: Will advise on the ACO-1

Well Drilled For: Well Class: Type Equipment: Oil, Gas, CWMO, Seismic, Other Coalbed Methane, Enh Rec, Storage, Disposal, Infield, Pool Ext, Wildcat, Other, Mud Rotary, Air Rotary, Cable

If OWWO: old well information as follows: Operator: Well Name: Original Completion Date: Original Total Depth:

Directional, Deviated or Horizontal wellbore? Yes No

If Yes, true vertical depth:

Bottom Hole Location:

KCC DKT #:

Spot SE NW Sec. 24 Twp. 29 S. R. 19 East West

1820 feet from N S Line of Section 1890 1850 feet from E W Line of Section

Is SECTION Regular Irregular?

(Note: Locate well on the Section Plat on reverse side)

County: Neosho

Lease Name: Knight, Joe D. Well #: 24-1

Field Name: Cherokee Basin CBM

Is this a Prorated / Spaced Field? Yes No

Target Formation(s): Cherokee Coals

Nearest Lease or unit boundary: 370

Ground Surface Elevation: 894 feet MSL

Water well within one-quarter mile: Yes No

Public water supply well within one mile: Yes No

Depth to bottom of fresh water: 100

Depth to bottom of usable water: 150

Surface Pipe by Alternate: 1 2

Length of Surface Pipe Planned to be set: 25

Length of Conductor Pipe required:

Projected Total Depth: Cherokee Coals

Formation at Total Depth: 1500

Water Source for Drilling Operations: Well Farm Pond Other Air

DWR Permit #:

(Note: Apply for Permit with DWR)

Will Cores be taken? Yes No

If Yes, proposed zone:

\* WAS: 1890 FWL IS: 1850 FWL

AFFIDAVIT

The undersigned hereby affirms that the drilling, completion and eventual plugging of this well will comply with K.S.A. 55 et. seq.

It is agreed that the following minimum requirements will be met:

- 1. Notify the appropriate district office prior to spudding of well; 2. A copy of the approved notice of intent to drill shall be posted on each drilling rig; 3. The minimum amount of surface pipe as specified below shall be set by circulating cement to the top; in all cases surface pipe shall be set through all unconsolidated materials plus a minimum of 20 feet into the underlying formation. 4. If the well is dry hole, an agreement between the operator and the district office on plug length and placement is necessary; 5. The appropriate district office will be notified before well is either plugged or production casing is cemented in; 6. If an ALTERNATE II COMPLETION, production pipe shall be cemented from below any usable water to surface within 120 days of spud date. Or pursuant to Appendix "B" - Eastern Kansas surface casing order #133,891-C, which applies to the KCC District 3 area, alternate II cementing must be completed within 30 days of the spud date or the well shall be plugged. In all cases, NOTIFY district office prior to any cementing.

I hereby certify that the statements made herein are true and to the best of my knowledge and belief.

Date: February 6, 2007 Signature of Operator or Agent: Richard Marlin Title: VP

RECEIVED KANSAS CORPORATION COMMISSION FEB 15 2007 CONSERVATION DIVISION WICHITA, KS

For KCC Use ONLY API # 15 - 133-26809-0000 Conductor pipe required None feet Minimum surface pipe required 20 feet per Alt. Approved by: [Signature] This authorization expires: 8-9-07 Spud date: Agent:

- Remember to: - File Drill Pit Application (form CDP-1) with Intent to Drill; - File Completion Form ACO-1 within 120 days of spud date; - File acreage attribution plat according to field proration orders; - Notify appropriate district office 48 hours prior to workover or re-entry; - Submit plugging report (CP-4) after plugging is completed; - Obtain written approval before disposing or injecting salt water.

If this permit has expired (See: authorized expiration date) please check the box below and return to the address below. Well Not Drilled - Permit Expired Signature of Operator or Agent:

Date: FEB 08 2007

Mail to: KCC - Conservation Division, 130 S. Market - Room 2078, Wichita, Kansas 67202

CONSERVATION DIVISION WICHITA, KS

24 29 19E

CORRECTED

**IN ALL CASES PLOT THE INTENDED WELL ON THE PLAT BELOW**

*Plat of acreage attributable to a well in a prorated or spaced field*

*If the intended well is in a prorated or spaced field, please fully complete this side of the form. If the intended well is in a prorated or spaced field complete the plat below showing that the well will be properly located in relationship to other wells producing from the common source of supply. Please show all the wells and within 1 mile of the boundaries of the proposed acreage attribution unit for gas wells and within 1/2 mile of the boundaries of the proposed acreage attribution unit for oil wells.*

API No. 15 - 133-26809-000  
Operator: Quest Cherokee LLC  
Lease: Knight, Joe D.  
Well Number: 24-1  
Field: Cherokee Basin CBM

Number of Acres attributable to well: \_\_\_\_\_  
QTR / QTR / QTR of acreage: \_\_\_\_\_ SE \_\_\_\_\_ NW

Location of Well: County: Neosho  
1820 \_\_\_\_\_ feet from  N /  S Line of Section  
~~1820~~ 1850 \_\_\_\_\_ feet from  E /  W Line of Section  
Sec. 24 Twp. 29 S. R. 19  East  West

Is Section:  Regular or  Irregular

If Section is Irregular, locate well from nearest corner boundary.

Section corner used:  NE  NW  SE  SW

**PLAT**

*(Show location of the well and shade attributable acreage for prorated or spaced wells.)  
(Show footage to the nearest lease or unit boundary line.)*

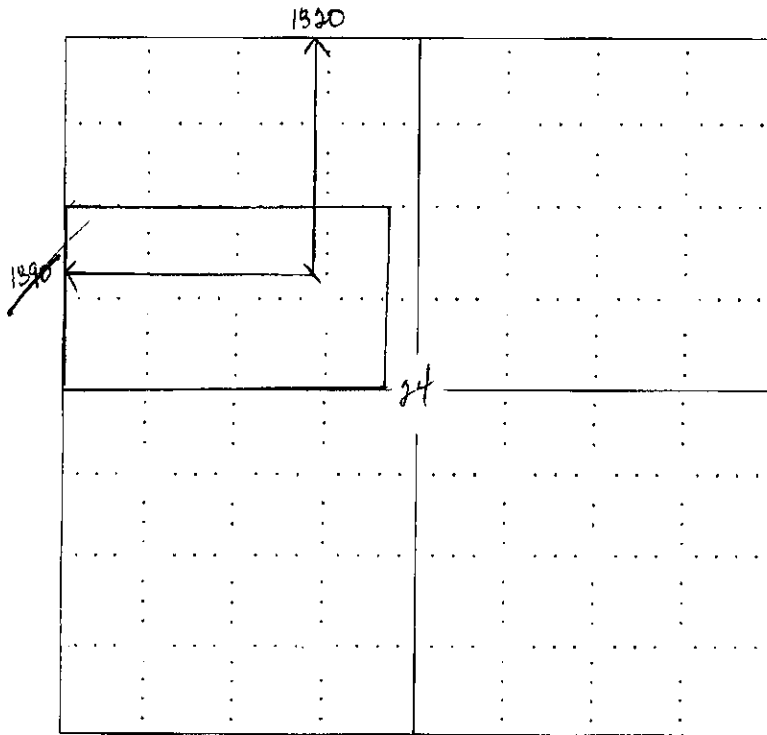

RECEIVED  
KANSAS CORPORATION COMMISSION  
FEB 15 2007  
CONSERVATION DIVISION  
WICHITA, KS

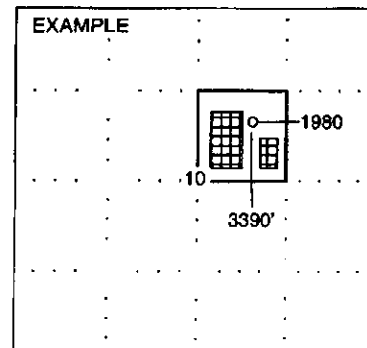

**NOTE: In all cases locate the spot of the proposed drilling location.**

**In plotting the proposed location of the well, you must show:**

1. The manner in which you are using the depicted plat by identifying section lines, i.e. 1 section, 1 section with 8 surrounding sections, 4 sections, etc.
2. The distance of the proposed drilling location from the section's south / north and east / west.
3. The distance to the nearest lease or unit boundary line.
4. If proposed location is located within a prorated or spaced field a certificate of acreage attribution plat must be attached: (CO-7 for oil wells; CG-8 for gas wells).

KANSAS CORPORATION COMMISSION  
OIL & GAS CONSERVATION DIVISION  
APPLICATION FOR SURFACE PIT

RECEIVED  
KANSAS CORPORATION COMMISSION  
FEB 15 2007  
Form CDP-1  
April 2004  
Form must be Typed

CONSERVATION DIVISION  
WICHITA, KS

Submit in Duplicate

Operator Name: <b>Quest Cherokee LLC</b>		License Number: <b>33344</b>	
Operator Address: <b>9520 North May Avenue, Suite 300 Oklahoma City, Oklahoma 73120</b>			
Contact Person: <b>Richard Marlin</b>		Phone Number: <b>( 405 ) 286 - 9316</b>	
Lease Name & Well No.: <b>Knight, Joe D. #24-1</b>		Pit Location (QQQQ): _____ SE _____ NW	
Type of Pit: <input type="checkbox"/> Emergency Pit <input type="checkbox"/> Burn Pit <input type="checkbox"/> Settling Pit <input checked="" type="checkbox"/> Drilling Pit <input type="checkbox"/> Workover Pit <input type="checkbox"/> Haul-Off Pit (If WP Supply API No. or Year Drilled)		Pit is: <input checked="" type="checkbox"/> Proposed <input type="checkbox"/> Existing If Existing, date constructed: _____ Pit capacity: <b>300</b> (bbis)	
Is the pit located in a Sensitive Ground Water Area? <input type="checkbox"/> Yes <input checked="" type="checkbox"/> No		Chloride concentration: _____ mg/l (For Emergency Pits and Settling Pits only)	
Is the bottom below ground level? <input type="checkbox"/> Yes <input checked="" type="checkbox"/> No		Artificial Liner? <input type="checkbox"/> Yes <input checked="" type="checkbox"/> No	
How is the pit lined if a plastic liner is not used?			
Pit dimensions (all but working pits): <b>30</b> Length (feet) <b>10</b> Width (feet) _____ N/A: Steel Pits Depth from ground level to deepest point: <b>10</b> (feet)			
If the pit is lined give a brief description of the liner material, thickness and installation procedure.		Describe procedures for periodic maintenance and determining liner integrity, including any special monitoring. <b>Air Drilling Operation lasting approx 3 days</b>	
Distance to nearest water well within one-mile of pit <b>3665</b> feet    Depth of water well <b>7</b> feet		Depth to shallowest fresh water _____ feet. Source of information: _____ measured _____ well owner <b>(10)</b> electric log _____ KQWR	
<b>Emergency, Settling and Burn Pits ONLY:</b> Producing Formation: _____ Number of producing wells on lease: _____ Barrels of fluid produced daily: _____ Does the slope from the tank battery allow all spilled fluids to flow into the pit? <input type="checkbox"/> Yes <input type="checkbox"/> No		<b>Drilling, Workover and Haul-Off Pits ONLY:</b> Type of material utilized in drilling/workover: <b>Air Drilled</b> Number of working pits to be utilized: <b>One</b> Abandonment procedure: <b>Air Dry, Back Fill and Cover</b> Drill pits must be closed within 365 days of spud date.	
I hereby certify that the above statements are true and correct to the best of my knowledge and belief.			
February 7, 2007 Date		RECEIVED KANSAS CORPORATION COMMISSION FEB 08 2007 Signature of Applicant or Agent: <b>Richard Marlin</b> CONSERVATION DIVISION WICHITA, KS	
<b>KCC OFFICE USE ONLY</b>			
- DIST			
Date Received: <b>2/8/07</b> Permit Number: _____ Permit Date: <b>2/9/07</b> Lease Inspection: <input type="checkbox"/> Yes <input checked="" type="checkbox"/> No			

Mall to: KCC - Conservation Division, 130 S. Market - Room 2078, Wichita, Kansas 67202

CORRECTED

15-133-26809-0000