



For KCC Use: 3-4-07
 Effective Date: _____
 District # 3
 SGA? Yes No

KANSAS CORPORATION COMMISSION 1008080
 OIL & GAS CONSERVATION DIVISION

Form C-1
 November 2005
Form must be Typed
Form must be Signed
All blanks must be Filled

NOTICE OF INTENT TO DRILL

Must be approved by KCC five (5) days prior to commencing well

Expected Spud Date: 03/05/2007
 month day year

OPERATOR: License# 5135
 Name: Farmer, John O., Inc.
 Address 1: 370 W Wichita Ave
 Address 2: PO Box 352
 City: Russell State: KS Zip: 67665 + 2635
 Contact Person: John Farmer IV
 Phone: 785-483-3144

CONTRACTOR: License# 32854
 Name: Gulick Drilling Co., Inc.

Well Drilled For:	Well Class:	Type Equipment:
<input checked="" type="checkbox"/> Oil	<input type="checkbox"/> Enh Rec	<input checked="" type="checkbox"/> Mud Rotary
<input type="checkbox"/> Gas	<input type="checkbox"/> Storage	<input type="checkbox"/> Air Rotary
<input type="checkbox"/> Seismic ; _____ # of Holes	<input type="checkbox"/> Disposal	<input type="checkbox"/> Cable
<input type="checkbox"/> Other: _____	<input checked="" type="checkbox"/> Infield	
	<input type="checkbox"/> Pool Ext.	
	<input type="checkbox"/> Wildcat	
	<input type="checkbox"/> Other	

If OWWO: old well information as follows:

Operator: _____
 Well Name: _____
 Original Completion Date: _____ Original Total Depth: _____

Directional, Deviated or Horizontal wellbore? Yes No
 If Yes, true vertical depth: _____
 Bottom Hole Location: _____
 KCC DKT #: _____

Spot Description: 105' N & 95' W
 NW - SE - SE - NE Sec. 14 Twp. 15 S. R. 9 E W
 (a/a/a/a) 2,040 feet from N / S Line of Section
590 feet from E / W Line of Section

Is SECTION: Regular Irregular?
 (Note: Locate well on the Section Plat on reverse side)

County: Wabaunsee
 Lease Name: Johnson Well #: 1
 Field Name: Wildcat

Is this a Prorated / Spaced Field? Yes No
 Target Formation(s): Viola, Simpson

Nearest Lease or unit boundary line (in footage): 590
 Ground Surface Elevation: 1427 feet MSL

Water well within one-quarter mile: Yes No
 Public water supply well within one mile: Yes No

Depth to bottom of fresh water: 120
 Depth to bottom of usable water: 280

Surface Pipe by Alternate: I II
 Length of Surface Pipe Planned to be set: 300

Length of Conductor Pipe (if any): 0
 Projected Total Depth: 3400
 Formation at Total Depth: Simpson

Water Source for Drilling Operations:
 Well Farm Pond Other: _____
 DWR Permit #: _____

(Note: Apply for Permit with DWR)
 Will Cores be taken? Yes No
 If Yes, proposed zone: _____

AFFIDAVIT

The undersigned hereby affirms that the drilling, completion and eventual plugging of this well will comply with K.S.A. 55 et. seq.
 It is agreed that the following minimum requirements will be met:

1. Notify the appropriate district office **prior** to spudding of well;
2. A copy of the approved notice of intent to drill **shall be** posted on each drilling rig;
3. The minimum amount of surface pipe as specified below **shall be set** by circulating cement to the top; in all cases surface pipe **shall be set** through all unconsolidated materials plus a minimum of 20 feet into the underlying formation.
4. If the well is dry hole, an agreement between the operator and the district office on plug length and placement is necessary **prior to plugging**;
5. The appropriate district office will be notified before well is either plugged or production casing is cemented in;
6. If an ALTERNATE II COMPLETION, production pipe shall be cemented from below any usable water to surface within **120 DAYS** of spud date. Or pursuant to Appendix "B" - Eastern Kansas surface casing order #133,891-C, which applies to the KCC District 3 area, alternate II cementing must be completed within 30 days of the spud date or the well shall be plugged. **In all cases, NOTIFY district office** prior to any cementing.

I hereby certify that the statements made herein are true and to the best of my knowledge and belief.

Date: 2/22/2007 Signature of Operator or Agent: [Signature] Title: Gulick

For KCC Use ONLY
 API # 15 - 197-20269-0000
 Conductor pipe required 0 feet
 Minimum surface pipe required 300 feet per ALT. I II
 Approved by: [Signature]
 This authorization expires: 8-27-07
 (This authorization void if drilling not started within 6 months of approval date.)
 Spud date: _____ Agent: _____

Remember to:

- File Drill Pit Application (form CDP-1) with Intent to Drill;
- File Completion Form ACO-1 within 120 days of spud date;
- File acreage attribution plat according to field proration orders;
- Notify appropriate district office 48 hours prior to workover or re-entry;
- Submit plugging report (CP-4) after plugging is completed (within 60 days);
- Obtain written approval before disposing or injecting salt water.
- If this permit has expired (See: authorized expiration date) please check the box below and return to the address below.

Well Not Drilled - Permit Expired Date: _____
 Signature of Operator or Agent: _____

14
15
9
 E
 W

Mail to: KCC - Conservation Division, 130 S. Market - Room 2078, Wichita, Kansas 67202

RECEIVED
 FEB 26 2007
 KCC WICHITA



1008080

IN ALL CASES PLOT THE INTENDED WELL ON THE PLAT BELOW

Plat of acreage attributable to a well in a prorated or spaced field

If the intended well is in a prorated or spaced field, please fully complete this side of the form. If the intended well is in a prorated or spaced field complete the plat below showing that the well will be properly located in relationship to other wells producing from the common source of supply. Please show all the wells and within 1 mile of the boundaries of the proposed acreage attribution unit for gas wells and within 1/2 mile of the boundaries of the proposed acreage attribution unit for oil wells.

API No. 15 - 197-20269-0000
Operator: Farmer, John O., Inc.
Lease: Johnson
Well Number: 1
Field: Wildcat

Location of Well: County: Wabaunsee
2,040 feet from N / S Line of Section
590 feet from E / W Line of Section
Sec. 14 Twp. 15 S. R. 9 E W

Number of Acres attributable to well: _____
QTR/QTR/QTR/QTR of acreage: NW - SE - SE - NE

Is Section: Regular or Irregular

If Section is Irregular, locate well from nearest corner boundary.

Section corner used: NE NW SE SW

PLAT

(Show location of the well and shade attributable acreage for prorated or spaced wells.)

(Show footage to the nearest lease or unit boundary line.)

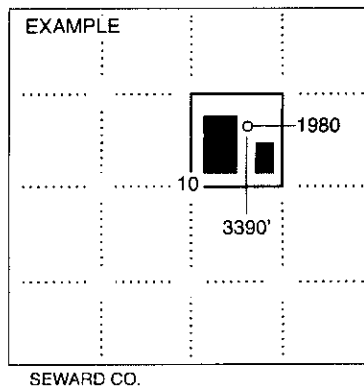
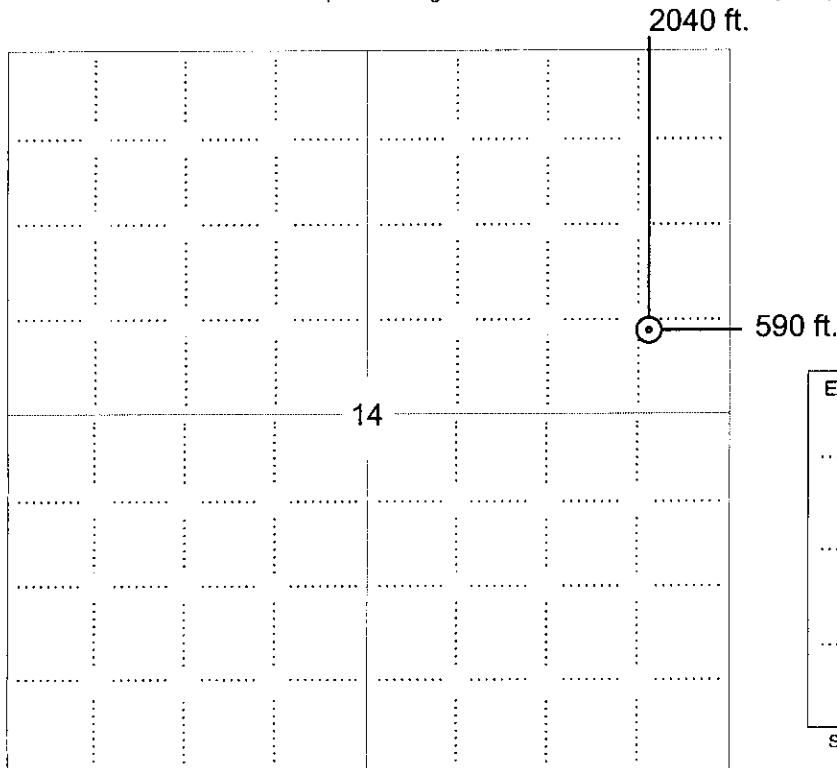

NOTE: In all cases locate the spot of the proposed drilling location.

In plotting the proposed location of the well, you must show:

1. The manner in which you are using the depicted plat by identifying section lines, i.e. 1 section, 1 section with 8 surrounding sections, 4 sections, etc.
2. The distance of the proposed drilling location from the south / north and east / west outside section lines.
3. The distance to the nearest lease or unit boundary line (in footage).
4. If proposed location is located within a prorated or spaced field a certificate of acreage attribution plat must be attached: (CO-7 for oil wells; CG-8 for gas wells).

RECEIVED
FEB 26 2007
KCC WICHITA



KANSAS CORPORATION COMMISSION 1008080
OIL & GAS CONSERVATION DIVISION

Form CDP-1
April 2004
Form must be Typed

APPLICATION FOR SURFACE PIT

Submit in Duplicate

Operator Name: Farmer, John O., Inc.		License Number: 5135	
Operator Address: 370 W Wichita Ave		PO Box 352 Russell KS 67665	
Contact Person: John Farmer IV		Phone Number: 785-483-3144	
Lease Name & Well No.: Johnson 1		Pit Location (QQQQ): NW SE SE NE	
Type of Pit: <input type="checkbox"/> Emergency Pit <input type="checkbox"/> Burn Pit <input type="checkbox"/> Settling Pit <input checked="" type="checkbox"/> Drilling Pit <input type="checkbox"/> Workover Pit <input type="checkbox"/> Haul-Off Pit <small>(If WP Supply API No. or Year Drilled)</small>	Pit is: <input checked="" type="checkbox"/> Proposed <input type="checkbox"/> Existing If Existing, date constructed: _____ Pit capacity: 3,000 (bbls)	Sec. 14 Twp. 15 R. 9 <input checked="" type="checkbox"/> East <input type="checkbox"/> West 2,040 Feet from <input checked="" type="checkbox"/> North / <input type="checkbox"/> South Line of Section 590 Feet from <input checked="" type="checkbox"/> East / <input type="checkbox"/> West Line of Section Wabaunsee County	
Is the pit located in a Sensitive Ground Water Area? <input type="checkbox"/> Yes <input checked="" type="checkbox"/> No		Chloride concentration: _____ mg/l <small>(For Emergency Pits and Settling Pits only)</small>	
Is the bottom below ground level? <input checked="" type="checkbox"/> Yes <input type="checkbox"/> No	Artificial Liner? <input type="checkbox"/> Yes <input checked="" type="checkbox"/> No	How is the pit lined if a plastic liner is not used? native clay & drilling mud	
Pit dimensions (all but working pits): 65 Length (feet) 65 Width (feet) <input type="checkbox"/> N/A: Steel Pits Depth from ground level to deepest point: 5 (feet) <input type="checkbox"/> No Pit			
If the pit is lined give a brief description of the liner material, thickness and installation procedure.		Describe procedures for periodic maintenance and determining liner integrity, including any special monitoring.	
Distance to nearest water well within one-mile of pit 2943 feet Depth of water well 55 feet		Depth to shallowest fresh water 35 feet. Source of information: <input type="checkbox"/> measured <input type="checkbox"/> well owner <input type="checkbox"/> electric log <input type="checkbox"/> KDWR	
Emergency, Settling and Burn Pits ONLY: Producing Formation: _____ Number of producing wells on lease: _____ Barrels of fluid produced daily: _____ Does the slope from the tank battery allow all spilled fluids to flow into the pit? <input type="checkbox"/> Yes <input type="checkbox"/> No		Drilling, Workover and Haul-Off Pits ONLY: Type of material utilized in drilling/workover: drilling mud Number of working pits to be utilized: 3 Abandonment procedure: allow to dry by evaporation & backfill when dry Drill pits must be closed within 365 days of spud date.	
I hereby certify that the above statements are true and correct to the best of my knowledge and belief.			
2/22/2007 Date		M.H. Signature of Applicant or Agent	
RECEIVED FEB 26 2007 KCC-WICHITA			
KCC OFFICE USE ONLY			
RFAC <input type="checkbox"/> RFAS <input type="checkbox"/>			
Date Received: 2/26/07 Permit Number: _____ Permit Date: 2/26/07 Lease Inspection: <input type="checkbox"/> Yes <input checked="" type="checkbox"/> No			

15-197-20269-0000