

For KCC Use: 3-13-07
 Effective Date: _____
 District # 1
 SGA? Yes No

RECEIVED
 KANSAS CORPORATION COMMISSION
 OIL & GAS CONSERVATION DIVISION

Form C-1
November 2005

MAR 07 2007

Form must be Typed
Form must be Signed
All blanks must be Filled

NOTICE OF INTENT TO DRILL

Must be approved by KCC five (5) days prior to commencing operations.

**CONSERVATION DIVISION
WICHITA, KS**

Expected Spud Date: 03/15/2007
month day year

OPERATOR: License# 33168 ✓
 Name: Woolsey Operating Company, LLC
 Address 1: 125 N. Market, Suite 1000
 Address 2: _____
 City: Wichita State: KS Zip: 67202 + 1775
 Contact Person: Dean Pattisson
 Phone: 316-267-4379
 CONTRACTOR: License# 5929 ✓
 Name: Duke Drilling Co., Inc.

Well Drilled For:	Well Class:	Type Equipment:
<input checked="" type="checkbox"/> Oil ✓	<input checked="" type="checkbox"/> Infield ✓	<input checked="" type="checkbox"/> Mud Rotary ✓
<input checked="" type="checkbox"/> Gas	<input type="checkbox"/> Enh Rec	<input type="checkbox"/> Pool Ext.
<input type="checkbox"/> Seismic ; # of Holes _____	<input type="checkbox"/> Storage	<input type="checkbox"/> Air Rotary
<input type="checkbox"/> Other: _____	<input type="checkbox"/> Disposal	<input type="checkbox"/> Cable
	<input type="checkbox"/> Wildcat	
	<input type="checkbox"/> Other	

If OWWO: old well information as follows:
 Operator: _____
 Well Name: _____
 Original Completion Date: _____ Original Total Depth: _____

Directional, Deviated or Horizontal wellbore? Yes No
 If Yes, true vertical depth: _____
 Bottom Hole Location: _____
 KCC DKT #: _____

Spot Description: _____
 _____ S2 NE Sec. 34 Twp. 33 S. R. 11 E W
 (AG/00) 1980 _____ feet from N / S Line of Section
 1320 _____ feet from E / W Line of Section

Is SECTION: Regular Irregular?
 (Note: Locate well on the Section Plat on reverse side)

County: Barber
 Lease Name: FORESTER 'A' Well #: 3
 Field Name: ROUNDUP SOUTH

Is this a Prorated / Spaced Field? Yes No
 Target Formation(s): MISSISSIPPIAN
 Nearest Lease or unit boundary line (in footage): 1320

Ground Surface Elevation: 1390 feet MSL
 Water well within one-quarter mile: Yes No
 Public water supply well within one mile: Yes No

Depth to bottom of fresh water: 150
 Depth to bottom of usable water: 180
 Surface Pipe by Alternate: I II

Length of Surface Pipe Planned to be set: 250
 Length of Conductor Pipe (if any): 0
 Projected Total Depth: 5150
 Formation at Total Depth: SIMPSON

Water Source for Drilling Operations:
 Well Farm Pond Other: TO BE HAULED
 DWR Permit #: _____

(Note: Apply for Permit with DWR)
 Will Cores be taken? Yes No
 If Yes, proposed zone: _____

AFFIDAVIT

The undersigned hereby affirms that the drilling, completion and eventual plugging of this well will comply with K.S.A. 55 et. seq.
 It is agreed that the following minimum requirements will be met:

1. Notify the appropriate district office **prior** to spudding of well;
2. A copy of the approved notice of intent to drill **shall be posted** on each drilling rig;
3. The minimum amount of surface pipe as specified below **shall be set** by circulating cement to the top; in all cases surface pipe **shall be set** through all unconsolidated materials plus a minimum of 20 feet into the underlying formation.
4. If the well is dry hole, an agreement between the operator and the district office on plug length and placement is necessary **prior to plugging**;
5. The appropriate district office will be notified before well is either plugged or production casing is cemented in;
6. If an ALTERNATE II COMPLETION, production pipe shall be cemented from below any usable water to surface within **120 DAYS** of spud date. Or pursuant to Appendix "B" - Eastern Kansas surface casing order #133,891-C, which applies to the KCC District 3 area, alternate II cementing must be completed within 30 days of the spud date or the well shall be plugged. **In all cases, NOTIFY district office** prior to any cementing.

I hereby certify that the statements made herein are true and to the best of my knowledge and belief.

Date: 03/07/07 Signature of Operator or Agent: Dean Pattisson Title: Operations Manager

For KCC Use ONLY	
API # 15 - <u>007-23126-0000</u>	
Conductor pipe required <u>None</u> feet	
Minimum surface pipe required <u>200</u> feet per ALT. <input checked="" type="checkbox"/> I <input type="checkbox"/> II	
Approved by: <u>03-8-07</u>	
This authorization expires: <u>9-8-07</u> (This authorization void if drilling not started within 6 months of approval date.)	
Spud date: _____	Agent: _____

Remember to:

- File Drill Pit Application (form CDP-1) with Intent to Drill;
- File Completion Form ACO-1 within 120 days of spud date;
- File acreage attribution plat according to field proration orders;
- Notify appropriate district office 48 hours prior to workover or re-entry;
- Submit plugging report (CP-4) after plugging is completed (within 60 days);
- Obtain written approval before disposing or injecting salt water.
- If this permit has expired (See: authorized expiration date) please check the box below and return to the address below.

Well Not Drilled - Permit Expired Date: _____
 Signature of Operator or Agent: _____

Mail to: KCC - Conservation Division, 130 S. Market - Room 2078, Wichita, Kansas 67202

34
33
11
 E W

IN ALL CASES PLOT THE INTENDED WELL ON THE PLAT BELOW

Plat of acreage attributable to a well in a prorated or spaced field

If the intended well is in a prorated or spaced field, please fully complete this side of the form. If the intended well is in a prorated or spaced field complete the plat below showing that the well will be properly located in relationship to other wells producing from the common source of supply. Please show all the wells and within 1 mile of the boundaries of the proposed acreage attribution unit for gas wells and within 1/2 mile of the boundaries of the proposed acreage attribution unit for oil wells.

API No. 15 - 007-23126-0000
 Operator: Woolsey Operating Company, LLC
 Lease: FORESTER 'A'
 Well Number: 3
 Field: ROUNDUP SOUTH

Location of Well: County: Barber
 1980 feet from N / S Line of Section
 1320 feet from E / W Line of Section
 Sec. 34 Twp. 33 S. R. 11 E W

Number of Acres attributable to well: _____
 QTR/QTR/QTR/QTR of acreage: _____ - _____ - S2 - NE

Is Section: Regular or Irregular

If Section Is Irregular, locate well from nearest corner boundary.

Section corner used: NE NW SE SW

PLAT

*(Show location of the well and shade acreage attributable for prorated or spaced wells.)
 (Show footage to the nearest lease or unit boundary line.)*

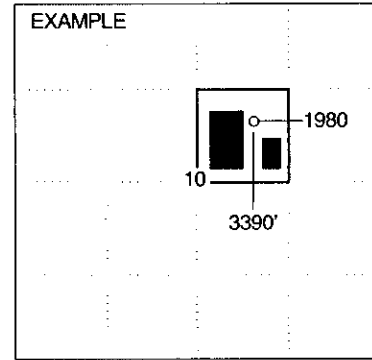
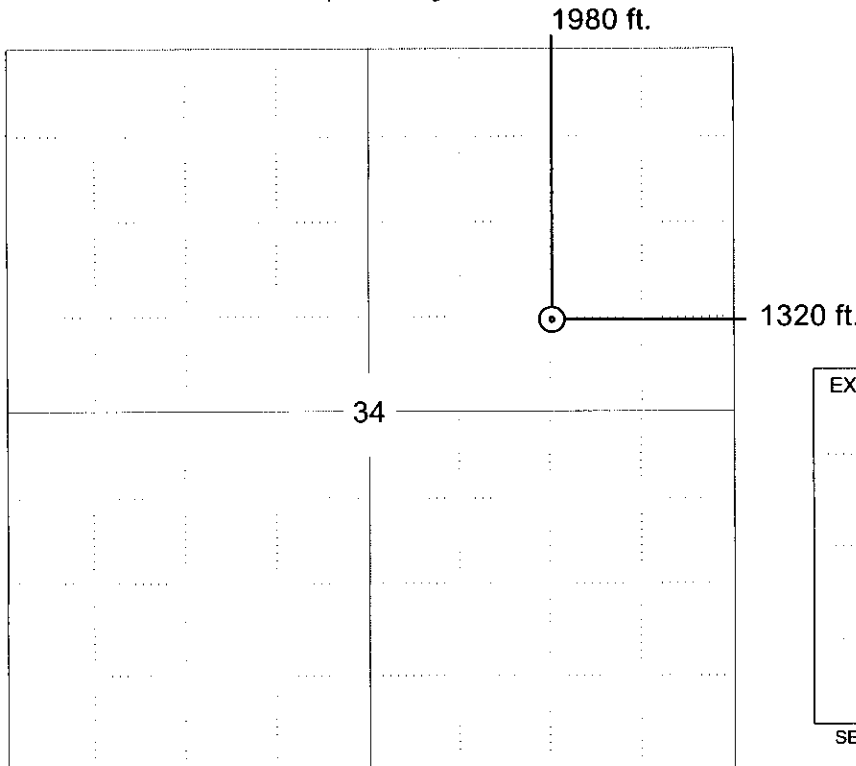

NOTE: In all cases locate the spot of the proposed drilling location.

In plotting the proposed location of the well, you must show:

1. The manner in which you are using the depicted plat by identifying section lines, i.e. 1 section, 1 section with 8 surrounding sections, 4 sections, etc.
2. The distance of the proposed drilling location from the south / north and east / west outside section lines.
3. The distance to the nearest lease or unit boundary line (in footage).
4. If proposed location is located within a prorated or spaced field a certificate of acreage attribution plat must be attached: (CO-7 for oil wells; CG-8 for gas wells).

KANSAS CORPORATION COMMISSION
OIL & GAS CONSERVATION DIVISION

Form GDP-1
April 2004
Form must be Typed

APPLICATION FOR SURFACE PIT

Submit in Duplicate

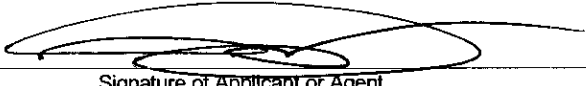
Operator Name: Woolsey Operating Company, LLC		License Number: 33168
Operator Address: 125 N. Market, Suite 1000		Wichita KS 67202
Contact Person: Dean Pattisson		Phone Number: 316-267-4379
Lease Name & Well No.: FORESTER 'A' 3		Pit Location (QQQQ): _____ S2 _____ NE
Type of Pit: <input type="checkbox"/> Emergency Pit <input type="checkbox"/> Burn Pit <input type="checkbox"/> Settling Pit <input checked="" type="checkbox"/> Drilling Pit <input type="checkbox"/> Workover Pit <input type="checkbox"/> Haul-Off Pit <small>(If WP Supply API No. or Year Drilled)</small>	Pit is: <input checked="" type="checkbox"/> Proposed <input type="checkbox"/> Existing If Existing, date constructed: _____ Pit capacity: _____ (bbls)	Sec. <u>34</u> Twp. <u>33</u> R. <u>11</u> <input type="checkbox"/> East <input checked="" type="checkbox"/> West <u>1,980</u> Feet from <input checked="" type="checkbox"/> North / <input type="checkbox"/> South Line of Section <u>1,320</u> Feet from <input checked="" type="checkbox"/> East / <input type="checkbox"/> West Line of Section Barber _____ County
Is the pit located in a Sensitive Ground Water Area? <input checked="" type="checkbox"/> Yes <input type="checkbox"/> No		Chloride concentration: _____ mg/l <small>(For Emergency Pits and Settling Pits only)</small>
Is the bottom below ground level? <input type="checkbox"/> Yes <input type="checkbox"/> No	Artificial Liner? <input type="checkbox"/> Yes <input type="checkbox"/> No	How is the pit lined if a plastic liner is not used? CLAYS FROM MUD WILL PROVIDE SEALER.
Pit dimensions (all but working pits): <u>80</u> Length (feet) <u>80</u> Width (feet) <input type="checkbox"/> N/A: Steel Pits Depth from ground level to deepest point: <u>4</u> (feet) <input type="checkbox"/> No Pit		
If the pit is lined give a brief description of the liner material, thickness and installation procedure.		Describe procedures for periodic maintenance and determining liner integrity, including any special monitoring. MONITOR PITS UNTIL DRY
Distance to nearest water well within one-mile of pit <u>4602</u> feet Depth of water well <u>34</u> feet		Depth to shallowest fresh water <u>6</u> feet. <u>10</u> Source of information: <input type="checkbox"/> measured <input type="checkbox"/> well owner <input type="checkbox"/> electric log <input type="checkbox"/> KDWR
Emergency, Settling and Burn Pits ONLY: Producing Formation: _____ Number of producing wells on lease: _____ Barrels of fluid produced daily: _____ Does the slope from the tank battery allow all spilled fluids to flow into the pit? <input type="checkbox"/> Yes <input type="checkbox"/> No		Drilling, Workover and Haul-Off Pits ONLY: Type of material utilized in drilling/workover: _____ Number of working pits to be utilized: <u>3</u> Abandonment procedure: WHEN DRY, BACKFILL AND RESTORE LOCATION Drill pits must be closed within 365 days of spud date.
I hereby certify that the above statements are true and correct to the best of my knowledge and belief.		
<u>03/07/07</u> Date		 Signature of Applicant or Agent
KCC OFFICE USE ONLY		
Date Received: <u>3/7/07</u> Permit Number: _____ Permit Date: <u>3/8/07</u> Lease Inspection: <input checked="" type="checkbox"/> Yes <input type="checkbox"/> No		RFAC <input checked="" type="checkbox"/> RFAS <input checked="" type="checkbox"/> <i>OUT DRAW</i>

KS-007-23126-0000

Mail to: KCC - Conservation Division, 130 S. Market - Room 2078, Wichita, Kansas 67202

KANSAS

CORPORATION COMMISSION

KATHLEEN SEBELIUS, GOVERNOR
BRIAN J. MOLINE, CHAIR
ROBERT E. KREHBIEL, COMMISSIONER
MICHAEL C. MOFFET, COMMISSIONER

March 8, 2007

Mr. Dean Pattisson
Woolsey Operating Company, LLC
125 N. Market Ste 1000
Wichita, KS 67202-1775

RE: Drilling Pit Application
Forester A Lease Well No. 3
NE/4 Sec. 34-33S-11W
Barber County, Kansas

Dear Mr. Pattison:

District staff has inspected the above referenced location and has determined that the reserve pit shall be constructed **without slots**, the bottom shall be flat and reasonably level, and the free fluids must be removed. The fluids are to be removed from the reserve pit as soon as the Hutchinson Salt section has been drilled through and displacement of the fluids into the reserve pit has occurred. The fluids should be removed again as soon as practical after drilling operations have ceased.
Please keep the pits away from the draw.

If production casing is set all completion fluids shall be removed from the working pits daily. NO completion fluids or non-exempt wastes shall be placed in the reserve pit.

The fluids should be taken to an authorized disposal well. Please call the District Office at (620) 225-8888 when the fluids have been removed. Please file form CDP-5 (August 2004), Exploration and Production Waste Transfer, within 30 days of fluid removal. Conservation division forms are available through our office and on the KCC web site:
www.kcc.state.ks.us/conservation/forms.

A copy of this letter should be posted in the doghouse along with the approved Intent to Drill.
If you have any questions or concerns please feel free to contact the undersigned at the above address.

Sincerely,

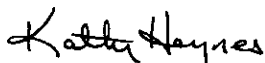

Kathy Haynes
Environmental Protection and Remediation Department

cc: S Durrant