

** 2100 - Fortage 3-13-07

** LEASE LOCATION CORRECTION 3-13-07
LEASE NAME CORRECTION 2-15-07

CORRECTED

KANSAS CORPORATION COMMISSION
OIL & GAS CONSERVATION DIVISION
NOTICE OF INTENT TO DRILL

LEASE NAME CORRECTION 2-15-07
CORRECTED

Form C-1
December 2002
Form must be Typed
Form must be Signed
Blanks must be Filled
**
320
2-14-07
CORRECTED

For KCC Use: 2-14-07
Effective Date: 3
District I: 3
SQA? Yes No

Must be approved by KCC five (5) days prior to commencing well

Expected Spud Date February 13, 2007
month day year

Spot East
SW NW Sec. 7 Twp. 28 S. R. 16
 West

OPERATOR: License# 33344
Name: Quest Cherokee LLC
Address: 9520 North May Avenue, Suite 300
City/State/Zip: Oklahoma City, Oklahoma 73120
Contact Person: Richard Martin
Phone: (405) 296-9316

1980 630 feet from N / S Line of Section
660 feet from E / W Line of Section
Is SECTION Regular Irregular?

(Note: Locate well on the Section Plat on reverse side)

CONTRACTOR: License# Will be licensed by the KCC
Name: Will advise on the ACO-1

County: Neosho
Lease Name: Seidi Farms SEIDL FARMS Well #: 7-1
Field Name: Cherokee Basin CBM

Well Drilled For: Well Class: Type Equipment:
 Oil Enn Roc Infield Mud Rotary
 Gas Storage Pool Ext. Air Rotary
 OWWO Disposal Wildcat Cable
 Solismic: # of Holes Other
 Other: Coalbed Methane

Is this a Fracated / Spaced Field? Yes No
Target Formation(s): Cherokee Coals
Nearest Lease or unit boundary: 660
Ground Surface Elevation: 952 feet MSL

If OWWO: old well information as follows:
Operator: _____
Well Name: _____
Original Completion Date: _____ Original Total Depth: _____

Water well within one-quarter mile: Yes No
Public water supply well within one mile: Yes No
Depth to bottom of fresh water: 100
Depth to bottom of useable water: 200-150

Directional, Deviated or Horizontal wellbore? Yes No
If Yes, true vertical depth: _____
Bottom Hole Location: _____

Surface Pipe by Alternate: 1 2
Length of Surface Pipe Planned to be set: 25
Length of Conductor Pipe required: _____
Projected Total Depth: Cherokee Coals
Formation at Total Depth: 1500

KCC DKT #: _____
2-15-07 * WAS: Seidi Farms / 2100 * WAS 660' FWL
IS: Seidi Farms IS: 630' FWL AFFIDAVIT

Water Source for Drilling Operations: Well Farm Pond Other: Air
DWR Permit #: _____
(Note: Apply for Permit with DWR)
Will Cores be taken? Yes No
If Yes, proposed zone: _____

The undersigned hereby affirms that the drilling, completion and eventual plugging of this well will comply with K.S.A. 55-61, 55-62. It is agreed that the following minimum requirements will be met:

1. Notify the appropriate district office prior to spudding of well; Will file new intent for skid rig.
2. A copy of the approved notice of intent to drill shall be posted on each drilling rig; Correcting back to original location 2-14-07
3. The minimum amount of surface pipe as specified below shall be set by circulating cement to the top; in all cases Operator mistakenly filed correction.
4. If the well is dry hole, an agreement between the operator and the district office on plug length and placement is necessary prior to plugging;
5. The appropriate district office will be notified before well is either plugged or production casing is cemented in;
6. If an ALTERNATE II COMPLETION, production pipe shall be cemented from below any usable water to surface within 120 days of spud date. Or pursuant to Appendix "B" - Eastern Kansas surface casing order #133,891-C, which applies to the KCC District 3 area, alternate II cementing must be completed within 30 days of the spud date or the well shall be plugged. In all cases, NOTIFY district office prior to any cementing.

I hereby certify that the statements made herein are true and to the best of my knowledge and belief.
Date: February 6, 2007 Signature of Operator or Agent: Richard Martin Title: VP

For KCC Use ONLY
API # 15: 133-26 PDS-0000
Conductor pipe required None feet
Minimum surface pipe required 20 feet per Alt. XO 2
Approved by: B.H. 2-9-07 / M.H. 2-15-07 / R.H. 3-13-07
This authorization expires: 8-9-07 2-14-07
(This authorization void if drilling not started within 6 months of approval date.)
Spud date: _____ Agent: _____

Remember to:
- File Drill Pit Application (form GDP-1) with Intent to Drill;
- File Completion Form ACO-1 within 120 days of spud date;
- File acreage attribution plat according to field proration orders;
- Notify appropriate district office 48 hours prior to workover or re-entry;
- Submit plugging report (CP-4) after plugging is completed;
- Obtain written approval before disposing or injecting salt water.
- If this permit has expired (See: authorized expiration date) please check the box below and return to the address below.
 Well Not Drilled - Permit Expired
Signature of Operator or Agent: _____
Date: FEB 08 2007

Mail to: KCC - Conservation Division, 130 **RECEIVED** 2078, Wichita, Kansas 67202
KANSAS CORPORATION COMMISSION CONSERVATION DIVISION
WICHITA, KS

MAR 13 2007

CONSERVATION DIVISION
WICHITA, KS

7
28
18E

CORRECTED

CORRECTED

CORRECTED

IN ALL CASES PLOT THE INTENDED WELL ON THE PLAT BELOW

Plat of acreage attributable to a well in a prorated or spaced field

If the intended well is in a prorated or spaced field, please fully complete this side of the form. If the intended well is in a prorated or spaced field complete the plat below showing that the well will be properly located in relationship to other wells producing from the common source of supply. Please show all the wells and within 1 mile of the boundaries of the proposed acreage attribution unit for gas wells and within 1/2 mile of the boundaries of the proposed acreage attribution unit for oil wells.

API No. 15 - 133-26805-000
Operator: Quest Cherokee LLC
*Lease: Seidl Farms SEIDL FARMS *
Well Number: 7-1
Field: Cherokee Basin CBM
Number of Acres attributable to well: _____
O/T R / Q/T R of acreage: _____ SW _____ NW

Location of Well: County: Neosho
1980 _____ feet from N / S Line of Section
~~900~~ 630-660 feet from E / W Line of Section
Sec. 7 Twp. 28 S. R. 18 East West

Is Section: Regular or Irregular

If Section is irregular, locate well from nearest corner boundary.

Section corner used: NE NW SE SW

PLAT

*(Show location of the well and shade attributable acreage for prorated or spaced wells.)
(Show footage to the nearest lease or unit boundary line.)*

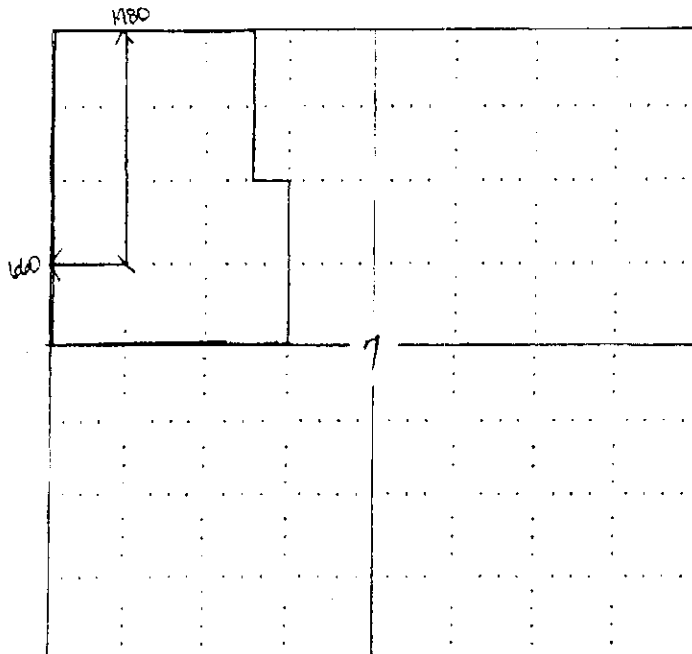

NOTE: In all cases locate the spot of the proposed drilling location.

RECEIVED
KANSAS CORPORATION COMMISSION
FEB 15 2007
CONSERVATION DIVISION
WICHITA, KS

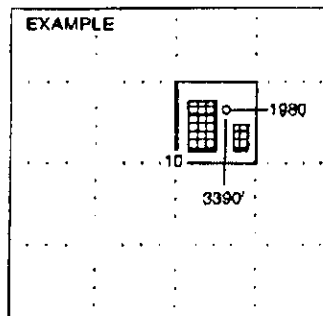

SEWARD CO.

In plotting the proposed location of the well, you must show:

1. The manner in which you are using the depicted plat by identifying section lines. I.e. 1 section, 1 section with 8 surrounding sections, 4 sections, etc.
2. The distance of the proposed drilling location from the section's south / north and east / west.
3. The distance to the nearest lease or unit boundary line.
4. If proposed location is located within a prorated or spaced field a certificate of acreage attribution plat must be attached: (CO-7 for oil wells; CG-8 for gas wells).

RECEIVED
KANSAS CORPORATION COMMISSION

MAR 13 2007

CONSERVATION DIVISION
WICHITA, KS

CORRECTED

RECEIVED
KANSAS CORPORATION COMMISSION

KANSAS CORPORATION COMMISSION
OIL & GAS CONSERVATION DIVISION

FEB 15 2007

Form CDP-1
April 2004
Form must be Typed

**APPLICATION FOR SURFACE PIT CONSERVATION DIVISION
WICHITA, KS**

Submit in Duplicate

Operator Name: Quest Cherokee LLC		License Number: 33344	
Operator Address: 9520 North May Avenue, Suite 300 Oklahoma City, Oklahoma 73120			
Contact Person: Richard Marlin		Phone Number: (405) 286 9316	
* Lease Name & Well No.: Seidl Farms #7-1 SEIDL FARMS		Pit Location (QQQQ): _____ SW _____ NW Sec. <u>7</u> Twp. <u>28</u> R. <u>18</u> <input checked="" type="checkbox"/> East <input type="checkbox"/> West 1980 Feet from <input checked="" type="checkbox"/> North / <input type="checkbox"/> South Line of Section 560 630 660 Feet from <input type="checkbox"/> East / <input checked="" type="checkbox"/> West Line of Section Neosho County	
Type of Pit: <input type="checkbox"/> Emergency Pit <input type="checkbox"/> Burn Pit <input type="checkbox"/> Settling Pit <input checked="" type="checkbox"/> Drilling Pit <input type="checkbox"/> Workover Pit <input type="checkbox"/> Haul-Off Pit <small>(If WP Supply API No. or Year Drilled)</small>	Pit Is: <input checked="" type="checkbox"/> Proposed <input type="checkbox"/> Existing If Existing, date constructed: _____ Pit capacity: <u>300</u> (bbls)		
Is the pit located in a Sensitive Ground Water Area? <input type="checkbox"/> Yes <input checked="" type="checkbox"/> No		Chloride concentration: _____ mg/l <small>(For Emergency Pits and Settling Pits only)</small>	
Is the bottom below ground level? <input type="checkbox"/> Yes <input checked="" type="checkbox"/> No		Artificial Liner? <input type="checkbox"/> Yes <input checked="" type="checkbox"/> No	
How is the pit lined if a plastic liner is not used?			
Pit dimensions (all but working pits): <u>30</u> Length (feet) <u>10</u> Width (feet) _____ N/A: Steel Pits Depth from ground level to deepest point: <u>10</u> (feet)			
If the pit is lined give a brief description of the liner material, thickness and installation procedure.		Describe procedures for periodic maintenance and determining liner integrity, including any special monitoring. Air Drilling Operation lasting approx 3 days	
Distance to nearest water well within one-mile of pit <u>N/A</u> feet Depth of water well _____ feet		Depth to shallowest fresh water _____ feet. Source of information: _____ measured _____ well owner _____ electric log _____ KDWR	
Emergency, Settling and Burn Pits ONLY: Producing Formation: _____ Number of producing wells on lease: _____ Barrels of fluid produced daily: _____ Does the slope from the tank battery allow all spilled fluids to flow into the pit? <input type="checkbox"/> Yes <input type="checkbox"/> No		Drilling, Workover and Haul-Off Pits ONLY: Type of material utilized in drilling/workover: <u>Air Drilled</u> Number of working pits to be utilized: <u>One</u> Abandonment procedure: <u>Air Dry, Back Fill and Cover</u> Drill pits must be closed within 365 days of spud date.	
I hereby certify that the above statements are true and correct to the best of my knowledge and belief.			
February 7, 2007 Date		RECEIVED KANSAS CORPORATION COMMISSION FEB 08 2007 Signature of Applicant or Agent Richard Marlin CONSERVATION DIVISION WICHITA, KS	

CORRECTED
CORRECTED

15-133-21805-0000

KCC OFFICE USE ONLY

Date Received: 2/8/07 Permit Number: _____ Permit Date: 2/8/07 Lease Inspection: Yes No

Mail to: KCC - Conservation Division, 130 S. Market - Room 2078, Wichita, Kansas 67202

RECEIVED
KANSAS CORPORATION COMMISSION

MAR 13 2007

CONSERVATION DIVISION
WICHITA, KS