

EFFECTIVE DATE: 3-21-07

State of Kansas

DISTRICT #: 1

CATHODIC PROTECTION BOREHOLE INTENT

SGA? Yes No

Must be approved by the K.C.C. sixty (60) days prior to commencing well.

Expected Spud (Starting) Date March 19 2007
month day year

OPERATOR: License # 5952

Name: BP America Production Company

Address: P. O. Box 3092 Room 3.276A, WL-1

City/State/Zip: Houston, Texas 77253-3092

Contact Person: DeAnn Snyers

Phone: (281) 366-4395

CONTRACTOR: License #: 33925

Name: C.M. Drilling Monte Moore Drilling

432-889-6261

Type Drilling Equipment: Mud Rotary Cable
 Air Rotary Other

CONSTRUCTION FEATURES

Length of Cathodic Surface (Non-Metallic) Casing

Planned to be set: 20 ft.

Length of Conductor pipe (If any?) — ft.

Size of the borehole (I.D.): 8" 10" - surface inches

Cathodic surface casing size: 4" inches

Cathodic surface casing centralizers set at depths of: N/A

Cathodic surface casing will terminate at:
 Above surface Surface Vault Below Surface Vault

Pitless casing adaptor will be used: Yes/No at Depth — ft.

Anode installation depths are: 80 - 250' continuous

Spot (Location) Q/Q/Q — East
NW NW NW Sec 4 Twp 29 S, Rg 38 West

583 ENL feet from South / North Line of Section
30 FWL feet from East / West Line of Section

(Circle directions from nearest outside corner boundaries)

IS SECTION REGULAR IRREGULAR?

(Spot well on Section Plat on Reverse Side)

County: Grant

Lease Name: Barnes Well #: 1

Facility Name: PIPELINES IK & IA (Barnes)

Ground Surface Elevation: 3146.7 MSL.

Cathodic Borehole Total Depth 250 ft.

Depth to Bedrock 460 ft.

WATER INFORMATION:

Aquifer Penetration: None Single Multiple

Depth to bottom of fresh water: 460

Depth to bottom of usable water: 1680

Water well within one-quarter mile: yes no

Public water supply well within one mile: yes no

Water Source for Drilling Operations:

well farm pond stream other

Water Well Location: —

DWR Permit #: —

Standard Dimension Ratio (SDR) is = 26 or less

(cathodic surface OO csg. in inches / MWT in inches = SDR)

Annular space between borehole and casing will be grouted with:
 Concrete Bentonite Cement
 Neat cement Bentonite clay

Anode vent pipe will be set at: 5 ft. above surface

Anode conductor (backfill) material TYPE: SE2 Coke Breeze

Depth to BASE of Backfill installation material: 250'

Depth to TOP of Backfill installation material: 150' 80

AFFIDAVIT

The undersigned hereby affirms that the drilling, completion and eventual plugging of this well will comply with K.S.A.55-101, et. seq. It is agreed that the following minimum requirements will be met:

1. Notify the appropriate district office prior to spudding of and again before plugging well;
2. A copy of the approved notice of intent to drill shall be posted on each drilling rig;
3. The minimum amount of cathodic surface casing as specified below shall be set by grouting the top.
4. An agreement between the operator and the district office on plugs and placement is necessary prior to plugging;
5. The appropriate district office will be notified before well is either plugged or casing is grouted in;
6. IN ALL CASES, NOTIFY DISTRICT OFFICE PRIOR TO ANY CEMENTING.

I hereby certify that the statements made herein are true and to the best of my knowledge and belief.

Date: 2/22/2007 Signature of Operator or Agent: DeAnn Snyers Title: Regulatory Staff Asst.

FOR KCC USE:

API # 15- 067-21628-0000
Conductor pipe required None feet
Minimum cathodic surface casing required 20 feet A1+3
Approved by: RH 3-16-07

This authorization expires: 9-16-07
(This authorization void if drilling not started within 6 months of effective date.)
Spud date: — Agent: —

RECEIVED
KANSAS CORPORATION COMMISSION
MAR 07 2007
CONSERVATION DIVISION
WICHITA, KS

4-29-38W

REMEMBER TO:

- File Drill Pit Application (form CDP-1) with Intent to Install;
- File Completion Form CB-2 within 30 days of spud date;
- Notify appropriate district office 48 hours prior to workover or re-entry;
- Submit plugging report (CP-4), within 30 days after plugging is completed.

IN ALL CASES PLOT THE INTENDED WELL ON THE PLAT BELOW

Show the relationship to other wells or facilities proposed to be serviced by the intended cathodic borehole. Please show all the wells, existing cathodic boreholes, pipelines or facilities within 1/2 mile of the proposed borehole.

API NO. 15- 067-21628000
 OPERATOR BP America Production Company LOCATION OF WELL: COUNTY Grant
 LEASE _____ 583 FNL feet south/north line of section
 WELL NUMBER _____ 30 FWL feet east/west line of section
 FACILITY NAME Pipelines IK & IA (Barnes) SECTION 4 TWP 29 RG 38

IS SECTION X REGULAR or _____ IRREGULAR
 IF SECTION IS IRREGULAR, LOCATE WELL FROM NEAREST CORNER BOUNDARY.
 SPOT: QTR/QTR/QTR/QTR OF ACREAGE
SW - NW - NW - NW Section corner used: _____ NE X NW _____ SE _____ SW

PLAT

(Show location of intended cathodic borehole.)
 (Show footage to nearest lease, unit or outside section boundary line)

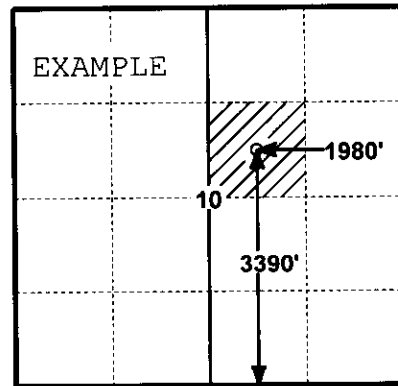
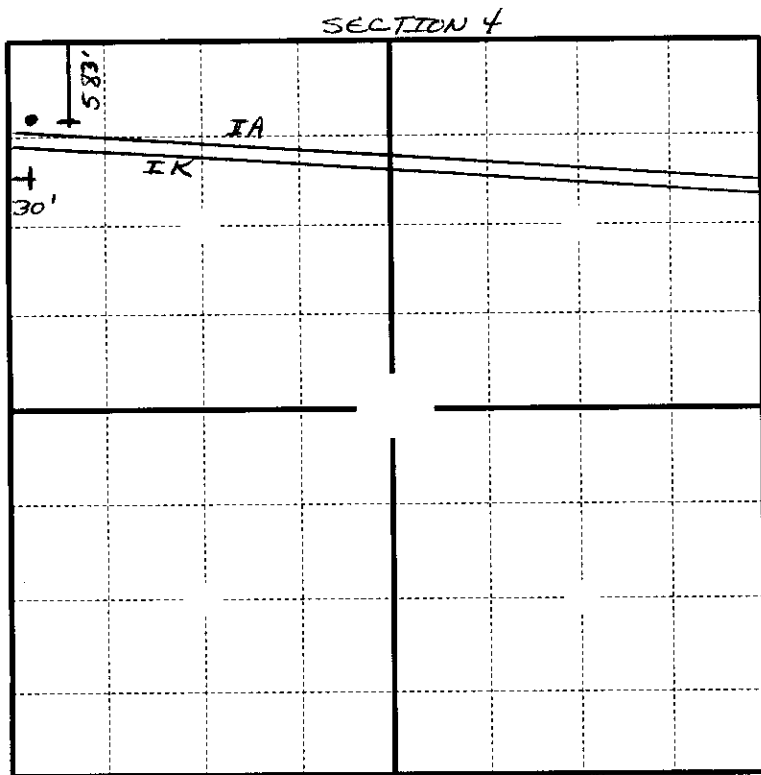

SEWARD CO.

In plotting the proposed location of the well, you must show:

- 1) The manner in which you are using the depicted plat by identifying section lines, i.e.
- 2) 1 section, 1 section with 8 surrounding sections, 4 sections, etc.;
- 3) the distance of the proposed drilling location from the section's south/north and east/west; and

APPLICATION FOR SURFACE PIT

Submit in Duplicate

Operator Name: <u>BP America Production Company</u>		License Number: <u>5952</u>
Operator Address: <u>P. O. Box 3092</u>		
Contact Person: <u>DeAnn Snyers Room 3.276A, WL-1</u>		Phone Number: <u>(281) 366-4395</u>
Lease Name & Well No.: <u>Facility Name: PIPELINE JK & IA (Barnes)</u>		Pit Location (QQQQ): <u>SW - NW - NW - NW</u>
Type of Pit: <input type="checkbox"/> Emergency Pit <input type="checkbox"/> Burn Pit <input type="checkbox"/> Settling Pit <input checked="" type="checkbox"/> Drilling Pit <input type="checkbox"/> Workover Pit <input type="checkbox"/> Haul-Off Pit <small>(If WP Supply API No. or Year Drilled)</small>	Pit is <input checked="" type="checkbox"/> Proposed <input type="checkbox"/> Existing If existing, date constructed _____ Pit capacity <u>PORTABLE PIT</u> (bbls)	Sec. <u>4</u> Twp. <u>29S</u> R. <u>38</u> <input type="checkbox"/> East <input checked="" type="checkbox"/> West <u>583</u> Feet from <input checked="" type="checkbox"/> North/ <input type="checkbox"/> South Line of Section <u>30</u> Feet from <input type="checkbox"/> East/ <input checked="" type="checkbox"/> West Line of Section <u>Grant</u> County
Is the pit located in a Sensitive Ground Water Area? <input type="checkbox"/> Yes <input checked="" type="checkbox"/> No		Chloride concentration: <u>0</u> mg/l <small>(For Emergency Pits and Settling Pits, only)</small>
Is the bottom below ground level? <input type="checkbox"/> Yes <input type="checkbox"/> No	Artificial Liner? <input type="checkbox"/> Yes <input type="checkbox"/> No	How is pit lined if a plastic liner is not used?
Pit dimensions (all but working pits): _____ Length (feet) _____ Width (feet) <u>X</u> N/A Steel Pits Depth from ground level to deepest point _____ (feet)		
If the pit is lined give a brief description of the liner material, thickness and installation procedure.		Describe procedures for periodic maintenance and determining liner integrity, including any special monitoring.
Distance to nearest water well within one-mile of pit <u>541</u> feet Depth of water well <u>95</u> feet		Depth to shallowest fresh water <u>85</u> feet. Source of information: _____ measured _____ well owner <u>(10) electric log</u> _____ KDWR
Emergency, Settling and Burn Pits ONLY: Producing Formation: _____ Number of producing wells on lease: _____ Barrels of fluid produced daily: _____ Does the slope from the tank battery allow all spilled fluids to flow into the pond? <input type="checkbox"/> Yes <input type="checkbox"/> No		Drilling, Workover and Haul-Off Pits ONLY Type of material utilized in drilling/workover <u>MAR 07 2007</u> Number of working pits to be utilized _____ Abandonment procedure: _____ Drill pits must be closed within 365 days of spud date.
I hereby certify that the above statements are true and correct to the best of my knowledge and belief.		
<u>February 22, 2007</u> Date		<u>DeAnn Snyers</u> Signature of Applicant or Agent
KCC OFFICE USE ONLY		
Date Received: <u>3/7/07</u> Permit Number: _____ Permit Date: <u>3/7/07</u> Lease Inspection: <input type="checkbox"/> Yes <input checked="" type="checkbox"/> No		<u>Steel</u>

15-067-21628000

RECEIVED
KANSAS CORPORATION COMMISSION
MAR 07 2007
CONSERVATION DIVISION
WICHITA, KS