

FOR KCC USE:

FORM C-1 7/91

EFFECTIVE DATE: 1-8-2000  
DISTRICT # 3  
SGA? Yes X No

State of Kansas  
NOTICE OF INTENTION TO DRILL

FORM MUST BE TYPED  
FORM MUST BE SIGNED  
ALL BLANKS MUST BE FILLED

Must be approved by the K.C.C. five (5) days prior to commencing well.

Expected Spud Date 1/7/00  
month day year

Spot SE NW SW Sec 22 Twp 23 S, Rg 10 X East  
West

OPERATOR: License # 5556  
Name: VIVA INTERNATIONAL, INC.  
Address: 6750 W. 75th, STE 1A  
City/State/Zip: OVERLAND PARK, KS 66204  
Contact Person: ROBERT BUKATY  
Phone: (913) 236-0090

1650 feet from South North Line of Section  
990 feet from East West Line of Section  
IS SECTION REGULAR IRREGULAR?

(NOTE: Locate well on the Section Plat on Reverse Side)

CONTRACTOR: License #: 30567  
Name: RIG 6 DRILLING

County: GREENWOOD  
Lease Name: PEARSON Well #: 18  
Field Name: BURKETT

Is this a Prorated/Spaced Field? yes X no

Target Formation(s): BARTLESVILLE

Nearest lease or unit boundary: 990

Ground Surface Elevation: 1340 feet MSL

Water well within one-quarter mile: yes X no

Public water supply well within one mile: yes X no

Depth to bottom of fresh water: 100

Depth to bottom of usable water: 150

Surface Pipe by Alternate: X 1 2

Length of Surface Pipe Planned to be set: 200

Length of Conductor pipe required: N/A

Projected Total Depth: 2300

Formation at Total Depth: BARTLESVILLE

Water Source for Drilling Operations:

well X farm pond other

Well Drilled For: Well Class: Type Equipment:  
X Oil Enh Rec Infield X Mud Rotary  
Gas Storage Pool Ext. Air Rotary  
OMWO Disposal Wildcat Cable  
Seismic; # of Holes Other

If OMWO: old well information as follows:  
Operator: N/A  
Well Name: N/A  
Comp. Date: N/A Old Total Depth N/A

Directional, Deviated or Horizontal wellbore? yes X no  
If yes, true vertical depth: N/A  
Bottom Hole Location: N/A

Will Cores Be Taken? yes X no

If yes, proposed zone: N/A

AFFIDAVIT

The undersigned hereby affirms that the drilling, completion and eventual plugging of this well will comply with K.S.A. 55-101, et. seq.

It is agreed that the following minimum requirements will be met:

1. Notify the appropriate district office prior to spudding of well;
2. A copy of the approved notice of intent to drill shall be posted on each drilling rig;
3. The minimum amount of surface pipe as specified below shall be set by circulating cement to the top; in all cases surface pipe shall be set through all unconsolidated materials plus a minimum of 20 feet into the underlying formation;
4. If the well is dry hole, an agreement between the operator and the district office on plug length and placement is necessary prior to plugging;
5. The appropriate district office will be notified before well is either plugged or production casing is cemented in;
6. IF AN ALTERNATE II COMPLETION, PRODUCTION PIPE SHALL BE CEMENTED FROM BELOW ANY USABLE WATER TO SURFACE WITHIN 120 DAYS OF SPUD DATE. IN ALL CASES, NOTIFY DISTRICT OFFICE PRIOR TO ANY CEMENTING.

I hereby certify that the statements made herein are true and to the best of my knowledge and belief.

Date: 12/31/99 Signature of Operator or Agent: William C. Brundley AGENT

FOR KCC USE:  
API # 15- 073-238880000  
Conductor pipe required NDNE feet  
Minimum surface pipe required 200 feet per Alt. 1  
Approved by: JK 1-3-2000  
This authorization expires: 7-3-2000  
(This authorization void if drilling not started within 6 months of effective date.)  
Spud date: \_\_\_\_\_ Agent: \_\_\_\_\_

22  
23

REMEMBER TO:

- File Drill Pit Application (form CDP-1) with Intent to Drill;
- File Completion Form ACO-1 within 120 days of spud date;
- File acreage attribution plat according to field proration orders;
- Notify appropriate district office 48 hours prior to workover or re-entry;
- Submit plugging report (CP-4) after plugging is completed;
- Obtain written approval before disposing or injecting salt water.

RECEIVED  
STATE CORPORATION COMMISSION  
1/3/00  
JAN 03 2000  
103  
CONSERVATION DIVISION  
Wichita, Kansas

Mail to: KCC - Conservation Division, 130 S. Market - Room 2078, Wichita, Kansas 67202.

**IN ALL CASES PLOT THE INTENDED WELL ON THE PLAT BELOW**

**PLAT OF ACREAGE ATTRIBUTABLE TO A WELL IN A PRORATED OR SPACED FIELD**

**If the intended well is in a prorated or spaced field, please fully complete this side of the form.** If the intended well is in a prorated or spaced field complete the plat below showing that the well will be properly located in relationship to other wells producing from the common source of supply. Please show all the wells within 1 mile of the boundaries of the proposed acreage attribution unit for gas wells and within 1/2 mile of the boundaries of the proposed acreage attribution unit for oil wells.

API NO. 15- \_\_\_\_\_  
 OPERATOR VIVA INTERNATIONAL, INC  
 LEASE PEARSON  
 WELL NUMBER 18  
 FIELD BURKETT

LOCATION OF WELL: COUNTY GREENWOOD  
1650 feet from south line of section  
990 feet from east line of section  
 SECTION 22 TWP 22 RG 10E

NUMBER OF ACRES ATTRIBUTABLE TO WELL \_\_\_\_\_  
 QTR/QTR/QTR OF ACREAGE SE - NW - SW

IS SECTION X REGULAR or \_\_\_\_\_ IRREGULAR  
**IF SECTION IS IRREGULAR, LOCATE WELL FROM NEAREST CORNER BOUNDARY.**

Section corner used: \_\_\_\_\_ NE \_\_\_\_\_ NW \_\_\_\_\_ SE \_\_\_\_\_ SW

**PLAT**

(Show location of the well and shade attributable acreage for prorated or spaced wells.)  
 (Show footage to the nearest lease or unit boundary line.)

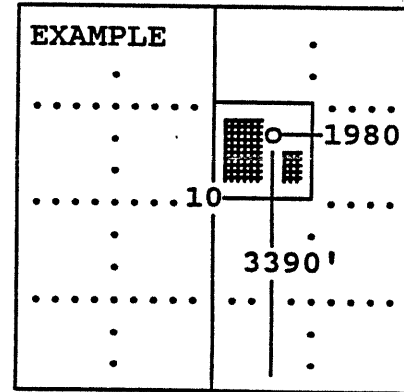
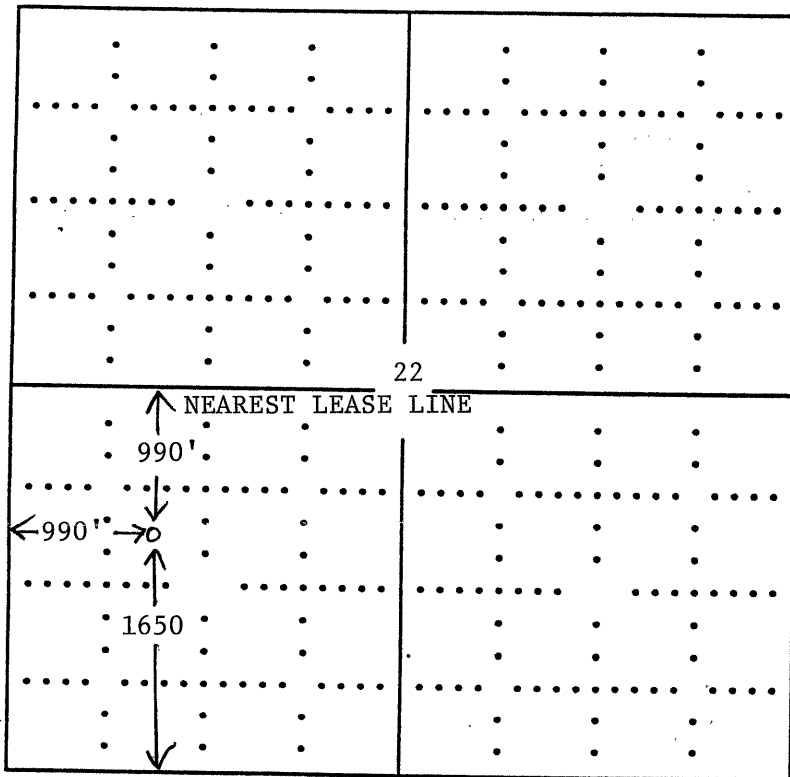

SEWARD CO.

**In plotting the proposed location of the well, you must show:**

- 1) The manner in which you are using the depicted plat by identifying section lines, i.e. 1 section, 1 section with 8 surrounding sections, 4 sections, etc.;
- 2) the distance of the proposed drilling location from the section's south/north and east/west; and
- 3) the distance to the nearest lease or unit boundary line.