

FOR KCC USE:

FORM C-1 7/91

FORM MUST BE TYPED

FORM MUST BE SIGNED

ALL BLANKS MUST BE FILLED

EFFECTIVE DATE: 8-23-92

State of Kansas

DISTRICT #

NOTICE OF INTENTION TO DRILL

SSA? Yes X No

Must be approved by the K.C.C. five (5) days prior to commencing well

Expected Spud Date September 15, 1992

Spot 330 North of East

W2 E2 NW Sec 17 Twp 9 S Rg 18 West

3960 feet from South / North line of Section

3630 feet from East / West line of Section

OPERATOR: License # 5635 The Gene Brown Company

IS SECTION X REGULAR IRREGULAR?

(NOTE: Locate well on the Section Plat on Reverse Side)

County: Rooks

Lease Name: Stahl Well #: 8

Field Name: McHale

Is this a Prorated/Spaced Field? yes X no

Target Formation(s): Arbuckle

Nearest lease or unit boundary: 990 to East

Ground Surface Elevation: Est. 2090 feet MSL

Water well within one-quarter mile: yes X no

Public water supply well within one mile: yes X no

Depth to bottom of fresh water: 100ft - 585

Depth to bottom of usable water: 800ft - 950

Surface Pipe by Alternate: 1 X 2

Length of Surface Pipe Planned to be set: 200ft

Length of Conductor pipe required: none

Projected Total Depth: 3580

Formation at Total Depth: Arbuckle

Water Source for Drilling Operations:

well X farm pond other

DWR Permit #:

Will Cores Be Taken? yes X no

If yes, proposed zone:

CONTRACTOR: License #: advise prior to spud date

Name: Unknown

Table with columns: Well Drilled For, Well Class, Type Equipment. Includes rows for Oil, Gas, OWWO, Seismic, etc.

If OWWO: old well information as follows: Operator, Well Name, Comp. Date, Old Total Depth

Directional, Deviated or Horizontal wellbore? yes X no

If yes, true vertical depth:

Bottom Hole Location:

AFFIDAVIT

The undersigned hereby affirms that the drilling, completion and eventual plugging of this well will comply with K.S.A. 55-101, et. seq. It is agreed that the following minimum requirements will be met:

- 1. Notify the appropriate district office prior to spudding of well;
2. A copy of the approved notice of intent to drill shall be posted on each drilling rig;
3. The minimum amount of surface pipe as specified below shall be set by circulating cement to the top;
4. If the well is dry hole, an agreement between the operator and the district office on plug length and placement is necessary prior to plugging;
5. The appropriate district office will be notified before well is either plugged or production casing is cemented in;
6. IF AN ALTERNATE II COMPLETION, PRODUCTION PIPE SHALL BE CEMENTED FROM BELOW ANY USABLE WATER TO SURFACE WITHIN 120 DAYS OF SPUD DATE. IN ALL CASES, NOTIFY DISTRICT OFFICE PRIOR TO ANY CEMENTING.

I hereby certify that the statements made herein are true and to the best of my knowledge and belief. Date: August 3, 1992 Signature of Operator or Agent: Thomas M. Sawyer Title: Development Supervisor

FOR KCC USE: API # 15- 163-23209-00-00 Conductor pipe required None feet Minimum surface pipe required 200' feet per Alt. X(2) Approved by: C.B. 8-18-92 This authorization expires: 2-18-93 (This authorization void if drilling not started within 6 months of effective date.) Spud date: Agent:

RECEIVED STATE CORPORATION COMMISSION AUG 17 1992 CONSERVATION DIVISION Wichita, Kansas RECEIVED STATE CORPORATION COMMISSION AUG 6 1992 CONSERVATION DIVISION Wichita, Kansas

REMEMBER TO:

- File Drill Pit Application (form CDP-1) with Intent to Drill;
- File Completion Form ACO-1 within 120 days of spud date;
- File acreage attribution plat according to field proration orders;
- Notify appropriate district office 48 hours prior to workover or re-work;
- Submit plugging report (CP-4) after plugging is completed;
- Obtain written approval before disposing or injecting salt water.

Mail to: Conservation Division, 200 Colorado Derby Building, 202 W. First St., Wichita, Kansas 67202-1286.

IN ALL CASES PLOT THE INTENDED WELL ON THE PLAT BELOW

PLAT OF ACREAGE ATTRIBUTABLE TO A WELL IN A PRORATED OR SPACED FIELD

If the intended well is in a prorated or spaced field, please fully complete this side of the form. If the intended well is in a prorated or spaced field complete the plat below showing that the well will be properly located in relationship to other wells producing from the common source of supply. Please show all the wells within 1 mile of the boundaries of the proposed acreage attribution unit for gas wells and within 1/2 mile of the boundaries of the proposed acreage attribution unit for oil wells.

API NO. 15- _____
 OPERATOR _____
 LEASE _____
 WELL NUMBER _____
 FIELD _____

LOCATION OF WELL: COUNTY Rooks
3960 feet from south/north line of section
3630 feet from east/west line of section
 SECTION 17 TWP 9 RG 18W

NUMBER OF ACRES ATTRIBUTABLE TO WELL _____
 QTR/QTR/QTR OF ACREAGE _____

IS SECTION _____ REGULAR or _____ IRREGULAR
IF SECTION IS IRREGULAR, LOCATE WELL FROM NEAREST CORNER BOUNDARY.

Section corner used: _____ NE _____ NW _____ SE _____ SW

PLAT

(Show location of the well and shade attributable acreage for prorated or spaced wells.)
 (Show footage to the nearest lease or unit boundary line.)

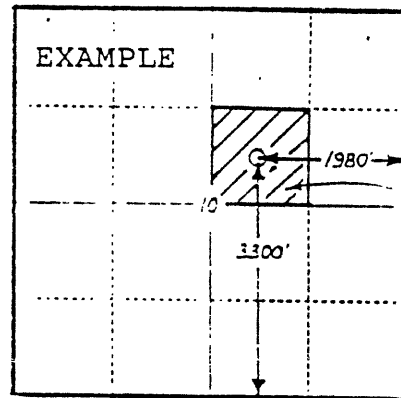
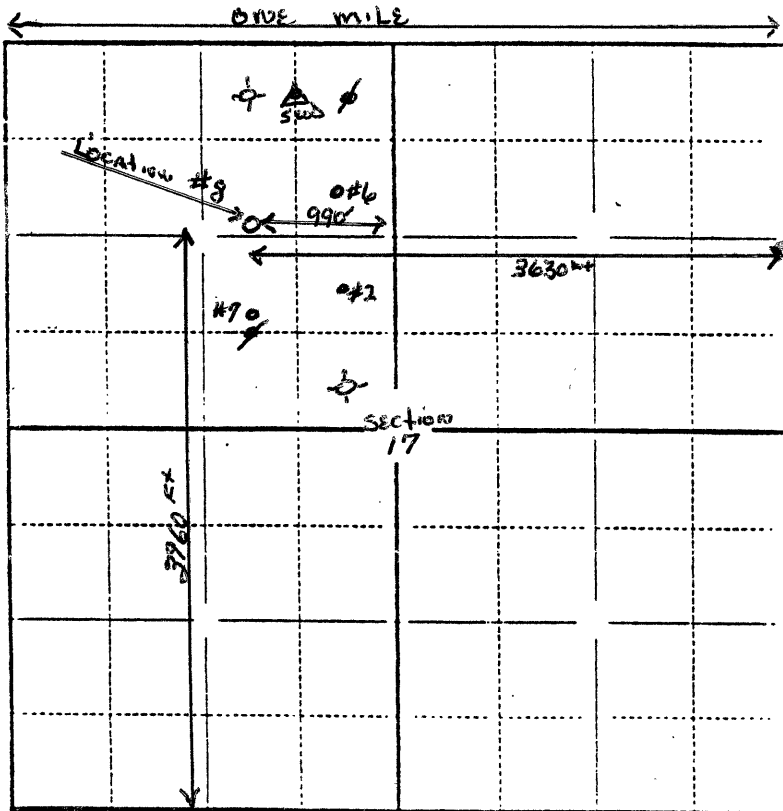

40 ACRES

In plotting the proposed location of the well, you must show:

- 1) The manner in which you are using the depicted plat by identifying section lines, i.e. 1 section, 1 section with 8 surrounding sections, 4 sections, etc.;
- 2) the distance of the proposed drilling location from the section's south/north and east/west lines; and
- 3) the distance to the nearest lease or unit boundary line.