

EFFECTIVE DATE: 4-29-91

2646256

FORM MUST BE TYPED  
FORM C-1 4/90

State of Kansas

FORM MUST BE SIGNED  
ALL BLANKS MUST BE FILLED

NOTICE OF INTENTION TO DRILL

Must be approved by the K.C.C. five (5) days prior to commencing well

Expected Spud Date May 2 1991 C-N/2-NE-NW Sec 17 Twp 9 S, Rg 18 X East X West

OPERATOR: License # 5635  
Name: The Gene Brown Company  
Address: P.O. Drawer #220  
City/State/Zip: Plainville, Kansas 67663  
Contact Person: Tom Brown  
Phone: 913-434-4811

4950 feet from South line of Section  
3300 feet from East line of Section  
(Note: Locate well on Section Plat on Reverse Side)

County: Rooks  
Lease Name: Stahl Well #: SWD #1  
Field Name: Mchale

CONTRACTOR: License #: 5302  
Name: Red Tiger Drilling Co. Rig # 9

Is this a Prorated Field? yes X no  
Target Formation(s): Lower Arbuckle  
Nearest lease or unit boundary: 330'  
Ground Surface Elevation: Approx 2100 feet MSL  
Domestic well within 330 feet: yes X no  
Municipal well within one mile: yes X no  
Depth to bottom of fresh water: 500 120  
Depth to bottom of usable water: 1025 950  
Surface Pipe by Alternate: 1 X 2  
Length of Surface Pipe Planned to be set: 200  
Length of Conductor pipe required: none  
Projected Total Depth: 3750  
Formation at Total Depth: Lower Arbuckle  
Water Source for Drilling Operations:  
well X farm pond other

Well Drilled For: Well Class: Type Equipment:  
... Oil ... Inj X Infield X Mud Rotary  
... Gas ... Storage ... Pool Ext. ... Air Rotary  
... OWWO X Disposal ... Wildcat ... Cable  
... Seismic; ... # of Holes

If OWWO: old well information as follows:  
Operator: \_\_\_\_\_  
Well Name: \_\_\_\_\_  
Comp. Date: \_\_\_\_\_ Old Total Depth \_\_\_\_\_

Directional, Deviated or Horizontal wellbore? yes X no  
If yes, total depth location: \_\_\_\_\_

AFFIDAVIT

X alt 2 completion

The undersigned hereby affirms that the drilling, completion and eventual plugging of this well will comply with K.S.A. 55-101, et. seq.

It is agreed that the following minimum requirements will be met:

1. The appropriate district office shall be notified before setting surface pipe;
2. The minimum amount of surface pipe as specified above shall be set by circulating cement to the top; in all cases surface pipe shall be set through all unconsolidated materials plus a minimum of 20 feet into the underlying formation;
3. If the well is dry, a plugging proposal shall be submitted to the district office. An agreement between the operator and the district office on plug length and placement is necessary prior to plugging;
4. The appropriate district office will be notified before well is either plugged or production casing is cemented in;
5. If an Alternate II completion, production pipe shall be cemented from below any usable water to surface within 120 days of spud date. In all cases, notify district office prior to any cementing.

I hereby certify that the statements made herein are true and to the best of my knowledge and belief.

Date: 4-19-91 Signature of Operator Mary Lou Strawn Title Owner - Operator

RECEIVED  
STATE CORPORATION COMMISSION  
APR 24 1991  
CONSERVATION DIVISION  
Wichita, Kansas

FOR KCC USE:

API # 15- 163-23,167-00-00  
 Conductor pipe required None feet  
 Minimum surface pipe required 300 feet per Alt. 0  
 Approved by: MDW 4-24-91  
 EFFECTIVE DATE: 4-29-91  
 This authorization expires: 10-24-91  
 (This authorization void if drilling not started within 6 months of effective date.)  
 Spud date: \_\_\_\_\_ Agent: \_\_\_\_\_

17  
9  
18W

REMEMBER TO:

- File Drill Pit Application (form CDP-1) with Intent to Drill;
- File Completion Form ACO-1 within 120 days of spud date;
- File acreage attribution plat according to field proration orders;
- Notify appropriate district office 48 hours prior to workover or re-entry;
- Submit plugging report (CP-4) after plugging is completed;
- Obtain written approval before disposing or injecting salt water.

**PLAT OF ACREAGE ATTRIBUTABLE TO A WELL**

State Corporation Commission, Conservation Division  
200 Colorado Derby Bldg. Wichita, Kansas 67202

OPERATOR The Gene Brown Company LOCATION OF WELL:  
 LEASE Stahl 4950 feet north of SE corner  
 WELL NUMBER SWD #1 3300 feet west of SE corner  
 FIELD Mchale NW/4 Sec. 17 T 9 R 18  W  
 COUNTY Rooks  
 NO. OF ACRES ATTRIBUTABLE TO WELL one IS SECTION X REGULAR  IRREGULAR?  
 DESCRIPTION OF ACREAGE 160 acre IF IRREGULAR, LOCATE WELL FROM NEAREST  
 CORNER BOUNDARY.

NOTE: If plat depicted is insufficient for your circumstances, you may attach your own scaled or surveyed plat.

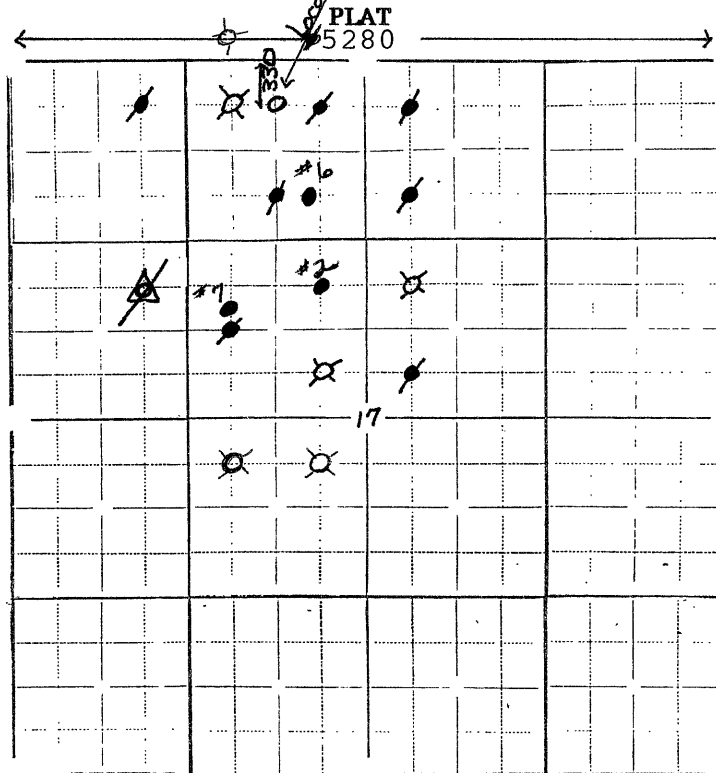

C-N/2 - NE/4 - NW/4

In plotting the proposed location of the well, you must show:

- 1) The manner in which you are using the depicted plat by identifying section lines, i.e. 1 section, 1 section with 8 surrounding partial sections, 4 sections, 16 sections, etc.;
- 2) the well's location relative to the location of other wells producing from the same common source of supply in adjoining drilling units, pursuant to K.A.R. 82-3-108, 82-3-207, 82-3-312, or special orders of the Commission;
- 3) the distance of the proposed drilling location from the section's east and south lines; and
- 4) the distance to the nearest lease or unit boundary line.

I hereby certify that the statements made herein are true and to the best of my knowledge and belief.

Signature of Operator or Agent Mary Lou Brown  
 Date 4-19-91 Title Owner - Operator