

ORIGINAL

SIDE ONE

STATE CORPORATION COMMISSION OF KANSAS
OIL & GAS CONSERVATION DIVISION
WELL COMPLETION FORM
ACO-1 WELL HISTORY
DESCRIPTION OF WELL AND LEASE

API NO. 15- 073-23,655-00-00

County GREENWOOD

SE SE SW Sec. 22 Twp. 23S Rge. 10 East
West

330 Ft. North from Southeast Corner of Section

2850 Ft. West from Southeast Corner of Section
(NOTE: Locate well in section plat below.)

Lease Name PEARSON Well # 13

Field Name BURKETT

Producing Formation BARTLESVILLE

Elevation: Ground 1416 KB _____

Total Depth 2368 PBDT 2355

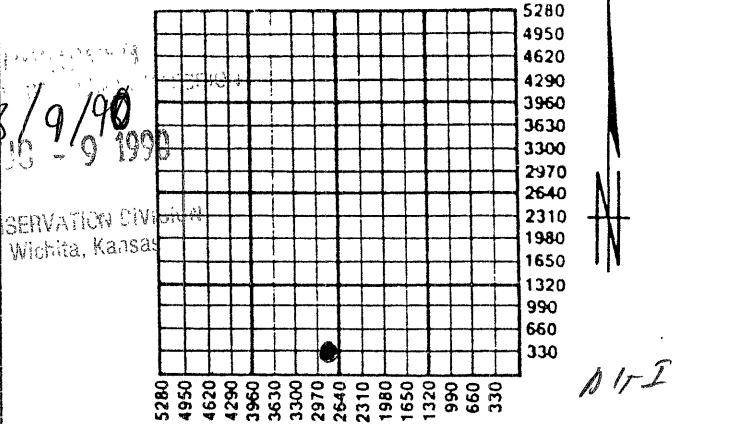

Amount of Surface Pipe Set and Cemented at 202 Feet

Multiple Stage Cementing Collar Used? _____ Yes No

If yes, show depth set _____ Feet

If Alternate II completion, cement circulated from _____

feet depth to _____ w/ _____ sx cmt.

Operator: License # 5556

Name: VIVA OIL CO., INC.

Address 101 WEST 10TH AVENUE

City/State/Zip NORTH KANSAS CITY, MO 64116

Purchaser: TEXACO TRADING & TRANSPORTATION

Operator Contact Person: VICKIE L. TURNER

Phone (816) 421-5636

Contractor: Name: F.D. GAINES DRILLING

License: 5930 STATE _____

Wellsite Geologist: DEAN SEEBER

Designate Type of Completion
 New Well _____ Re-Entry _____ Workover

Oil _____ SWD _____ Temp. Abd.
_____ Gas _____ Inj _____ Delayed Comp.

_____ Dry _____ Other (Core, Water Supply, etc.)

If **OWMO**: old well info as follows:

Operator: _____

Well Name: _____

Comp. Date _____ Old Total Depth _____

Drilling Method:
 Mud Rotary _____ Air Rotary _____ Cable

5-24-90 5-31-90 6-27-90
Spud Date Date Reached TD Completion Date

INSTRUCTIONS: This form shall be completed in triplicate and filed with the Kansas Corporation Commission, 200 Colorado Derby Building, Wichita, Kansas 67202, within 120 days of the spud date of any well. Rule 82-3-130, 82-3-107 and 82-3-106 apply. Information on side two of this form will be held confidential for a period of 12 months if requested in writing and submitted with the form. See rule 82-3-107 for confidentiality in excess of 12 months. One copy of all wireline logs and drillers time log shall be attached with this form. ALL CEMENTING TICKETS MUST BE ATTACHED. Submit CP-4 form with all plugged wells. Submit CP-111 form with all temporarily abandoned wells. Any recompletion, workover or conversion of a well requires filing of ACO-2 within 120 days from commencement date of such work.

All requirements of the statutes, rules and regulations promulgated to regulate the oil and gas industry have been fully complied with and the statements herein are complete and correct to the best of my knowledge.

Signature Vickie L. Turner

Title VICE PRESIDENT Date 8-7-90

Subscribed and sworn to before me this 7TH day of AUGUST, 19 90.

Notary Public TERRI L. GUSTIN

Date Commission Expires 12-21-93

TERRI L. GUSTIN
Notary Public-State of Missouri
Commissioned in Clay County
My Commission Expires December 21, 1993

K.C.C. OFFICE USE ONLY		
F	Letter of Confidentiality Attached	
C	<input checked="" type="checkbox"/> Wireline Log Received	
C	<input type="checkbox"/> Drillers Timelog Received	
Distribution		
<input checked="" type="checkbox"/> KCC	<input type="checkbox"/> SWD/Rep	<input type="checkbox"/> NGPA
<input type="checkbox"/> KGS	<input type="checkbox"/> Plug	<input type="checkbox"/> Other
(Specify)		

SIDE TWO

Operator Name VIVA OIL CO., INC. Lease Name PEARSON Well # 13
 Sec. 22 Twp. 23S Rge. 10 East West
 County GREENWOOD

INSTRUCTIONS: Show important tops and base of formations penetrated. Detail all cores. Report all drill stem tests giving interval tested, time tool open and closed, flowing and shut-in pressures, whether shut-in pressure reached static level, hydrostatic pressures, bottom hole temperature, fluid recovery, and flow rates if gas to surface during test. Attach extra sheet if more space is needed. Attach copy of log.

Drill Stem Tests Taken Yes No
 (Attach Additional Sheets.)
 Samples Sent to Geological Survey Yes No
 Cores Taken Yes No
 Electric Log Run Yes No
 (Submit Copy.)
 MARMATON 1903
 CHEROKEE 2060
 ARDMORE 2141
 CATTLEMAN NO SAND DEVELOPMENT
 BARTLESVILLE 2289
 BASE OF BARTLESVILLE 2331
 RTD 2368

Formation Description

Log Sample

Name	Top	Bottom
CATTLEMAN	2190	2224
NO POROUS SAND DEVELOPMENT		
BARTLESVILLE		
SANDSTONE, SHALEY	2289	2331

CASING RECORD New Used
 Report all strings set-conductor, surface, intermediate, production, etc.

Purpose of String	Size Hole Drilled	Size Casing Set (In O.D.)	Weight Lbs./Ft.	Setting Depth	Type of Cement	# Sacks Used	Type and Percent Additives
SURFACE	12-1/2	8-5/8		202	COMMON	125	3% CACL
PRODUCTION	7-7/8	5-1/2	15#	2367	COMMON	200	2% GEL

Shots Per Foot	PERFORATION RECORD Specify Footage of Each Interval Perforated	Acid, Fracture, Shot, Cement Squeeze Record (Amount and Kind of Material Used)	Depth
1 @	2291, 2293, 2296, 2300, 2302, 2305, 2307, 2310, 2312, 2315, 2322 AND 2327	FRAC W/ 105 SX SAND, 400# GEL, 475 BBLs WTR, 300 GALS 15% NE ACID	2291- 2327

TUBING RECORD Size 2-3/8 Set At 2288 Packer At NONE Liner Run Yes No

Date of First Production 7-8-90 Producing Method Flowing Pumping Gas Lift Other (Explain)

Estimated Production Per 24 Hours Oil 5.5 Bbls. Gas 12 Mcf Water 39 Bbls. Gas-Oil Ratio 39 Gravity

Disposition of Gas: Vented Sold Used on Lease (If vented, submit ACO-18.)

METHOD OF COMPLETION

Open Hole Perforation Dually Completed Commingled

Other (Specify) _____

Production Interval 2291-2327

15-073-23655-00-00
ORIGINAL



GAINES OIL & DRILLING

FRANKLIN D. GAINES - OWNER
P.O. BOX 219
AUGUSTA, KANSAS 67010
316-775-2182



June 6, 1990

DRILLER'S REPORT

OPERATOR: Viva Oil Co., Inc. (#5556)
101 West 10th Avenue
North Kansas City, MO 64116

CONTRACTOR: Franklin D. Gaines (#5930)
P. O. Box 219
Augusta, KS 67010

LEASE & WELL NO.: Pearson No. 13
LEGAL: SE SE SW Section 22, Township 23, Range 10 East, Greenwood
Co., KS

WELL COMMENCED: 5/24/90
WELL COMPLETED: 5/31/90

CASING REPORT: Set 201' of 8-5/8" surface casing
Cemented by United Cementing

Ran 2368' of 5½" longstring
Cemented by United Cementing

FORMATION TOPS: None reported by geologist

RECEIVED
STAFF OFFICE
8/18/90
JUG - 9 1990
CONSERVATION DIVISION
Wichita, Kansas

SERVICE TICKET

UNITED CEMENTING & ACID CO., INC.

No. 679

BOX 712

EL DORADO, KANSAS 67042

PHONE AC 316-321-4680

DATE 5-31-90 COUNTY 9W
 CHG. TO: Uva oil co ADDRESS _____
 CITY _____ STATE _____ ZIP _____
 LEASE & WELL NO. Reason #13 SEC. _____ TWP. _____ RNG. _____
 CONTRACTOR Haines Drilling Co. TIME ON LOCATION 8:11 pm
 KIND OF JOB Cementing LS NW

SERVICE CHARGE: 625.00

QUANTITY	MATERIAL USED	TYPE		
200	SAYS CLASS A		4.65	930.00 *
4	SAYS Gel		8.00	32.00 *
1	5 1/2 Guide Shoe			76.00 *
1	5 1/2 AFU Insert Valve			105.25 *
3	5 1/2 Centralizers		26.60 ea	79.80 *
204	BULK CHARGE X .75			153.00 *
193	BULK TRK. MILES X .60 X 10.			114.00 *
	PUMP TRK. MILES			
4-5 1/2	PLUGS Top Rubber			35.00 *
	SALES TAX			80.07
	TOTAL			2230.12

T. D. 2368' STATE OF KANSAS PERMITS DIVISION
 SIZE HOLE 7 7/8" AUG - 9 1990
 MAX. PRESS. 900
 PLUG DEPTH 2325' CONSERVATION DIVISION Wichita Kansas
 PLUG USED Rubber
 TIME FINISHED 12:20 PM
6-1-90

REMARKS: 200 say cement
2 90 well
VOCES 150
1540-13

EQUIPMENT USED

NAME	UNIT NO.	NAME	UNIT NO.
<u>Rob</u>	<u>Roger</u>		
<u>Thomas</u>			

CEMENTER OR TREATER _____ OWNER'S REP. _____

SERVICE TICKET

UNITED CEMENTING & ACID CO., INC.

NO 327

BOX 712

EL DORADO, KANSAS 67042

PHONE AC 316-321-4680

DATE 5-24-90 COUNTY Greenwood

CHG. TO: VIKI OIL CO. INC. ADDRESS

CITY STATE ZIP

LEASE & WELL NO. Pearson #13 SEC. TWP. RNG.

CONTRACTOR Gains Dry Co TIME ON LOCATION 6:30 AM

KIND OF JOB Cement surface pipe

SERVICE CHARGE: 275.00

QUANTITY	MATERIAL USED TYPE	
125	8 gal @ 390 chloride @ 465	581.25
4	gal Chloride @ 20.00	80.00
129	BULK CHARGE 8 gal @ .25	96.75
22	BULK TRK. MILES (6.50 x 60 x 22)	85.80
	PUMP TRK. MILES	
1-8 5/8	PLUGS top wooden plug @	28.00
	SALES TAX	45.77
	TOTAL	1,192.57

T. D. 212 AUG - 9 1990

SIZE HOLE 12 1/2

MAX. PRESS.

PLUG DEPTH 190

PLUG USED

REMARKS: Cement circulated to top.

CSG. SET AT 202 VOLUME

TBG SET AT VOLUME

SIZE PIPE 8 5/8

PKER DEPTH

TIME FINISHED 8:00 AM

EQUIPMENT USED

NAME	UNIT NO.	NAME	UNIT NO.
Wagon			
Heart			
Deland	#13	Jay McSweeney	

CEMENTER OR TREATER OWNER'S REP.