

MAR 01 2007

CONSERVATION DIVISION
WICHITA, KS

KANSAS CORPORATION COMMISSION
OIL & GAS CONSERVATION DIVISION
WELL PLUGGING APPLICATION
Please TYPE Form and File ONE Copy

Form CP-1
September 2003
This Form must be Typed
Form must be Signed
All blanks must be Filled

API # 15 - 051-24346 -00-00 (Identifier Number of this well). This must be listed for wells drilled since 1967; if no API # was issued, indicate original spud or completion date 11/03/1985.

Well Operator: Knighton Oil Company, Inc. KCC License #: 5010
(Owner / Company Name) (Operator's)

Address: 221 S. Broadway, Suite 710 City: Wichita

State: Kansas Zip Code: 67202 Contact Phone: (316) 264 - 7918

Lease: Berland Well #: 10 Sec. 28 Twp. 11 S. R. 19 East West

Approx. SW SE NE E/2 E/2 SE Spot Location / QQQQ County: Ellis

1410 Feet (in exact footage) From North / South (from nearest outside section corner) Line of Section (Not Lease Line)

450 Feet (in exact footage) From East / West (from nearest outside section corner) Line of Section (Not Lease Line)

Check One: Oil Well Gas Well D&A Cathodic Water Supply Well
 SWD Docket # _____ ENHR Docket # _____ Other: _____

Conductor Casing Size: _____ Set at: _____ Cemented with: _____ Sacks

Surface Casing Size: 8 5/8" Set at: 216' Cemented with: 150 Sacks

Production Casing Size: 5 1/2' Set at: 3694' Cemented with: 400 Sacks

List (ALL) Perforations and Bridgeplug Sets: Pf 3643-47, 3631-34, 3627-29, 3506-10, 3105-3110

Elevation: 2115 (G.L. / K.B.) T.D.: 3700 PBTD: 3694 Anhydrite Depth: 1409
(Stone Corral Formation)

Condition of Well: Good Poor Casing Leak Junk in Hole

Proposed Method of Plugging (attach a separate page if additional space is needed): According to the rules and regulations of the State Corporation Commission.

Is Well Log attached to this application as required? Yes No Is ACO-1 filed? Yes No

If not explain why? _____

Plugging of this Well will be done in accordance with K.S.A. 55-101 et. seq. and the Rules and Regulations of the State Corporation Commission.

List Name of Company Representative authorized to be in charge of plugging operations: Ken Werner, Knighton Oil Company, Inc.

Phone: (316) 264 - 7918

Address: 221 S Broadway, Suite 710 Wichita, Kansas 67202 City / State: Wichita, Kansas 67202

Plugging Contractor: Express Well Service KCC License #: 6426
(Company Name) (Contractor's)

Address: P.O. Box 19 Victoria, KS 67671 Phone: (785) 735 - 9405

Proposed Date and Hour of Plugging (if known?): March 15, 2007

Payment of the Plugging Fee (K.A.R. 82-3-118) will be guaranteed by Operator or Agent

Date: 3/01/07 Authorized Operator / Agent: [Signature]
(Signature)

Mail to: KCC - Conservation Division, 130 S. Market - Room 2078, Wichita, Kansas 67202

STATE CORPORATION COMMISSION OF KANSAS
OIL & GAS CONSERVATION DIVISION

WELL COMPLETION OR RECOMPLETION FORM
ACO-1 WELL HISTORY

DESCRIPTION OF WELL AND LEASE

Operator: License # 5010
Name ... Knighton Oil Company, Inc.
Address 710 Petroleum Building
City/State/Zip Wichita, Kansas 67202

Purchaser... Clear Creek

Operator Contact Person Earl M. Knighton, Jr.
Phone (316) 264-7918

Contractor: License # 4083
Name Western Kansas Drilling

Wellsite Geologist N/A
Phone

Designate Type of Completion
 New Well Re-Entry Workover

Oil SWD Temp Abd
 Gas Inj Delayed Comp.
 Dry Other (Core, Water Supply etc.)

If OWWO: old well info as follows:
Operator
Well Name
Comp. Date Old Total Depth

WELL HISTORY

Drilling Method:
 Mud Rotary Air Rotary Cable

11/03/85 11/09/85 12/20/85
Spud Date Date Reached TD Completion Date
3,700' 3,661'
Total Depth PBD

Amount of Surface Pipe Set and Cemented at 216 feet
Multiple Stage Cementing Collar Used? Yes No
If yes, show depth set feet
If alternate 2 completion, cement circulated from 1,360 feet depth to Surface / 310 SX cmt

API No. 15-051-24-346

County Ellis
Approx. East West
SE NE SE Sec. 28 Twp. 11S Rge. 19

1,410 Ft North from Southeast Corner of Section
450 Ft West from Southeast Corner of Section
(Note: Locate well in section plat below)

Lease Name Berland Well # 10

Field Name Solomon

Producing Formation Arbuckle

Elevation: Ground 2,115 KB 2,120

Section Plat

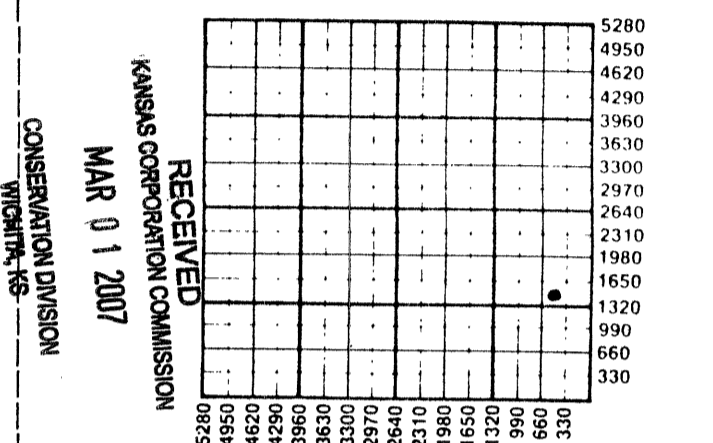

WATER SUPPLY INFORMATION

Disposition of Produced Water: Disposal Repressuring
Docket #

Questions on this portion of the ACO-1 call:
Water Resources Board (913) 296-3717

Source of Water:
Division of Water Resources Permit #

Groundwater Ft North from Southeast Corner (Well) Ft West from Southeast Corner
Sec Twp Rge East West

Surface Water Ft North from Southeast Corner (Stream, pond etc) Ft West from Southeast Corner
Sec Twp Rge East West

Other (explain) Hauled by Drilling Contractor (purchased from city, R.W.D. #)

INSTRUCTIONS: This form shall be completed in duplicate and filed with the Kansas Corporation Commission, 200 Colorado Derby Building, Wichita, Kansas 67202, within 90 days after completion or recompletion of any well. Rule 82-3-130 and 82-3-107 apply. Information on side two of this form will be held confidential for a period of 12 months if requested in writing and submitted with the form. See rule 82-3-107 for confidentiality in excess of 12 months. One copy of all wireline logs and drillers time log shall be attached with this form. Submit CP-4 form with all plugged wells. Submit CP-111 form with all temporarily abandoned wells.

All requirements of the statutes, rules and regulations promulgated to regulate the oil and gas industry have been fully complied with and the statements herein are complete and correct to the best of my knowledge.

Signature Earl M. Knighton, Jr.
Title President Date 2/07/86

Subscribed and sworn to before me this 7th day of February 1986
Notary Public Sarah A. McGehee
Date of Expiration December 11, 1989

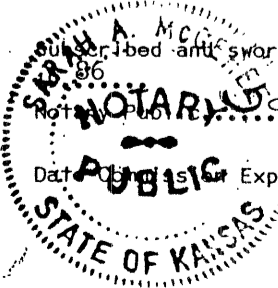

K.C.C. OFFICE USE ONLY
F Letter of Confidentiality Attached
C Wireline Log Received
C Drillers Timelog Received
Distribution
 KCC SWD/Rep NGPA
 KGS Plug Other (Specify)

Sec. 11 Twp. 11S Rge. 19E

SIDE TWO

Operator Name Knighton Oil Company, Inc Lease Name Berland Well # 10

Sec 28 Twp 11S Rge 19 East West County Ellis

WELL LOG

INSTRUCTIONS: Show important tops and base of formations penetrated. Detail all cores. Report all drill stem tests giving interval tested, time tool open and closed, flowing and shut-in pressures, whether shut-in pressure reached static level, hydrostatic pressures, bottom hole temperature, fluid recovery, and flow rates if gas to surface during test. Attach extra sheet if more space is needed. Attach copy of log.

Drill Stem Tests Taken Yes No
 Samples Sent to Geological Survey Yes No
 Cores Taken Yes No

Formation Description
 Log Sample

Name	Top	Bottom
Anhydrite	1,409	1,449
Topeka	3,075	3,300
Heebner	3,300	3,304
Toronto	3,318	3,340
Lansing	3,340	3,567
BKC	3,567	---
Conglomerate	3,596	3,610
Simpson	3,610	3,631
Arbuckle	3,631	RTD
RTD	3,700	

RECEIVED
 KANSAS CORPORATION COMMISSION
 MAR 01 2007
 CONSERVATION DIVISION
 WICHITA, KS

CASING RECORD <input type="checkbox"/> New <input checked="" type="checkbox"/> Used							
Report all strings set-conductor, surface, intermediate, production, etc.							
Purpose of String	Size Hole Drilled	Size Casing Set (in O.D.)	Weight Lbs/Ft.	Setting Depth	Type of Cement	#Sacks Used	Type and Percent Additives
Surface Casing	12 1/2"	8-5/8"	20	216'	60/40 Poz	150	2% Gal. 3% CaCl ₂
Production Csg	7-7/8"	5 1/2"	14	3,694'	60/40 Poz	150	2% Gal. 10% Salt
					65/35 Light	250	2% Gal. 10% Salt
PERFORATION RECORD				Acid, Fracture, Shot, Cement Squeeze Record			
Shots Per Foot	Specify Footage of Each Interval Perforated			(Amount and Kind of Material Used)		Depth	
4	1,360 - 1,361			Squeeze Dakota with 310 sx			
				(50 CLA & 260 HAL Light			
				Circulated)			
4	3,627 - 3,629 3,631 - 3,634						
TUBING RECORD				Liner Run <input type="checkbox"/> Yes <input checked="" type="checkbox"/> No			
Date of First Production	Producing Method						
12/20/85	<input type="checkbox"/> Flowing <input checked="" type="checkbox"/> Pumping <input type="checkbox"/> Gas Lift <input type="checkbox"/> Other (explain).....						
Estimated Production Per 24 Hours	Oil	Gas	Water	Gas-Oil Ratio	Gravity		
	10 Bbls	MCF	200 Bbls	CFPB			

METHOD OF COMPLETION

Production Interval

Disposition of gas: Vented Open Hole Perforation
 Sold Other (Specify) 3,627 - 3,629
 Used on Lease Dually Completed 3,631 - 3,634
 Commingled

SKETCH

Show all casing strings, tubing strings, and their O. D. sizes, plug back depth, total depth, casing seats, perforations, liner, screen, packer, and tubing anchor, etc. Show location of equipment in tubing string, junk in the hole, name of producing formations, pumping equipment, etc. All measurements below should be rounded off to nearest foot.

RECORD

Give details of casing, tubing, and rod and pump setting below. Show depth to top of items, such as pump, packer, landing nipples, safety joint, tubing anchor, and restrictions in tubing, etc. Give information on how to release packer.

TUBING RECORD

- 1-Lufkin D-114 Pumping Unit
- 1-Witte D-28 Engine
- 119 Joints 2 7/8" 8 rd EUE Tubing
- 27 7/8" Rods
- 127 3/4" Rods

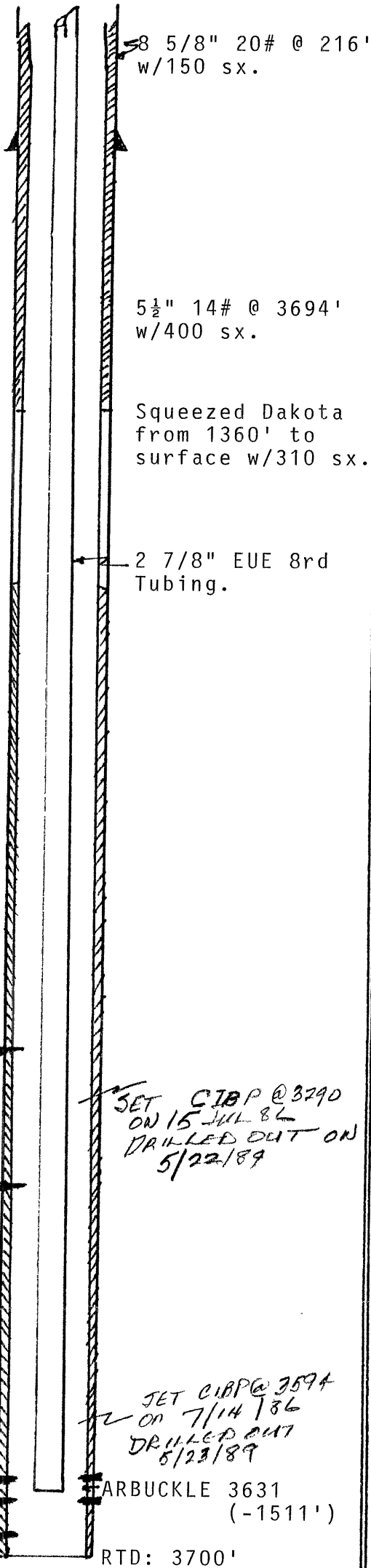

Top of cement @ 1510'

15 Jul 86
TOPEKA
3105-3110
(2 SPF)

14 Jul 86
HANSING
3506-3510
(2 SPF)

SET CIBP @ 3790
ON 15 JUL 86
DRILLED OUT ON
5/22/89

SET CIBP @ 3594
ON 7/14/86
DRILLED OUT
5/23/89

Perforations:
3627-29 (4 spf)
3631-34 (4 spf)
3645-47 (4 spf)
5/23/89

BARBUCKLE 3631
(-1511')

RTD: 3700'

KANSAS

CORPORATION COMMISSION

Kathleen Sebelius, Governor Brian J. Moline, Chair Robert E. Krehbiel, Commissioner Michael C. Moffet, Commissioner

NOTICE OF RECEIPT OF WELL PLUGGING APPLICATION (CP-1)

Knighton Oil Company, Inc.
221 S. Broadway, Ste. 710
Wichita, KS 67202-4214

March 06, 2007

Re: BERLAND #10
API 15-051-24346-00-00
SWSENESE 28-11S-19W, 1410 FSL 450 FEL
ELLIS COUNTY, KANSAS

Dear Operator:

This letter is to notify you that the Conservation Division is in receipt of your plugging proposal, form CP-1, for the above-captioned well.

Your CP-1 has been reviewed by the Conservation Division central office for completeness and to verify license numbers. The plugging proposal will now be forwarded to the district office listed below for review of your proposed method of plugging.

Please contact the district office for approval of your proposed plugging method at least five (5) days before plugging the well, pursuant to K.A.R. 82-3-113 (b). If a workover pit will be used during the plugging of the well it must be permitted. A CDP-1 form must be filed and approved prior to the use of the pit.

The Conservation Division's review of form CP-1, either in the central or district office, does not include an inquiry into well ownership or the filing operator's legal right to plug the well.

This notice in no way constitutes authorization to plug the above-captioned well by persons not having legal rights of ownership or interest in the well. This notice is void after ninety (90) days from the above date.

Sincerely



Barry Metz
Deputy Director

District: #4
2301 E. 13th
Hays, KS 67601
(785) 625-0550