

For KCC Use:  
 Effective Date: 4-15-07  
 District # 4  
 SGA?  Yes  No

KANSAS CORPORATION COMMISSION  
 OIL & GAS CONSERVATION DIVISION  
**NOTICE OF INTENT TO DRILL**

Form C-1  
 December 2002  
**Form must be Typed**  
**Form must be Signed**  
**All blanks must be Filled**

Must be approved by KCC five (5) days prior to commencing well

Expected Spud Date May 1, 2007  
month day year

Spot NW SW NE NE/4 Sec. 26 Twp. 9S S. R. 19  
 East  
 West  
725 feet from  N /  S Line of Section  
1025 feet from  E /  W Line of Section

OPERATOR: License# 6931 ✓  
 Name: Bowman Oil Company  
 Address: 805 Codell Road  
Codell, Kansas 67663  
 City/State/Zip:  
 Contact Person: Louis "Don" Bowman or William "Bill" Bowman  
 Phone: 785-434-2286 M-F 7-12 AM

Is SECTION  Regular  Irregular?  
 (Note: Locate well on the Section Plat on reverse side)  
 County: Rooks County, Kansas

CONTRACTOR: License# 33575 ✓  
 Name: WW Drilling LLC

Lease Name: Saindon M. Well #: 1

Field Name:  
 Is this a Prorated / Spaced Field?  Yes  No  
 Target Formation(s): Arbuckle

<b>Well Drilled For:</b>	<b>Well Class:</b>	<b>Type Equipment:</b>
<input checked="" type="checkbox"/> Oil <input type="checkbox"/> Gas <input type="checkbox"/> OWWO <input type="checkbox"/> Seismic; # of Holes <input type="checkbox"/> Other	<input type="checkbox"/> Enh Rec <input type="checkbox"/> Storage <input type="checkbox"/> Disposal <input type="checkbox"/> Other	<input checked="" type="checkbox"/> Intfield <input type="checkbox"/> Pool Ext. <input type="checkbox"/> Wildcat <input type="checkbox"/> Other
		<input checked="" type="checkbox"/> Mud Rotary <input type="checkbox"/> Air Rotary <input type="checkbox"/> Cable

Nearest Lease or unit boundary: 725'  
 Ground Surface Elevation: 2150' feet MSL

Water well within one-quarter mile:  Yes  No  
 Public water supply well within one mile:  Yes  No

Depth to bottom of fresh water: 100  
 Depth to bottom of usable water: 850

Surface Pipe by Alternate:  1  2  
 Length of Surface Pipe Planned to be set: 200'

Length of Conductor Pipe required: none  
 Projected Total Depth: 3750'

Formation at Total Depth: Arbuckle  
 Water Source for Drilling Operations:  
 Well  Farm Pond  Other X

DWR Permit #: \_\_\_\_\_  
 (Note: Apply for Permit with DWR )

Will Cores be taken?  Yes  No  
 If Yes, proposed zone: \_\_\_\_\_

If OWWO: old well information as follows:  
 Operator: \_\_\_\_\_  
 Well Name: \_\_\_\_\_  
 Original Completion Date: \_\_\_\_\_ Original Total Depth: \_\_\_\_\_

Directional, Deviated or Horizontal wellbore?  Yes  No

If Yes, true vertical depth: \_\_\_\_\_

Bottom Hole Location: \_\_\_\_\_

KCC DKT #: \_\_\_\_\_

**AFFIDAVIT**

The undersigned hereby affirms that the drilling, completion and eventual plugging of this well will comply with K.S.A. 55 et. seq.  
 It is agreed that the following minimum requirements will be met:

RECEIVED  
 KANSAS CORPORATION COMMISSION

APR 09 2007

1. Notify the appropriate district office **prior** to spudding of well;
2. A copy of the approved notice of intent to drill **shall be** posted on each drilling rig;
3. The minimum amount of surface pipe as specified below **shall be set** by circulating cement to the top; in all cases surface pipe **shall be set** through all unconsolidated materials plus a minimum of 20 feet into the underlying formation.
4. If the well is dry hole, an agreement between the operator and the district office on plug length and placement is necessary **prior** to cementing;
5. The appropriate district office will be notified before well is either plugged or production casing is cemented in;
6. If an ALTERNATE II COMPLETION, production pipe shall be cemented from below any usable water to surface within **120 days** of spud date.  
 Or pursuant to Appendix "B" - Eastern Kansas surface casing order #133,891-C, which applies to the KCC District 3 area, alternate II cementing must be completed within 30 days of the spud date or the well shall be plugged. **In all cases, NOTIFY district office** prior to any cementing.

I hereby certify that the statements made herein are true and to the best of my knowledge and belief.

Date: April 4, 2007 Signature of Operator or Agent: Connie Jo Austin Title: Agent

**For KCC Use ONLY**  
 API # 15 - 163-23605-00-00  
 Conductor pipe required NONE feet  
 Minimum surface pipe required 200 feet per Alt. X 2  
 Approved by: WTHM 4-10-07  
 This authorization expires: 10-10-07  
 (This authorization void if drilling not started within 6 months of approval date.)  
 Spud date: \_\_\_\_\_ Agent: \_\_\_\_\_

**Remember to:**

- File Drill Pit Application (form CDP-1) with Intent to Drill;
- File Completion Form ACO-1 within 120 days of spud date;
- File acreage attribution plat according to field proration orders;
- Notify appropriate district office 48 hours prior to workover or re-entry;
- Submit plugging report (CP-4) after plugging is completed;
- Obtain written approval before disposing or injecting salt water.

- If this permit has expired (See: authorized expiration date) please check the box below and return to the address below.  
 Well Not Drilled - Permit Expired  
 Signature of Operator or Agent: \_\_\_\_\_  
 Date: \_\_\_\_\_

Mail to: KCC - Conservation Division, 130 S. Market - Room 2078, Wichita, Kansas 67202

26  
 9  
 19W

**IN ALL CASES PLOT THE INTENDED WELL ON THE PLAT BELOW**

*Plat of acreage attributable to a well in a prorated or spaced field*

**If the intended well is in a prorated or spaced field, please fully complete this side of the form.** If the intended well is in a prorated or spaced field complete the plat below showing that the well will be properly located in relationship to other wells producing from the common source of supply. Please show all the wells and within 1 mile of the boundaries of the proposed acreage attribution unit for gas wells and within 1/2 mile of the boundaries of the proposed acreage attribution unit for oil wells.

API No. 15 - 163-23605-00-00  
 Operator: Bowman Oil Company  
 Lease: Saindon M.  
 Well Number: 1  
 Field: \_\_\_\_\_  
 Number of Acres attributable to well: NE/4  
 QTR / QTR / QTR of acreage: NW SW NE - NE/4

Location of Well: County: Rooks County, Kansas  
 \_\_\_\_\_ 725 feet from  N /  S Line of Section  
 \_\_\_\_\_ 1025 feet from  E /  W Line of Section  
 Sec. 26 Twp. 9S S. R. 19  East  West  
 Is Section:  Regular or  Irregular  
**If Section is Irregular, locate well from nearest corner boundary.**  
 Section corner used:  NE  NW  SE  SW

**PLAT**

(Show location of the well and shade attributable acreage for prorated or spaced wells.)  
 (Show footage to the nearest lease or unit boundary line.)

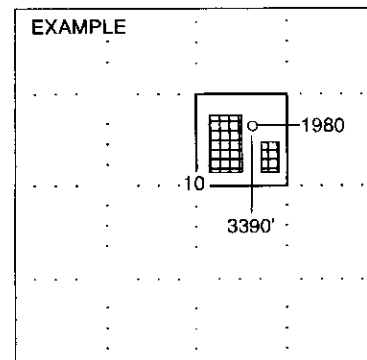
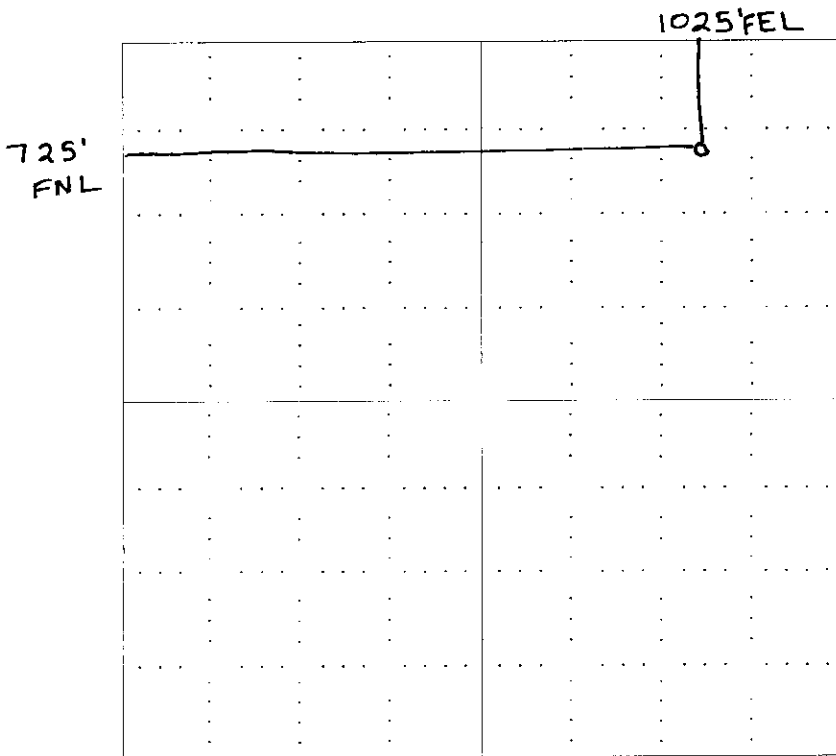

SEWARD CO.

**NOTE: In all cases locate the spot of the proposed drilling locaton.**

**RECEIVED**  
 KANSAS CORPORATION COMMISSION

**APR 09 2007**

**CONSERVATION DIVISION**  
 WICHITA, KS

**In plotting the proposed location of the well, you must show:**

1. The manner in which you are using the depicted plat by identifying section lines, i.e. 1 section, 1 section with 8 surrounding sections, 4 sections, etc.
2. The distance of the proposed drilling location from the section's south / north and east / west.
3. The distance to the nearest lease or unit boundary line.
4. If proposed location is located within a prorated or spaced field a certificate of acreage attribution plat must be attached: (CO-7 for oil wells; CG-8 for gas wells).

KANSAS CORPORATION COMMISSION  
OIL & GAS CONSERVATION DIVISION

Form CDP-1  
April 2004  
Form must be Typed

APPLICATION FOR SURFACE PIT

Submit in Duplicate

Operator Name: <b>Bowman Oil Company</b>		License Number: <b>6931</b>
Operator Address: <b>805 Codell Road Codell, Kansas 67663</b>		
Contact Person: <b>Louis "Don" Bowman/William "Bill" Bowman</b>		Phone Number: ( <b>785</b> ) <b>434 - 2286 MF 7-12AM</b>
Lease Name & Well No.: <b>Saindon M. #1</b>		Pit Location (QQQQ): <b>NW - SW - NE - NE</b>
Type of Pit: <input type="checkbox"/> Emergency Pit <input type="checkbox"/> Burn Pit <input type="checkbox"/> Settling Pit <input checked="" type="checkbox"/> Drilling Pit <input type="checkbox"/> Workover Pit <input type="checkbox"/> Haul-Off Pit <small>(If WP Supply API No. or Year Drilled)</small>	Pit is: <input checked="" type="checkbox"/> Proposed <input type="checkbox"/> Existing If Existing, date constructed: _____ Pit capacity: <b>500</b> (bbls)	Sec. <b>26</b> Twp. <b>9S</b> R. <b>19</b> <input type="checkbox"/> East <input checked="" type="checkbox"/> West <b>725</b> Feet from <input checked="" type="checkbox"/> North / <input type="checkbox"/> South Line of Section <b>1025</b> Feet from <input checked="" type="checkbox"/> East / <input type="checkbox"/> West Line of Section <b>Rooks County, Kansas</b> County
Is the pit located in a Sensitive Ground Water Area? <input type="checkbox"/> Yes <input checked="" type="checkbox"/> No		Chloride concentration: <b>20,000 more or less</b> mg/l <small>(For Emergency Pits and Settling Pits only)</small>
Is the bottom below ground level? <input checked="" type="checkbox"/> Yes <input type="checkbox"/> No	Artificial Liner? <input checked="" type="checkbox"/> Yes <input type="checkbox"/> No	How is the pit lined if a plastic liner is not used?
Pit dimensions (all but working pits): <b>40</b> Length (feet) <b>12</b> Width (feet)    N/A: <b>Steel Pits</b> Depth from ground level to deepest point: <b>6</b> (feet)		
If the pit is lined give a brief description of the liner material, thickness and installation procedure. <b>Standard Black Plastic</b>		Describe procedures for periodic maintenance and determining liner integrity, including any special monitoring. <b>Daily Visual Inspection</b>
Distance to nearest water well within one-mile of pit <b>24-95-19W</b> <b>2700</b> feet    Depth of water well <b>35</b> feet		Depth to shallowest fresh water <b>21</b> feet. Source of information: <input checked="" type="checkbox"/> measured <input type="checkbox"/> well owner <input type="checkbox"/> electric log <input type="checkbox"/> KDWR
<b>Emergency, Settling and Burn Pits ONLY:</b> Producing Formation: _____ Number of producing wells on lease: _____ Barrels of fluid produced daily: _____ Does the slope from the tank battery allow all spilled fluids to flow into the pit? <input type="checkbox"/> Yes <input type="checkbox"/> No		<b>Drilling, Workover and Haul-Off Pits ONLY:</b> Type of material utilized in drilling/workover: <b>Rotary Mud</b> Number of working pits to be utilized: <b>3 pits</b> Abandonment procedure: <b>Will haul waste, and allow pit to air dry and will fill pit back to ground level.</b> Drill pits must be closed within 365 days of spud date.
I hereby certify that the above statements are true and correct to the best of my knowledge and belief.		
_____ April 4, 2007 Date		<b>RECEIVED</b> KANSAS CORPORATION COMMISSION <b>APR 09 2007</b> Signature of Applicant or Agent: <b>Connie Jo Austin</b>
<b>KCC OFFICE USE ONLY</b>		
Date Received: <b>4/9/07</b> Permit Number: _____		Permit Date: <b>4/9/07</b> Lease Inspection: <input type="checkbox"/> Yes <input checked="" type="checkbox"/> No

15-163-23605-00-070