

For KCC Use:  
 Effective Date: 4-15-07  
 District # 2  
 SGA?  Yes  No

KANSAS CORPORATION COMMISSION  
 OIL & GAS CONSERVATION DIVISION  
**NOTICE OF INTENT TO DRILL**

Form C-1  
 December 2002  
 Form must be Typed  
 Form must be Signed  
 All blanks must be Filled

Must be approved by the K.C.C. five (5) days prior to commencing well

Expected Spud Date MARCH 12 2007  
month day year

SE NW SE SE 34 Twp. 18 S. R. 10  East  West  
925 feet from  N /  S Line of Section  
780 feet from  E /  W Line of Section  
 Is SECTION x Regular          Irregular?

OPERATOR: License # 3882 ✓  
 Name: SAMUEL GARY JR. & ASSOCIATES, INC.  
 Address: 1670 BROADWAY, SUITE 3300  
 City/State/Zip: DENVER, CO 80202  
 Contact Person: TOM FERTAL  
 Phone: (303) 831-4673

(Note: Locate well on the Section Plat on Reverse Side)

County: RICE

CONTRACTOR: License 8273 ✓  
 Name: EXCELL SERVICES INC

Lease Name: ZINK Well #: 3-34

Field Name: WILDCAT  
 Is this a Prorated / Spaced Field?  Yes  No

Target Formation(s): ARBUCKLE

Nearest Lease or unit boundary: 780'

Ground Surface Elevation: Est. 1730 feet MSL

Water well within one-quarter mile:  Yes  No

Public water supply well within one mile:  Yes  No

Depth to bottom of fresh water: 125

Depth to bottom of usable water: 230

Surface Pipe by Alternate:  1  2

Length of Surface Pipe Planned to be set: 320'

Length of Conductor pipe required: NONE

Projected Total Depth: 3400'

Formation at Total Depth: ARBUCKLE

Water Source for Drilling Operations:

Well  Farm Pond Other X

DWR Permit #: N/A

(Note: Apply for Permit with DWR )

Will Cores Be Taken?  Yes  No

If yes, proposed zone: N/A

<b>Well Drilled For:</b>	<b>Well Class:</b>	<b>Type Equipment:</b>
<input checked="" type="checkbox"/> Oil	<input type="checkbox"/> Enh Rec	<input checked="" type="checkbox"/> Mud Rotary
<input type="checkbox"/> Gas	<input type="checkbox"/> Storage	<input type="checkbox"/> Air Rotary
<input type="checkbox"/> OWWO	<input type="checkbox"/> Disposal	<input type="checkbox"/> Cable
<input type="checkbox"/> Seismic; # of Holes	<input checked="" type="checkbox"/> Wildcat	
<input type="checkbox"/> Other	<input type="checkbox"/> Other	

If OWWO: old well information as follows:  
 Operator: \_\_\_\_\_  
 Well Name: \_\_\_\_\_  
 Original Completion Date: \_\_\_\_\_ Original Total Depth: \_\_\_\_\_

Directional, Deviated or Horizontal wellbore?  Yes  No

If yes, true vertical depth: \_\_\_\_\_

Bottom Hole Location: \_\_\_\_\_

KCC DKT#: \_\_\_\_\_

**AFFIDAVIT**

The undersigned hereby affirms that the drilling, completion and eventual plugging of this well will comply with K.S.A. 55-101, et. seq. It is agreed that the following minimum requirements will be met:

1. Notify the appropriate district office **prior** to spudding of well;
2. A copy of the approved Notice of Intent to Drill **shall be** posted on each drilling rig;
3. The minimum amount of surface pipe as specified below **shall be set** by circulating cement to the top; in all cases surface pipe shall be set through all unconsolidated materials plus a minimum of 20 feet into the underlying formation;
4. If the well is a dry hole, an agreement between the operator and the district office on plug length and placement is necessary **prior to plugging**;
5. The appropriate district office will be notified before well is either plugged or production casing is cemented in;
6. If an ALTERNATE II COMPLETION, production pipe shall be cemented from below any usable water to surface within **120 days** of spud date. Or pursuant to Appendix "B" - Eastern Kansas surface casing order #133,891-C, which applies to the KCC District 3 area, alternate II cementing must be completed within 30 days of spud date or the well shall be plugged. **In all cases, NOTIFY district office** prior to any cementing.

I hereby certify that the statements made herein are true and to the best of my knowledge and belief.  
 Date: FEBRUARY 27, 2007 Signature of Operator or Agent: Thomas Fertal Title: SR. GEOLOGIST

**Remember to:**

- File Drill Pit Application (Form CDP-1) with Intent to Drill;
  - File Completion Form ACO-1 within 120 days of spud date;
  - File acreage attribution plat according to field proration orders;
  - Notify appropriate district office 48 hours prior to workover or re-entry;
  - Submit plugging report (CP-4) after plugging is completed;
  - Obtain written approval before disposing or injecting salt water.
- If this permit has expired (See: authorized expiration date) please check the box below and return to the address below.

Well Not Drilled - Permit Expired  
 Signature of Operator or Agent: \_\_\_\_\_  
 Date: \_\_\_\_\_

**For KCC use ONLY**  
 API # 15 - 159-22537-00-00  
 Conductor pipe required NONE feet  
 Minimum surface pipe required 250 feet per Alt. 1   
 Approved by: WITM 4-10-07  
 This authorization expires: 10-10-07  
 (This authorization void if drilling not started within 6 months of effective date.)  
 Spud date: \_\_\_\_\_ Agent: \_\_\_\_\_

Mail to: KCC - Conservation Division 130 S. Market - Room 2078, Wichita, Kansas 67202

RECEIVED  
 KANSAS CORPORATION COMMISSION  
 FEB 28 2007  
 CONSERVATION DIVISION  
 WICHITA, KS

37  
 18  
 10

IN ALL CASES PLOT THE INTENDED WELL ON THE PLAT BELOW

Plat of Acreage attributable to a well in a prorated or spaced field

If the intended well is in a prorated or spaced field, please fully complete this side of the form. If the intended well is in a prorated or spaced field complete the plat below showing that the well will be properly located in relationship to other wells producing from the common source of supply. Please show all the wells and within 1 mile of the boundaries of the proposed acreage attribution unit for gas wells and within 1/2 mile of the boundaries of the proposed acreage attribution unit for oil wells.

API No. 15 - 159-22537 0000
Operator: SAMUEL GARY JR & ASSOCIATES, INC.
Lease: ZINK
Well Number: 3-34
Field:

Location of Well: County: RICE
925 feet from N / S Line of Section
780 feet from E / W Line of Section
Sec. 34 Twp. 18 S. R. 10 East West

Is Section: Regular or Irregular

Number of Acres attributable to well:
QTR / QTR / QTR of acreage:

If Section is Irregular, locate well from nearest corner boundary.
Section corner used: NE NW SE SW

PLAT

(Show location of the well and shade attributable acreage for prorated or spaced wells.)
(Show footage to the nearest lease or unit boundary line.)

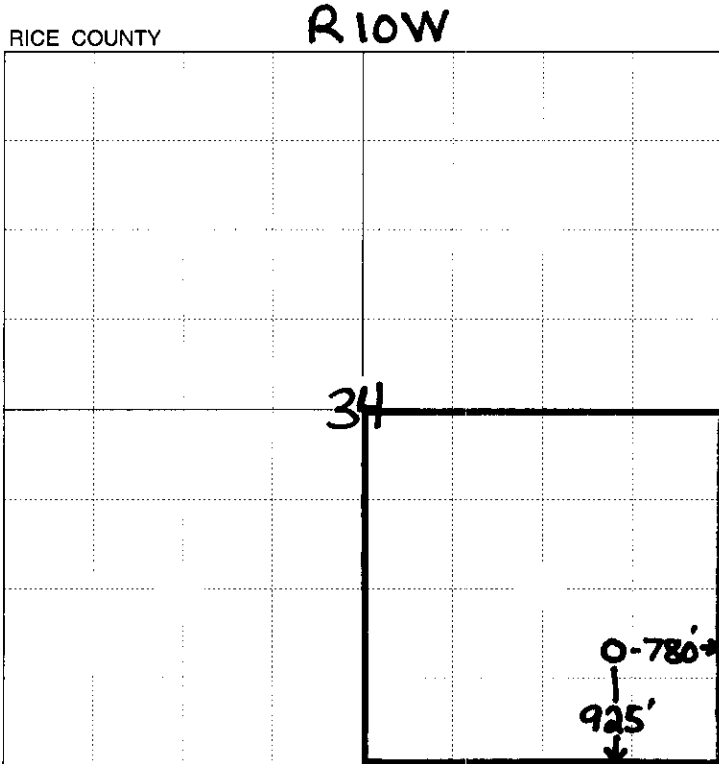

780' from nearest lease boundary

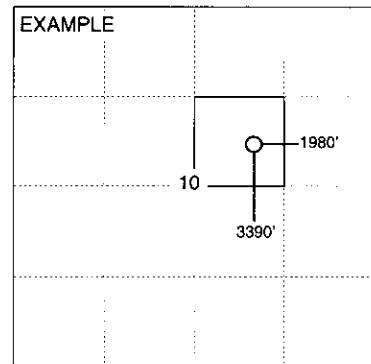

SEWARD CO.

RECEIVED KANSAS CORPORATION COMMISSION

FEB 28 2007

CONSERVATION DIVISION WICHITA, KS

NOTE: In all cases locate the spot of the proposed drilling location.

In plotting the proposed location of the well, you must show:

- 1. The manner in which you are using the depicted plat by identifying section lines, i.e. 1 section, 1 section with 8 surrounding sections, 4 sections, etc.
2. The distance of the proposed drilling location from the section's south / north and east / west.
3. The distance to the nearest lease or unit boundary line.
4. If proposed location is located within a prorated or spaced field a certificate of acreage attribution plat must be attached: (CO-7 for oil wells; CG-8 for gas wells).



# KANSAS

CORPORATION COMMISSION

KATHLEEN SEBELIUS, GOVERNOR  
BRIAN J. MOLINE, CHAIR  
ROBERT E. KREHBIEL, COMMISSIONER  
MICHAEL C. MOFFET, COMMISSIONER

April 10, 2007

Mr. Tom Fertal  
Samuel Gary Jr. & Associates, Inc.  
1670 Broadway Ste 3300  
Denver, CO 80202

Re: Drilling Pit Application  
Zink Lease Well No. 3-34  
SE/4 Sec. 34-18S-10W  
Rice County, Kansas

Dear Mr. Fertal:

District staff has inspected the above referenced location and has determined that the reserve pit shall be constructed **without slots**, the bottom shall be flat and reasonably level, and **all pits must be lined with bentonite**. The free fluids must be removed. The fluids are to be removed from the reserve pit as soon as the Hutchinson Salt section has been drilled through and displacement of the fluids into the reserve pit has occurred. The fluids should be removed again within 72 hours after drilling operations have ceased.

**If production casing is set all completion fluids shall be removed from the working pits daily. NO completion fluids or non-exempt wastes shall be placed in the reserve pit.**

The fluids should be taken to an authorized disposal well. Please call the District Office at (316) 630-4000 when the fluids have been removed. Please file form CDP-5 (August 2004), Exploration and Production Waste Transfer, within 30 days of fluid removal. Conservation division forms are available through our office and on the KCC web site: [www.kcc.state.ks.us/conservation/forms](http://www.kcc.state.ks.us/conservation/forms).

**A copy of this letter should be posted in the doghouse along with the approved Intent to Drill.** If you have any questions or concerns please feel free to contact the undersigned at the above address.

Sincerely,



Kathy Haynes  
Environmental Protection and Remediation Department

cc: File

15-159-22537-00-00