

OWWO

For KCC Use: 4-18-07
Effective Date: 4
District # _____
SGA? Yes No

KANSAS CORPORATION COMMISSION
OIL & GAS CONSERVATION DIVISION

Form C-1
December 2002
Form must be Typed
Form must be Signed
All blanks must be Filled

NOTICE OF INTENT TO DRILL

Must be approved by KCC five (5) days prior to commencing well

Expected Spud Date April 17 2007
month day year

Spot NW - SE - SE Sec. 14 Twp. 10 S. R. 20
 East West

OPERATOR: License# 32705
Name: Raney Oil Company, LLC
Address: 3425 Tam O'Shanter Dr.
City/State/Zip: Lawrence, KS 66047
Contact Person: Thomas Raney
Phone: (785) 749-0672

1980 990 feet from N / S Line of Section
1980 990 feet from E / W Line of Section

Is SECTION Regular Irregular?

(Note: Locate well on the Section Plat on reverse side)

CONTRACTOR: License# I. O. Miller 33346
Name: T.R. Services

County: Rooks
Lease Name: Sutor Well #: 3

Field Name: Marcotte

Is this a Prorated / Spaced Field? Yes No

Target Formation(s): Arbuckle

Nearest Lease or unit boundary: 1980

Ground Surface Elevation: 2213 feet MSL

Water well within one-quarter mile: Yes No

Public water supply well within one mile: Yes No

Depth to bottom of fresh water: 150

Depth to bottom of usable water: 950

Surface Pipe by Alternate: 1 2

Length of Surface Pipe Planned to be set: 201 PREVIOUSLY SET

Length of Conductor Pipe required: _____

Projected Total Depth: 3790

Formation at Total Depth: Arbuckle

Water Source for Drilling Operations:
 Well Farm Pond Other _____

DWR Permit #: _____

(Note: Apply for Permit with DWR)

Will Cores be taken? Yes No

If Yes, proposed zone: _____

Well Drilled For: Oil Gas OWWO Seismic; # of Holes _____ Other _____
 Enh Rec Storage Disposal
Well Class: Infield Pool Ext. Wildcat Other
Type Equipment: Mud Rotary Air Rotary Cable

If OWWO: old well information as follows:
Operator: I. O. Miller
Well Name: Sutor #3
Original Completion Date: 6/20/52 Original Total Depth: 3769

Directional, Deviated or Horizontal wellbore? Yes No

If Yes, true vertical depth: _____

Bottom Hole Location: _____

KCC DKT #: _____

AFFIDAVIT

The undersigned hereby affirms that the drilling, completion and eventual plugging of this well will comply with K.S.A. 55 et. seq.
It is agreed that the following minimum requirements will be met:

1. Notify the appropriate district office **prior** to spudding of well;
2. A copy of the approved notice of intent to drill **shall be** posted on each drilling rig;
3. The minimum amount of surface pipe as specified below **shall be set** by circulating cement to the top; in all cases surface pipe **shall be set** through all unconsolidated materials plus a minimum of 20 feet into the underlying formation.
4. If the well is dry hole, an agreement between the operator and the district office on plug length and placement is necessary **prior to plugging**;
5. The appropriate district office will be notified before well is either plugged or production casing is cemented in;
6. If an ALTERNATE II COMPLETION, production pipe shall be cemented from below any usable water to surface within **120 days** of spud date.
Or pursuant to Appendix "B" - Eastern Kansas surface casing order #133,891-C, which applies to the KCC District 3 area, alternate II cementing must be completed within 30 days of the spud date or the well shall be plugged. **In all cases, NOTIFY district office** prior to any cementing.

I hereby certify that the statements made herein are true and to the best of my knowledge and belief.

Date: 4.10.07 Signature of Operator or Agent: [Signature] Title: member

For KCC Use ONLY
API # 15 - 15-103-0221-0001
Conductor pipe required NONE feet
Minimum surface pipe required 200 feet per Alt. (12)
Approved by: [Signature] 4-13-07
This authorization expires: 10-13-07
(This authorization void if drilling not started within 6 months of approval date.)
Spud date: _____ Agent: _____

Remember to:
- File Drill Plat Application (form CDP-1) with Intent to Drill;
- File Completion Form ACO-1 within 120 days of spud date;
- File acreage attribution plat according to field proration orders;
- Notify appropriate district office 48 hours prior to workover or re-entry;
- Submit plugging report (CP-4) after plugging is completed;
- Obtain written approval before disposing or injecting salt water.
- If this permit has expired (See: authorized expiration date) please check the box below and return to the address below.
 Well Not Drilled - Permit Expired
Signature of Operator or Agent: _____
Date: _____

14
10
20

Mail to: KCC - Conservation Division, 130 S. Market - Room 2078, Wichita, Kansas 67202

RECEIVED
APR 13 2007

KCC WICHITA

IN ALL CASES PLOT THE INTENDED WELL ON THE PLAT BELOW

Plat of acreage attributable to a well in a prorated or spaced field

If the intended well is in a prorated or spaced field, please fully complete this side of the form. If the intended well is in a prorated or spaced field complete the plat below showing that the well will be properly located in relationship to other wells producing from the common source of supply. Please show all the wells and within 1 mile of the boundaries of the proposed acreage attribution unit for gas wells and within 1/2 mile of the boundaries of the proposed acreage attribution unit for oil wells.

API No. 15 - 163 021210000 ?
 Operator: Raney Oil Company, LLC
 Lease: Sutor
 Well Number: 3
 Field: Marcotte
 Number of Acres attributable to well: 10
 QTR / QTR / QTR of acreage: NW - SE - SE

Location of Well: County: Rooks
1980 feet from N / S Line of Section
1980 feet from E / W Line of Section
 Sec. 14 Twp. 10 S. R. 20 East West
 Is Section: Regular or Irregular
 If Section is irregular, locate well from nearest corner boundary.
 Section corner used: NE NW SE SW

PLAT

*(Show location of the well and shade attributable acreage for prorated or spaced wells.)
(Show footage to the nearest lease or unit boundary line.)*

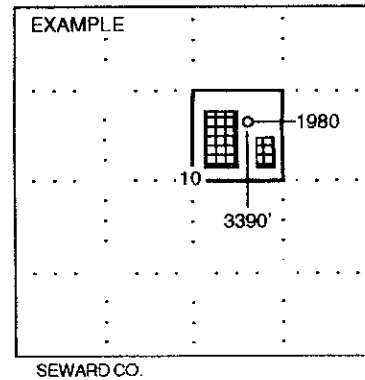
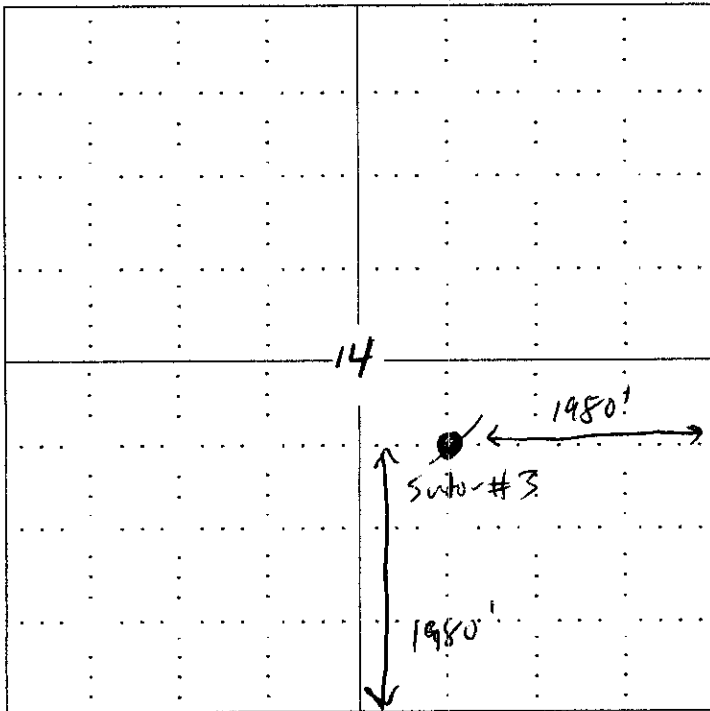

NOTE: In all cases locate the spot of the proposed drilling locaton.

In plotting the proposed location of the well, you must show:

1. The manner in which you are using the depicted plat by identifying section lines, i.e. 1 section, 1 section with 8 surrounding sections, 4 sections, etc.
2. The distance of the proposed drilling location from the section's south / north and east / west.
3. The distance to the nearest lease or unit boundary line.
4. If proposed location is located within a prorated or spaced field a certificate of acreage attribution plat must be attached: (CO-7 for oil wells; CG-8 for gas wells).

RECEIVED
APR 13 2007

KCC WICHITA

**KANSAS CORPORATION COMMISSION
OIL & GAS CONSERVATION DIVISION
APPLICATION FOR SURFACE PIT**

Form CDP-1
April 2004
Form must be Typed

Submit in Duplicate

Operator Name: Raney Oil Company, LLC		License Number: 32705
Operator Address: 3425 Tam O'Shanter Dr.		
Contact Person: Thomas Raney		Phone Number: (785) 749 - 0672
Lease Name & Well No.: Sutor #3		Pit Location (QQQQ): <u> </u> - <u> </u> NW - <u> </u> SE - <u> </u> SE
Type of Pit: <input type="checkbox"/> Emergency Pit <input type="checkbox"/> Burn Pit <input type="checkbox"/> Settling Pit <input type="checkbox"/> Drilling Pit <input checked="" type="checkbox"/> Workover Pit <input type="checkbox"/> Haul-Off Pit <small>(If WP Supply API No. or Year Drilled)</small>	Pit Is: <input checked="" type="checkbox"/> Proposed <input type="checkbox"/> Existing If Existing, date constructed: _____ Pit capacity: 150 (bbls)	Sec. <u>14</u> Twp. <u>10</u> R. <u>20</u> <input type="checkbox"/> East <input checked="" type="checkbox"/> West <u>1980</u> Feet from <input type="checkbox"/> North / <input checked="" type="checkbox"/> South Line of Section <u>1980</u> Feet from <input checked="" type="checkbox"/> East / <input type="checkbox"/> West Line of Section <u>Rooks</u> County
Is the pit located in a Sensitive Ground Water Area? <input type="checkbox"/> Yes <input checked="" type="checkbox"/> No		Chloride concentration: <u>5,000</u> mg/l <small>(For Emergency Pits and Settling Pits only)</small>
Is the bottom below ground level? <input checked="" type="checkbox"/> Yes <input type="checkbox"/> No	Artificial Liner? <input checked="" type="checkbox"/> Yes <input type="checkbox"/> No	How is the pit lined if a plastic liner is not used?
Pit dimensions (all but working pits): <u>15</u> Length (feet) <u>10</u> Width (feet) _____ N/A: Steel Pits Depth from ground level to deepest point: <u>6</u> (feet)		
If the pit is lined give a brief description of the liner material, thickness and installation procedure. Commercial Pit Liner		Describe procedures for periodic maintenance and determining liner integrity, including any special monitoring. Daily inspection
Distance to nearest water well within one-mile of pit <u>3388</u> feet Depth of water well <u>45</u> feet		Depth to shallowest fresh water <u>35</u> feet. ? Source of Information: _____ measured _____ well owner _____ electric log _____ KDWR
Emergency, Settling and Burn Pits ONLY: Producing Formation: _____ Number of producing wells on lease: _____ Barrels of fluid produced daily: _____ Does the slope from the tank battery allow all spilled fluids to flow into the pit? <input type="checkbox"/> Yes <input type="checkbox"/> No		Drilling, Workover and Haul-Off Pits ONLY: Type of material utilized in drilling/workover: <u>Freshwater</u> Number of working pits to be utilized: <u>1</u> Abandonment procedure: <u>Let dry & backfill</u> _____ Drill pits must be closed within 365 days of spud date.
I hereby certify that the above statements are true and correct to the best of my knowledge and belief.		
<u>4. 10. 07</u> Date		<u>Thomas Raney, LLC</u> Signature of Applicant or Agent
KCC OFFICE USE ONLY		
Date Received: <u>4/13/07</u> Permit Number: _____ Permit Date: <u>4/13/07</u> Lease Inspection: <input type="checkbox"/> Yes <input checked="" type="checkbox"/> No		

15-763-02/2/10001

Mail to: KCC - Conservation Division, 130 S. Market - Room 2078, Wichita, Kansas 67202

RECEIVED
APR 13 2007

KCC WICHITA

9

All Information Completely
Make Required Affidavit
Mail or Deliver Report to:
Conservation Division
State Corporation Commission
212 No. Market
Wichita, Kansas

WELL PLUGGING RECORD

Rooks County, Sec 4 Twp. 10 Rge. 20 (E) W(W)
Location as "NE/CNW/SE/W" or footage from lines NW/4 SE/4 SE/4
Lease Owner I.O. Miller
Lease Name Butor Well No. 3
Office Address Wichita, Kansas
Character of Well (completed as Oil, Gas or Dry Hole) _____
Date well completed _____ 19____
Application for plugging filed _____ 19____
Application for plugging approved _____ 19____
Plugging commenced 5/3/68 _____ 19____
Plugging completed 5/4/68 _____ 19____
Reason for abandonment of well or producing formation depleted.

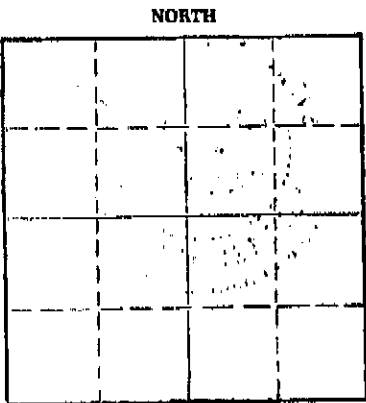

Locate well correctly on above Section Plat

If a producing well is abandoned, date of last production _____ 19____
Was permission obtained from the Conservation Division or its agents before plugging was commenced? Yes

Name of Conservation Agent who supervised plugging of this well Massey
Producing formation _____ Depth to top _____ Bottom _____ Total Depth of Well 3769' Feet
Show depth and thickness of all water, oil and gas formations.

OIL, GAS OR WATER RECORDS

CASING RECORD

FORMATION	CONTENT	FROM	TO	SIZE	PUT IN	PULLED OUT
				8-5/8"	201'	none
				5 1/2"	3765'	505'

Describe in detail the manner in which the well was plugged, indicating where the mud fluid was placed and the method or methods used in introducing it into the hole. If cement or other plugs were used, state the character of same and depth placed, from _____ feet to _____ feet for each plug set.

Checked hole to 3769', ran sand to 3760' and ran 5 sacks of cement. Shot pipe at 727', 601', 510', got loose and pulled 17 joints. Pumped 100 sacks of cement.

PLUGGING COMPLETE.

RECEIVED
KANSAS CORPORATION COMMISSION
APR 13 2007

RECEIVED
STATE CORPORATION COMMISSION
MAY 24 1968
CONSERVATION DIVISION
Wichita, Kansas

CONSERVATION DIVISION
WICHITA, KS

(If additional description is necessary, use BACK of this sheet)
Name of Plugging Contractor KNIGHT CASING PULLING CO., INC.
CHASR, KANSAS