

For KCC Use: 4-23-07
Effective Date: 3
District # 3
SGA? ☐ Yes ☒ No

KANSAS CORPORATION COMMISSION
OIL & GAS CONSERVATION DIVISION

NOTICE OF INTENT TO DRILL

Must be approved by KCC five (5) days prior to commencing well

Form C-1
December 2002
Form must be Typed
Form must be Signed
All blanks must be Filled

Expected Spud Date April 17, 2007
month day year

OPERATOR: License# 33124
Name: Neosho Natural LLC
Address: 4230 Douglas Road
Thayer, Kansas 66776
City/State/Zip: Jeff Kephart
Contact Person: 620-839-5581
Phone:

CONTRACTOR: License# 33072
Name: Well Refined Drilling Co., Inc.

Well Drilled For: ☐ Oil ☐ Enh Rec ☐ Infield ☐ Mud Rotary
☒ Gas ☐ Storage ☐ Pool Ext. ☒ Air Rotary
☐ OWWO ☐ Disposal ☒ Wildcat ☐ Cable
Seismic: # of Holes ☐ Other

If OWWO: old well information as follows:

Operator:
Well Name:
Original Completion Date: Original Total Depth:

Directional, Deviated or Horizontal wellbore? ☐ Yes ☒ No

If Yes, true vertical depth:

Bottom Hole Location:

KCC DKT #:

Spot SE4 NE4 NE4 Sec. 5 Twp. 31 S. R. 18 ☒ East ☐ West
990' feet from ☒ N / ☐ S Line of Section
330' feet from ☒ E / ☐ W Line of Section
Is SECTION ☒ Regular ☐ Irregular?

(Note: Locate well on the Section Plat on reverse side)

County: Labeite
Lease Name: Montee Scott Well #: 5-1
Field Name: Unknown

Is this a Prorated / Spaced Field? ☐ Yes ☒ No

Target Formation(s): Mississippian

Nearest Lease or unit boundary: 330'

Ground Surface Elevation: Unknown feet MSL

Water well within one-quarter mile: ☐ Yes ☒ No

Public water supply well within one mile: ☐ Yes ☒ No

Depth to bottom of fresh water: 100+

Depth to bottom of usable water: 200+

Surface Pipe by Alternate: ☐ 1 ☒ 2

Length of Surface Pipe Planned to be set: 20' Minimum

Length of Conductor Pipe required: None

Projected Total Depth: 1200'

Formation at Total Depth: Arbuckle

Water Source for Drilling Operations: ☐ Well ☒ Farm Pond ☐ Other

DWR Permit #:

(Note: Apply for Permit with DWR ☐)

Will Cores be taken? ☐ Yes ☒ No

If Yes, proposed zone:

AFFIDAVIT

The undersigned hereby affirms that the drilling, completion and eventual plugging of this well will comply with K.S.A. 55 et. seq.
It is agreed that the following minimum requirements will be met:

1. Notify the appropriate district office **prior** to spudding of well;
2. A copy of the approved notice of intent to drill **shall be** posted on each drilling rig;
3. The minimum amount of surface pipe as specified below **shall be set** by circulating cement to the top; in all cases surface pipe shall be set through all unconsolidated materials plus a minimum of 20 feet into the underlying formation.
4. If the well is dry hole, an agreement between the operator and the district office on plug length and placement is necessary **prior to plugging**;
5. The appropriate district office will be notified before well is either plugged or production casing is cemented in;
6. If an ALTERNATE II COMPLETION, production pipe shall be cemented from below any usable water to surface within **120 days** of spud date. Or pursuant to Appendix "B" - Eastern Kansas surface casing order #133,891-C, which applies to the KCC District 3 area, alternate II cementing must be completed within 30 days of the spud date or the well shall be plugged. **In all cases, NOTIFY district office** prior to any cementing.

I hereby certify that the statements made herein are true and to the best of my knowledge and belief.

Date: 4/11/07 Signature of Operator or Agent: Charlotte D. Kephart Title: Agent

For KCC Use ONLY

API # 15 - 099-24191-0000

Conductor pipe required None feet

Minimum surface pipe required 20 feet per Alt. XO 2

Approved by: 4-18-07

This authorization expires: 10-18-07

(This authorization void if drilling not started within 6 months of approval date.)

Spud date: Agent:

Remember to:

- File Drill Pit Application (form CDP-1) with Intent to Drill;
 - File Completion Form ACO-1 within 120 days of spud date;
 - File acreage attribution plat according to field proration orders;
 - Notify appropriate district office 48 hours prior to workover or re-entry;
 - Submit plugging report (CP-4) after plugging is completed;
 - Obtain written approval before disposing or injecting salt water.
- If this permit has expired (See: authorized expiration date) please check the box below and return to the address below.

☐ Well Not Drilled - Permit Expired

Signature of Operator or Agent:

Date:

Mail to: KCC - Conservation Division, 130 S. Market - Room 2078, Wichita, Kansas 67202

RECEIVED
KANSAS CORPORATION COMMISSION

APR 18 2007

CONSERVATION DIVISION
WICHITA, KS

5
31
187

IN ALL CASES PLOT THE INTENDED WELL ON THE PLAT BELOW*Plat of acreage attributable to a well in a prorated or spaced field*

If the intended well is in a prorated or spaced field, please fully complete this side of the form. If the intended well is in a prorated or spaced field complete the plat below showing that the well will be properly located in relationship to other wells producing from the common source of supply. Please show all the wells and within 1 mile of the boundaries of the proposed acreage attribution unit for gas wells and within 1/2 mile of the boundaries of the proposed acreage attribution unit for oil wells.

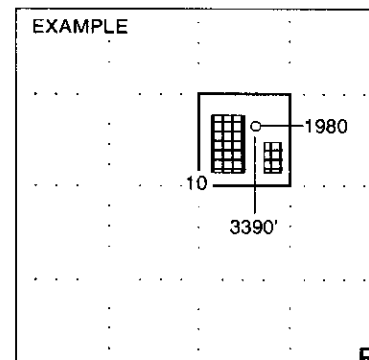
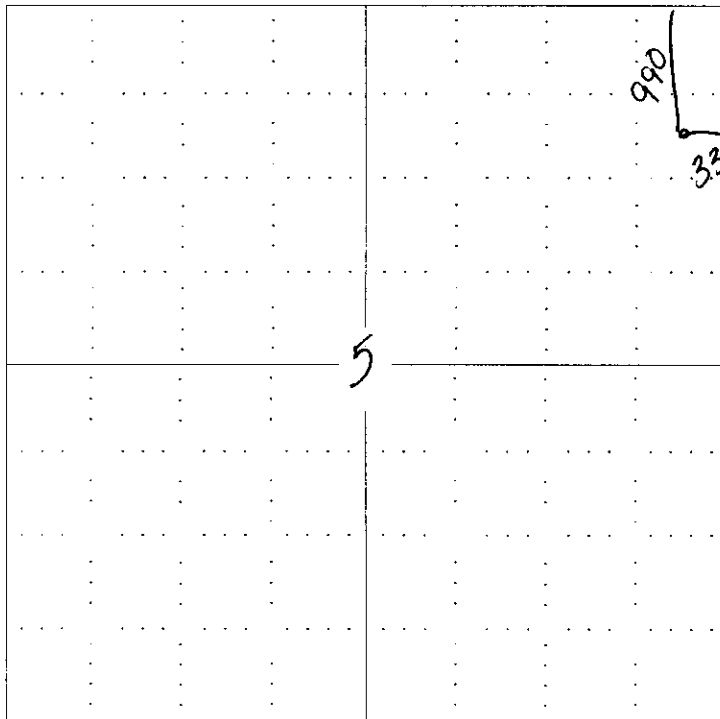
API No. 15 - 099-24191-0000Operator: Neosho Natural LLCLease: Montee ScottWell Number: 5-1Field: UnknownNumber of Acres attributable to well: 40QTR / QTR / QTR of acreage: SE4 - NE4 - NE4Location of Well: County: Labette990' _____ feet from ☒ N / ☐ S Line of Section330' _____ feet from ☒ E / ☐ W Line of SectionSec. 5 Twp. 31 S. R. 18 ☒ East ☐ WestIs Section: ☒ Regular or ☐ Irregular**If Section is Irregular, locate well from nearest corner boundary.**Section corner used: ☐ NE ☐ NW ☐ SE ☐ SW**PLAT***(Show location of the well and shade attributable acreage for prorated or spaced wells.)**(Show footage to the nearest lease or unit boundary line.)*

SEWARD CO.

RECEIVED
KANSAS CORPORATION COMMISSION

APR 18 2007

In plotting the proposed location of the well, you must show:

1. The manner in which you are using the depicted plat by identifying section lines, i.e. 1 section, 1 section with 8 surrounding sections, 4 sections, etc.
2. The distance of the proposed drilling location from the section's south / north and east / west.
3. The distance to the nearest lease or unit boundary line.
4. If proposed location is located within a prorated or spaced field a certificate of acreage attribution plat must be attached: (C0-7 for oil wells; CG-8 for gas wells).

CONSERVATION DIVISION
WICHITA, KS

KANSAS CORPORATION COMMISSION
OIL & GAS CONSERVATION DIVISION
APPLICATION FOR SURFACE PIT

Form GDP-1
April 2004
Form must be Typed

Submit in Duplicate

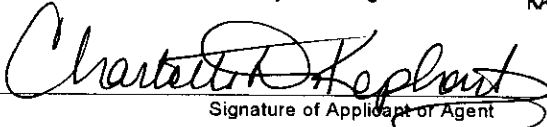
Operator Name: Neosho Natural LLC		License Number: 33124	
Operator Address: 4230 Douglas Road Thayer, KS 66776			
Contact Person: Jeff Kephart		Phone Number: (620) 839 - 5581	
Lease Name & Well No.: Montee Scott 5-1		Pit Location (QQQQ): SE4 NE4 NE4 Sec. 5 Twp. 31 R. 18 <input checked="" type="checkbox"/> East <input type="checkbox"/> West 990' Feet from <input checked="" type="checkbox"/> North / <input type="checkbox"/> South Line of Section 330' Feet from <input checked="" type="checkbox"/> East / <input type="checkbox"/> West Line of Section Labette County	
Type of Pit: <input type="checkbox"/> Emergency Pit <input type="checkbox"/> Burn Pit <input type="checkbox"/> Settling Pit <input checked="" type="checkbox"/> Drilling Pit <input type="checkbox"/> Workover Pit <input type="checkbox"/> Haul-Off Pit (If WP Supply API No. or Year Drilled)		Pit is: <input checked="" type="checkbox"/> Proposed <input type="checkbox"/> Existing If Existing, date constructed: _____ Pit capacity: 150 (bbls)	
Is the pit located in a Sensitive Ground Water Area? <input type="checkbox"/> Yes <input checked="" type="checkbox"/> No		Chloride concentration: <u>none</u> mg/l (For Emergency Pits and Settling Pits only)	
Is the bottom below ground level? <input checked="" type="checkbox"/> Yes <input type="checkbox"/> No		Artificial Liner? <input type="checkbox"/> Yes <input checked="" type="checkbox"/> No	
		How is the pit lined if a plastic liner is not used? Native Mud and Clay	
Pit dimensions (all but working pits): <u>30</u> Length (feet) <u>10</u> Width (feet) <u>N/A</u> Steel Pits Depth from ground level to deepest point: <u>4</u> (feet)			
If the pit is lined give a brief description of the liner material, thickness and installation procedure.		Describe procedures for periodic maintenance and determining liner integrity, including any special monitoring.	
Distance to nearest water well within one-mile of pit <u>na 1504</u> feet Depth of water well <u>180</u> feet		Depth to shallowest fresh water <u>100+</u> <u>70</u> feet. Source of information: <u>measured</u> <u>well owner</u> <u>electric log</u> <input checked="" type="checkbox"/> KDWR	
Emergency, Settling and Burn Pits ONLY: Producing Formation: _____ Number of producing wells on lease: _____ Barrels of fluid produced daily: _____ Does the slope from the tank battery allow all spilled fluids to flow into the pit? <input type="checkbox"/> Yes <input type="checkbox"/> No		Drilling, Workover and Haul-Off Pits ONLY: Type of material utilized in drilling/workover: <u>Fresh Water</u> Number of working pits to be utilized: <u>1</u> Abandonment procedure: <u>Air Dry, Backfill with the same dirt that was removed</u> Drill pits must be closed within 365 days of spud date.	
I hereby certify that the above statements are true and correct to the best of my knowledge and belief.		RECEIVED KANSAS CORPORATION COMMISSION APR 18 2007 CONSERVATION DIVISION WICHITA, KS	
<u>4/11/07</u> Date		 Signature of Applicant or Agent	
KCC OFFICE USE ONLY			
Date Received: <u>4/18/07</u> Permit Number: _____ Permit Date: <u>4/18/07</u> Lease Inspection: <input type="checkbox"/> Yes <input checked="" type="checkbox"/> No			

Mail to: KCC - Conservation Division, 130 S. Market - Room 2078, Wichita, Kansas 67202

15-098-24191-000