

For KCC Use: 4-25-07  
Effective Date: 4  
District #: 4  
SGA?  Yes  No

KANSAS CORPORATION COMMISSION  
OIL & GAS CONSERVATION DIVISION

NOTICE OF INTENT TO DRILL

Must be approved by KCC five (5) days prior to commencing well

OWWO

Form C-1

December 2002

Form must be Typed

Form must be Signed

All blanks must be Filled

Expected Spud Date April 30 2007  
month day year

OPERATOR: License# 33486  
Name: Dark Horse Oil Company, LLC  
Address: 34861 Forest Park Drive  
City/State/Zip: Elizabeth, Co 80107-7879  
Contact Person: Douglas C. Frickey  
Phone: 303-646-5156

CONTRACTOR: License# 32247  
Name: Jeff's Oilwell Supervision

<b>Well Drilled For:</b>	<b>Well Class:</b>	<b>Type Equipment:</b>
<input checked="" type="checkbox"/> Oil <input checked="" type="checkbox"/> Gas <input checked="" type="checkbox"/> OWWO <input type="checkbox"/> Seismic; # of Holes <input type="checkbox"/> Other	<input type="checkbox"/> Enh Rec <input type="checkbox"/> Storage <input type="checkbox"/> Disposal <input checked="" type="checkbox"/> Infield <input type="checkbox"/> Pool Ext. <input type="checkbox"/> Wildcat <input checked="" type="checkbox"/> Other	<input type="checkbox"/> Mud Rotary <input type="checkbox"/> Air Rotary <input checked="" type="checkbox"/> Cable

If OWWO: old well information as follows:  
Operator: Sidney VD Oil Company  
Well Name: Arndts #2  
Original Completion Date: 4-23-54 Original Total Depth: 3396

Directional, Deviated or Horizontal wellbore?  Yes  No  
If Yes, true vertical depth: \_\_\_\_\_  
Bottom Hole Location: \_\_\_\_\_  
KCC DKT #: \_\_\_\_\_

Spot SW NW NW Sec. 9 Twp. 8 S. R. 17  East  West  
990 feet from  N /  S Line of Section  
330 feet from  E /  W Line of Section  
Is SECTION  Regular  Irregular?

(Note: Locate well on the Section Plat on reverse side)

County: Rooks  
Lease Name: Arndts Well #: 2  
Field Name: Lone Star

Is this a Prorated / Spaced Field?  Yes  No  
Target Formation(s): Arbuckle  
Nearest Lease or unit boundary: 330

Ground Surface Elevation: 1939 feet MSL  
Water well within one-quarter mile:  Yes  No  
Public water supply well within one mile:  Yes  No

Depth to bottom of fresh water: 80 ft  
Depth to bottom of usable water: 700 ft 600  
Surface Pipe by Alternate:  1  2  
Length of Surface Pipe Planned to be set: 100 ft

Length of Conductor Pipe required: \_\_\_\_\_  
Projected Total Depth: 3425  
Formation at Total Depth: Arbuckle

Water Source for Drilling Operations:  
 Well  Farm Pond Other Lse. water  
DWR Permit #: \_\_\_\_\_

(Note: Apply for Permit with DWR )

Will Cores be taken?  Yes  No  
If Yes, proposed zone: \_\_\_\_\_

AFFIDAVIT

The undersigned hereby affirms that the drilling, completion and eventual plugging of this well will comply with K.S.A. 55 et. seq.

It is agreed that the following minimum requirements will be met:

1. Notify the appropriate district office **prior** to spudding of well;
2. A copy of the approved notice of intent to drill **shall be** posted on each drilling rig;
3. The minimum amount of surface pipe as specified below **shall be set** by circulating cement to the top; in all cases surface pipe **shall be set** through all unconsolidated materials plus a minimum of 20 feet into the underlying formation.
4. If the well is dry hole, an agreement between the operator and the district office on plug length and placement is necessary **prior to plugging**;
5. The appropriate district office will be notified before well is either plugged or production casing is cemented in;
6. If an ALTERNATE II COMPLETION, production pipe shall be cemented from below any usable water to surface within **120 days** of spud date. Or pursuant to Appendix "B" - Eastern Kansas surface casing order #133,891-C, which applies to the KCC District 3 area, alternate II cementing must be completed within 30 days of the spud date or the well shall be plugged. **In all cases, NOTIFY district office** prior to any cementing.

I hereby certify that the statements made herein are true and to the best of my knowledge and belief.

Date: April 16, 2007 Signature of Operator or Agent: \_\_\_\_\_ Title: President

For KCC Use ONLY  
API # 15 - 163-01356-00-01  
Conductor pipe required None feet  
Minimum surface pipe required 100 feet per Alt. X2  
Approved by: Ret 4-20-07  
This authorization expires: 10-20-07  
(This authorization void if drilling not started within 6 months of approval date.)  
Spud date: \_\_\_\_\_ Agent: \_\_\_\_\_

Remember to:

- File Drill Pit Application (form CDP-1) with Intent to Drill;
- File Completion Form ACO-1 within 120 days of spud date;
- File acreage attribution plat according to field proration orders;
- Notify appropriate district office 48 hours prior to workover or re-entry;
- Submit plugging report (CP-4) after plugging is completed;
- Obtain written approval before disposing or injecting salt water.

- If this permit has expired (See: authorized expiration date) please check the box below and return to the address below.

Well Not Drilled - Permit Expired **RECEIVED**

Signature of Operator or Agent: \_\_\_\_\_ KANSAS CORPORATION COMMISSION

Date: \_\_\_\_\_

Mail to: KCC - Conservation Division, 130 S. Market - Room 2078, Wichita, Kansas APR 19 2007

CONSERVATION DIVISION  
WICHITA, KS

9  
8  
17W

**IN ALL CASES PLOT THE INTENDED WELL ON THE PLAT BELOW**

*Plat of acreage attributable to a well in a prorated or spaced field*

**If the intended well is in a prorated or spaced field, please fully complete this side of the form.** If the intended well is in a prorated or spaced field complete the plat below showing that the well will be properly located in relationship to other wells producing from the common source of supply. Please show all the wells and within 1 mile of the boundaries of the proposed acreage attribution unit for gas wells and within 1/2 mile of the boundaries of the proposed acreage attribution unit for oil wells.

API No. 15 - 163-01356-00-0  
 Operator: Dark Horse Oil Company, LLC  
 Lease: Arndts  
 Well Number: 2  
 Field: Lone Star  
 Number of Acres attributable to well: \_\_\_\_\_  
 QTR / QTR / QTR of acreage: SW - NW - NW

Location of Well: County: Rooks  
990 feet from  N /  S Line of Section  
330 feet from  E /  W Line of Section  
 Sec. 9 Twp. 8 S. R. 17  East  West

Is Section:  Regular or  Irregular

**If Section is Irregular, locate well from nearest corner boundary.**  
 Section corner used:  NE  NW  SE  SW

**PLAT**

*(Show location of the well and shade attributable acreage for prorated or spaced wells.)  
 (Show footage to the nearest lease or unit boundary line.)*

**T-8-S**

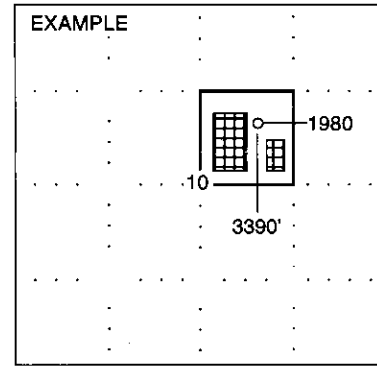
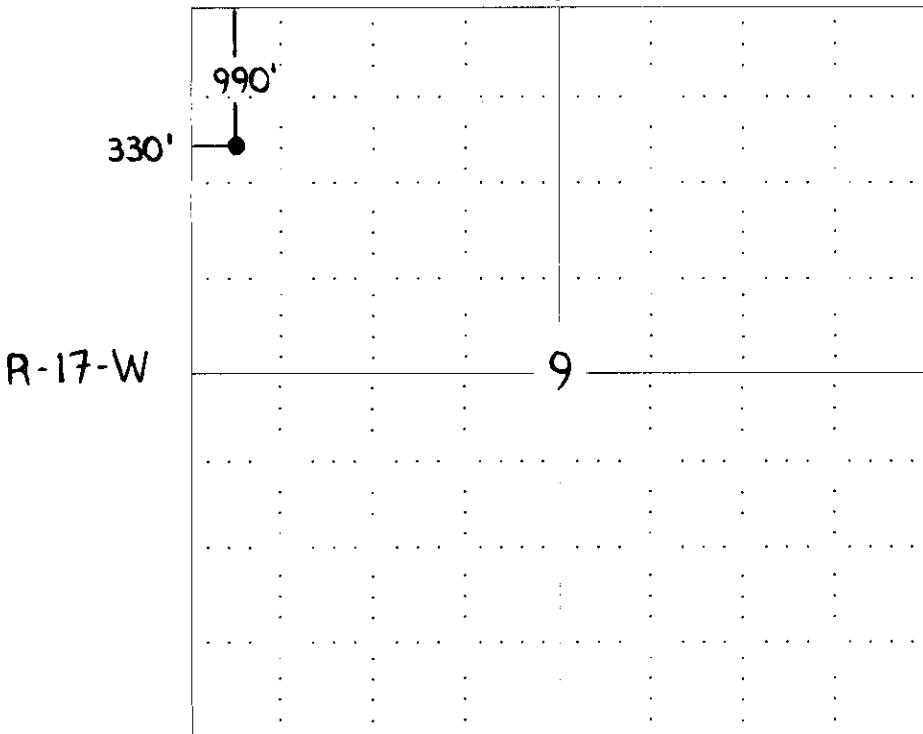

**NOTE: In all cases locate the spot of the proposed drilling location.**

**In plotting the proposed location of the well, you must show:**

1. The manner in which you are using the depicted plat by identifying section lines, i.e. 1 section, 1 section with 8 surrounding sections, 4 sections, etc.
2. The distance of the proposed drilling location from the section's south / north and east / west.
3. The distance to the nearest lease or unit boundary line.
4. If proposed location is located within a prorated or spaced field a certificate of acreage attribution plat must be attached: (CO-7 for oil wells; CG-8 for gas wells).

**RECEIVED**  
 KANSAS CORPORATION COMMISSION  
 APR 19 2007

CONSERVATION DIVISION  
 WICHITA, KS

**KANSAS CORPORATION COMMISSION  
OIL & GAS CONSERVATION DIVISION  
APPLICATION FOR SURFACE PIT**

Form CDP-1  
April 2004  
Form must be Typed

*Submit in Duplicate*

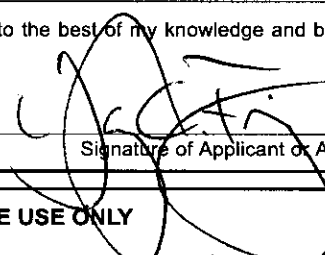
Operator Name: <b>Dark Horse Oil Company, LLC</b>		License Number: <b>33486</b>
Operator Address: <b>34861 Forest Park Drive- Elizabeth, Co. 80107-7879</b>		
Contact Person: <b>Douglas C. Frickey</b>		Phone Number: ( 303 ) <b>646 5156</b>
Lease Name & Well No.: <b>Arndts #2</b>		Pit Location (QQQQ): <b>SW . NW . NW .</b>
Type of Pit: <input type="checkbox"/> Emergency Pit <input type="checkbox"/> Burn Pit <input type="checkbox"/> Settling Pit <input checked="" type="checkbox"/> Drilling Pit <input type="checkbox"/> Workover Pit <input type="checkbox"/> Haul-Off Pit <small>(If WP Supply API No. or Year Drilled)</small>	Pit is: <input checked="" type="checkbox"/> Proposed <input type="checkbox"/> Existing If Existing, date constructed: _____ Pit capacity: _____ (bbls)	Sec. <b>9</b> Twp. <b>8-S</b> R. <b>17</b> <input type="checkbox"/> East <input checked="" type="checkbox"/> West <b>990</b> Feet from <input checked="" type="checkbox"/> North / <input type="checkbox"/> South Line of Section <b>330</b> Feet from <input type="checkbox"/> East / <input checked="" type="checkbox"/> West Line of Section <b>Rooks</b> _____ County
Is the pit located in a Sensitive Ground Water Area? <input type="checkbox"/> Yes <input checked="" type="checkbox"/> No		Chloride concentration: _____ mg/l <small>(For Emergency Pits and Settling Pits only)</small>
Is the bottom below ground level? <input checked="" type="checkbox"/> Yes <input type="checkbox"/> No	Artificial Liner? <input checked="" type="checkbox"/> Yes <input type="checkbox"/> No	How is the pit lined if a plastic liner is not used?
Pit dimensions (all but working pits): <b>15</b> Length (feet) <b>8</b> Width (feet)    _____ N/A: <b>Steel Pits</b> Depth from ground level to deepest point: <b>6</b> (feet)		
If the pit is lined give a brief description of the liner material, thickness and installation procedure. <b>Plastic 6mm Liner, Installed by rig crew and anchored by pit dirt on edges.</b>		Describe procedures for periodic maintenance and determining liner integrity, including any special monitoring. <b>Visual check</b>
Distance to nearest water well within one-mile of pit <b>3941</b> feet    Depth of water well <b>30</b> feet		Depth to shallowest fresh water <b>17</b> feet. Source of information: _____ measured    _____ well owner    _____ electric log <input checked="" type="checkbox"/> KDWR
<b>Emergency, Settling and Burn Pits ONLY:</b> Producing Formation: _____ Number of producing wells on lease: _____ Barrels of fluid produced daily: _____ Does the slope from the tank battery allow all spilled fluids to flow into the pit? <input type="checkbox"/> Yes <input type="checkbox"/> No		<b>Drilling, Workover and Haul-Off Pits ONLY:</b> Type of material utilized in drilling/workover: <b>Plastic</b> Number of working pits to be utilized: <b>1</b> Abandonment procedure: <b>Empty with Vac. Truck then backfill</b> Drill pits must be closed within 365 days of spud date.
I hereby certify that the above statements are true and correct to the best of my knowledge and belief.		
April 16, 2007 Date		 Signature of Applicant or Agent
<b>KCC OFFICE USE ONLY</b>		
Date Received: <b>4/19/07</b>	Permit Number: _____	Permit Date: <b>4/19/07</b> Lease Inspection _____

15-163-01356-00-01

Mail to: KCC - Conservation Division, 130 S. Market - Room 2078, Wichita, Kansas 67202

**RECEIVED**  
KANSAS CORPORATION COMMISSION  
APR 19 2007  
CONSERVATION DIVISION  
WICHITA, KS

STATE OF KANSAS  
 STATE CORPORATION COMMISSION  
 130 S. Market, Room 2078  
 Wichita, KS 67202

WELL PLUGGING RECORD 15-163-01356-00-00  
 K.A.R.-82-3-117

API NUMBER 3/23/1954  
 LEASE NAME Arndt  
 WELL NUMBER 2

TYPE OR PRINT  
 NOTICE: Fill out completely  
 and return to Cons. Div.  
 office within 30 days.

4290 Ft. from S Section Line  
4950 Ft. from E Section Line  
 SEC. 9 TWP. 8 RGE. 17 (E) or (W)  
 COUNTY Rooks  
 Date Well Completed 3/23/1954  
 Plugging Commenced 5/8/98  
 Plugging Completed 5/8/98

LEASE OPERATOR Berusco, Inc.  
 ADDRESS Box 723 Hwy. No. 67601  
 PHONE#(785) 628-6101 OPERATORS LICENSE NO. 5363  
 Character of Well oil  
 (Oil, Gas, D&A, SWD, Input, Water Supply Well)

The plugging proposal was approved on 5/8/98 (date)  
 by Carl Goodrum (KCC District Agent's Name).

Is ACD-1 filed? \_\_\_\_\_ if not, is well log attached? \_\_\_\_\_

Producing Formation \_\_\_\_\_ Depth to Top \_\_\_\_\_ Bottom \_\_\_\_\_ T.O. 3388

Show depth and thickness of all water, oil and gas formations.

OIL, GAS OR WATER RECORDS | CASING RECORD

Formation	Content	From	To	Size	Put In	Pulled out
	<u>Surface</u>	<u>0</u>	<u>110</u>	<u>8 1/2"</u>		
	<u>Casing</u>	<u>0</u>	<u>3388</u>	<u>5 1/2"</u>		

Describe in detail the manner in which the well was plugged, indicating where the mud fluid was placed and the method or methods used in introducing it into the hole. If cement or other plug were used, state the character of same and depth placed, from feet to feet each set:

Run plug suspended to 2050' mud 275 lbs. 60% PVC - 10% gel - 900# kettle. Cuv. cement to surface. Hook to 5' Cuv. mud 25 lbs. follow to 2875'. Hook to 8' 1/2" mud 50 lbs. follow to 3388' and plug.

Name of Plugging Contractor Berusco, Inc. License No. 5363  
 Address Box 723 Hwy. No. 67601

NAME OF PARTY RESPONSIBLE FOR PLUGGING FEES: Berusco, Inc.  
 STATE OF Kansas COUNTY OF Ellis, ss.

Mr. Dennis Turner (Employee of Operator) or (Operator) of above-described well, being first duly sworn on oath, says: That I have knowledge of the facts statements, and matters herein contained and the log of the above-described well as filed the the same are true and correct, so help me God.

(Signature) Dennis Turner  
 (Address) Box 723 Hwy. No. 67601

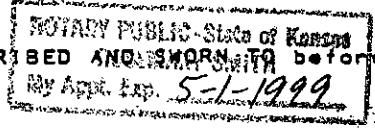

SUBSCRIBED AND SWORN to before me this 22 day of September, 19 98  
Gregory Smith Notary Public  
 My Commission Expires: 5-1-1999