



For KCC Use: 4-2507
 Effective Date: _____
 District # _____
 SGA? Yes No

KANSAS CORPORATION COMMISSION
 OIL & GAS CONSERVATION DIVISION

1008960

Form C-1
 November 2005
 Form must be Typed
 Form must be Signed
 All blanks must be Filled

NOTICE OF INTENT TO DRILL

Must be approved by KCC five (5) days prior to commencing well

Expected Spud Date: 04/23/2007
 month day year

OPERATOR: License# 32356
 Name: Intermountain Refining Co, Inc
 Address 1: PO Box 35
 Address 2: _____
 City: Farmington State: NM Zip: 87499 + _____
 Contact Person: Cassandra Parks
 Phone: 303-893-5090
 CONTRACTOR: License# 33532
 Name: Advanced Drilling Technologies LLC

Spot Description: _____
 NE NE SW NE Sec. 28 Twp. 18 S. R. 31 E W
 (0/0/0) 1,376 feet from N / S Line of Section
 1,376 feet from E / W Line of Section

Is SECTION: Regular Irregular?
 (Note: Locate well on the Section Plat on reverse side)

County: Scott
 Lease Name: Mildred Strode Well #: 1A
 Field Name: HUGOTON NORTHEAST GAS AREA

Is this a Prorated / Spaced Field? Yes No
 Target Formation(s): Krider
 Nearest Lease or unit boundary line (in footage): 1376

Ground Surface Elevation: 2948 feet MSL
 Water well within one-quarter mile: Yes No
 Public water supply well within one mile: Yes No

Depth to bottom of fresh water: 180
 Depth to bottom of usable water: 1500
 Surface Pipe by Alternate: I II

Length of Surface Pipe Planned to be set: 350
 Length of Conductor Pipe (if any): 0
 Projected Total Depth: 2900
 Formation at Total Depth: Chase Group

Water Source for Drilling Operations:
 Well Farm Pond Other: Hauled in
 DWR Permit #: _____

(Note: Apply for Permit with DWR)
 Will Cores be taken? Yes No
 If Yes, proposed zone: _____

RECEIVED
 KANSAS CORPORATION COMMISSION

AFFIDAVIT

The undersigned hereby affirms that the drilling, completion and eventual plugging of this well will comply with K.S.A. 55 et. seq. APR 20 2007

It is agreed that the following minimum requirements will be met:

1. Notify the appropriate district office **prior** to spudding of well;
2. A copy of the approved notice of intent to drill **shall be** posted on each drilling rig;
3. The minimum amount of surface pipe as specified below **shall be set** by circulating cement to the top; in all cases surface pipe **shall be set** through all unconsolidated materials plus a minimum of 20 feet into the underlying formation.
4. If the well is dry hole, an agreement between the operator and the district office on plug length and placement is necessary **prior to plugging**;
5. The appropriate district office will be notified before well is either plugged or production casing is cemented in;
6. If an ALTERNATE II COMPLETION, production pipe shall be cemented from below any usable water to surface within **120 DAYS** of spud date.
 Or pursuant to Appendix "B" - Eastern Kansas surface casing order #133,891-C, which applies to the KCC District 3 area, alternate II cementing must be completed within 30 days of the spud date or the well shall be plugged. **In all cases, NOTIFY district office** prior to any cementing.

I hereby certify that the statements made herein are true and to the best of my knowledge and belief.

Date: 4/19/2007 Signature of Operator or Agent: Cassandra Parks Title: Agent

For KCC Use ONLY
 API # 15 - 171-20660-0000
 Conductor pipe required 0 feet
 Minimum surface pipe required 200 feet per ALT. I II
 Approved by: pm 4-20-07
 This authorization expires: 10-20-07
 (This authorization void if drilling not started within 6 months of approval date.)
 Spud date: _____ Agent: _____

Remember to:

- File Drill Pit Application (form CDP-1) with Intent to Drill;
- File Completion Form ACO-1 within 120 days of spud date;
- File acreage attribution plat according to field proration orders;
- Notify appropriate district office 48 hours prior to workover or re-entry;
- Submit plugging report (CP-4) after plugging is completed (within 60 days);
- Obtain written approval before disposing or injecting salt water.

- If this permit has expired (See: authorized expiration date) please check the box below and return to the address below.
 Well Not Drilled - Permit Expired Date: _____
 Signature of Operator or Agent: _____

Mail to: KCC - Conservation Division, 130 S. Market - Room 2078, Wichita, Kansas 67202

28
18
31
 E
 W



1008960

IN ALL CASES PLOT THE INTENDED WELL ON THE PLAT BELOW

Plat of acreage attributable to a well in a prorated or spaced field

If the intended well is in a prorated or spaced field, please fully complete this side of the form. If the intended well is in a prorated or spaced field complete the plat below showing that the well will be properly located in relationship to other wells producing from the common source of supply. Please show all the wells and within 1 mile of the boundaries of the proposed acreage attribution unit for gas wells and within 1/2 mile of the boundaries of the proposed acreage attribution unit for oil wells.

API No. 15 - 171-20660-0000
Operator: Intermountain Refining Co, Inc
Lease: Mildred Strode
Well Number: 1A
Field: HUGOTON NORTHEAST GAS AREA

Location of Well: County: Scott
1,376 feet from N / S Line of Section
1,376 feet from E / W Line of Section
Sec. 28 Twp. 18 S. R. 31 E W

Number of Acres attributable to well: 2
QTR/QTR/QTR/QTR of acreage: NE NE SW NE

Is Section: Regular or Irregular

If Section is Irregular, locate well from nearest corner boundary.

Section corner used: NE NW SE SW

PLAT

*(Show location of the well and shade attributable acreage for prorated or spaced wells.)
(Show footage to the nearest lease or unit boundary line.)*

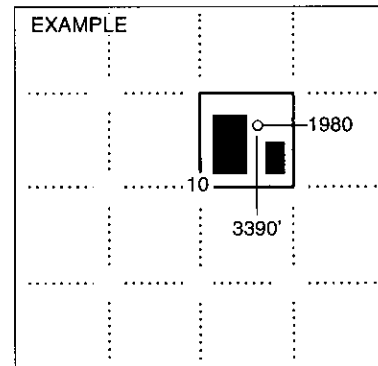
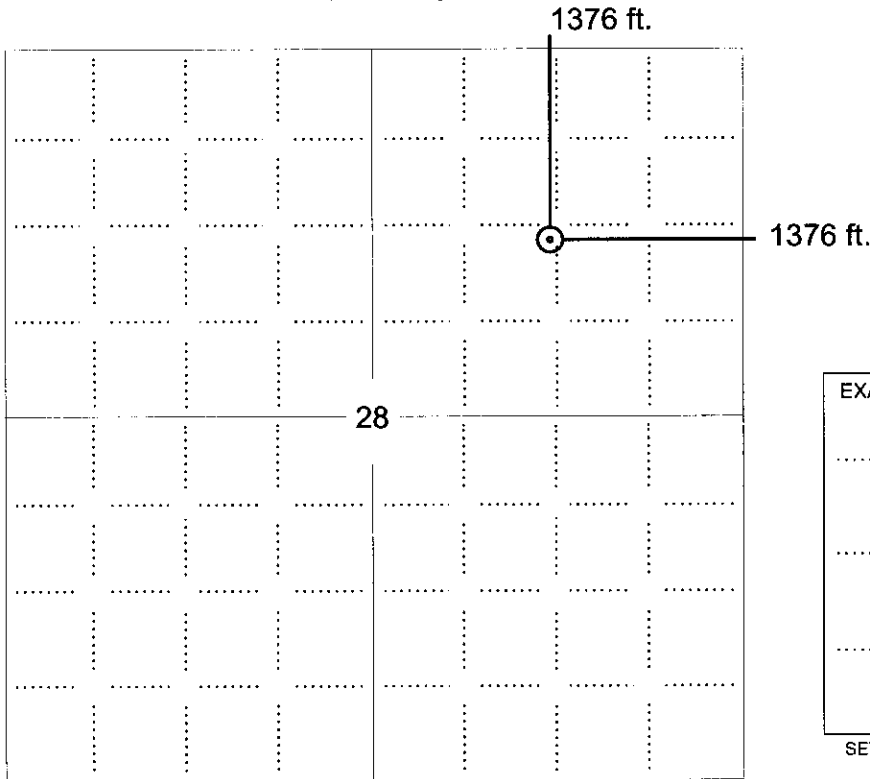

SEWARD CO.

RECEIVED
KANSAS CORPORATION COMMISSION

APR 20 2007

In plotting the proposed location of the well, you must show:

1. The manner in which you are using the depicted plat by identifying section lines, i.e. 1 section, 1 section with 8 surrounding sections, 4 sections, etc.
2. The distance of the proposed drilling location from the south / north and east / west outside section lines.
3. The distance to the nearest lease or unit boundary line (in footage).
4. If proposed location is located within a prorated or spaced field a certificate of acreage attribution plat must be attached: (CO-7 for oil wells; CG-8 for gas wells).

CONSERVATION DIVISION
WICHITA, KS



KANSAS CORPORATION COMMISSION 1008960
 OIL & GAS CONSERVATION DIVISION
APPLICATION FOR SURFACE PIT

Form CDP-1
 April 2004
 Form must be Typed

Submit in Duplicate

Operator Name: Intermountain Refining Co, Inc		License Number: 32356
Operator Address: PO Box 35		Farmington NM 87499
Contact Person: Cassandra Parks		Phone Number: 303-893-5090
Lease Name & Well No.: Mildred Strode 1A		Pit Location (QQQQ): NE NE SW NE Sec. 28 Twp. 18 R. 31 <input type="checkbox"/> East <input checked="" type="checkbox"/> West 1,376 Feet from <input checked="" type="checkbox"/> North / <input type="checkbox"/> South Line of Section 1,376 Feet from <input checked="" type="checkbox"/> East / <input type="checkbox"/> West Line of Section Scott County
Type of Pit: <input type="checkbox"/> Emergency Pit <input type="checkbox"/> Burn Pit <input type="checkbox"/> Settling Pit <input checked="" type="checkbox"/> Drilling Pit <input type="checkbox"/> Workover Pit <input type="checkbox"/> Haul-Off Pit <small>(If WP Supply API No. or Year Drilled)</small>	Pit is: <input checked="" type="checkbox"/> Proposed <input type="checkbox"/> Existing If Existing, date constructed: Pit capacity: 3,000 (bbls)	
Is the pit located in a Sensitive Ground Water Area? <input type="checkbox"/> Yes <input checked="" type="checkbox"/> No		Chloride concentration: _____ mg/l <small>(For Emergency Pits and Settling Pits only)</small>
Is the bottom below ground level? <input checked="" type="checkbox"/> Yes <input type="checkbox"/> No	Artificial Liner? <input type="checkbox"/> Yes <input checked="" type="checkbox"/> No	How is the pit lined if a plastic liner is not used? Natural clay
Pit dimensions (all but working pits): 80 Length (feet) 80 Width (feet) <input type="checkbox"/> N/A: Steel Pits Depth from ground level to deepest point: 4 (feet) <input type="checkbox"/> No Pit		
If the pit is lined give a brief description of the liner material, thickness and installation procedure.		Describe procedures for periodic maintenance and determining liner integrity, including any special monitoring.
Distance to nearest water well within one-mile of pit 4257 feet Depth of water well 150 feet		Depth to shallowest fresh water 65 feet. Source of information: <input type="checkbox"/> measured <input type="checkbox"/> well owner <input type="checkbox"/> electric log <input checked="" type="checkbox"/> KDWR
Emergency, Settling and Burn Pits ONLY: Producing Formation: _____ Number of producing wells on lease: _____ Barrels of fluid produced daily: _____ Does the slope from the tank battery allow all spilled fluids to flow into the pit? <input type="checkbox"/> Yes <input type="checkbox"/> No		Drilling, Workover and Haul-Off Pits ONLY: Type of material utilized in drilling/workover: Bentonite Mud Number of working pits to be utilized: 2 Abandonment procedure: Evaporation/Backfill Drill pits must be closed within 365 days of spud date.
I hereby certify that the above statements are true and correct to the best of my knowledge and belief.		RECEIVED KANSAS CORPORATION COMMISSION APR 20 2007 CONSERVATION DIVISION WICHITA, KS
Date: 4/19/2007		Signature of Applicant or Agent:

15-171-200610-0000

KCC OFFICE USE ONLY		RFAC <input type="checkbox"/> RFAS <input type="checkbox"/>
Date Received: 4/20/07	Permit Number: _____	Permit Date: 4/20/07 Lease Inspection: <input type="checkbox"/> Yes <input checked="" type="checkbox"/> No