

FOR KCC USE:

FORM CB-1 12/93

FORM MUST BE TYPED

FORM MUST BE SIGNED

ALL BLANKS MUST BE FILLED IN

EFFECTIVE DATE: 4-29-07

State of Kansas

DISTRICT # 4

CATHODIC PROTECTION BOREHOLE INTENT

SGA? ... Yes X No

Must be approved by the K.C.C. sixty (60) days prior to commencing well.

Expected Spud (Starting) Date May 14 2007

month day year

OPERATOR: License # 33097

Name: Southern Star Central Gas Pipeline

Address: 1130 S. Country Club Drive

City/State/Zip: Colby, KS. 67701

Contact Person: Randall Neff

Phone: (785) 443-2562

CONTRACTOR: License # 32775

Name: McLean's CP Installation, Inc.

Type Drilling Equipment: X Mud Rotary Cable
..... Air Rotary Other

CONSTRUCTION FEATURES

Length of Cathodic Surface (Non-Metallic) Casing

Planned to be set: 20' ft.

Length of Conductor pipe (if any?): ft.

Size of the borehole (I.D.): 17 1/2"-20" 10"-180" inches

Cathodic surface casing size: 10" inches

Cathodic surface casing centralizers set at depths of: 20';

..... ; ; ; ; ; ; ; ; ;

Cathodic surface casing will terminate at:

... Above surface ... Surface Vault X Below Surface Vault

Pitless casing adaptor will be used: ... Yes No at Depth ft.

Anode installation depths are: 180' 170' 160' 150'

..... ; ; 140' 130' 120' ; ; ; ;

* Maximum TD = 300'

Spot (Location) Q/Q/Q

NW... NW... NE... Sec 35... Twp 4... S Rg 36... X West

50..... feet from South North line of Section

3062..... feet from East West line of Section

(Circle directions from nearest outside corner boundaries)

SECTION X REGULAR IRREGULAR?

(Spot well on the Section Plat on Reverse Side)

County: Rawlins

Lease Name: McDonald Well #: 1 E

Facility Name: McDonald Rectifier

Ground Surface Elevation: 3317' MSL.

Cathodic Borehole Total Depth 200' ft.

Depth to Bedrock 300 ft.

WATER INFORMATION:

Aquifer Penetration: None X Single Multiple

Depth to bottom of fresh water: 300 ft.

Depth to bottom of usable water: 300 ft.

Water well within one-quarter mile: yes X no

Public water supply well within one mile: yes X no

Water Source for Drilling Operations:

.... well farm pond stream X other

Water Well Location:

DWR Permit #:

Standard Dimension Ratio (SDR) is = 2.6

(cathodic surface OD csg. in inches / MW in inches = SDR)

Annular space between borehole and casing will be grouted

with: X Concrete Bentonite Cement

X Neat cement Bentonite clay

Anode vent pipe will be set at: 3 ft. above surface

Anode conductor (backfill) material TYPE: SC2

Depth to BASE of Backfill installation material: 200'

Depth to TOP of Backfill installation material: 25'

AFFIDAVIT

The undersigned hereby affirms that the drilling, completion and eventual plugging of this well will comply with K.S.A. 55-101, et. seq. It is agreed that the following minimum requirements will be met:

1. Notify the appropriate district office prior to spudding of and again before plugging well;
2. A copy of the approved notice of intent to drill shall be posted on each drilling rig;
3. The minimum amount of cathodic surface casing as specified below shall be set by grouting to the top.
4. An agreement between the operator and the district office on plugs and placement is necessary prior to plugging;
5. The appropriate district office will be notified before well is either plugged or casing is grouted in;
6. IN ALL CASES, NOTIFY DISTRICT OFFICE PRIOR TO ANY CEMENTING.

I hereby certify that the statements made herein are true and to the best of my knowledge and belief.

Date: 4-18-07 Signature of Operator or Agent: Michelle Prescott Office

FOR KCC USE:

API # 15- 153-20846-0000

Conductor pipe required None feet

Minimum cathodic surface casing required 20 feet Alt 3

Approved by: Per 4-24-07

This authorization expires: 10-24-07

(This authorization void if drilling not started within 6 months of effective date.)

Spud date: Agent:

REMEMBER TO:

- File Drill Pit Application (form CDP-1) with Intent to Install;
- File Completion Form CB-2 within 30 days of spud date;
- Notify appropriate district office 48 hours prior to workover or re-entry;
- Submit plugging report (CB-4) within 30 days after plugging is completed.

Mail to: KCC - Conservation Division, 130 S. Market - Room 2078, Wichita, Kansas 67202-1286.

RECEIVED

APR 23 2007

KCC WICHITA

IN ALL CASES PLOT THE INTENDED WELL ON THE PLAT BELOW

Show the relationship to other wells or facilities proposed to be serviced by the intended cathodic borehole. Please show all the wells, existing cathodic boreholes, pipelines or facilities within 1/2 mile of the proposed borehole.

API NO. 15- 153-20846-0000
OPERATOR Southern Star Central Gas
LEASE McDonald
WELL NUMBER 1 E
FACILITY NAME McDonald Rectifier

LOCATION OF WELL: COUNTY Rawlins
50 feet from south/north line of section
3062 feet from east/west line of section
SECTION 35 TWP 4 S RG 36W

SPOT: QTR/QTR/QTR/QTR OF ACREAGE
NE - NW - NW - NE

IS SECTION X REGULAR or IRREGULAR
IF SECTION IS IRREGULAR, LOCATE WELL FROM NEAREST
CORNER BOUNDARY.

Section corner used: NE NW SE SW

PLAT

(Show location of intended cathodic borehole.)

(Show footage from nearest lease, unit or outside section boundary line.)

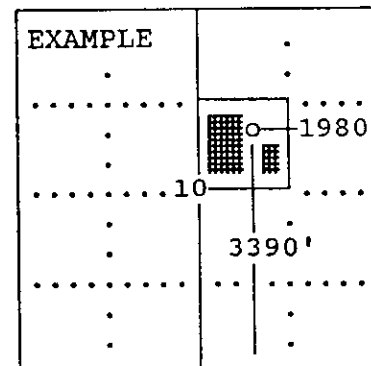
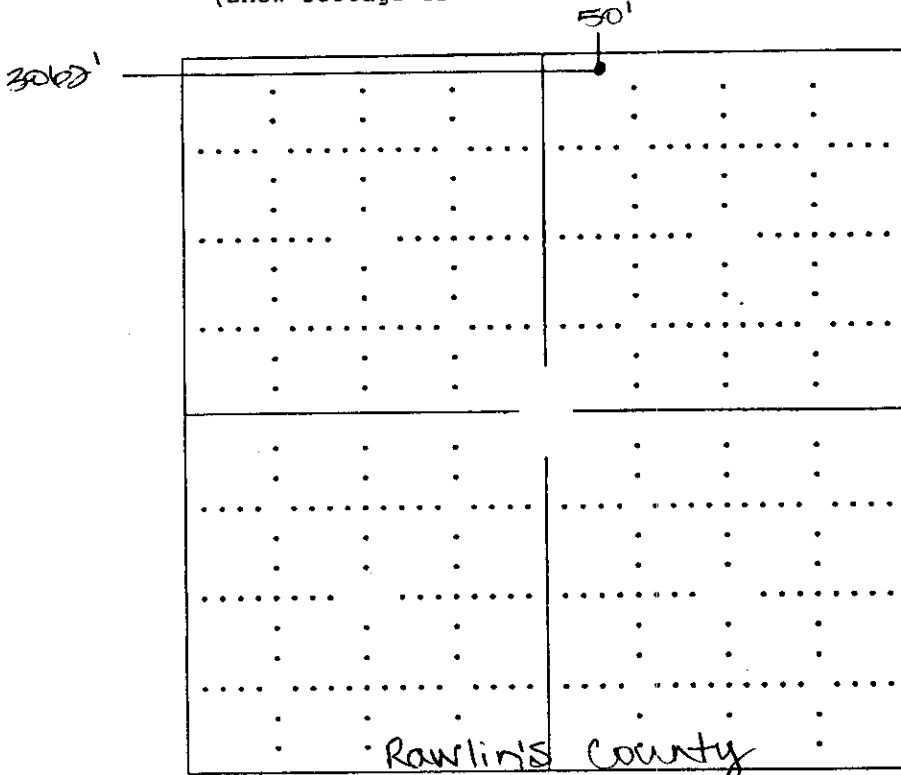

SEWARD CO.

In plotting the proposed location of the well, you must show:

- 1) The manner in which you are using the depicted plat by identifying section lines, i.e. 1 section, 1 section with 8 surrounding sections, 4 sections, etc.;
- 2) the distance of the proposed drilling location from the section's south/north and east/west; and
- 3) the distance to the nearest lease, unit or outside section boundary line.

RECEIVED

APR 23 2007

KCC WICHITA

KANSAS CORPORATION COMMISSION
OIL & GAS CONSERVATION DIVISION
APPLICATION FOR SURFACE PIT

Form CDP-1
April 2004
Form must be Typed

Submit in Duplicate

Operator Name: Southern Star Central Gas Pipeline		License Number: 33097
Operator Address: 1130 S. Country Club Drive		
Contact Person: Randall A. Neff		Phone Number: (785) 462 - 4915
Lease Name & Well No.: McDonald, 1 E		Pit Location (QQQQ): NE - NW - NW - NE
Type of Pit: <input type="checkbox"/> Emergency Pit <input type="checkbox"/> Burn Pit <input type="checkbox"/> Settling Pit <input checked="" type="checkbox"/> Drilling Pit <input type="checkbox"/> Workover Pit <input type="checkbox"/> Haul-Off Pit <small>(If WP Supply API No. or Year Drilled)</small>	Pit is: <input checked="" type="checkbox"/> Proposed <input type="checkbox"/> Existing If Existing, date constructed: _____ Pit capacity: 60 (bbls)	Sec. 35 Twp. 4S R. 36W <input type="checkbox"/> East <input checked="" type="checkbox"/> West 50 Feet from <input checked="" type="checkbox"/> North / <input type="checkbox"/> South Line of Section 3062 Feet from <input type="checkbox"/> East / <input checked="" type="checkbox"/> West Line of Section Rawlins County
Is the pit located in a Sensitive Ground Water Area? <input type="checkbox"/> Yes <input checked="" type="checkbox"/> No		Chloride concentration: _____ mg/l <small>(For Emergency Pits and Settling Pits only)</small>
Is the bottom below ground level? <input checked="" type="checkbox"/> Yes <input type="checkbox"/> No	Artificial Liner? <input checked="" type="checkbox"/> Yes <input type="checkbox"/> No	How is the pit lined if a plastic liner is not used? 6m Black Plastic Liner
Pit dimensions (all but working pits): 15' Length (feet) 6' Width (feet) _____ N/A: Steel Pits Depth from ground level to deepest point: 6' (feet)		
If the pit is lined give a brief description of the liner material, thickness and installation procedure. 6m black plastic liner layed in pit and edges secured to pit		Describe procedures for periodic maintenance and determining liner integrity, including any special monitoring. Pit will only be used for a 2-3 day period then pit will be backfilled.
Distance to nearest water well within one-mile of pit None feet Depth of water well _____ feet		Depth to shallowest fresh water _____ feet. Source of information: _____ measured _____ well owner _____ electric log _____ KDWR
Emergency, Settling and Burn Pits ONLY: Producing Formation: _____ Number of producing wells on lease: _____ Barrels of fluid produced daily: _____ Does the slope from the tank battery allow all spilled fluids to flow into the pit? <input type="checkbox"/> Yes <input type="checkbox"/> No		Drilling, Workover and Haul-Off Pits ONLY: Type of material utilized in drilling/workover: _____ Number of working pits to be utilized: 1 Abandonment procedure: Backfill Drill pits must be closed within 365 days of spud date.
RECEIVED APR 23 2007 KCC WICHITA		
I hereby certify that the above statements are true and correct to the best of my knowledge and belief. <div style="display: flex; justify-content: space-between;"> <div style="text-align: center;"> 4-18-07 Date </div> <div style="text-align: center;">  Signature of Applicant or Agent </div> </div>		

KCC OFFICE USE ONLY

Date Received: **4/23/07** Permit Number: _____ Permit Date: **4/23/07** Lease Inspection: ☐ Yes ☒ No

Mail to: KCC - Conservation Division, 130 S. Market - Room 2078, Wichita, Kansas 67202

15-153-20846-0000