



For KCC Use: 5-1-07
 Effective Date: 5-1-07
 District # 4
 SGA? Yes No

KANSAS CORPORATION COMMISSION 1009105
 OIL & GAS CONSERVATION DIVISION

Form C-1
 November 2005

Form must be Typed
 Form must be Signed
 All blanks must be Filled

NOTICE OF INTENT TO DRILL

Must be approved by KCC five (5) days prior to commencing well

Expected Spud Date: 05/15/2007
month day year

OPERATOR: License# 5030
 Name: Vess Oil Corporation
 Address 1: 1700 Waterfront Parkway, Bldg 500
 Address 2:
 City: Wichita State: KS Zip: 67206 + 5504
 Contact Person: W.R. Horigan
 Phone: 316-682-1537

CONTRACTOR: License# 5363
 Name: Berexco, inc.

Well Drilled For:	Well Class:	Type Equipment:
<input checked="" type="checkbox"/> Oil	<input type="checkbox"/> Enh Rec	<input checked="" type="checkbox"/> Mud Rotary
<input type="checkbox"/> Gas	<input type="checkbox"/> Storage	<input type="checkbox"/> Air Rotary
	<input type="checkbox"/> Disposal	<input type="checkbox"/> Cable
<input type="checkbox"/> Seismic ; _____ # of Holes	<input type="checkbox"/> Wildcat	
<input type="checkbox"/> Other: _____	<input type="checkbox"/> Other	

If OWWO: old well information as follows:
 Operator: _____
 Well Name: _____
 Original Completion Date: _____ Original Total Depth: _____

Directional, Deviated or Horizontal wellbore? Yes No
 If Yes, true vertical depth: _____
 Bottom Hole Location: _____
 KCC DKT #: _____

Spot Description:
 E2 NW NW NW Sec. 27 Twp. 15 S. R. 27 E W
(10-0-00) 330 feet from N / S Line of Section
 650 feet from E / W Line of Section

Is SECTION: Regular Irregular?

(Note: Locate well on the Section Plat on reverse side)

County: Gove
 Lease Name: Munsell "EE" Well #: 2
 Field Name: ROSA NORTHWEST

Is this a Prorated / Spaced Field? Yes No

Target Formation(s): Mississippi

Nearest Lease or unit boundary line (in footage): 330

Ground Surface Elevation: 2465 feet MSL

Water well within one-quarter mile: Yes No

Public water supply well within one mile: Yes No

Depth to bottom of fresh water: 180

Depth to bottom of usable water: 900

Surface Pipe by Alternate: I II

Length of Surface Pipe Planned to be set: 300

Length of Conductor Pipe (if any): _____

Projected Total Depth: 4330

Formation at Total Depth: Mississippi

Water Source for Drilling Operations:

Well Farm Pond Other: _____

DWR Permit #: _____

(Note: Apply for Permit with DWR)

Will Cores be taken? Yes No

If Yes, proposed zone: _____

AFFIDAVIT

RECEIVED
 KANSAS CORPORATION COMMISSION

The undersigned hereby affirms that the drilling, completion and eventual plugging of this well will comply with K.S.A. 55 et. seq.

It is agreed that the following minimum requirements will be met:

APR 26 2007

1. Notify the appropriate district office **prior** to spudding of well;
2. A copy of the approved notice of intent to drill **shall be** posted on each drilling rig;
3. The minimum amount of surface pipe as specified below **shall be set** by circulating cement to the top; in all cases surface pipe **shall be set** through all unconsolidated materials plus a minimum of 20 feet into the underlying formation.
4. If the well is dry hole, an agreement between the operator and the district office on plug length and placement is necessary **prior to plugging**;
5. The appropriate district office will be notified before well is either plugged or production casing is cemented in;
6. If an ALTERNATE II COMPLETION, production pipe shall be cemented from below any usable water to surface within **120 DAYS** of spud date. Or pursuant to Appendix "B" - Eastern Kansas surface casing order #133,891-C, which applies to the KCC District 3 area, alternate II cementing must be completed within 30 days of the spud date or the well shall be plugged. **In all cases, NOTIFY district office** prior to any cementing.

CONSERVATION DIVISION
 WICHITA, KS

I hereby certify that the statements made herein are true and to the best of my knowledge and belief.

Date: 4/25/07 Signature of Operator or Agent: Jammy Buttr Title: PETROLEUM ENGINEER

For KCC Use ONLY
 API # 15 - 063-21662-0000
 Conductor pipe required 0 feet
 Minimum surface pipe required 200 feet per ALT. I II
 Approved by: W.R. 4-26-07
 This authorization expires: 10-26-07
(This authorization void if drilling not started within 6 months of approval date.)
 Spud date: _____ Agent: _____

Remember to:

- File Drill Pit Application (form CDP-1) with Intent to Drill;
- File Completion Form ACO-1 within 120 days of spud date;
- File acreage attribution plat according to field proration orders;
- Notify appropriate district office 48 hours prior to workover or re-entry;
- Submit plugging report (CP-4) after plugging is completed (within 60 days);
- Obtain written approval before disposing or injecting salt water.
- If this permit has expired (See: authorized expiration date) please check the box below and return to the address below.

Well Not Drilled - Permit Expired Date: _____
 Signature of Operator or Agent: _____

27
 15
 27
 E
 W



1009105

IN ALL CASES PLOT THE INTENDED WELL ON THE PLAT BELOW

Plat of acreage attributable to a well in a prorated or spaced field

If the intended well is in a prorated or spaced field, please fully complete this side of the form. If the intended well is in a prorated or spaced field complete the plat below showing that the well will be properly located in relationship to other wells producing from the common source of supply. Please show all the wells and within 1 mile of the boundaries of the proposed acreage attribution unit for gas wells and within 1/2 mile of the boundaries of the proposed acreage attribution unit for oil wells.

API No. 15 - 063-21662-0000
Operator: Vess Oil Corporation
Lease: Munsell "EE"
Well Number: 2
Field: ROSA NORTHWEST

Location of Well: County: Gove
330 feet from N / S Line of Section
650 feet from E / W Line of Section
Sec. 27 Twp. 15 S. R. 27 E W

Number of Acres attributable to well: _____
QTR/QTR/QTR/QTR of acreage: E2 - NW - NW - NW

Is Section: Regular or Irregular

If Section is Irregular, locate well from nearest corner boundary.

Section corner used: NE NW SE SW

PLAT

*(Show location of the well and shade attributable acreage for prorated or spaced wells.)
(Show footage to the nearest lease or unit boundary line.)*

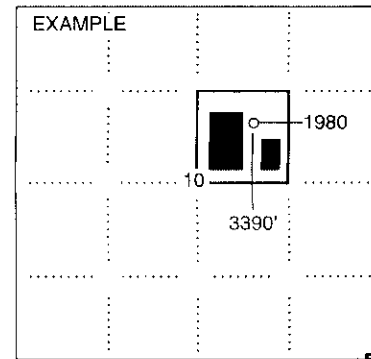
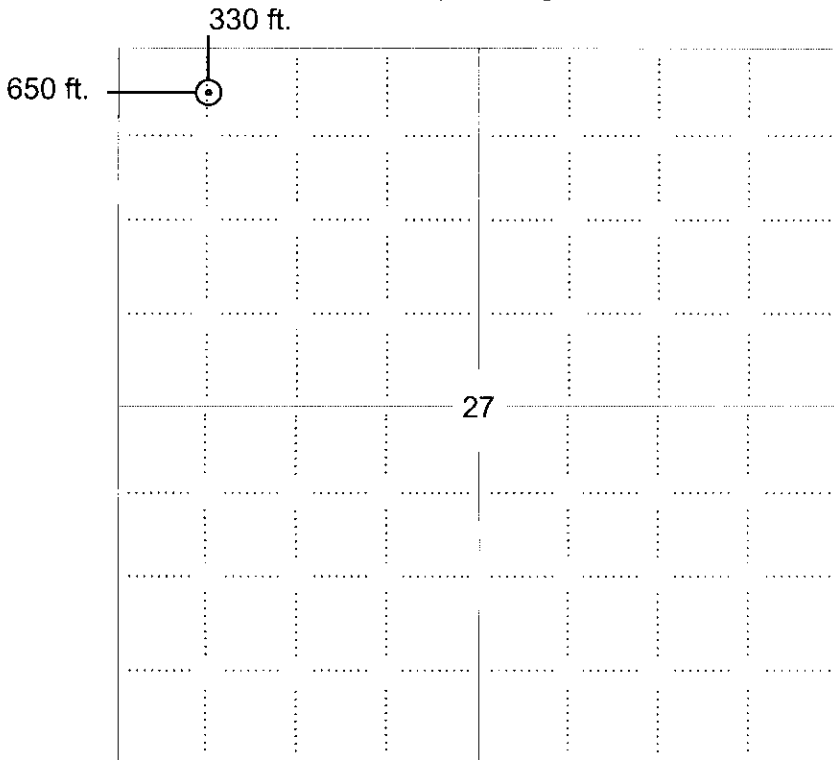

NOTE: In all cases locate the spot of the proposed drilling location.

SEWARD CO.

RECEIVED
KANSAS CORPORATION COMMISSION

APR 26 2007

CONSERVATION DIVISION
WICHITA, KS

In plotting the proposed location of the well, you must show:

1. The manner in which you are using the depicted plat by identifying section lines, i.e. 1 section, 1 section with 8 surrounding sections, 4 sections, etc.
2. The distance of the proposed drilling location from the south / north and east / west outside section lines.
3. The distance to the nearest lease or unit boundary line (in footage).
4. If proposed location is located within a prorated or spaced field a certificate of acreage attribution plat must be attached: (CO-7 for oil wells; CG-8 for gas wells).



KANSAS CORPORATION COMMISSION 1009105
OIL & GAS CONSERVATION DIVISION

Form CDP-1
April 2004
Form must be Typed

APPLICATION FOR SURFACE PIT

Submit in Duplicate

Operator Name: Vess Oil Corporation		License Number: 5030	
Operator Address: 1700 Waterfront Parkway, Bldg 500		Wichita KS 67206	
Contact Person: W.R. Horigan		Phone Number: 316-682-1537	
Lease Name & Well No.: Munsell "EE" 2		Pit Location (QQQQ): E2 - NW - NW - NW	
Type of Pit: <input type="checkbox"/> Emergency Pit <input type="checkbox"/> Burn Pit <input type="checkbox"/> Settling Pit <input checked="" type="checkbox"/> Drilling Pit <input type="checkbox"/> Workover Pit <input type="checkbox"/> Haul-Off Pit <small>(If WP Supply API No. or Year Drilled)</small>	Pit is: <input checked="" type="checkbox"/> Proposed <input type="checkbox"/> Existing If Existing, date constructed: _____ Pit capacity: 6,000 (bbls)	Sec. 27 Twp. 15 R. 27 <input type="checkbox"/> East <input checked="" type="checkbox"/> West 330 Feet from <input checked="" type="checkbox"/> North / <input type="checkbox"/> South Line of Section 650 Feet from <input type="checkbox"/> East / <input checked="" type="checkbox"/> West Line of Section Gove County	
Is the pit located in a Sensitive Ground Water Area? <input type="checkbox"/> Yes <input checked="" type="checkbox"/> No		Chloride concentration: _____ mg/l <small>(For Emergency Pits and Settling Pits only)</small>	
Is the bottom below ground level? <input type="checkbox"/> Yes <input checked="" type="checkbox"/> No		Artificial Liner? <input type="checkbox"/> Yes <input checked="" type="checkbox"/> No	
Pit dimensions (all but working pits): 80 Length (feet) 80 Width (feet) <input type="checkbox"/> N/A: Steel Pits Depth from ground level to deepest point: 6 (feet) <input type="checkbox"/> No Pit		How is the pit lined if a plastic liner is not used? NATURAL CLAYS	
If the pit is lined give a brief description of the liner material, thickness and installation procedure.		Describe procedures for periodic maintenance and determining liner integrity, including any special monitoring.	
Distance to nearest water well within one-mile of pit 4438 feet Depth of water well 75 feet		Depth to shallowest fresh water 65 feet. Source of information: <input type="checkbox"/> measured <input type="checkbox"/> well owner <input type="checkbox"/> electric log <input checked="" type="checkbox"/> KDWR	
Emergency, Settling and Burn Pits ONLY: Producing Formation: _____ Number of producing wells on lease: _____ Barrels of fluid produced daily: _____ Does the slope from the tank battery allow all spilled fluids to flow into the pit? <input type="checkbox"/> Yes <input type="checkbox"/> No		Drilling, Workover and Haul-Off Pits ONLY: Type of material utilized in drilling/workover: fresh water - mud Number of working pits to be utilized: 3 Abandonment procedure: Evaporated, backfilled and compacted. Drill pits must be closed within 365 days of spud date.	
I hereby certify that the above statements are true and correct to the best of my knowledge and belief.		RECEIVED KANSAS CORPORATION COMMISSION	
4/25/07 Date		 Signature of Applicant or Agent	
		APR 26 2007 CONSERVATION DIVISION WICHITA, KS	
KCC OFFICE USE ONLY			
Date Received: 4/26/07 Permit Number: _____		Steel Pit <input type="checkbox"/> RFAC <input type="checkbox"/> RFAS <input type="checkbox"/>	
Permit Date: 4/26/07 Lease Inspection: <input checked="" type="checkbox"/> Yes <input type="checkbox"/> No			

15 063-21612-0000