

AMENDED

KANSAS CORPORATION COMMISSION  
OIL & GAS CONSERVATION DIVISION

ORIGINAL

Form AGO-1  
September 1999  
Form Must Be Typed

WELL COMPLETION FORM  
WELL HISTORY - DESCRIPTION OF WELL & LEASE

Operator: License # 33019  
Name: Rosewood Resources Inc.  
Address: 2711 N. Haskell Ave., Suite 2800, LB 22  
City/State/Zip: DALLAS, TX 75201  
Purchaser: \_\_\_\_\_  
Operator Contact Person: Steven VonFeldt  
Phone: (214) 756-8679  
Contractor: Name: Excell Drilling Company  
License: 8273  
Wellsite Geologist: Steven VonFeldt

Designate Type of Completion:  
 New Well  Re-Entry  Workover  
 Oil  SWD  SLOW  Temp. Abd.  
 Gas  ENHR  SIGW  
 Dry  Other (Core, WSW, Expl., Cathodic, etc)

If Workover/Re-entry: Old Well Info as follows:  
Operator: \_\_\_\_\_  
Well Name: \_\_\_\_\_

Original Comp. Date: \_\_\_\_\_ Original Total Depth: \_\_\_\_\_  
 Deepening  Re-perf.  Conv. to Enhr./SWD  
 Plug Back \_\_\_\_\_ Plug Back Total Depth \_\_\_\_\_  
 Commingled \_\_\_\_\_ Docket No. \_\_\_\_\_  
 Dual Completion \_\_\_\_\_ Docket No. \_\_\_\_\_  
 Other (SWD or Enhr.?) \_\_\_\_\_ Docket No. \_\_\_\_\_

10/04/2004 10/14/2004 10/15/2004  
Spud Date or Date Reached TD Completion Date or  
Recompletion Date Recompletion Date

API No. 15 - 023-20588-00-00  
County: Cheyenne  
       NW SE Sec. 23 Twp. 3 S. R. 41  East  West  
2231 feet from (S) N (circle one) Line of Section  
2012 feet from (E) W (circle one) Line of Section

Footages Calculated from Nearest Outside Section Corner:  
(circle one) NE (SE) NW SW  
Lease Name: Isamihagen Well #: 3-23  
Field Name: Cherry Creek

Producing Formation: NIOBRARA  
Elevation: Ground: 3402' Kelly Bushing: 3414'  
Total Depth: 5165' Plug Back Total Depth: 3245'  
Amount of Surface Pipe Set and Cemented at 177 @ 188 Feet  
Multiple Stage Cementing Collar Used?  Yes  No  
If yes, show depth set DV tool @ 1430' Feet  
If Alternate II completion, cement circulated from \_\_\_\_\_  
feet depth to \_\_\_\_\_ w/ \_\_\_\_\_ sx cement.

Drilling Fluid Management Plan  
(Data must be collected from the Reserve Pit)  
Chloride content 5000 ppm Fluid volume 220 bbls  
Dewatering method used Evaporation  
Location of fluid disposal if hauled offsite: \_\_\_\_\_  
Operator Name: \_\_\_\_\_ **RECEIVED**  
Lease Name: \_\_\_\_\_ License **OCT 11 2005**  
Quarter \_\_\_\_\_ Sec. \_\_\_\_\_ Twp. \_\_\_\_\_ S. R. \_\_\_\_\_  East  West  
County: \_\_\_\_\_ Docket No.: **CONSERVATION DIVISION**  
**WICHITA, KS**

**INSTRUCTIONS:** An original and two copies of this form shall be filed with the Kansas Corporation Commission, 130 S. Market - Room 2078, Wichita, Kansas 67202, within 120 days of the spud date, recompletion, workover or conversion of a well. Rule 82-3-130, 82-3-106 and 82-3-107 apply. Information of side two of this form will be held confidential for a period of 12 months if requested in writing and submitted with the form (see rule 82-3-107 for confidentiality in excess of 12 months). One copy of all wireline logs and geologist well report shall be attached with this form. ALL CEMENTING TICKETS MUST BE ATTACHED. Submit CP-4 form with all plugged wells. Submit CP-111 form with all temporarily abandoned wells.

All requirements of the statutes, rules and regulations promulgated to regulate the oil and gas industry have been fully complied with and the statements herein are complete and correct to the best of my knowledge.

Signature: [Signature]  
Title: Reservoir Engineer Date: 10-7-2005  
Subscribed and sworn to before me this 7<sup>th</sup> day of October,  
2005.  
Notary Public: [Signature]  
Date Commission Expires: \_\_\_\_\_

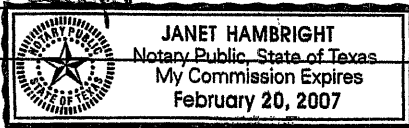

**KCC Office Use ONLY**  
 Letter of Confidentiality Received  
If Denied, Yes  Date: \_\_\_\_\_  
 Wireline Log Received  
 Geologist Report Received  
 LIC Distribution [Signature] 10-10-05

Operator Name: Rosewood Resources Inc. Lease Name: Isernhagen Well #: 3-23  
 Sec. 23 Twp. 3 S. R. 41  East  West County: Cheyenne

**INSTRUCTIONS:** Show important tops and base of formations penetrated. Detail all cores. Report all final copies of drill stems tests giving interval tested, time tool open and closed, flowing and shut-in pressures, whether shut-in pressure reached static level, hydrostatic pressures, bottom hole temperature, fluid recovery, and flow rates if gas to surface test, along with final chart(s). Attach extra sheet if more space is needed. Attach copy of all Electric Wireline Logs surveyed. Attach final geological well site report.

Drill Stem Tests Taken  Yes  No  
 (Attach Additional Sheets)

Samples Sent to Geological Survey  Yes  No

Cores Taken  Yes  No

Electric Log Run  Yes  No  
 (Submit Copy)

List All E. Logs Run:

Platform Express Resistivity, Porosity, Density;  
 ML-GR; BHC-Sonic-GR

Log Formation (Top), Depth and Datum  Sample

Name	Top	Datum
Beecher Island	1200'	KB
Carlisle	1790'	KB
Morrison	2630'	KB
Stone Corral	3170'	KB
Topeka	4070'	KB
Lansing J	4410'	KB
Morrow	4980'	KB
Mississippi	5090'	KB

CASING RECORD <input checked="" type="checkbox"/> New <input type="checkbox"/> Used							
Report all strings set-conductor, surface, intermediate, production, etc.							
Purpose of String	Size Hole Drilled	Size Casing Set (In O.D.)	Weight Lbs./ Ft.	Setting Depth	Type of Cement	# Sacks Used	Type and Percent Additives
Surface	11"	8-5/8"		189'	Neat	92	
Production	7-7/8"	4-1/2"	10.5	3274'	Type 3	290	stage1
DV Tool				1430'	Type 3	300	stage 2

ADDITIONAL CEMENTING / SQUEEZE RECORD				
Purpose:	Depth Top Bottom	Type of Cement	#Sacks Used	Type and Percent Additives
<input type="checkbox"/> Perforate				
<input type="checkbox"/> Protect Casing				
<input type="checkbox"/> Plug Back TD				
<input type="checkbox"/> Plug Off Zone				

Shots Per Foot	PERFORATION RECORD - Bridge Plugs Set/Type Specify Footage of Each Interval Perforated	Acid, Fracture, Shot, Cement Squeeze Record (Amount and Kind of Material Used)		Depth

**RECEIVED**  
**KANSAS CORPORATION COMMISSION**  
**OCT 11 2005**  
**CONSERVATION DIVISION**  
**WICHITA, KS**

TUBING RECORD		Size	Set At	Packer At	Liner Run <input type="checkbox"/> Yes <input type="checkbox"/> No
Date of First, Resumerd Production, SWD or Enhr.		Producing Method <input type="checkbox"/> Flowing <input type="checkbox"/> Pumping <input type="checkbox"/> Gas Lift <input type="checkbox"/> Other (Explain)			
Estimated Production Per 24 Hours	Oil Bbls.	Gas Mcf	Water Bbls.	Gas-Oil Ratio	Gravity

Disposition of Gas  Vented  Sold  Used on Lease (If vented, Submit ACO-18.)

METHOD OF COMPLETION  Open Hole  Perf.  Dually Comp.  Commingled

Production Interval  Other (Specify)

Rosewood Resources Inc.  
 27011 N. Haskell Ave., Ste. 2800  
 Dallas, Texas 75204

Engineer: Dennis Harris 214-756-6621

Date: 10/04/2005

Addendum to UI Application

well: Isernhagen 3-23

Underground Injection Application MIT data to support 500 PSI max surface pressure

	FWG	Depth	Ph, psi	BPM	BBLs	Ps, psi	Comment	Ph+Ps	Frac Grad
MIT Test Data	0.433	3072	1330	1.00	10		vac	1330	0.433
	0.433	3072	1330	2.90	25	-20	vac	1310	0.426
	0.433	3072	1330	3.25	25	110		1440	0.469
	0.433	3072	1330	3.50	25	200		1530	0.498
	0.433	3072	1330	3.75	25	290		1620	0.527
	<b>0.433</b>	<b>3072</b>	<b>1330</b>	<b>4.25</b>	<b>25</b>	<b>390</b>		<b>1720</b>	<b>0.560</b>
	0.433	3072	1330	4.50	25	590		1920	0.625
	0.433	3072	1330	4.75	65	700		2030	0.661
	0.433	3072	1330	1.58	0	-20	vac	1310	0.426
extrapolated		3072		0.00				440	0.143
extrapolated		3072		0.50				593	0.193
extrapolated		3072		1.00				747	0.243
extrapolated		3072		2.00				1054	0.343
extrapolated		3072		3.00				1361	0.443
extrapolated		3072		4.00				1668	0.543

Proposed Injection Rate: 1000 BPD  
 1440 min/day  
 Proposed Injection Rate 0.694 BPM

RECEIVED  
 KANSAS CORPORATION COMMISSION  
 OCT 11 2005  
 CONSERVATION DIVISION  
 WICHITA, KS

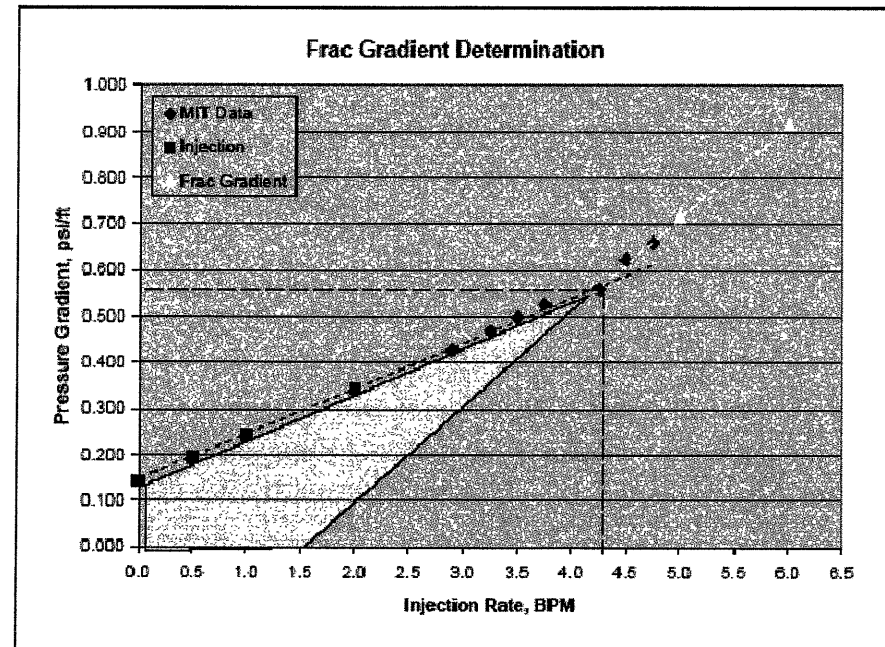
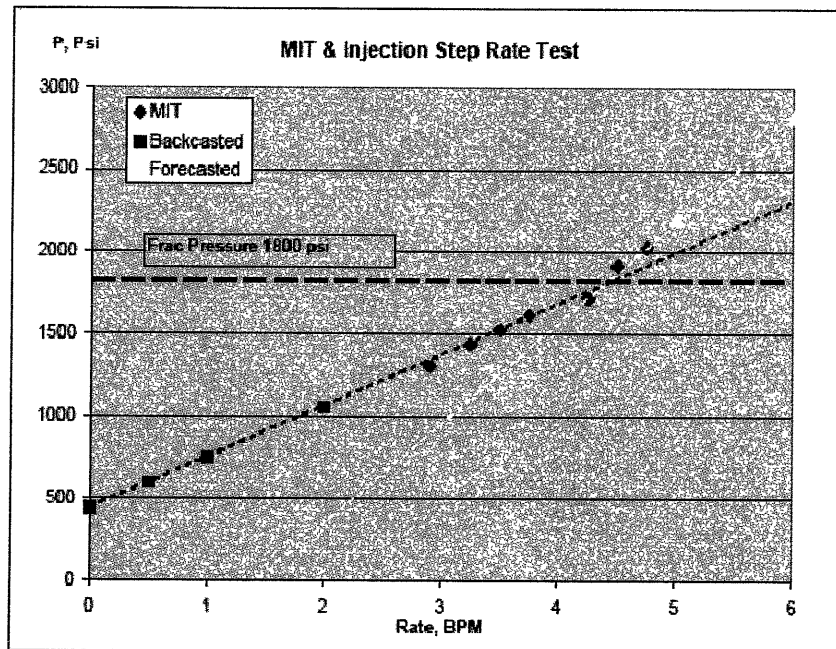



October 5, 2005

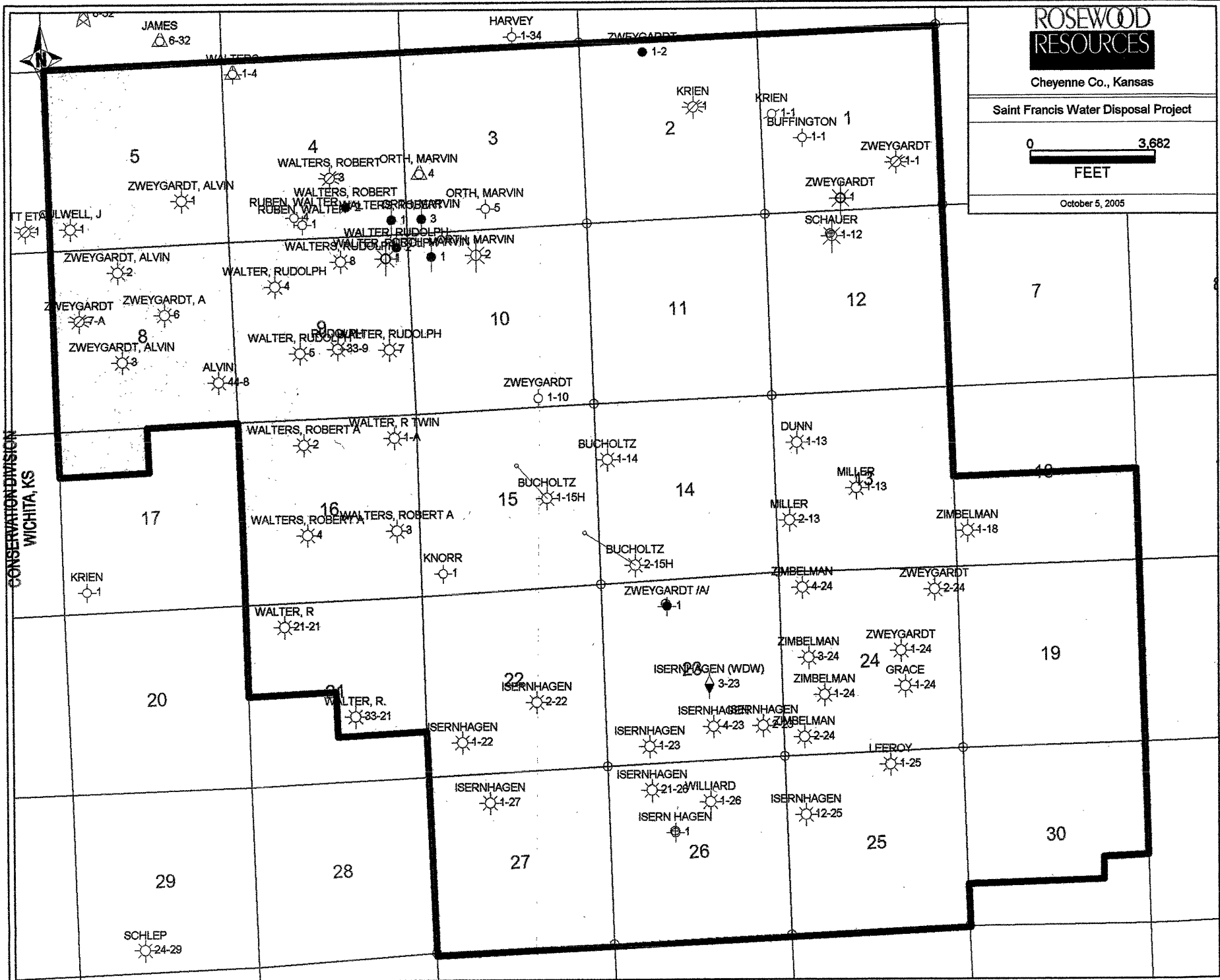

RECEIVED  
KANSAS CORPORATION COMMISSION  
OCT 11 2005

CONSERVATION DIVISION  
WICHITA, KS

# Saint Francis Water Disposal Project

(Legal description of disposal acreage)

Rosewood Resources Incorporated plans and intends to operate a water disposal project in Cheyenne County, Kansas; herein defined by the illustrated map titled, "Saint Francis Water Disposal Project" and is comprised of the following acreage description as of the date October 5, 2005:

## **Township 3S, Range 41W:**

Section 1: South half containing the Zweygartd #1-1, and Zweygartd #1 wells and acreage.

Section 2: excluded.

Section 3: West half acreage containing the plug & abandoned wells: Marvin Orth #3,#4,and #5.

Section 4: South half section containing the Robert Walters #2, Robert Waters #1(P&A), and Robert Walters #3(P&A) and acreage

Section 5: South half plus northwest quarter containing the Alvin Zweygartd #1 , J. Culwell #1 gas wells and acreage.

Sections: 8, 9, 10, 11, 12, 13, 14, 15, 16 containing all acreage and wells.

Section 17: the acreage in the north half of the northwest quarter.

Section 21: North half of section plus the north half of the southeast quarter.

Sections: 22, 23, 24, 25 containing all acreage and wells.

Section 26: North half of section plus the southeast quarter plus the north half of the southwest quarter containing the acreage and the Willard #1-26 gas well.

Section 27: all acreage plus the Isernhagen #1-27 gas well.

## **Township 3S, Range 40W:**

Section 18: South half of section containing all acreage and the Zimbleman #1-18 gas well.

Section 19: the acreage belonging to the east half of the section.

Section 30: All acreage in the north half of section plus the north half of the southwest quarter; plus the northwest quarter of the southeast quarter; plus the north half of the northeast quarter of the southeast quarter;