

STATE CORPORATION COMMISSION OF KANSAS
OIL & GAS CONSERVATION DIVISION
WELL COMPLETION OR RECOMPLETION FORM
ACO-1 WELL HISTORY
DESCRIPTION OF WELL AND LEASE

Operator: License # 5205
Name Mid Continent Energy
Address 120 S. Market, Suite 310
Wichita, KS 67202
City/State/Zip

Purchaser

Operator Contact Person Jack Buehler
Phone 316-265-9501

Contractor: License # 5418
Name Allen Drilling Company

Wellsite Geologist Kent Roberts
Phone 316-265-9501

Designate Type of Completion
 New Well Re-Entry Workover
 Oil SWD Temp Abd
 Gas Inj Delayed Comp
 Dry Other (Core, Water Supply etc)

If OWWO: old well info as follows:
Operator
Well Name
Comp. Date Old Total Depth

WELL HISTORY

Drilling Method:
 Mud Rotary Air Rotary Cable
10-11-85 10-16-85 10-17-85
Spud Date Date Reached TD Completion Date
3067 KCC 3380 ZAP
Total Depth PBSD
Amount of Surface Pipe Set and Cemented at 248 feet
Multiple Stage Cementing Collar Used? Yes No
If yes, show depth set 1,617 feet
If alternate 2 completion, cement circulated from 1,617 feet depth to surface/350.SX cmt
Cement Company Name B.J. Titan
Invoice #

API NO. 15-163-22,778-00-00
County Rooks
S/2 NW NW Sec. 31 Twp. 9 Rge. 18 East West

4290 Ft North from Southeast Corner of Section
4620 Ft West from Southeast Corner of Section
(Note: Locate well in section plat below)

Lease Name Mayhew Well # 2

Field Name Williams NW

Producing Formation KCC ZAY KCC ZAY

Elevation: Ground 2182 2187 2190 2195 KB

Section Plat

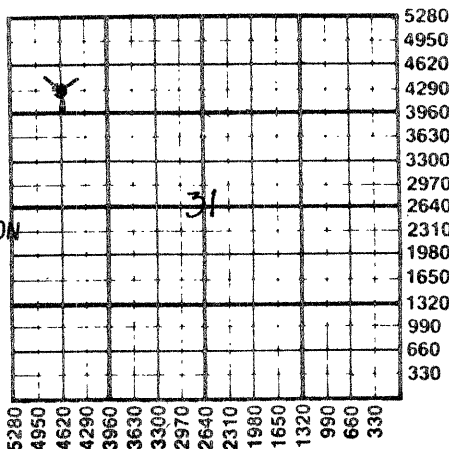

WATER SUPPLY INFORMATION

Disposition of Produced Water: Disposal
Docket # Repressuring

Questions on this portion of the ACO-1 call:

Water Resources Board (913) 296-3717

Source of Water:
Division of Water Resources Permit #

Groundwater Ft North from Southeast Corner (Well) Ft West from Southeast Corner of Sec Twp Rge East West

Surface Water Ft North from Southeast Corner (Stream, pond etc) Ft West from Southeast Corner Sec Twp Rge East West

Other (explain) (purchased from city, R.W.D. #)

INSTRUCTIONS: This form shall be completed in duplicate and filed with the Kansas Corporation Commission, 200 Colorado Derby Building, Wichita, Kansas 67202, within 90 days after completion or recompletion of any well. Rule 82-3-130 and 82-3-107 apply.

Information on side two of this form will be held confidential for a period of 12 months if requested in writing and submitted with the form. See rule 82-3-107 for confidentiality in excess of 12 months. One copy of all wireline logs and drillers time log shall be attached with this form. Submit CP-4 form with all plugged wells. Submit CP-111 form with all temporarily abandoned wells.

All requirements of the statutes, rules and regulations promulgated to regulate the oil and gas industry have been fully complied with and the statements herein are complete and correct to the best of my knowledge.

Signature Kent R. Roberts
Title Petroleum Geologist Date 11/12/85

Subscribed and sworn to before me this 12th day of November 1985
Notary Public Mary Kathleen Bachman

Date Commission Expires Mary Kathleen Bachman



K.C.C. OFFICE USE ONLY
F Letter of Confidentiality Attached
C Wireline Log Received
C Drillers Time-log Received
Distribution
KCC SWD/Rep NGPA
KGS Plug Other
(Specify)

Sec. 31 Twp. 9 Rge. 18 E

SIDE TWO

Operator NameMid..Continent..Energy..... Lease Name.....Mayhew.....Well #.....2

Sec.....31... Twp.....9... Rge.....18... East West County.....Rooks.....

WELL LOG

INSTRUCTIONS: Show important tops and base of formations penetrated. Detail all cores. Report all drill stem tests giving interval tested, time tool open and closed, flowing and shut-in pressures, whether shut-in pressure reached static level, hydrostatic pressures, bottom hole temperature, fluid recovery, and flow rates if gas to surface during test. Attach extra sheet if more space is needed. Attach copy of log.

Drill Stem Tests Taken Yes No
 Samples Sent to Geological Survey Yes No
 Cores Taken Yes No

Formation Description
 Log Sample

NO DST'S TAKEN.

Name	Top	Bottom
Anhydrite	1585	+ 602
Topeka	3139	- 952
Heebner	3353	-1166
Toronto	3378	-1191
Lansing	3394	-1207
B/Kansas City	3628	-1441
U. Simpson	3702	-1515
L. Simpson	3720	-1533
Arbuckle	3738	-1551
R.T.D.	3830	-1643
L.T.D.	3834	-1647
D.D.T.D.	3867	-1680

CASING RECORD New Used
 Report all strings set-conductor, surface, intermediate, production, etc.

Purpose of String	Size Hole Drilled	Size Casing Set (in O.D.)	Weight Lbs/Ft.	Setting Depth	Type of Cement	#Sacks Used	Type and Percent Additives
Surface	12 1/4	8 5/8	23#	248	60/40 pqz	150	3% CC 2% Gel
Production	7 7/8	5 1/2	16.5#	3791	60/40 pqz	150	10% salt
DV				1617	50/50 pqz	350	6% Gel

Shots Per Foot	Specify Footage of Each Interval Perforated	Acid, Fracture, Shot, Cement Squeeze Record (Amount and Kind of Material Used)	Depth
OH	3791 - 3867'	1,000 gal. 28%	3791-3867'

TUBING RECORD Size 2-3/8" Set At 3,780' Packer at 3,780' Liner Run Yes No

Date of First Production _____ Producing Method Flowing Pumping Gas Lift Other (explain).....

Estimated Production Per 24 Hours	Oil Bbls	Gas MCF	Water Bbls	Gas-Oil Ratio	Gravity
			S.W.D.W. - 3 bbl./min. on vacuum.		

METHOD OF COMPLETION

Production Interval

Disposition of gas: Vented Open Hole Perforation
 Sold Other (Specify)
 Used on Lease

OH 3791-3867'

Dually Completed
 Commingled

S.W.D.W.