

Notice: Fill out COMPLETELY and return to Conservation Division at the address below within 60 days from plugging date.

KANSAS CORPORATION COMMISSION
OIL & GAS CONSERVATION DIVISION
WELL PLUGGING RECORD
K.A.R. 82-3-117

Form CP-4
December 2003
Type or Print on this Form
Form must be Signed
All blanks must be Filled

Lease Operator: W. D. Short Oil Co., LLC
Address: P. O. Box 729-102 S. River Rd., Oxford, Ks. 67119
Phone: (620) 455-3576 Operator License #: 33608
Type of Well: Oil Docket #: _____
(Oil, Gas D&A, SWD, ENHR, Water Supply Well, Cathodic, Other) (If SWD or ENHR)
The plugging proposal was approved on: 11-27-2006 (Date)
by: Barry Metz (KCC District Agent's Name)
Is ACO-1 filed? Yes No If not, is well log attached? Yes No
Producing Formation(s): List All (If needed attach another sheet)
Arbuckle Depth to Top: 3549 Bottom: 3600 T.D. 3600

Depth to Top: _____ Bottom: _____ T.D. _____

API Number: 15 - 035-19231-00-00
Lease Name: Waite
Well Number: #8 SE NW SE 6PS
Spot Location (QQQQ): NW SE SE 3-207
990/674 Feet from North / South Section Line ojs
990/1775 Feet from East / West Section Line
Sec. 19 Twp. 32 S. R. 3 East West
County: Cowley
Date Well Completed: 11-09-1925
Plugging Commenced: 01-05-2007
Plugging Completed: 02-28-2007

Show depth and thickness of all water, oil and gas formations.

Oil, Gas or Water Records		Casing Record (Surface Conductor & Production)				
Formation	Content	From	To	Size	Put In	Pulled Out
Arbuckle	Oil	3549	3600	20"	38'	0
				10"	1902'	400'
				8-1/4" 5/2	2568' 3549	999'

KCC Pkt 3/13/07 Per CPA/3

Describe in detail the manner in which the well is plugged, indicating where the mud fluid was placed and the method or methods used in introducing it into the hole. If cement or other plugs were used, state the character of same depth placed from (bottom), to (top) for each plug set.

Ran Tubing and spotted 150sx cement w/4% Gel @ 2580'(1-8-07), Pulled tubing and shot off 8-1/4"@999', Pulled pipe, shot off 10" @ 400', pulled pipe, Pumped top plug 565sx cement w/ 4% Gel(350' to Surface)

Name of Plugging Contractor: Braden, James R. DBA Braden Petroleum + Well Plugging CO
W. D. Short Oil Co., LLC License #: 33608-32475
Address: P.O. Box 729 Oxford, Ks. 67119

Name of Party Responsible for Plugging Fees: W. D. Short Oil Co., LLC KCC Pkt 3/13/07
State of Kansas County, Sumner, ss. Per CPA/3

William D. (Don) Short, Jr. (Employee of Operator) or (Operator) on above-described well, being first duly sworn on oath, says: That I have knowledge of the facts statements, and matters herein contained, and the log of the above-described well is as filed, and the same are true and correct, so help me God.

(Signature) [Signature]
(Address) P.O. Box 729, 102 S. River Rd. Oxford, Ks. 67119

SUBSCRIBED and SWORN TO before me this 8th day of March, 2007

DENESE A. WILSON
Notary Public - State of Kansas
My Appt. Expires 3-30-09

[Signature] My Commission Expires: 3-30-09
Notary Public

Mail to: KCC - Conservation Division, 130 S. Market - Room 2078, Wichita, Kansas 67202
RECEIVED
MAR 12 2007
KCC WICHITA Per

CONSOLIDATED
OIL WELL
SERVICES, LLC

REMIT TO
Consolidated Oil Well Services, LLC
Dept. 1228
Denver, CO 80256

MAIN OFFICE
P.O. Box 884
Chanute, KS 66720
620/431-9210 • 1-800/467-8676
FAX 620/431-0012

INVOICE

Invoice # 212113

Invoice Date: 02/28/2007 Terms:

Page 1

W.D. SHORT OIL CO LLC
P.O. BOX 729
OXFORD KS 67115
() -

WAITE #2/8
16932
02-28-07

SCANNED

3-6-07 DATE

FILE COPY

Part Number	Description	Qty	Unit Price	Total
1131	60/40 POZ MIX	565.00	9.8000	5537.00
1118A	S-5 GEL/ BENTONITE (50#)	1940.00	.1500	291.00
	Description	Hours	Unit Price	Total
439	TON MILEAGE DELIVERY	648.00	1.10	712.80
442	TON MILEAGE DELIVERY	648.00	1.10	712.80
485	P & A OLD WELL	1.00	550.00	550.00
515	TON MILEAGE DELIVERY	648.00	1.10	712.80

Parts:	5828.00	Freight:	.00	Tax:	338.03	AR	8854.43
Labor:	.00	Misc:	.00	Total:	8854.43		
Sublt:	.00	Supplies:	.00	Change:	.00		

RECEIVED

MAR 12 2007

Signed _____

Date _____

KCC WICHITA

BARTLESVILLE, OK
278 CR 2706 74003
918/338-0808

EUREKA, KS
820 E. 7th 67045
620/583-7664

OTTAWA, KS
2631 So. Eisenhower Ave. 66067
785/242-4044

GILLETTE, WY
300 Enterprise Avenue 82716
307/686-4914

THAYER, KS
8655 Dorn Road 66776
620/839-5269

WORLAND, WY
837 Hwy US 16 E 82401
307/347-4577

CONSOLIDATED
OIL WELL
SERVICES, LLC

REMIT TO
Consolidated Oil Well Services,
Dept. 1228
Denver, CO 80256

MAIN OFFICE
P.O. Box 884
Chanute, KS 66720
620/431-9210 • 1-800/467-8676
FAX 620/431-0012

INVOICE

Invoice # 211406

Invoice Date: 01/12/2007 Terms:

Page 1

W.D. SHORT OIL CO LLC
P.O. BOX 729
OXFORD KS 67115
()

FILE COPY

WAITE #8
16748
01-08-07

SCANNED

1-23-07 DATE

Part Number	Description	Qty	Unit Price	Total
1131	60/40 POZ MIX	150.00	9.8000	1470.00
1118A	S-5 GEL/ BENTONITE (50#)	500.00	.1500	75.00
Description		Hours	Unit Price	Total
442	TON MILEAGE DELIVERY	363.64	1.10	400.00
463	P & A OLD WELL	1.00	550.00	550.00
463	EQUIPMENT MILEAGE (ONE WAY)	80.00	3.30	264.00

Parts:	1545.00	Freight:	.00	Tax:	89.61	AR	2848.61
Labor:	.00	Misc:	.00	Total:	2848.61		
Sublt:	.00	Supplies:	.00	Change:	.00		

Signed _____

Date _____

BARTLESVILLE, Ok
278 CR 2706 74003
918/338-0808

EUREKA, Ks
820 E. 7th 67045
620/583-7664

OTTAWA, Ks
2631 So. Eisenhower Ave. 66067
785/242-4044

GILLETTE, WY
300 Enterprise Avenue 82716
307/686-4914

THAYER, Ks
8655 Dorn Road 66776
620/431-9210

RECEIVED
WORLAND, WY
837 Hwy US 16 E 82401
307/471-1527

RECEIVED
MAR 12 2007 KCC WICHITA

KCC WICHITA

CONSOLIDATED OIL WELL SERVICES, LLC
 P.O. BOX 884, CHANUTE, KS 66720
 620-431-9210 OR 800-467-8676

TICKET NUMBER 16748
 LOCATION FOREMAN
 FOREMAN RICK LEONARD

TREATMENT REPORT & FIELD TICKET CEMENT

DATE 1-08-07	CUSTOMER # 7876	WELL NAME & NUMBER WAZIE #8	SECTION	TOWNSHIP	RANGE	COUNTY Cowley																
CUSTOMER W. D. Short Ore Co. Inc.			<table border="1" style="width: 100%; border-collapse: collapse;"> <tr> <td>TRUCK #</td> <td>DRIVER</td> <td>TRUCK #</td> <td>DRIVER</td> </tr> <tr> <td>463</td> <td>Kyle</td> <td></td> <td></td> </tr> <tr> <td>442</td> <td>Jarrid</td> <td></td> <td></td> </tr> <tr> <td> </td> <td> </td> <td> </td> <td> </td> </tr> </table>				TRUCK #	DRIVER	TRUCK #	DRIVER	463	Kyle			442	Jarrid						
TRUCK #	DRIVER	TRUCK #					DRIVER															
463	Kyle																					
442	Jarrid																					
MAILING ADDRESS P.O. Box 729																						
CITY Oxford	STATE KS	ZIP CODE 67119																				
JOB TYPE P.T.A.	HOLE SIZE	HOLE DEPTH	CASING SIZE & WEIGHT																			
CASING DEPTH	DRILL PIPE	TUBING 2 3/8"	OTHER																			
SLURRY WEIGHT	SLURRY VOL	WATER gal/sk	CEMENT LEFT in CASING																			
DISPLACEMENT 7 1/2 bbl	DISPLACEMENT PSI	MIX PSI	RATE																			

REMARKS: **Safety meeting: Rig up to 2 3/8" tubing. Pump 20 bbl fresh water ahead. Pump 4 sks gel-flush. Mixed 150 sks 60/40 Peamix cement w/ 4% gel @ 2580'. Displaced with 7 1/2 bbl fresh water. Job complete. Rig down.**

"Thank you"

ACCOUNT CODE	QUANTITY or UNITS	DESCRIPTION of SERVICES or PRODUCT	UNIT PRICE	TOTAL
5405A	1	PUMP CHARGE	550.00	550.00
5406	80	MILEAGE	3.30	264.00
1131	150 sks	60/40 Peamix cement	9.80	1470.00
1118A	500 #	4% gel	.15	75.00
5407A	6.45	hour-mileage bulk truck (asbidded)	1.10	400.00
			Subtotal	2759.00
			SALES TAX	89.61
			ESTIMATED TOTAL	2848.61

AUTHORIZATION called by W.D. Short

TITLE

211406

DATE

RECEIVED
 MAR 12 2007
 KCC WICHITA

15-035-15231 00 00

19-32-3e Wati #8 01

WAITE #8 SE NW SE

MARCH 20 TO DOUG FROM AMY

GPS DK

NEW GPS IS ALMOST ON OLD WELL SPOT ON 37.25004 - 97.13738 MAP

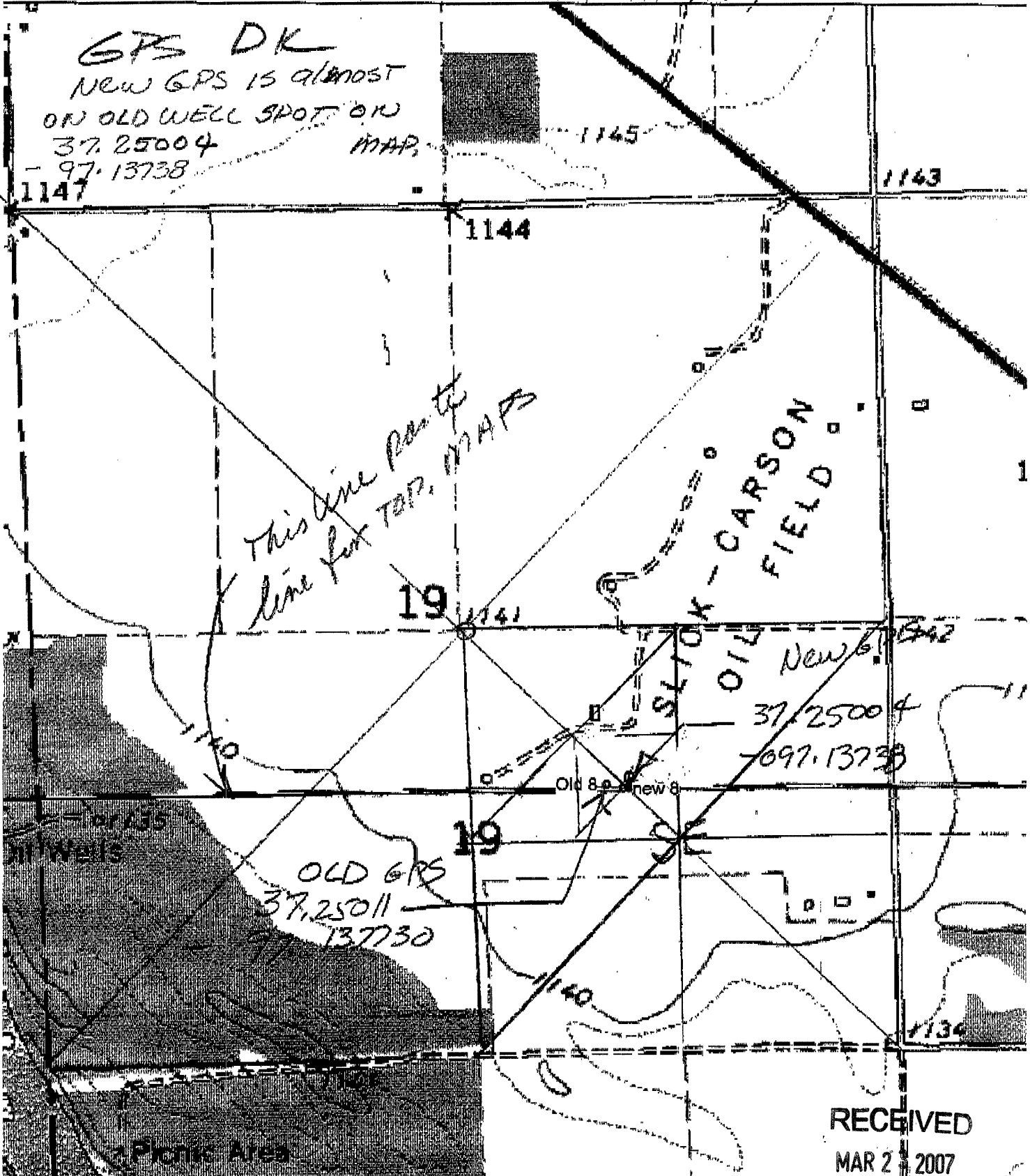

This line points line for TOP MAPS

SLICK-CARSON FIELD

New 6 37.25004 -97.13738

OLD 6 37.25011 -97.13730

RECEIVED

MAR 23 2007

KCC WICHITA