

15-163-30197-00-01

WELL PLUGGING RECORD

Give All Information Completely
 Make Required Affidavit

COUNTY Rooks SEC. 5 TWP. 9 RGE. 19 E/W
 Location as in quarters or footage from lines:
SE/NE/NE

| | | | |
|--|--|--|--|
| | | | |
| | | | |
| | | | |
| | | | |

Lease Owner Frontier Oil Company
 Lease Name Ondrasek Well No. #1
 Office Address 1437 N. Franklin - Russell, Ks. 67665
 Character of Well (Completed as Oil, Gas or Dry Hole): Oil
 Date Well Completed _____
 Application for plugging filed _____
 Plugging commenced June 26, 1982
 Plugging completed July 7, 1982
 Reason for abandonment of well or producing formation Depleted

Locate Well
 correctly on above
 Section Platt.

Was permission obtained from the Conservation Division or it's
 Agent's before plugging was commenced? Yes

Name of Conservation Agent who supervised plugging of this well Mr. Hamel

Producing formation _____ Depth to top _____ bottom _____ T.D. 3507'

Show depth and thickness of all water, oil and gas formations.

OIL, GAS OR WATER RECORDS

Casing Record

| Formation | Content | From | To | Size | Put in | Pulled Out |
|-----------|---------|------|----|--------|--------|------------|
| | | | | 8 5/8" | 208' | NONE |
| | | | | 4 1/2" | 3506' | 1991.53' |
| | | | | | | |
| | | | | | | |

Describe in detail the manner in which the well was plugged, indicating where the mud
 fluid was placed and the method or methods used in introducing it into the hold. If cement
 or other plugs were used, state the character of same and depth placed, from _____ feet
 to _____ feet for each plug set.

Dumped sand to 3400' and four (4) sacks cement.
Shot pipe @ 2700', 2500', 2300', 2100' and 2000'.
Pulled fifty-three (53) joints of 4 1/2" casing.
Allied plugged well with five (5) sacks hulls, twelve (12)
sacks gel, one (1) sack hulls, seventy (70) sacks 50/50
pozmix cement with 6 % added gel and 3% calcium chloride
and eight (8) sacks gel. Released the plug and displaced
seventy (70) sacks cement at 300 psi max. press. shutin at 100 psi.

(If additional description is necessary, use BACK of this sheet)

Name of Plugging Contractor Rockhold Engineering, Inc.

STATE OF KANSAS COUNTY OF BARTON, ss.

James W. Rockhold (employee of owner) or (owner or operator) of the
 above-described well, being first duly sworn on oath, says: That I have knowledge of the
 facts, statements, and matters herein contained and the log of the above-described well as
 filed and that the same are true and correct. So help me God.

(Signature) James W. Rockhold
 JAMES W. ROCKHOLD - Box 698 - Great Bend, Ks.
 (Address) 67530

SUBSCRIBED AND SWORN TO before me this 20th day of August, 1982

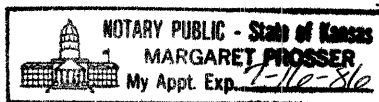

Margaret Prosser
 Notary Public.
 STATE CORPORATION COMMISSION
8/23/82
AUG 23 1982

My Commission expires: _____

15-163-30197-00-01

KANSAS

WELL COMPLETION REPORT AND DRILLER'S LOG

S. 5 T. 9S R. 19W ^E_W
 Loc. SE/4 NE/4 NE/4

API No. 15 — OWWO —
 County Number

County Rooks

Operator
Frontier Oil Company

Address
1720 KSB Building, Wichita, Kansas 67202

Well No. 1 Lease Name Ondrasek

Footage Location
 feet from (N) (S) line feet from (E) (W) line

Principal Contractor Red Tiger Drilling Company Geologist Richard Parker

Spud Date 7/22/81 Date Completed 8-3-81 Total Depth 3,507' P.B.T.D. n/a

Directional Deviation none Oil and/or Gas Purchaser n/a [T/A]

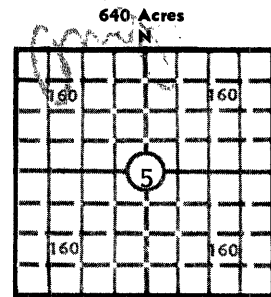

Elev.: Gr. 2038

DF 2041 KB 2,043'

CASING RECORD

Report of all strings set — surface, intermediate, production, etc.

| Purpose of string | Size hole drilled | Size casing set (in O.D.) | Weight lbs/ft. | Setting depth | Type cement | Sacks | Type and percent additives |
|-------------------|-------------------|---------------------------|----------------|---------------|-------------|--------|----------------------------|
| Production | 7 7/8" | 4 1/2" | 10.5# | 3,506' | Common | 200 sx | 10% Salt |
| OLD INFO: | | | | | | | |
| Surface | 7 7/8" | 8 5/8" | 28# | 208 | not known | 140 | |

LINER RECORD

PERFORATION RECORD

| Top, ft. | Bottom, ft. | Sacks cement | Shots per ft. | Size & type | Depth interval |
|----------|-------------|--------------|---------------|-------------|----------------|
| ----- | ----- | ----- | none | | |

TUBING RECORD

| Size | Setting depth | Packer set at |
|------|---------------|---------------|
| | | |

ACID, FRACTURE, SHOT, CEMENT SQUEEZE RECORD

| Amount and kind of material used | Depth interval treated |
|----------------------------------|------------------------|
| none | |

RECEIVED

STATE CORPORATION COMMISSION
 JUL 22 1982

CONSERVATION DIVISION
 Wichita, Kansas

INITIAL PRODUCTION

| | |
|--|--|
| Date of first production <u>T/A</u> | Producing method (flowing, pumping, gas lift, etc.) <u>n/a</u> |
| RATE OF PRODUCTION PER 24 HOURS | Oil <u>n/a</u> bbls. Gas <u>n/a</u> MCF Water <u>n/a</u> bbls. Gas-oil ratio <u>n/a</u> CFPB |
| Disposition of gas (vented, used on lease or sold) <u>n/a</u> | Producing interval (s) <u>TA</u> |

INSTRUCTIONS: As provided in KCC Rule 82-2-125, within 90 days after completion of a well, one completed copy of this Drillers Log shall be transmitted to the State Geological Survey of Kansas, 4150 Monroe Street, Wichita, Kansas 67209. Copies of this form are available from the Conservation Division, State Corporation Commission, 245 No. Water, Wichita, Kansas 67202. Phone AC 316-522-2206. If confidential custody is desired, please note Rule 82-2-125. Drillers Logs will be on open file in the Oil and Gas Division, State Geological Survey of Kansas, Lawrence, Kansas 66044.

| | | |
|----------------------------------|------------------------|---|
| Operator Frontier Oil Company | | DESIGNATE TYPE OF COMP.: OIL, GAS, DRY HOLE, SWDW, ETC.: OWWO |
| Well No. 1 | Lease Name Ondrasek | Temporarily Abandoned |
| S 5 T 9S R 19W E W | | SE NE NE |

WELL LOG

Show all important zones of porosity and contents thereof; cored intervals, and all drill-stem tests, including depth interval tested, cushion used, time tool open, flowing and shut-in pressures, and recoveries.

SHOW GEOLOGICAL MARKERS, LOGS RUN, OR OTHER DESCRIPTIVE INFORMATION.

| FORMATION DESCRIPTION, CONTENTS, ETC. | TOP | BOTTOM | NAME | DEPTH |
|---|-----|--------------|---|--|
| Washdown RTD | 0 | 3507 3507 | OLD INFORMATION: Anhydrite Topeka Heebner Toronto Lansing BKC Conglomerate Arbuckle TD | 1455(+ 588 2993(- 950 3197(-1154 3218(-1175 3239(-1196 3440(-1397 3467(-1424 3475(-1432 3507(-1464 |
| <p align="right">ORIGINALLY DRILLED AS: PICKRELL DRUG. CO. #1 Ondrasek D&A 9-4-66</p> | | | | |

USE ADDITIONAL SHEETS, IF NECESSARY, TO COMPLETE WELL RECORD.

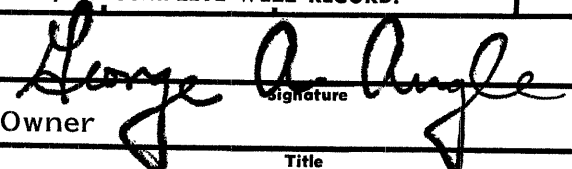
| | |
|---------------|---|
| Date Received |  Signature |
| | Owner |
| | Title |
| | 8-13-81 |
| | Date |