

ORIGINAL

SIDE ONE

STATE CORPORATION COMMISSION OF KANSAS  
OIL & GAS CONSERVATION DIVISION  
WELL COMPLETION FORM  
ACO-1 WELL HISTORY  
DESCRIPTION OF WELL AND LEASE

Operator: License # 30131

Name: Concord Oil Company, Inc./  
Lansing Energy  
Address 1119 Colorado Ave.

City/State/Zip Santa Monica, CA 90401

Purchaser: Clear Creek, Inc.

Operator Contact Person: Richard L. Cornett

Phone (316) -262-7595

Contractor: Name: Emphasis Oil Operations

License: 8241

Wellsite Geologist: Richard L. Cornett

Designate Type of Completion

New Well  Re-Entry  Workover

Oil  SWD  Temp. Abd.  
 Gas  Inj  Delayed Comp.  
 Dry  Other (Core, Water Supply, etc.)

If **OWMO**: old well info as follows:

Operator: \_\_\_\_\_

Well Name: \_\_\_\_\_

Comp. Date \_\_\_\_\_ Old Total Depth \_\_\_\_\_

Drilling Method:

Mud Rotary  Air Rotary  Cable

8/28/90 9/4/90 10-13-90

Spud Date Date Reached TD Completion Date

API NO. 15-163-23,103-60-00

County Rooks

S/2 S/2 NE SW Sec. 32 Twp. 9S Rge. 19  East  West

1485 Ft. North from Southeast Corner of Section

3300 Ft. West from Southeast Corner of Section  
(NOTE: Locate well in section plat below.)

Lease Name Lynd Well # 8

Field Name Lynd West

Producing Formation Arbuckle

Elevation: Ground 2210' KB 2215'

Total Depth 3800' PBTD \_\_\_\_\_

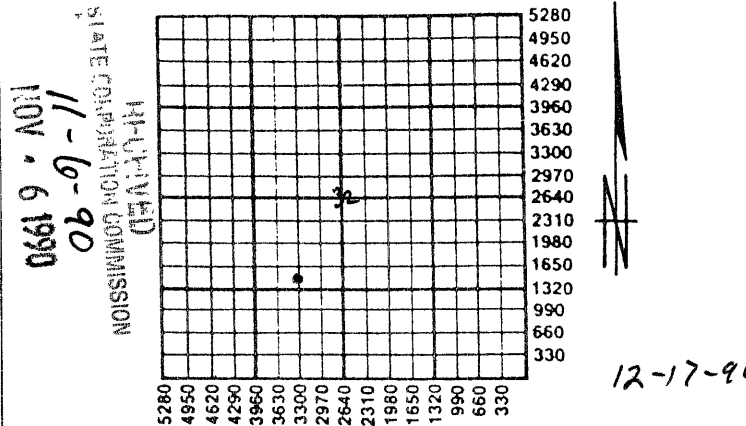

12-17-90

Amount of Surface Pipe Set and Cemented at 205 Feet

Multiple Stage Cementing Collar Used?  Yes  No

If yes, show depth set \_\_\_\_\_ Feet

If Alternate II completion, cement circulated from TD

feet depth to Surf. w/ 775 (total) sx cmt.

**INSTRUCTIONS:** This form shall be completed in triplicate and filed with the Kansas Corporation Commission, 200 Colorado Derby Building, Wichita, Kansas 67202, within 120 days of the spud date of any well. Rule 82-3-130, 82-3-107 and 82-3-106 apply. Information on side two of this form will be held confidential for a period of 12 months if requested in writing and submitted with the form. See rule 82-3-107 for confidentiality in excess of 12 months. **One copy of all wireline logs and drillers time log shall be attached with this form. ALL CEMENTING TICKETS MUST BE ATTACHED.** Submit CP-4 form with all plugged wells. Submit CP-111 form with all temporarily abandoned wells. Any recompletion, workover or conversion of a well requires filing of ACO-2 within 120 days from commencement date of such work.

All requirements of the statutes, rules and regulations promulgated to regulate the oil and gas industry have been fully complied with and the statements herein are complete and correct to the best of my knowledge.

Signature Richard L. Cornett

Title Agent for Concord Date 10-30-90

Subscribed and sworn to before me this 13<sup>th</sup> day of November, 1990

Notary Public Darlene J. Starr

Date Commission Expires 10-1-93

K.C.C. OFFICE USE ONLY

F  Letter of Confidentiality Attached  
C  Wireline Log Received  
C  Drillers Timelog Received

Distribution

KCC  SWD/Rep  NGPA  
 KGS  Plug  Other  
(Specify)

**SIDE TWO**

Operator Name Concord Oil Company, Inc./ Lease Name Lynd Well # 8  
 Lansing Energy  East County Rooks  
 Sec. 32 Twp. 9S Rge. 19W  West

**INSTRUCTIONS:** Show important tops and base of formations penetrated. Detail all cores. Report all drill stem tests giving interval tested, time tool open and closed, flowing and shut-in pressures, whether shut-in pressure reached static level, hydrostatic pressures, bottom hole temperature, fluid recovery, and flow rates if gas to surface during test. Attach extra sheet if more space is needed. Attach copy of log.

Drill Stem Tests Taken (Attach Additional Sheets.) <input checked="" type="checkbox"/> Yes <input type="checkbox"/> No Samples Sent to Geological Survey <input type="checkbox"/> Yes <input checked="" type="checkbox"/> No Cores Taken <input type="checkbox"/> Yes <input checked="" type="checkbox"/> No Electric Log Run (Submit Copy.) <input checked="" type="checkbox"/> Yes <input type="checkbox"/> No	<table border="1" style="width:100%; border-collapse: collapse;"> <tr> <th colspan="3" style="text-align: center;">Formation Description</th> </tr> <tr> <td></td> <td style="text-align: center;"><input checked="" type="checkbox"/> Log</td> <td style="text-align: center;"><input type="checkbox"/> Sample</td> </tr> <tr> <th style="text-align: left;">Name</th> <th style="text-align: center;">Top</th> <th style="text-align: center;">Bottom</th> </tr> <tr> <td>Heebner</td> <td style="text-align: center;">-1182</td> <td></td> </tr> <tr> <td>Lansing</td> <td style="text-align: center;">-1222</td> <td></td> </tr> <tr> <td>B/KC</td> <td style="text-align: center;">-1432</td> <td></td> </tr> <tr> <td>Arbuckle</td> <td style="text-align: center;">-1526</td> <td></td> </tr> <tr> <td>RTD</td> <td style="text-align: center;">-1586</td> <td></td> </tr> </table>	Formation Description				<input checked="" type="checkbox"/> Log	<input type="checkbox"/> Sample	Name	Top	Bottom	Heebner	-1182		Lansing	-1222		B/KC	-1432		Arbuckle	-1526		RTD	-1586	
Formation Description																									
	<input checked="" type="checkbox"/> Log	<input type="checkbox"/> Sample																							
Name	Top	Bottom																							
Heebner	-1182																								
Lansing	-1222																								
B/KC	-1432																								
Arbuckle	-1526																								
RTD	-1586																								

CASING RECORD <input type="checkbox"/> New <input checked="" type="checkbox"/> Used							
Report all strings set-conductor, surface, intermediate, production, etc.							
Purpose of String	Size Hole Drilled	Size Casing Set (In O.D.)	Weight Lbs./Ft.	Setting Depth	Type of Cement	# Sacks Used	Type and Percent Additives
205	12 1/4	8 5/8	28#	205	60/40 poz	135	2% gel, 3% cl
3798	7 7/8	5 1/2	14#	3798	60/40 poz	375	10% gel
					60/40 poz	150	10% NaCl, 5% ge
					65/35 poz	250	6% gel, 1% sk flo seal.
PERFORATION RECORD				Acid, Fracture, Shot, Cement Squeeze Record (Amount and Kind of Material Used) Depth			
Shots Per Foot	Specify Footage of Each Interval Perforated						
4	3772-3775			none			
4	3766-3769			none			
TUBING RECORD							
Size	Set At	Packer At	Liner Run <input type="checkbox"/> Yes <input checked="" type="checkbox"/> No				
2 7/8	3068'	none					
Date of First Production	Producing Method <input type="checkbox"/> Flowing <input checked="" type="checkbox"/> Pumping <input type="checkbox"/> Gas Lift <input type="checkbox"/> Other (Explain)						
10-13-90							
Estimated Production Per 24 Hours	Oil Bbls.	Gas Mcf	Water Bbls.	Gas-Oil Ratio	Gravity		
	22	-0-	520		25°		

Disposition of Gas:  Vented  Sold  Used on Lease (If vented, submit ACO-18.)

**METHOD OF COMPLETION**

Open Hole  Perforation  Dually Completed  Commingled

Other (Specify) \_\_\_\_\_

Production Interval \_\_\_\_\_

ORIGINAL

DRILL STEM TESTS							
No	Interval	IFP/Time	ISIP/Time	FFP/Time	FSIP/Time	IHM - FHM	RECOVERY
1	3500-3523	85-228/30"	806/30"	240-371/30"	795/60"	1985-1772	180' SSYOCW (40% d, 10% o, 50% w) 360' Vol 40% W (10% d, 25% o, 65% w) 270' SOCW (57% o, 95% w)
2	3550-3580						HIT BRIDGE - MURKIN
3	3550-3580	48-60/30"	947/60"	72-133/30"	947/60"	1926-1772	60' GHP, 228' 50% WCM (50% G, 5% o, 20% w, 25% m) 62' 4% W/Sl OCW m I 10% d, 57% o, 35% w, 50% m)
4	358-3635	24-24/30"	466/60"	24-24/30"	399/60"	1902-1748	10' 0.50 m.
5	3734-3741	12-24/30"	300/60"	12-24/30"	111/60"	2033-1748	10' 0.50 m.
6	3737-3745	120-371/30"	759/60"	918-501/30"	759/60"	2045-1831	248' CWOL, 186' SL WCO (90% o, 10% w) 186' WCO (75% o, 25% w), 248' HWCO (65% o, 35% w), 10' m (10% o) 62' OCW (25% o, 75% w) 248' SOCW (57% o, 95% w)

RECEIVED  
NATE COMMISSION COMMISSION

NOV 6 1990

CONSERVATION DIVISION  
Wichita, Kansas

*Dennis Anderson*

ORIGINAL

*Marion*

SEP 10 RECD

*\* Dennis*

DENNIS,

THE TEMP SURVEY SHOWS CMT.  $\approx$  400' FROM SURF. ALLIED IS GOING TO SQUEEZE AND IS TO CALL YOUR OFFICE BEFORE COMMENCING. CALL IF QUESTIONS.

SINCERELY,

RICK CORNETT  
316-262-7595

TEMPERATURE SURVEY

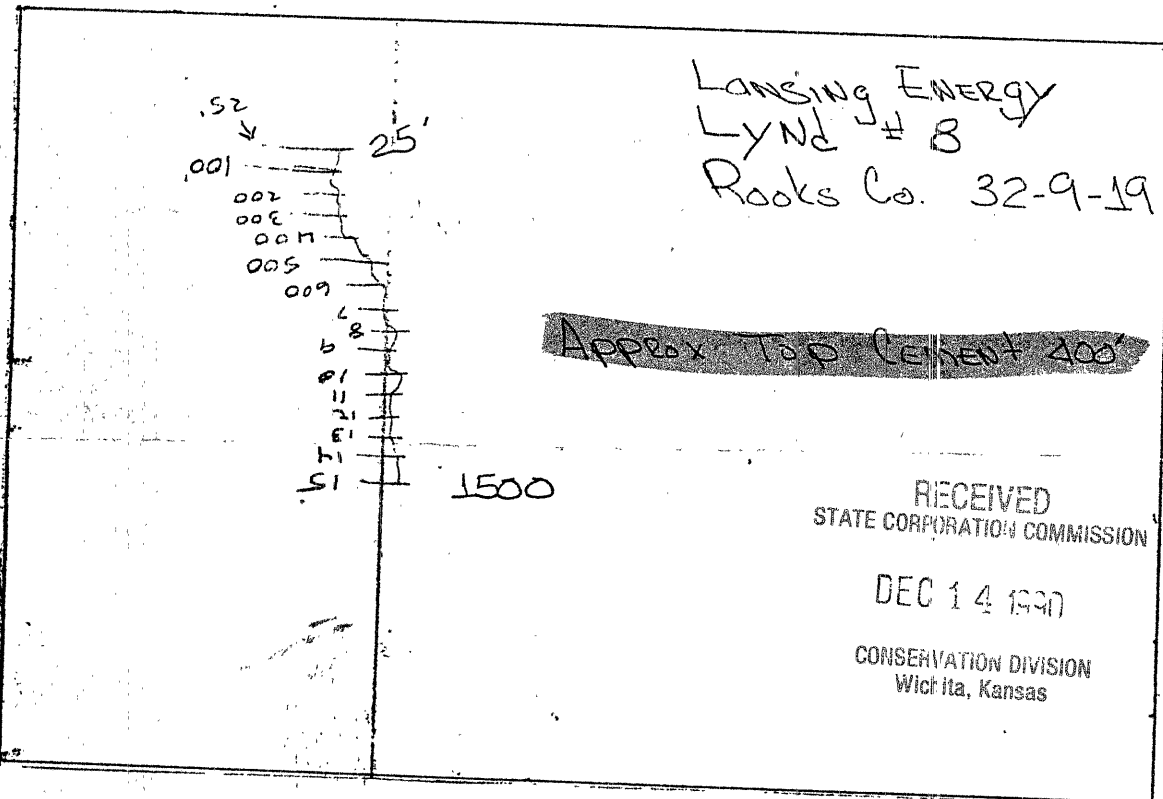

KCC

SEP 11 1990

WICHITA, KS

ORIGINAL

EMPHASIS OIL OPERATIONS

P. O. BOX 506  
RUSSELL, KS 67665

DRILLERS LOG

OPERATOR: Concord Oil Company, Inc./Lansing Energy 1119 Colorado Ave. Santa Monica, CA 90401  
CONTRACTOR: Emphasis Oil Operations Box 506 Russell, KS 67665

LEASE: Lynd WELL #8 LOCATION: S/2 S/2 NE SW Section 32-9S-19W Rooks County, Kansas

LOGGERS TOTAL DEPTH: 3800'  
ROTARY TOTAL DEPTH: 3800'  
COMMENCED: 8/28/90  
CASING: 8-5/8" @ 205' w/135 sks cement  
5-1/2" @ 3798' w/350 sks ATH cement  
w/150 sks Common  
ELEVATION: 2215' K.B.  
COMPLETED: 9/4/90  
STATUS: Oil Well

RECEIVED  
STATE CORPORATION COMMISSION

NOV • 6 1990

CONSERVATION DIVISION  
Wichita, Kansas

DEPTHS & FORMATIONS

(All measurements from K.B.)

Dakota Sand	873'	Toronto	3416'
Red Bed	913'	Lansing-Kansas City	3436'
Cedar Hills	1105'	Base Kansas City	3646'
Red Bed	1363'	Arbuckle	3740'
Anhydrite	1633'	R.T.D.	3800'
Heebner	3396'		

STATE OF KANSAS )  
                          ) ss  
COUNTY OF RUSSELL)

Kyle B. Branum, of Emphasis Oil Operations, states that the above and foregoing is a true and correct log of the above captioned well, to the best of his knowledge.

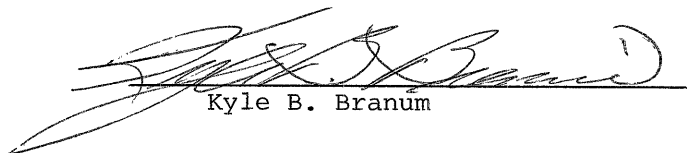
  
Kyle B. Branum

Subscribed and sworn to before me on September 5, 1990.

My commission expires: February 6, 1992.

GLEND A. R. TIFFIN  
NOTARY PUBLIC  
STATE OF KANSAS  
MY APPT. EXPIRES 2-6-92

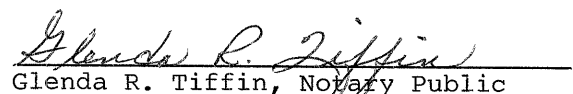
  
Glenda R. Tiffin, Notary Public

15-163-23163-00-00

Phone 913-483-2627, Russell, Kansas  
 Phone 316-793-5861, Great Bend, Kansas

ORIGINAL

Phone Plainville 913-434-2812  
 Phone Ness City 913-798-3843

*new*

**ALLIED CEMENTING CO., INC. N<sup>o</sup> 8952**  
 Home Office P. O. Box 31      Russell, Kansas 67665

Date	9-4-90	Sec.	32	Twp.	9	Range	19	Called Out		On Location	1:15 PM	Job Start		Finish	4:30 PM
Lease	Lynd	Well No.	8	Location	Zurich	County	10-15-84-15	Rooks		State	Kan				

Contractor	Emphasis Oil Oper	
Type Job	Prod String	
Hole Size	7 7/8	T.D. 3800'
Csg.	5 1/2	Depth 3799'
Tbg. Size		Depth
Drill Pipe		Depth
Tool		Depth
Cement Left in Csg.	15'	Shoe Joint
Press Max.		Minimum
Meas Line	✓	Displace
Perf.		

**Owner**  
 To Allied Cementing Co., Inc.  
 You are hereby requested to rent cementing equipment and furnish cementer and helper to assist owner or contractor to do work as listed.

**Charge To** Concord Oil Co / Lansing Energy  
**Street** 1119 Colorado Ave  
**City** Santa Monica **State** Ca **90401**  
 The above was done to satisfaction and supervision of owner agent or contractor.

**Purchase Order No.**  
 X Jack D. Fox

**Amount Ordered** 375 <sup>60/40 per 10% salt</sup> CEMENT  
 150 <sup>60/40 per 10% salt, 5% G.I</sup>

**Consisting of**

Common	315	SKs 2	5.00	1,575.00
Poz. Mix	210	SKs 2	2.25	472.80
Gel.	31	SKs 2	6.75	209.25
Galvanize	Salt - 12	SKs 2	4.75	57.00
Quicker	61	637 lbs 2	2.94	184.25

**EQUIPMENT**

Pumptrk	No. 153	Cementer	Walt D.
		Helper	Dave F.
Pumptrk	No.	Cementer	
		Helper	
Bulktrk	146	Driver	Ed K.
Bulktrk	156	Driver	Mark D.

Handling	90¢ per sk	472.50
Mileage	3¢ per sk mile	157.50
10 miles		
Sub Total		3128.48
Total		3128.48

**DEPTH of Job**

Reference:	Pump truck	838.00
	5 1/2 Plus	35.00
	2.00 per mile	20.00
	Sub Total	
	Tax	
	Total	893.00

**Floating Equipment** 5 1/2

1- Guide Shoe	- 119.00
1- AFU insert	- 180.00
2- Baskets	- 242.00
5- Centralizers	- 220.00
	761.00
- 20% Disc	152.20

**Remarks:** Pd by ck #1720  
 Pumptruck - 893  
 Material - 3128.48  
 Ft Equip - 761.00  
 - 20% Disc = 956.48

RECEIVED  
 STATE OF KANSAS COMMISSION

DEC 5 1990

REGISTRATION DIVISION

15-163-27103-0000

Russell, Kansas  
793-5861, Great Bend, Kansas

Phone Plainville 913-434-2812  
Phone Ness City 913-798-3843

New ORIGINAL

# ALLIED CEMENTING CO., INC. N<sup>o</sup> 9026

Home Office P. O. Box 31      Russell, Kansas 67665

Date	9-26-90	Sec.	32	Twp.	9 <sup>s</sup>	Range	19 <sup>w</sup>	Called Out	7:00 A.M.	On Location	9:30 A.M.	Job Start	9:45 A.M.	Finish	10:30 A.M.	
Lease	Lynd	Well No.	8	Location				Zurich 15 1/2 W 1/4 N	County	Rooks	State	Ks				

Contractor		Owner	
Type Job		Back Side Squeeze	
Hole Size	7 7/8"	I.D.	
Csg.	5 1/2"	Depth	
Csg. Size	8 5/8"	Depth	205'
Drill Pipe		Depth	
Tool		Depth	
Cement Left in Csg.		Shoe Joint	
Press Max.	500#	Minimum	
Meas Line		Displace	
Perf.			

Owner Same

To Allied Cementing Co., Inc.  
You are hereby requested to rent cementing equipment and furnish cementer and helper to assist owner or contractor to do work as listed.

Charge To Lansing Energy Corporation  
Street 1115 Biking Bldg., 107 N. Market  
City Wichita State Ks. 67202

The above was done to satisfaction and supervision of owner agent or contractor.

Purchase Order No.

### EQUIPMENT

No.	Cementer	Gary H. Wayne Mc.
Pumptrk 191	Helper	
No.	Cementer	Glen C.
Pumptrk	Helper	
	Driver	
Bulktrk #212	Driver	

CEMENT	
Amount Ordered	250 sks @ 65/35 per 60 gal with
Consisting of	1/4 # Floseal 1 sk. & 3 sks hulk
Common	163 sks @ 5.00/sk. \$815.00
Poz. Mix	87 sks @ 2.25/sk. 195.75
Gel.	9 sks @ 6.75/sk. 60.75
Chloride	
Quickset Floseal-63# @ 60#/16.	37.80
Hulks- 3 sks @ 14.00/sk.	42.00
Sales Tax	
Handling @ 90#/sk. (250 sks)	225.00
Mileage @ 0.34/sk./mi. (10 mi.)	75.00
Sub Total	\$1451.30
Total	

DEPTH of Job	
Reference:	# 5 Pumptruck-squeeze \$360.00
	# 14 mileage @ 2.00/mi. 20.00
Sub Total	\$380.00
Tax	
Total	

Remarks: Down annulus (8 7/8" csg.) at 500# max. pressure, mixed 3 sks hulks with 250 sks cement, and shut in at 200#.

Floating Equipment

Thanks

RECEIVED  
STATE COMMISSION  
DEC 5 1990  
WICHITA