



For KCC Use: 5-907  
 Effective Date: \_\_\_\_\_  
 District # 1  
 SGA?  Yes  No

KANSAS CORPORATION COMMISSION 1008922  
 OIL & GAS CONSERVATION DIVISION

Form C-1  
 November 2005  
**Form must be Typed**  
**Form must be Signed**  
**All blanks must be Filled**

**NOTICE OF INTENT TO DRILL**

Must be approved by KCC five (5) days prior to commencing well

Expected Spud Date: 05/04/2007  
 month day year

Spot Description: SE NW NW NE  
 SE - NW - NW - NE Sec. 9 Twp. 28 S. R. 36  E  W  
 (200/200) 536 feet from  N /  S Line of Section  
2,161 feet from  E /  W Line of Section

OPERATOR: License# 5278  
 Name: EOG Resources, Inc.  
 Address 1: 3817 NW Expressway, Suite 500  
 Address 2: \_\_\_\_\_  
 City: Oklahoma City State: OK Zip: 73112 + 1483  
 Contact Person: MINDY BLACK  
 Phone: 405-246-3100

Is SECTION:  Regular  Irregular?  
 (Note: Locate well on the Section Plat on reverse side)  
 County: Grant  
 Lease Name: TATE Well #: 9 #1  
 Field Name: Wildcat

CONTRACTOR: License# 30684  
 Name: Abercrombie Rtd, Inc

Is this a Prorated / Spaced Field?  Yes  No  
 Target Formation(s): MORROW

Well Drilled For:  Oil  Gas  Seismic; # of Holes \_\_\_\_\_  
 Enh Rec  Storage  Disposal  Other: \_\_\_\_\_  
 Well Class:  Infield  Pool Ext.  Wildcat  Other: \_\_\_\_\_  
 Type Equipment:  Mud Rotary  Air Rotary  Cable  
 If OWWO: old well information as follows: \_\_\_\_\_

Nearest Lease or unit boundary line (in footage): 536  
 Ground Surface Elevation: 3103 feet MSL  
 Water well within one-quarter mile:  Yes  No  
 Public water supply well within one mile:  Yes  No  
 Depth to bottom of fresh water: 420  
 Depth to bottom of usable water: 750  
 Surface Pipe by Alternate:  I  II  
 Length of Surface Pipe Planned to be set: 1700  
 Length of Conductor Pipe (if any): 40  
 Projected Total Depth: 5800  
 Formation at Total Depth: ST. LOUIS

Operator: \_\_\_\_\_  
 Well Name: \_\_\_\_\_  
 Original Completion Date: \_\_\_\_\_ Original Total Depth: \_\_\_\_\_

Water Source for Drilling Operations:  
 Well  Farm Pond  Other: \_\_\_\_\_  
 DWR Permit #: \_\_\_\_\_ (Note: Apply for Permit with DWR)

Directional, Deviated or Horizontal wellbore?  Yes  No  
 If Yes, true vertical depth: \_\_\_\_\_  
 Bottom Hole Location: \_\_\_\_\_  
 KCC DKT #: PVPA 040703

Will Cores be taken?  Yes  No  
 If Yes, proposed zone: \_\_\_\_\_

**PRORATED & SPACED: HUGOTON & PANOMA**

**AFFIDAVIT**

The undersigned hereby affirms that the drilling, completion and eventual plugging of this well will comply with K.S.A. 55 et. seq.  
 It is agreed that the following minimum requirements will be met:

RECEIVED  
 KANSAS CORPORATION COMMISSION  
 APR 20 2007  
 CONSERVATION DIVISION  
 WICHITA, KS

1. Notify the appropriate district office **prior** to spudding of well;
2. A copy of the approved notice of intent to drill **shall be** posted on each drilling rig;
3. The minimum amount of surface pipe as specified below **shall be set** by circulating cement to the top; in all cases surface pipe **shall be set** through all unconsolidated materials plus a minimum of 20 feet into the underlying formation.
4. If the well is dry hole, an agreement between the operator and the district office on plug length and placement is necessary **prior to plugging**;
5. The appropriate district office will be notified before well is either plugged or production casing is cemented in;
6. If an ALTERNATE II COMPLETION, production pipe shall be cemented from below any usable water to surface within **120 DAYS** of spud date. Or pursuant to Appendix "B" - Eastern Kansas surface casing order #133,891-C, which applies to the KCC District 3 area, alternate II cementing must be completed within 30 days of the spud date or the well shall be plugged. **In all cases, NOTIFY district office** prior to any cementing.

I hereby certify that the statements made herein are true and to the best of my knowledge and belief.

Date: 4-18-07 Signature of Operator or Agent: Mindy Black Title: Operations Assistant

**For KCC Use ONLY**  
 API # 15 - 067-21643-0000  
 Conductor pipe required 0 feet  
 Minimum surface pipe required 770 feet per ALT.  I  II  
 Approved by: KWH 5-4-07  
 This authorization expires: 11-4-07  
 (This authorization void if drilling not started within 6 months of approval date.)  
 Spud date: \_\_\_\_\_ Agent: \_\_\_\_\_

**Remember to:**  
 - File Drill Pit Application (form CDP-1) with Intent to Drill;  
 - File Completion Form ACO-1 within 120 days of spud date;  
 - File acreage attribution plat according to field proration orders;  
 - Notify appropriate district office 48 hours prior to workover or re-entry;  
 - Submit plugging report (CP-4) after plugging is completed (within 60 days);  
 - Obtain written approval before disposing or injecting salt water.  
 - If this permit has expired (See: authorized expiration date) please check the box below and return to the address below.  
 Well Not Drilled - Permit Expired Date: \_\_\_\_\_  
 Signature of Operator or Agent: \_\_\_\_\_



1008922

**IN ALL CASES PLOT THE INTENDED WELL ON THE PLAT BELOW**

*Plat of acreage attributable to a well in a prorated or spaced field*

**If the intended well is in a prorated or spaced field, please fully complete this side of the form.** If the intended well is in a prorated or spaced field complete the plat below showing that the well will be properly located in relationship to other wells producing from the common source of supply. Please show all the wells and within 1 mile of the boundaries of the proposed acreage attribution unit for gas wells and within 1/2 mile of the boundaries of the proposed acreage attribution unit for oil wells.

API No. 15 - 067-21643-0000  
Operator: EOG Resources, Inc.  
Lease: TATE  
Well Number: 9 #1  
Field: Wildcat

Location of Well: County: Grant  
536 feet from  N /  S Line of Section  
2,161 feet from  E /  W Line of Section  
Sec. 9 Twp. 28 S. R. 36  E  W

Number of Acres attributable to well: \_\_\_\_\_  
QTR/QTR/QTR/QTR of acreage: SE - NW - NW - NE

Is Section:  Regular or  Irregular

**If Section is irregular, locate well from nearest corner boundary.**  
Section corner used:  NE  NW  SE  SW

**PLAT**

*(Show location of the well and shade attributable acreage for prorated or spaced wells.)  
(Show footage to the nearest lease or unit boundary line.)*

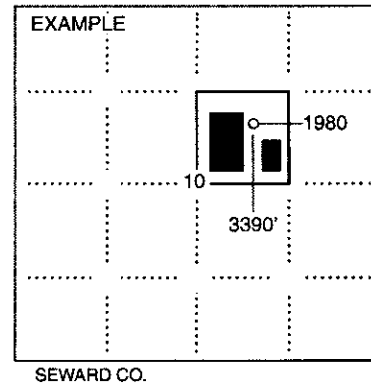
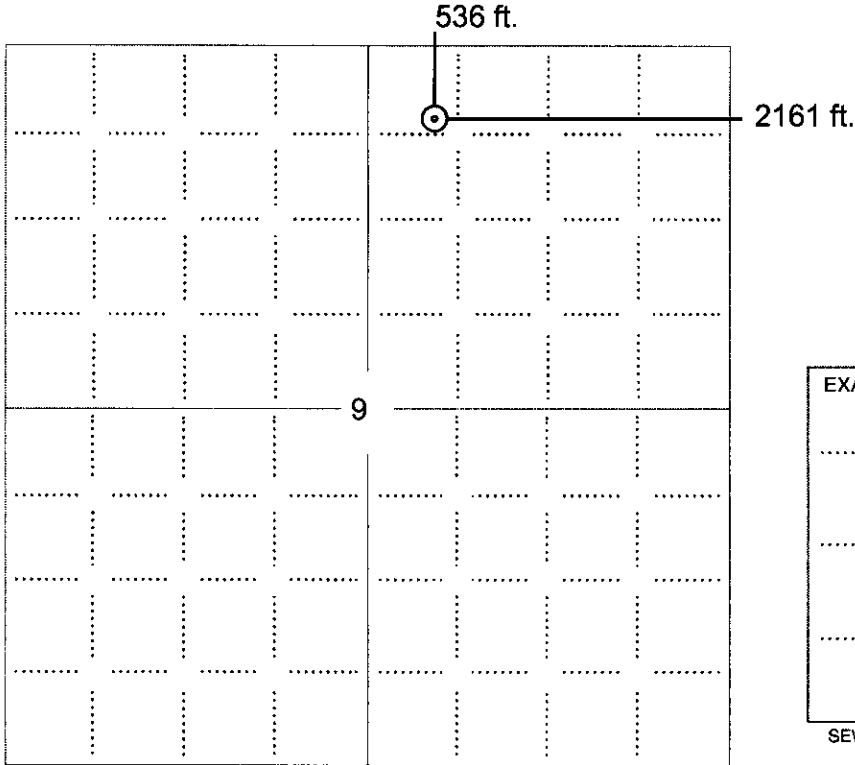

**NOTE: In all cases locate the spot of the proposed drilling location.**

**RECEIVED**  
KANSAS CORPORATION COMMISSION

**APR 20 2007**

CONSERVATION DIVISION  
WICHITA, KS

**In plotting the proposed location of the well, you must show:**

1. The manner in which you are using the depicted plat by identifying section lines, i.e. 1 section, 1 section with 8 surrounding sections, 4 sections, etc.
2. The distance of the proposed drilling location from the south / north and east / west outside section lines.
3. The distance to the nearest lease or unit boundary line (in footage).
4. If proposed location is located within a prorated or spaced field a certificate of acreage attribution plat must be attached: (CO-7 for oil wells; CG-8 for gas wells).



KANSAS CORPORATION COMMISSION 1008922  
OIL & GAS CONSERVATION DIVISION

Form GDP-1  
April 2004  
Form must be Typed

**APPLICATION FOR SURFACE PIT**

Submit in Duplicate

Operator Name: <b>EOG Resources, Inc.</b>		License Number: <b>5278</b>	
Operator Address: <b>3817 NW Expressway, Suite 500</b>		Oklahoma City OK 73112	
Contact Person: <b>MINDY BLACK</b>		Phone Number: <b>405-246-3100</b>	
Lease Name & Well No.: <b>TATE 9 #1</b>		Pit Location (QQQQ): <b>SE NW NW NE</b>	
Type of Pit: <input type="checkbox"/> Emergency Pit <input type="checkbox"/> Burn Pit <input type="checkbox"/> Settling Pit <input checked="" type="checkbox"/> Drilling Pit <input type="checkbox"/> Workover Pit <input type="checkbox"/> Haul-Off Pit <small>(If WP Supply API No. or Year Drilled)</small>	Pit is: <input checked="" type="checkbox"/> Proposed <input type="checkbox"/> Existing If Existing, date constructed: _____ Pit capacity: <b>12,500</b> (bbls)	Sec. <b>9</b> Twp. <b>28</b> R. <b>36</b> <input type="checkbox"/> East <input checked="" type="checkbox"/> West <b>536</b> Feet from <input checked="" type="checkbox"/> North / <input type="checkbox"/> South Line of Section <b>2,161</b> Feet from <input checked="" type="checkbox"/> East / <input type="checkbox"/> West Line of Section Grant _____ County	
Is the pit located in a Sensitive Ground Water Area? <input type="checkbox"/> Yes <input checked="" type="checkbox"/> No		Chloride concentration: _____ mg/l <small>(For Emergency Pits and Settling Pits only)</small>	
Is the bottom below ground level? <input checked="" type="checkbox"/> Yes <input type="checkbox"/> No	Artificial Liner? <input type="checkbox"/> Yes <input checked="" type="checkbox"/> No	How is the pit lined if a plastic liner is not used? <b>SOIL COMPACTION</b>	
Pit dimensions (all but working pits): <b>125</b> Length (feet) <b>125</b> Width (feet) <input type="checkbox"/> N/A: Steel Pits Depth from ground level to deepest point: <b>5</b> (feet) <input type="checkbox"/> No Pit			
If the pit is lined give a brief description of the liner material, thickness and installation procedure.		Describe procedures for periodic maintenance and determining liner integrity, including any special monitoring.	
Distance to nearest water well within one-mile of pit <b>881</b> feet    Depth of water well <b>340</b> feet		Depth to shallowest fresh water <b>262</b> feet. Source of information: <input type="checkbox"/> measured <input type="checkbox"/> well owner <input type="checkbox"/> electric log <input checked="" type="checkbox"/> KDWR	
<b>Emergency, Settling and Burn Pits ONLY:</b> Producing Formation: _____ Number of producing wells on lease: _____ Barrels of fluid produced daily: _____ Does the slope from the tank battery allow all spilled fluids to flow into the pit? <input type="checkbox"/> Yes <input type="checkbox"/> No		<b>Drilling, Workover and Haul-Off Pits ONLY:</b> Type of material utilized in drilling/workover: <b>GEL</b> Number of working pits to be utilized: <b>0</b> Abandonment procedure: <b>EVAPORATION/DEWATER AND BACKFILLING OF RESERVE PIT.</b> Drill pits must be closed within 365 days of spud date.	
I hereby certify that the above statements are true and correct to the best of my knowledge and belief.		<b>RECEIVED</b> KANSAS CORPORATION COMMISSION	
<b>4-19-07</b> Date		<b>Mindy Black</b> Signature of Applicant or Agent	
		<b>APR 20 2007</b> CONSERVATION DIVISION WICHITA, KS	
<b>KCC OFFICE USE ONLY</b>			
Date Received: <b>4/20/07</b> Permit Number: _____		Permit Date: <b>4/20/07</b> Lease Inspection: <input type="checkbox"/> Yes <input checked="" type="checkbox"/> No	

15-067-21643-0000

KANSAS CORPORATION COMMISSION  
 CONSERVATION DIVISION  
 130 S. Market - Room 2078  
 Wichita, Kansas 67202

Form VPA-1  
 4/01

PVPA 040703

VERIFIED AFFIDAVIT FOR USE OF MUD AS AN  
 ALTERNATIVE TO THE CEMENTING REQUIREMENT IN ¶18(D)  
 OF THE PANOMA COUNCIL GROVE B.P.O.

FORM MUST BE TYPED

Submit in Duplicate  
 Attach to Drilling Permit

Operator Name EOG Resources, Inc.				KCC License No. 5278	
Operator Address 3817 NW Expressway Suite #500 Oklahoma City, OK 73112					
Contact Person MINDY BLACK				Telephone No. (405) 246-3130	
Lease Name & No. TATE 9 #1		API No. 15-067-21643-0000		KCC Lease Code No.	
Location Quarter NE	Section 9	Township 28S	Range 36	536' E / W (circle one) 2161'	FL from N / S (circle one) Line of Sec. FL from E / W (circle one) Line of Sec.
County GRANT	Field Name UNASSIGNED	Producing Formation Group MORROW		Mud Weight 8.7	

**AFFIDAVIT CERTIFICATE OF SERVICE**

All requirements of the statutes, rules and regulations promulgated to regulate the oil and gas industry have been fully complied with and the statements here are complete and correct to the best of my knowledge. The well subscribed to in this Affidavit will be completed in accordance with all applicable rules and regulations of the KCC. However, applicant intends to use drilling mud of sufficient weight across the interval between the base of the Council Grove Group and the top of the Chase Group as an alternative to the cementing requirements found in paragraph 18(D) of the Panoma Council Grove B.P.O. unless an objection is filed within 15 days of service of this Affidavit. I hereby certify that I caused a true and correct copy of the foregoing Affidavit and any attachments of said Affidavit to be served by placing the same in the United States mail, postage prepaid, to the following parties, which represent all of the operators or lessees of record and the owners of record of unleased acreage within a one mile radius of the well, including operators and working interest owners having interests in the lands covered by the unit on which the well is to be drilled:

RECEIVED  
 KANSAS CORPORATION COMMISSION

APR 20 2007

Signature Mindy Black Date 4/19/07

Title OPERATIONS ASSISTANT

CONSERVATION DIVISION  
 WICHITA, KS

Subscribed and sworn to before me this 19th day of April, 2007.

Notary Public Sheila R. Rogers

Date Commission Expires 07-01-09

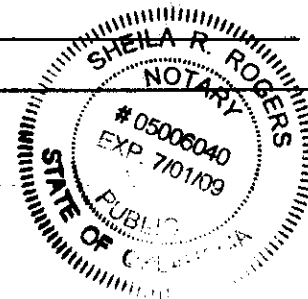

15-067-21643-0000

**Exhibit "A"**  
**Tate 9 #1**  
**Section 9-28S-36W**  
**Grant County, Kansas**  
**Page 1 of 1**

PVPA 040703

1. ExxonMobil Production Company  
P.O. Box 4610  
Houston, TX 77210-4610
  
2. OXY USA, Inc.  
P.O. Box 27570  
Houston, TX 77227-7570

**End of Exhibit "A"**

RECEIVED  
KANSAS CORPORATION COMMISSION

APR 20 2007

CONSERVATION DIVISION  
WICHITA, KS

May 4, 2007

Mindy Black  
EOG Resources, Inc.  
3817 NW Expressway, Suite 500  
Oklahoma City, OK 73112

Re: Tate 9 #1 API #15-064-21643-0000  
Docket # PVPA 040703  
NE Sec.9-T28S-R36W  
Grant County, Kansas

Dear Ms. Black,

The form VPA-1 affidavit filed for the above-referenced well stated that service of the affidavit was mailed on April 19, 2007. The fifteen (15) day protest period has expired and we have not received any protests. Therefore, we are advising you that the drilling of this well may commence and, in lieu of cement, drilling mud of the weight specified in your affidavit may be used across the interval between the base of the Council Grove group and the top of the Chase group.

Sincerely,



Rick Hestermann  
Production Department

**NOTICE TO OPERATORS DRILLING IN THE PANOMA-  
COUNCIL GROVE GAS POOL SPACED AREA**

The enclosed intent is located within the Panoma-Council Grove gas pool space area. In May 1978, Panoma-Council Grove Proration Order (as amended), Docket No. 60,024-C (C-7058) under FINDINGS OF FACT AND LAW on page 31, the following language is stated that:

"The Commission finds that in order to prevent waste and protect correlative rights, the following stated rules pertaining to wells already completed, in the process of being drilled or for future wells to be drilled in the Panoma Council Grove Gas Pool Spaced area, and for wells producing from the Council Grove Formation outside of the Panoma Council Grove Gas Pool Spaced area within the Hugoton Gas Field, should be adopted."

1. "No dual completions between the Chase (Hugoton) and Council Grove Formations will be permitted for future wells drilled."
2. "Casing shall not be set above the top of the Council Grove Formation for a Council Grove producing well."
3. "The production casing of all new Council Grove wells should be cemented with a calculated volume of cement sufficient to encase the casing from the bottom of the casing to a point 500 feet above the Chase Formation."
4. "The casing shall be encased in cement in the interval between the base of the Council Grove and the top of the Chase Formation on all wells, irrespective of depth, completed below the Council Grove Formation, if they are located within the space area."
5. "The cement coverage heretofore required shall be confirmed by the running of a recognized survey, such as a temperature survey or cement bond log."

A copy of this survey and the cement tickets(s) showing that all cement work has been completed, must be filed with the ACO-1 Completion Report within 120 days from the wells "spud date."

Failure to comply with these provisions may cause the well to be shut-in until compliance has been achieved.

If you have any questions, please feel free to contact the Conservation Division's Production Department at (316) 337-6200.