

OWWO

For KCC Use: 5-14-07  
Effective Date: \_\_\_\_\_  
District # 2  
SGA? ☐ Yes ☒ No

KANSAS CORPORATION COMMISSION  
OIL & GAS CONSERVATION DIVISION

NOTICE OF INTENT TO DRILL

Must be approved by KCC five (5) days prior to commencing well

Form C-1  
December 2002  
Form must be Typed  
Form must be Signed  
All blanks must be Filled

Expected Spud Date May 10 2007  
month day year

OPERATOR: License# 5030  
Name: Vess Oil Corporation  
Address: 1700 Waterfront Parkway, Bldg. 500  
City/State/Zip: Wichita, KS 67206  
Contact Person: Casey Coats  
Phone: 316-682-1537 X104

CONTRACTOR: License# 32991  
Name: Simmons Well Service, Inc.

Well Drilled For: ☒ Oil ☐ Gas ☐ OWO ☐ Seismic; ☐ Other  
Well Class: ☒ Enh Rec ☐ Storage ☐ Disposal ☐ # of Holes ☐ Other  
Type Equipment: ☒ Infield ☐ Pool Ext. ☐ Wildcat ☐ Other  
☒ Mud Rotary ☐ Air Rotary ☐ Cable  
Pulling unit, mud pump and power swivel

If OWWO: old well information as follows:  
Operator: Cities Service  
Well Name: Wilson A #199  
Original Completion Date: 6/8/41 Original Total Depth: 2012'

Directional, Deviated or Horizontal wellbore? ☐ Yes ☒ No  
If Yes, true vertical depth: \_\_\_\_\_  
Bottom Hole Location: \_\_\_\_\_  
KCC DKT #: \_\_\_\_\_

Spot SW NE Sec. 8 Twp. 25S S. R. 05E ☒ East ☐ West  
2363 feet from ☒ N / ☐ S Line of Section  
2257' feet from ☒ E / ☐ W Line of Section

Is SECTION ☒ Regular ☐ Irregular?

(Note: Locate well on the Section Plat on reverse side)

County: Butler  
Lease Name: Wilson A Well #: 199 OWWO  
Field Name: El Dorado

Is this a Prorated / Spaced Field? ☐ Yes ☒ No

Target Information(s): Douglas, Oread and White Cloud

Nearest Lease or unit boundary: 2257'

Ground Surface Elevation: 1392' feet MSL

Water well within one-quarter mile: ☐ Yes ☒ No

Public water supply well within one mile: ☐ Yes ☒ No

Depth to bottom of fresh water: 160'

Depth to bottom of usable water: 180'

Surface Pipe by Alternate: ☒ 1 ☒ 2

Length of Surface Pipe Planned to be set: 8-5/8 @ 75', 1" @ 1978 ← cut 200' to surface

Length of Conductor Pipe required: none

Projected Total Depth: 1600

Formation at Total Depth: Douglas

Water Source for Drilling Operations: ☐ Well ☐ Farm Pond ☒ Other trucked

DWR Permit #: \_\_\_\_\_

(Note: Apply for Permit with DWR ☐)

Will Cores be taken? ☐ Yes ☒ No

If Yes, proposed zone: \_\_\_\_\_

AFFIDAVIT

The undersigned hereby affirms that the drilling, completion and eventual plugging of this well will comply with K.S.A. 55 et. seq.

It is agreed that the following minimum requirements will be met:

1. Notify the appropriate district office **prior** to spudding of well;
2. A copy of the approved notice of intent to drill **shall be** posted on each drilling rig;
3. The minimum amount of surface pipe as specified below **shall be set** by circulating cement to the top; in all cases surface pipe **shall be set** through all unconsolidated materials **plus** a minimum of 20 feet into the underlying formation.
4. If the well is dry hole, an agreement between the operator and the district office on plug length and placement is necessary **prior to plugging**;
5. The appropriate district office will be notified before well is either plugged or production casing is cemented in;
6. If an ALTERNATE II COMPLETION, production pipe shall be cemented from below any usable water to surface within **120 days** of spud date.  
Or pursuant to Appendix "B" - Eastern Kansas surface casing order #133,891-C, which applies to the KCC District 3 area, alternate II cementing must be completed within 30 days of the spud date or the well shall be plugged. **In all cases, NOTIFY district office** prior to any cementing.

I hereby certify that the statements made herein are true and to the best of my knowledge and belief.

Date: 5/7/07 Signature of Operator or Agent: Casey Coats Title: Operations Engineer

For KCC Use ONLY

API # 15 - 015-19735-00-03  
Conductor pipe required None feet  
Minimum surface pipe required 75' feet per Alt. X 2  
Approved by: 5-9-07  
This authorization expires: 11-9-07  
(This authorization void if drilling not started within 6 months of effective date.)  
Spud date: \_\_\_\_\_ Agent: \_\_\_\_\_

Remember to:

- File Drill Pit Application (form CDP-1) with Intent to Drill;
- File Completion Form ACO-1 within 120 days of spud date;
- File acreage attribution plat according to field proration orders;
- Notify appropriate district office 48 hours prior to workover or re-entry;
- Submit plugging report (CP-4) after plugging is completed;
- Obtain written approval before disposing or injecting salt water.
- If this permit has expired (See: authorized expiration date) please check the box below and return to the address below.

☐ Well Not Drilled - Permit Expired

Signature of Operator or Agent: \_\_\_\_\_ Date: \_\_\_\_\_

RECEIVED

KANSAS CORPORATION COMMISSION

Mail to: KCC - Conservation Division, 130 S. Market - Room 2078, Wichita, Kansas 67202

MAY 08 2007

CONSERVATION DIVISION  
WICHITA, KS

**IN ALL CASES PLOT THE INTENDED WELL ON THE PLAT BELOW***Plat of acreage attributable to a well in a prorated or spaced field*

**If the intended well is in a prorated or spaced field, please fully complete this side of the form.** If the intended well is in a prorated or spaced field complete the plat below showing that the well will be properly located in relationship to other wells producing from the common source of supply. Please show all the wells and within 1 mile of the boundaries of the proposed acreage attribution unit for gas wells and within 1/2 mile of the boundaries of the proposed acreage attribution unit for oil wells.

API No. 15 - 015-19735-0003  
 Operator: Vess Oil Corporation  
 Lease: Wilson A  
 Well Number: 199 OWWO  
 Field: El Dorado

Number of Acres attributable to well: \_\_\_\_\_  
 QTR / QTR / QTR of acreage: SW - SW - NE

Location of Well: County: Butler  
2363 feet from ☒ N / ☐ S Line of Section  
2257' feet from ☒ E / ☐ W Line of Section  
 Sec. 8 Twp. 25S S. R. 05E ☒ East ☐ West

Is Section: ☒ Regular or ☐ Irregular

**If Section is Irregular, locate well from nearest corner boundary.**

Section corner used: ☐ NE ☐ NW ☐ SE ☐ SW

**PLAT**

(Show location of the well and shade attributable acreage for prorated or spaced wells.)  
 (Show footage to the nearest lease or unit boundary line.)

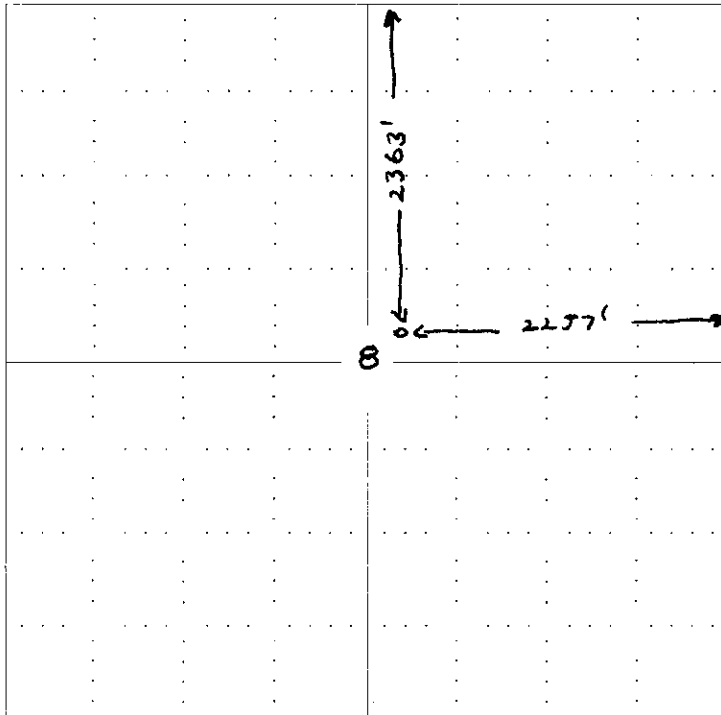

**NOTE: In all cases locate the spot of the proposed drilling location.**

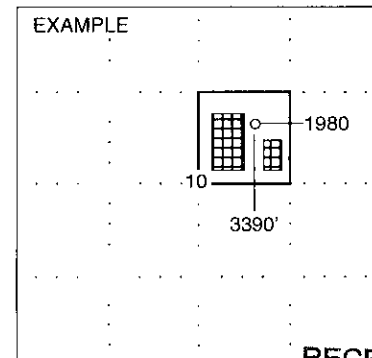

SEWARD CO.

**RECEIVED**  
 KANSAS CORPORATION COMMISSION

**MAY 08 2007**

**In plotting the proposed location of the well, you must show:**

1. The manner in which you are using the depicted plat by identifying section lines, i.e. 1 section, 1 section with 8 surrounding sections, 4 sections, etc.
2. The distance of the proposed drilling location from the section's south / north and east / west.
3. The distance to the nearest lease or unit boundary line.
4. If proposed location is located within a prorated or spaced field a certificate of acreage attribution plat must be attached: (CO-7 for oil wells; CG-8 for gas wells).

CONSERVATION DIVISION  
 WICHITA, KS

KANSAS CORPORATION COMMISSION  
OIL & GAS CONSERVATION DIVISION  
**APPLICATION FOR SURFACE POND**

Form CDP-1  
January 2001  
Form must be Typed

*Submit in Duplicate*

Operator Name: <b>Vess Oil Corporation</b>		License Number: <b>5030</b>	
Operator Address: <b>1700 Waterfront Parkway, Bldg. 500, Wichita, KS 67206</b>			
Contact Person: <b>Casey Coats</b>		Phone Number: ( <b>316</b> ) <b>682 - 1537 X104</b>	
Lease Name: <b>Wilson A #199 OWWO</b>		Pit Location:	
Type of Pond: <input type="checkbox"/> Emergency Pit <input type="checkbox"/> Treatment Pit <input type="checkbox"/> Workover Pit <input checked="" type="checkbox"/> Drilling Pit <input type="checkbox"/> Burn Pit (If WP Supply API No. or Year Drilled) _____		Pit is: <input checked="" type="checkbox"/> Proposed <input type="checkbox"/> Existing If Existing, date constructed: _____ Pit capacity: <b>500</b> (bbls)	
		<b>NE</b> Qtr. Sec. <b>8</b> Twp. <b>25S</b> R. <b>05E</b> <input checked="" type="checkbox"/> E <input type="checkbox"/> W <b>2363'</b> Feet from <b>N</b> S (circle one) Line of Section <b>2257'</b> Feet from <b>E</b> W (circle one) Line of Section <b>Butler</b> County	
Is the pit located in a Sensitive Ground Water Area? <input type="checkbox"/> Yes <input checked="" type="checkbox"/> No		Chloride concentration: _____ mg/l (For Emergency Pits and Treatment Pits only)	
Is the bottom below ground level? <input checked="" type="checkbox"/> Yes <input type="checkbox"/> No		Artificial Liner? <input type="checkbox"/> Yes <input checked="" type="checkbox"/> No	
How is the pit lined if a plastic liner is not used? <b>rock, clay soil and bentonite mud</b>			
Pit dimensions (all but working pits): <b>20</b> Length (feet) <b>12</b> Width (feet) Depth from ground level to deepest point: <b>3</b> (feet)			
If the pit is lined give a brief description of the liner material, thickness and installation procedure.		Describe procedures for periodic maintenance and determining liner integrity, including any special monitoring.	
Distance to nearest water well within one-mile of pit <b>3900</b> feet    Depth of water well <b>105</b> feet		Depth to shallowest fresh water <b>15</b> feet. Source of information: _____ measured <input checked="" type="checkbox"/> well owner <input type="checkbox"/> electric log <input type="checkbox"/> KDWR	
<b>Emergency, Treatment and Burn Pits ONLY:</b> Producing Formation: _____ Number of producing wells on lease: _____ Barrels of fluid produced daily: _____ Does the slope from the tank battery allow all spilled fluids to flow into the pond? <input type="checkbox"/> Yes <input type="checkbox"/> No		<b>Drilling and Workover Pits ONLY:</b> Type of material utilized in drilling/workover: <b>water</b> Number of working pits to be utilized: <b>1</b> Abandonment procedure: <b>evaporation, haul and fill back in</b> Drill pits must be closed within 365 days of spud date.	
I hereby certify that the above statements are true and correct to the best of my knowledge and belief.			
Date <b>5/7/07</b>		<b>Casey Coats</b> Signature of Applicant or Agent	
RECEIVED KANSAS CORPORATION COMMISSION <b>MAY 08 2007</b> CONSERVATION DIVISION WICHITA, KS			

**KCC OFFICE USE ONLY**

Date Received: **5/8/07** Permit Number: \_\_\_\_\_ Permit Date: **5/8/07** Lease Inspection: ☐ Yes ☒ No

Mail to: KCC - Conservation Division, 130 S. Market - Room 2078, Wichita, Kansas 67202

15015-1985-0005

15-015-19735-0003

Wilson A 199  
App SW SW NE  
Sec 8 - T25S-R05E  
Butler Co, Kansas

1393.1 GL

6-8-41 drly completed

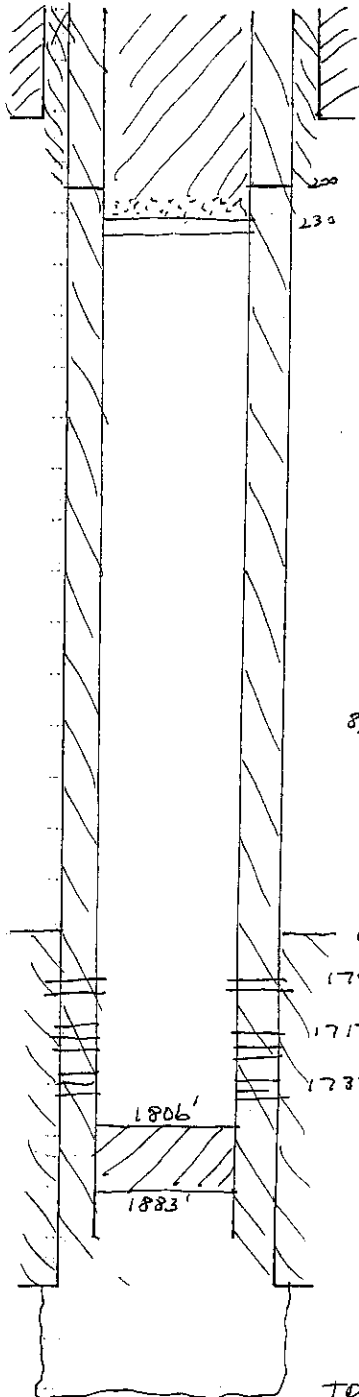

Burlingame Lime 823 to 859

- oil stain

Douglas (stranger sand)

Cores show

1482 to 1496

4/16/79 Plugging Spot 355x A w/ 27cc

plug at 1883' wireline log at 1806'

Pack plug to 230': 23' rock + sand on top.

Perf 200': 522 1235x A w/ 27cc, Core to surface

8/20/66 4 1/2" 9.5 w/ 184 Casing liner set at 1960'

w/ 1855x - Circulated to surface

Cleaned out to 2012'

4 1/2" 7 perfs

cut JOC 1650'

1706 to 09

1717 to 1727 Landing

1734 to 1744

1806'

1883'

Original 7" Perfs:

1717-27, 1734-58

1978-2012 OH

7" casing set at 1978' w/ 655x

KC

TO 2012

RECEIVED  
KANSAS CORPORATION COMMISSION

MAY 08 2007

CONSERVATION DIVISION  
WICHITA, KS

STATE OF KANSAS  
STATE CORPORATION COMMISSIONTo: Rick Wertman  
Fax 357-6211  
From Vess Oil Corp

FORM CP-4

15-015-19735-00-02

## WELL PLUGGING RECORD

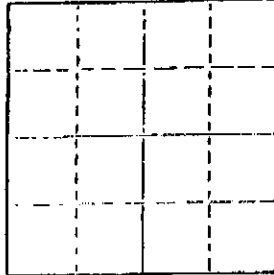
Give All Information Completely  
Make Required Affidavit  
Mail or Deliver Report to  
Conservation Division  
State Corporation Comm.  
245 North Water  
Wichita, KS 67202Locate well correctly on above  
Section PlatButler County, Sec. 8 Twp. 25 Rge. 5 E/W  
Location as "NE/CNW/SW" or footage from lines  
277' N - 383' E CenterLease Owner Cities Service Company  
Lease Name Wilson Well No. 199  
Office Address 700 Sutton Place Bldg., Wichita, KS 67202  
Character of Well (Completed as Oil, Gas or Dry Hole)  
OilDate Well completed 6-8 1941  
Application for plugging filed 1-18 1979  
Application for plugging approved 1-22 1979  
Plugging commenced 4-16 1979  
Plugging completed 4-16 1979  
Reason for abandonment of well or producing formation  
UneconomicalIf a producing well is abandoned, date of last production  
19Was permission obtained from the Conservation Division or  
its agents before plugging was commenced? YesName of Conservation Agent who supervised plugging of this well Don Thompson  
Producing formation Lansing, Kansas City Depth to top 1691 Bottom 1744 Total Depth of Well 2012  
Show depth and thickness of all water, oil and gas formations.

## OIL, GAS OR WATER RECORDS

## CASING RECORD

FORMATION	CONTENT	FROM	TO	SIZE	PUT IN	PULLED OUT
				7"	18'	-0-
				4 1/2"	1960'	-0-

Describe in detail the manner in which the well was plugged, indicating where the mud fluid  
was placed and the method or methods used in introducing it into the hole. If cement or other  
plugs were used, state the character of same and depth placed, from feet to  
feet for each plug set.Ran 2" EUE tubing open end to 1883' spot 35 sacks common cement, 2% CaCl-2  
on bottom thru tubing. Ran SLM 1806' top cement. 77' F.U. Pushed plug to 230'.  
23' rock and sand at top of plug. Perforated 4 1/2" casing at 200' with 4-1/2 shots.  
Squeeze with 123 sacks common 2% CaCl-2 at 200#. Cement circulated to surface.

(If additional description is necessary, use BACK of this sheet)

Name of Plugging Contractor Halliburton

STATE OF Kansas COUNTY OF Sedgwick, ss.  
W. J. Devaney (employee of owner) or (owner)  
of the above-described well, being first duly sworn on oath, says: That I have knowledge of  
the facts, statements, and matters herein contained and the log of the above-described well  
as filed and that the same are true and correct. So help me God.Glenn E. Meier  
STATE NOTARY PUBLIC  
Sedgwick County, Kansas

(Signature)

209 E William, 900 Sutton Place Bldg., Wichita  
(Address) KS 6720

SUBSCRIBED AND SWORN before me this 19th day of April, 1979

Glenn E. Meier Notary Public.

My commission expires 6-3-81

RECEIVED  
KANSAS CORPORATION COMMISSION

MAY 8 2007

CONSERVATION DIVISION  
WICHITA, KS