

For KCC Use: 5-1507  
Effective Date: 5-15-07  
District # 1  
SGA?  Yes  No

KANSAS CORPORATION COMMISSION  
OIL & GAS CONSERVATION DIVISION

Form C-1  
December 2002  
Form must be Typed  
Form must be Signed  
All blanks must be Filled

NOTICE OF INTENT TO DRILL

Must be approved by KCC five (5) days prior to commencing well

Expected Spud Date May, 23, 2007  
month day year

Spot  East  
NE - SE Sec. 31 Twp. 22 S. R. 30  West  
1,980 feet from  N /  S Line of Section  
583 feet from  E /  W Line of Section  
Is SECTION  Regular  Irregular?

OPERATOR: License# 9152  
Name: MAREXCO, Inc.  
Address: 3555 NW 58th St. - Suite 420  
City/State/Zip: Oklahoma City, OK 73112  
Contact Person: Stephen W. Marden  
Phone: 405-942-4880

(Note: Locate well on the Section Plat on reverse side)  
County: Finney  
Lease Name: Huelskamp Well #: 1-31  
Field Name: Stewart NE  
Is this a Prorated / Spaced Field?  Yes  No

CONTRACTOR: License# 33793  
Name: H2 Drilling

Target Formation(s): Kansas City Fort Scott  
Nearest Lease or unit boundary: 583'  
Ground Surface Elevation: 2,856' feet MSL  
Water well within one-quarter mile:  Yes  No  
Public water supply well within one mile:  Yes  No  
Depth to bottom of fresh water: 180'  
Depth to bottom of usable water: 1,000' 1250'  
Surface Pipe by Alternate:  1  2  
Length of Surface Pipe Planned to be set: 350'  
Length of Conductor Pipe required: 0  
Projected Total Depth: 4,700'

Well Drilled For: Well Class: Type Equipment:  
 Oil  Enh Rec  Infield  Mud Rotary  
 Gas  Storage  Pool Ext.  Air Rotary  
 OWWO  Disposal  Wildcat  Cable  
 Seismic; # of Holes  Other  Other

If OWWO: old well information as follows:  
Operator: \_\_\_\_\_  
Well Name: \_\_\_\_\_  
Original Completion Date: \_\_\_\_\_ Original Total Depth: \_\_\_\_\_

Directional, Deviated or Horizontal wellbore?  Yes  No  
If Yes, true vertical depth: \_\_\_\_\_  
Bottom Hole Location: \_\_\_\_\_  
KCC DKT #: \_\_\_\_\_

Formation at Total Depth: Pennsylvannian Fort Scott  
Water Source for Drilling Operations:  
 Well  Farm Pond  Other  X  
DWR Permit #: \_\_\_\_\_  
Will Cores be taken?  Yes  No  
If Yes, proposed zone: \_\_\_\_\_

PRORATED & SPACED: HUGOTON

AFFIDAVIT

RECEIVED  
KANSAS CORPORATION COMMISSION

The undersigned hereby affirms that the drilling, completion and eventual plugging of this well will comply with K.S.A. 55 et. seq.  
It is agreed that the following minimum requirements will be met:

MAY 09 2007

1. Notify the appropriate district office **prior** to spudding of well;
2. A copy of the approved notice of intent to drill **shall be** posted on each drilling rig;
3. The minimum amount of surface pipe as specified below **shall be set** by circulating cement to the top; in all cases surface pipe **shall be set** through all unconsolidated materials plus a minimum of 20 feet into the underlying formation.
4. If the well is dry hole, an agreement between the operator and the district office on plug length and placement is necessary **prior to plugging**;
5. The appropriate district office will be notified before well is either plugged or production casing is cemented in;
6. If an ALTERNATE II COMPLETION, production pipe shall be cemented from below any usable water to surface within **120 days** of spud date. Or pursuant to Appendix "B" - Eastern Kansas surface casing order #133,891-C, which applies to the KCC District 3 area, alternate II cementing must be completed within 30 days of the spud date or the well shall be plugged. **In all cases, NOTIFY district office** prior to any cementing.

I hereby certify that the statements made herein are true and to the best of my knowledge and belief.

Date: 5/07/07 Signature of Operator or Agent: Stephen W. Marden Title: V.P.

For KCC Use ONLY  
API # 15 - D55-21940-0000  
Conductor pipe required None feet  
Minimum surface pipe required 200 feet per Alt. Y(2)  
Approved by: fm 5-10-07  
This authorization expires: 11-10-07  
(This authorization void if drilling not started within 6 months of approval date.)  
Spud date: \_\_\_\_\_ Agent: \_\_\_\_\_

Remember to:

- File Drill Pit Application (form CDP-1) with Intent to Drill;
- File Completion Form ACO-1 within 120 days of spud date;
- File acreage attribution plat according to field proration orders;
- Notify appropriate district office 48 hours prior to workover or re-entry;
- Submit plugging report (CP-4) after plugging is completed;
- Obtain written approval before disposing or injecting salt water.
- If this permit has expired (See: authorized expiration date) please check the box below and return to the address below.

Well Not Drilled - Permit Expired  
Signature of Operator or Agent: \_\_\_\_\_  
Date: \_\_\_\_\_

Mail to: KCC - Conservation Division, 130 S. Market - Room 2078, Wichita, Kansas 67202

31  
22  
30W

**IN ALL CASES PLOT THE INTENDED WELL ON THE PLAT BELOW**

*Plat of acreage attributable to a well in a prorated or spaced field*

**If the intended well is in a prorated or spaced field, please fully complete this side of the form.** If the intended well is in a prorated or spaced field complete the plat below showing that the well will be properly located in relationship to other wells producing from the common source of supply. Please show all the wells and within 1 mile of the boundaries of the proposed acreage attribution unit for gas wells and within 1/2 mile of the boundaries of the proposed acreage attribution unit for oil wells.

API No. 15 - 055-21940-0000  
Operator: MAREXCO, Inc.  
Lease: Huelskamp  
Well Number: 1-31  
Field: Stewart NE  
Number of Acres attributable to well: \_\_\_\_\_  
QTR / QTR / QTR of acreage: \_\_\_\_\_

Location of Well: County: Finney  
1,980 feet from  N /  S Line of Section  
583 feet from  E /  W Line of Section  
Sec. 31 Twp. 22 S. R. 30  East  West

Is Section:  Regular or  Irregular

**If Section is Irregular, locate well from nearest corner boundary.**

Section corner used:  NE  NW  SE  SW

**PLAT**

*(Show location of the well and shade attributable acreage for prorated or spaced wells.)  
(Show footage to the nearest lease or unit boundary line.)*

T22S-R30W

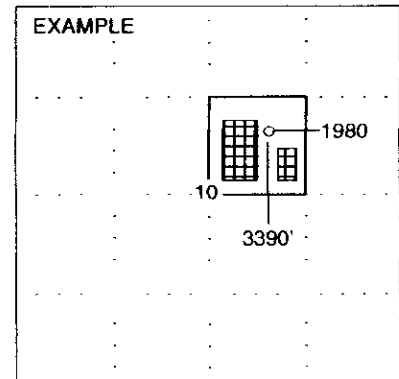
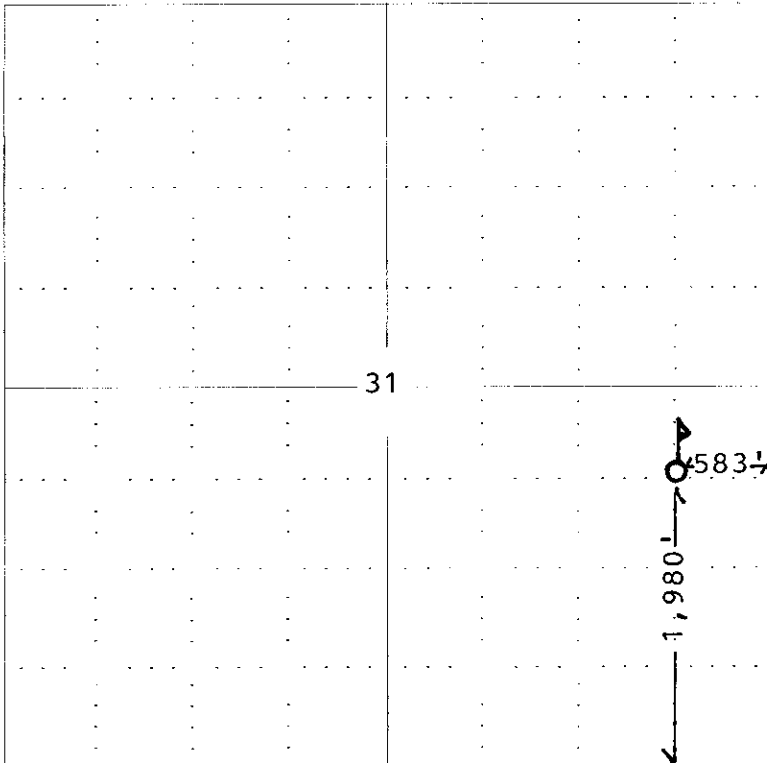

SEWARD CO. RECEIVED KANSAS CORPORATION COMMISSION

MAY 09 2007

**In plotting the proposed location of the well, you must show:**

1. The manner in which you are using the depicted plat by identifying section lines, i.e. 1 section, 1 section with 8 surrounding sections, 4 sections, etc.
2. The distance of the proposed drilling location from the section's south / north and east / west.
3. The distance to the nearest lease or unit boundary line.
4. If proposed location is located within a prorated or spaced field a certificate of acreage attribution plat must be attached: (CO-7 for oil wells; CG-8 for gas wells).

CONSERVATION DIVISION  
WICHITA, KS

KANSAS CORPORATION COMMISSION  
OIL & GAS CONSERVATION DIVISION

Form CDP-1  
April 2004  
Form must be Typed

APPLICATION FOR SURFACE PIT

Submit in Duplicate

|  |  |   |
|--|--|---|
| Operator Name: <b>MAREXCO, Inc.</b>  |  | License Number: <b>9152</b>   |
| Operator Address: <b>3555 NW 58th Street - Suite 420, Oklahoma City, OK 73112</b>  |  |   |
| Contact Person: <b>Stephen W. Marden</b>   |  | Phone Number: <b>(405) 942-4880</b>   |
| Lease Name & Well No.: <b>Huelskamp #1-31</b>  |  | Pit Location (QQQQ):<br>_____ NE SE<br>Sec. <b>31</b> Twp. <b>22S</b> R. <b>30</b> <input type="checkbox"/> East <input checked="" type="checkbox"/> West<br><b>1,980</b> Feet from <input type="checkbox"/> North / <input checked="" type="checkbox"/> South Line of Section<br><b>583</b> Feet from <input checked="" type="checkbox"/> East / <input type="checkbox"/> West Line of Section<br><b>Finney</b> County |
| Type of Pit:<br><input type="checkbox"/> Emergency Pit <input type="checkbox"/> Burn Pit<br><input type="checkbox"/> Settling Pit <input checked="" type="checkbox"/> Drilling Pit<br><input type="checkbox"/> Workover Pit <input type="checkbox"/> Haul-Off Pit<br><small>(If WP Supply API No. or Year Drilled)</small> | Pit is:<br><input checked="" type="checkbox"/> Proposed <input type="checkbox"/> Existing<br>If Existing, date constructed:<br>_____<br>Pit capacity:<br><b>800</b> (bbls) |   |
| Is the pit located in a Sensitive Ground Water Area? <input type="checkbox"/> Yes <input checked="" type="checkbox"/> No   |  | Chloride concentration: _____ mg/l<br><small>(For Emergency Pits and Settling Pits only)</small>  |
| Is the bottom below ground level?<br><input checked="" type="checkbox"/> Yes <input type="checkbox"/> No   | Artificial Liner?<br><input type="checkbox"/> Yes <input checked="" type="checkbox"/> No   | How is the pit lined if a plastic liner is not used?<br><b>Native muds.</b>   |
| Pit dimensions (all but working pits): <b>100</b> Length (feet) <b>100</b> Width (feet) _____ N/A: Steel Pits<br>Depth from ground level to deepest point: <b>4</b> (feet)   |  |   |
| If the pit is lined give a brief description of the liner material, thickness and installation procedure.  |  | Describe procedures for periodic maintenance and determining liner integrity, including any special monitoring.   |
| Distance to nearest water well within one-mile of pit<br><b>1,320</b> feet Depth of water well <b>180'</b> feet  |  | Depth to shallowest fresh water <b>180</b> <del>60</del> feet.<br>Source of information: <b>(C)</b><br>_____ measured _____ well owner _____ electric log <input checked="" type="checkbox"/> KDWR  |
| <b>Emergency, Settling and Burn Pits ONLY:</b><br>Producing Formation: _____<br>Number of producing wells on lease: _____<br>Barrels of fluid produced daily: _____<br>Does the slope from the tank battery allow all spilled fluids to flow into the pit? <input type="checkbox"/> Yes <input type="checkbox"/> No        |  | <b>Drilling, Workover and Haul-Off Pits ONLY:</b><br>Type of material utilized in drilling/workover: <b>chem. mud</b><br>Number of working pits to be utilized: <b>1</b><br>Abandonment procedure: <b>break down corners, let dry completely, fill with top soil last.</b><br>Drill pits must be closed within 365 days of spud date.   |
| I hereby certify that the above statements are true and correct to the best of my knowledge and belief.  |  | <b>RECEIVED</b><br>KANSAS CORPORATION COMMISSION<br><b>MAY 09 2007</b><br>CONSERVATION DIVISION<br>WICHITA, KS  |
| <b>5/7/07</b><br>Date  |  | <b>Stephen W. Marden</b><br>Signature of Applicant or Agent   |

15-055-21940-0000

KCC OFFICE USE ONLY

Date Received: **5/9/07** Permit Number: \_\_\_\_\_ Permit Date: **5/9/07** Lease Inspection:  Yes  No