

For KCC Use: 5-20-07
Effective Date: 4
District #: 4
SGA? ☐ Yes ☒ No

KANSAS CORPORATION COMMISSION
OIL & GAS CONSERVATION DIVISION
NOTICE OF INTENT TO DRILL

Must be approved by KCC five (5) days prior to commencing well

Form C-1
December 2002
Form must be Typed
Form must be Signed
All blanks must be Filled

Expected Spud Date MAY 19 2007
month day year

OPERATOR: License# 5086
Name: PINTAIL PETROLEUM LTD
Address: 225 N MARKET SUITE 300
City/State/Zip: WICHITA, KS 67202
Contact Person: FLIP PHILLIPS
Phone: 316-263-2243

CONTRACTOR: License# 4958
Name: Mallard JV Inc

Well Drilled For:	Well Class:	Type Equipment:
<input checked="" type="checkbox"/> Oil	<input type="checkbox"/> Enh Rec	<input type="checkbox"/> Infield
<input type="checkbox"/> Gas	<input type="checkbox"/> Storage	<input type="checkbox"/> Pool Ext.
<input type="checkbox"/> OWWO	<input type="checkbox"/> Disposal	<input checked="" type="checkbox"/> Wildcat
<input type="checkbox"/> Seismic; # of Holes	<input type="checkbox"/> Other	<input type="checkbox"/> Cable
<input type="checkbox"/> Other		

If OWWO: old well information as follows:

Operator: _____
Well Name: _____
Original Completion Date: _____ Original Total Depth: _____

Directional, Deviated or Horizontal wellbore? ☐ Yes ☒ No

If Yes, true vertical depth: _____

Bottom Hole Location: _____

KCC DKT #: _____

Spot
W/2 SE/4 - NE/4 Sec. 9 Twp. 15 S. R. 21 ☐ East ☒ West
1960 _____ feet from ☒ N / ☐ S Line of Section
1230 _____ feet from ☒ E / ☐ W Line of Section

Is SECTION ☒ Regular ☐ Irregular?

(Note: Locate well on the Section Plat on reverse side)

County: TREGO
Lease Name: Splitter GL Well #: 2-9
Field Name: WILDCAT

Is this a Prorated / Spaced Field? ☐ Yes ☒ No

Target Formation(s): MISSISSIPPI

Nearest Lease or unit boundary: 1230'

Ground Surface Elevation: 2253' feet MSL

Water well within one-quarter mile: ☐ Yes ☒ No

Public water supply well within one mile: ☐ Yes ☒ No

Depth to bottom of fresh water: 100

Depth to bottom of usable water: 600 730

Surface Pipe by Alternate: ☐ 1 ☒ 2

Length of Surface Pipe Planned to be set: 200'

Length of Conductor Pipe required: NONE

Projected Total Depth: 4300'

Formation at Total Depth: MISSISSIPPI

Water Source for Drilling Operations:

☐ Well ☐ Farm Pond ☒ Other

DWR Permit #: _____

(Note: Apply for Permit with DWR ☒)

Will Cores be taken? ☐ Yes ☒ No

If Yes, proposed zone: _____

AFFIDAVIT

RECEIVED
KANSAS CORPORATION COMMISSION

The undersigned hereby affirms that the drilling, completion and eventual plugging of this well will comply with K.S.A. 55 et. seq.

It is agreed that the following minimum requirements will be met:

1. Notify the appropriate district office **prior** to spudding of well;
2. A copy of the approved notice of intent to drill **shall be** posted on each drilling rig;
3. The minimum amount of surface pipe as specified below **shall be set** by circulating cement to the top; in all cases surface pipe **shall be set** through all unconsolidated materials plus a minimum of 20 feet into the underlying formation.
4. If the well is dry hole, an agreement between the operator and the district office on plug length and placement is necessary **prior to plugging**;
5. The appropriate district office will be notified before well is either plugged or production casing is cemented in;
6. If an ALTERNATE II COMPLETION, production pipe shall be cemented from below any usable water to surface within **120 days** of spud date.
Or pursuant to Appendix "B" - Eastern Kansas surface casing order #133,891-C, which applies to the KCC District 3 area, alternate II cementing must be completed within 30 days of the spud date or the well shall be plugged. **In all cases, NOTIFY district office** prior to any cementing.

I hereby certify that the statements made herein are true and to the best of my knowledge and belief.

Date: 5/15/07 Signature of Operator or Agent: Beck A. Isen Title: GEOLOGIST

For KCC Use ONLY

API # 15 - 195-22457-0000

Conductor pipe required NONE feet

Minimum surface pipe required 200 feet per Alt. X 2

Approved by: 5/15/07

This authorization expires: 11-15-07

(This authorization void if drilling not started within 6 months of approval date.)

Spud date: _____ Agent: _____

Remember to:

- File Drill Pit Application (form CDP-1) with Intent to Drill;
- File Completion Form ACO-1 within 120 days of spud date;
- File acreage attribution plat according to field proration orders;
- Notify appropriate district office 48 hours prior to workover or re-entry;
- Submit plugging report (CP-4) after plugging is completed;
- Obtain written approval before disposing or injecting salt water.
- If this permit has expired (See: authorized expiration date) please check the box below and return to the address below.

☐ Well Not Drilled - Permit Expired

Signature of Operator or Agent: _____

Date: _____

Mail to: KCC - Conservation Division, 130 S. Market - Room 2078, Wichita, Kansas 67202

9
15
21W

IN ALL CASES PLOT THE INTENDED WELL ON THE PLAT BELOW*Plat of acreage attributable to a well in a prorated or spaced field*

If the intended well is in a prorated or spaced field, please fully complete this side of the form. If the intended well is in a prorated or spaced field complete the plat below showing that the well will be properly located in relationship to other wells producing from the common source of supply. Please show all the wells and within 1 mile of the boundaries of the proposed acreage attribution unit for gas wells and within 1/2 mile of the boundaries of the proposed acreage attribution unit for oil wells.

API No. 15 - 195-22457-0000
 Operator: PINTAIL PETROLEUM LTD
 Lease: Splitter GL
 Well Number: 2-9
 Field: WILDCAT

Number of Acres attributable to well: 320
 QTR / QTR / QTR of acreage: W/2 - SE/4 - NE/4

Location of Well: County: TREGO
 1960 feet from ☒ N / ☐ S Line of Section
 1230 feet from ☒ E / ☐ W Line of Section
 Sec. 9 Twp. 15 S. R. 21 ☐ East ☒ West

Is Section: ☒ Regular or ☐ Irregular

If Section Is Irregular, locate well from nearest corner boundary.

Section corner used: ☐ NE ☐ NW ☐ SE ☐ SW

PLAT

(Show location of the well and shade attributable acreage for prorated or spaced wells.)
 (Show footage to the nearest lease or unit boundary line.)

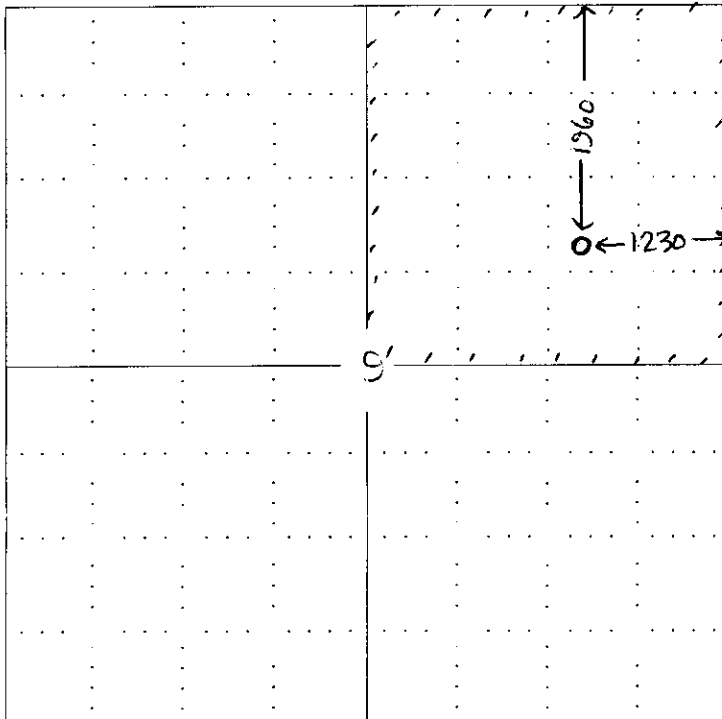

RECEIVED
 KANSAS CORPORATION COMMISSION

MAY 15 2007

CONSERVATION DIVISION
 WICHITA, KS

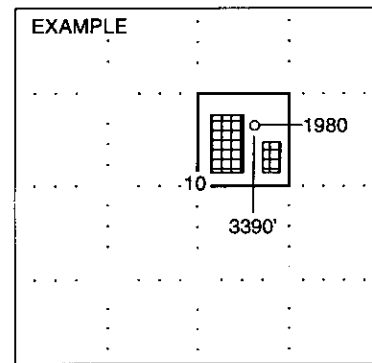

NOTE: In all cases locate the spot of the proposed drilling location.

In plotting the proposed location of the well, you must show:

1. The manner in which you are using the depicted plat by identifying section lines, i.e. 1 section, 1 section with 8 surrounding sections, 4 sections, etc.
2. The distance of the proposed drilling location from the section's south / north and east / west.
3. The distance to the nearest lease or unit boundary line.
4. If proposed location is located within a prorated or spaced field a certificate of acreage attribution plat must be attached: (CO-7 for oil wells; CG-8 for gas wells).

**KANSAS CORPORATION COMMISSION
OIL & GAS CONSERVATION DIVISION
APPLICATION FOR SURFACE PIT**

Form CDP-1
April 2004
Form must be Typed

Submit in Duplicate

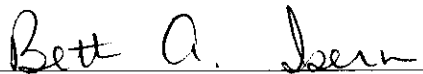
Operator Name: PINTIAL PETROLEUM LTD		License Number: 5086
Operator Address: 225 N MARKET SUITE 300 WICHITA KS 67206		
Contact Person: FLIP PHILLIPS		Phone Number: (316) 263 - 2243
Lease Name & Well No.: Splitter GL 2-9		Pit Location (QQQQ): APPX W/2 SE/4 NE/4
Type of Pit: <input type="checkbox"/> Emergency Pit <input type="checkbox"/> Burn Pit <input type="checkbox"/> Settling Pit <input checked="" type="checkbox"/> Drilling Pit <input type="checkbox"/> Workover Pit <input type="checkbox"/> Haul-Off Pit <small>(If WP Supply API No. or Year Drilled)</small>	Pit is: <input checked="" type="checkbox"/> Proposed <input type="checkbox"/> Existing If Existing, date constructed: _____ Pit capacity: _____ (bbls)	Sec. 9 Twp. 15 R. 21 <input type="checkbox"/> East <input checked="" type="checkbox"/> West 1960 Feet from <input checked="" type="checkbox"/> North / <input type="checkbox"/> South Line of Section 1230 Feet from <input checked="" type="checkbox"/> East / <input type="checkbox"/> West Line of Section TREGO _____ County
Is the pit located in a Sensitive Ground Water Area? <input type="checkbox"/> Yes <input checked="" type="checkbox"/> No		Chloride concentration: _____ mg/l <small>(For Emergency Pits and Settling Pits only)</small>
Is the bottom below ground level? <input checked="" type="checkbox"/> Yes <input type="checkbox"/> No	Artificial Liner? <input type="checkbox"/> Yes <input checked="" type="checkbox"/> No	How is the pit lined if a plastic liner is not used? MUD AND BENTONITE
Pit dimensions (all but working pits): 80 Length (feet) 80 Width (feet) N/A: Steel Pits Depth from ground level to deepest point: 4 (feet)		
If the pit is lined give a brief description of the liner material, thickness and installation procedure.		Describe procedures for periodic maintenance and determine liner integrity, including any special monitoring. <div style="text-align: right;"> RECEIVED MAY 15 2007 CONSERVATION DIVISION WICHITA, KS </div>
Distance to nearest water well within one-mile of pit 5248 feet Depth of water well 48 feet	Depth to shallowest fresh water 180 42 feet. Source of information: _____ measured _____ well owner <input checked="" type="checkbox"/> electric log <input checked="" type="checkbox"/> KDWR	
Emergency, Settling and Burn Pits ONLY: Producing Formation: _____ Number of producing wells on lease: _____ Barrels of fluid produced daily: _____ Does the slope from the tank battery allow all spilled fluids to flow into the pit? <input type="checkbox"/> Yes <input type="checkbox"/> No	Drilling, Workover and Haul-Off Pits ONLY: Type of material utilized in drilling/workover: FRESH WATER AND MUD Number of working pits to be utilized: 3 Abandonment procedure: EVAPORATE AND BACKFILL _____ Drill pits must be closed within 365 days of spud date.	
I hereby certify that the above statements are true and correct to the best of my knowledge and belief. <div style="display: flex; justify-content: space-between;"> <div> 12/28/2006 Date </div> <div>  Signature of Applicant or Agent </div> </div>		
KCC OFFICE USE ONLY		
Date Received: 5/5/07 Permit Number: _____ Permit Date: 5/5/07 Lease Inspection: <input type="checkbox"/> Yes <input checked="" type="checkbox"/> No		

Mail to: KCC - Conservation Division, 130 S. Market - Room 2078, Wichita, Kansas 67202

15785-22457-0000