

For KCC Use:
 Effective Date: 5-19-07
 District #: 4
 SGA? Yes No

**KANSAS CORPORATION COMMISSION
 OIL & GAS CONSERVATION DIVISION**

CORRECTED

Form C-1
 December 2002
 Form must be Typed
 Form must be Signed
 All must be Filled

NOTICE OF INTENT TO DRILL

Must be approved by KCC five (5) days prior to commencing well

Expected Spud Date June 1 2007
month day year

* Spot East
NE-SE SE SE Sec. 14 Twp. 10 S. R. 15 West
~~620~~ 670 feet from N / S Line of Section
~~530~~ 430 feet from E / W Line of Section
 Is SECTION Regular Irregular?

OPERATOR: License# 3956 ✓
 Name: Brungardt Oil & Leasing, Inc.
 Address: P.O. Box 871
 City/State/Zip: Russell, KS 67665
 Contact Person: Gary L. Brungardt
 Phone: (785)483-4975

CONTRACTOR: License# 5184 ✓
 Name: Shields Oil Producers, Inc.

Well Drilled For: Oil Gas CWMO Seismic; # of Holes Other
 Enh Rec Storage Disposal
 Well Class: Infield Pool Ext. Wildcat Other
 Type Equipment: Mud Rotary Air Rotary Cable

(Note: Locate well on the Section Plat on reverse side)
 County: Osborne
 Lease Name: Wedel A Well #: 3
 Field Name: Ruggels
 Is this a Prorated / Spaced Field? Yes No
 Target Formation(s): Arbuckle

Nearest Lease or unit boundary: 530'
 Ground Surface Elevation: 1870 * 1885 feet MSL
 Water well within one-quarter mile: Yes No
 Public water supply well within one mile: Yes No
 Depth to bottom of fresh water: 180'
 Depth to bottom of usable water: 600'

Surface Pipe by Alternate: 1 2
 Length of Surface Pipe Planned to be set: 200'
 Length of Conductor Pipe required: None
 Projected Total Depth: 3600'
 Formation at Total Depth: Arbuckle
 Water Source for Drilling Operations: Well Farm Pond Other _____
 DWR Permit #: _____

**RECEIVED
 KANSAS CORPORATION COMMISSION
 MAY 18 2007**

**CONSERVATION DIVISION
 WICHITA, KS**

(Note: Apply for Permit with DWR)
 Will Cores be taken? Yes No
 If Yes, proposed zone: _____

* WAS: SE-SE-SE 620' FSL, 530' FEL, Elev. 1870
 IS: NE-SE-SE 670' FSL, 430' FEL Elev. 1885

AFFIDAVIT

**RECEIVED
 KANSAS CORPORATION COMMISSION
 MAY 14 2007**

**CONSERVATION DIVISION
 WICHITA, KS**

The undersigned hereby affirms that the drilling, completion and eventual plugging of this well will comply with K.S.A. 35 et. seq.
 It is agreed that the following minimum requirements will be met:

1. Notify the appropriate district office **prior** to spudding of well;
2. A copy of the approved notice of intent to drill **shall be** posted on each drilling rig;
3. The minimum amount of surface pipe as specified below **shall be set** by circulating cement to the top; in all cases surface pipe shall be set through all unconsolidated materials plus a minimum of 20 feet into the underlying formation.
4. If the well is dry hole, an agreement between the operator and the district office on plug length and placement is necessary **prior to plugging**;
5. The appropriate district office will be notified before well is either plugged or production casing is cemented in;
6. If an ALTERNATE II COMPLETION, production pipe shall be cemented from below any usable water to surface within **120 days** of spud date. Or pursuant to Appendix "B" - Eastern Kansas surface casing order #133,891-C, which applies to the KCC District 3 area, alternate II cementing must be completed within 30 days of the spud date or the well shall be plugged. **In all cases, NOTIFY district office** prior to any cementing.

I hereby certify that the statements made herein are true and to the best of my knowledge and belief.
 Date: 5/10/07 Signature of Operator or Agent: Gary L. Brungardt Title: Owner

For KCC Use ONLY
 API # 15 - 141-20372-0000
 Conductor pipe required None feet
 Minimum surface pipe required 200 feet per Alt. **X(2)**
 Approved by: Per 5-14-07 / Mark 5-18-07
 This authorization expires: 11-14-07
(This authorization void if drilling not started within 6 months of approval date.)
 Spud date: _____ Agent: _____

Remember to:
 - File Drill Pit Application (form CDP-1) with Intent to Drill;
 - File Completion Form ACO-1 within 120 days of spud date;
 - File acreage attribution plat according to field proration orders;
 - Notify appropriate district office 48 hours prior to workover or re-entry;
 - Submit plugging report (CP-4) after plugging is completed;
 - Obtain written approval before disposing or injecting salt water.
 - If this permit has expired (See: authorized expiration date) please check the box below and return to the address below.
 Well Not Drilled - Permit Expired
 Signature of Operator or Agent: _____
 Date: _____

Mail to: KCC - Conservation Division, 130 S. Market - Room 2078, Wichita, Kansas 67202

MSW 14 10 15 W

IN ALL CASES PLOT THE INTENDED WELL ON THE PLAT BELOW

Plat of acreage attributable to a well in a prorated or spaced field

CORRECTED

If the intended well is in a prorated or spaced field, please fully complete this side of the form. If the intended well is in a prorated or spaced field complete the plat below showing that the well will be properly located in relationship to other wells producing from the common source of supply. Please show all the wells and within 1 mile of the boundaries of the proposed acreage attribution unit for gas wells and within 1/2 mile of the boundaries of the proposed acreage attribution unit for oil wells.

API No. 15 - _____
 Operator: _____
 Lease: _____
 Well Number: _____
 Field: _____
 Number of Acres attributable to well: _____
 QTR / QTR / QTR of acreage: _____

Location of Well: County: _____
 _____ feet from N / S Line of Section
 _____ feet from E / W Line of Section
 Sec. _____ Twp. _____ S. R. _____ East West

Is Section: Regular or Irregular

If Section is Irregular, locate well from nearest corner boundary.
 Section corner used: NE NW SE SW

PLAT

(Show location of the well and shade attributable acreage for prorated or spaced wells)
 (Show footage to the nearest lease or unit boundary line.)

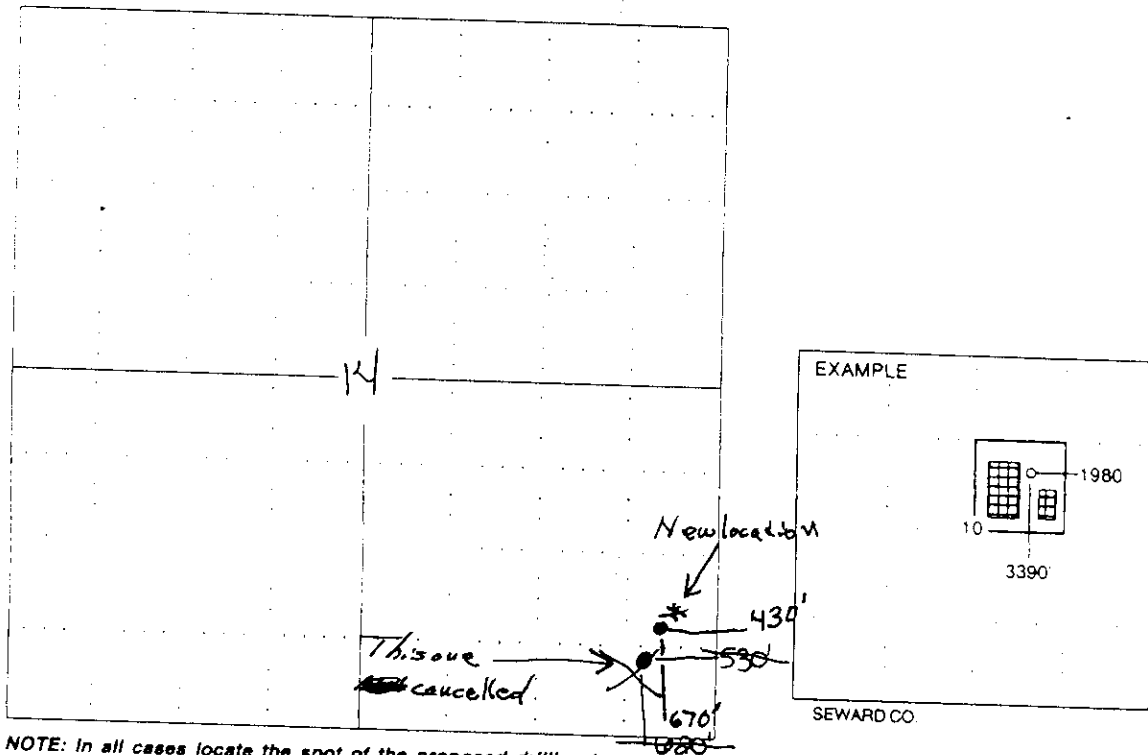

NOTE: In all cases locate the spot of the proposed drilling location.

In plotting the proposed location of the well, you must show:

1. The manner in which you are using the depicted plat by identifying section lines, i.e. 1 section, 1 section with 8 surrounding sections, 4 sections, etc.
2. The distance of the proposed drilling location from the section's south / north and east / west.
3. The distance to the nearest lease or unit boundary line.
4. If proposed location is located within a prorated or spaced field a certificate of acreage attribution plat must be attached: (CO-7 for oil wells, CG-8 for gas wells).