

15-163-00791-00-00

STATE OF KANSAS
STATE CORPORATION COMMISSION

Give All Information Completely
Make Required Affidavit
Mail or Deliver Report to:
Conservation Division
State Corporation Commission
212 North Market, Insurance Bldg.
Wichita, Kansas

WELL PLUGGING RECORD

ROOKS County, Sec. 28 Twp. 9S Rge. 19W (X) W (W)

Location as "NE/CNW/SW" or footage from lines NW SE NW

Lease Owner PETROLEUM, INC.

Lease Name MILLER "S" Well No. 1

Office Address ROUTE 2, GREAT BEND, KANSAS

Character of Well (completed as Oil, Gas or Dry Hole) DRY HOLE

Date well completed JUNE 30, 19 60

Application for plugging filed JUNE 30, 19 60

Application for plugging approved JUNE 30, 19 60

Plugging commenced JUNE 30, 19 60

Plugging completed JUNE 30, 19 60

Reason for abandonment of well or producing formation NO PRODUCING ZONES.

If a producing well is abandoned, date of last production NONE 19

Was permission obtained from the Conservation Division or its agents before plugging was commenced? YES

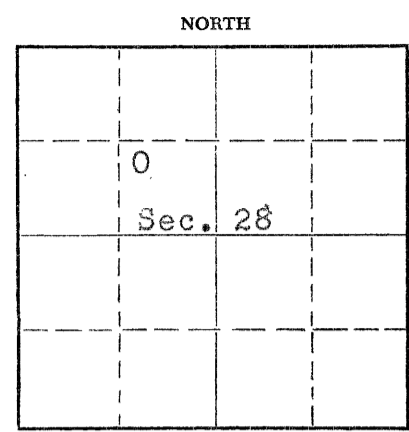

Locate well correctly on above Section Plat

Name of Conservation Agent who supervised plugging of this well ELDON PETTY

Producing formation --- Depth to top --- Bottom --- Total Depth of Well 3692 Feet

Show depth and thickness of all water, oil and gas formations.

OIL, GAS OR WATER RECORDS

CASING RECORD

FORMATION	CONTENT	FROM	TO	SIZE	PUT IN	PULLED OUT
				8-5/8"	254'	NONE

Describe in detail the manner in which the well was plugged, indicating where the mud fluid was placed and the method or methods used in introducing it into the hole. If cement or other plugs were used, state the character of same and depth placed, from feet to feet for each plug set.

MUDDERED UP WITH HEAVY MUD TO 500' FOLLOWED BY WOODEN PLUG. PLACED 20 SACKS CEMENT THROUGH DRILL PIPE ON TO PLUG. MUDDERED UP WITH HEAVY MUD TO 240', FOLLOWED BY WOODEN PLUG AND 1/4 SACK HULLS. PLACED 20 SACKS CEMENT THROUGH DRILL PIPE ON TO HULLS. MUDDERED UP WITH HEAVY MUD TO 35' FOLLOWED BY WOODEN PLUG, 1/4 SACK OF HULLS AND 10 SACKS CEMENT TO BASE OF WELL CELLAR.

RECEIVED
STATE CORPORATION COMMISSION
7/15/60
JUL 15 1960

CONSERVATION DIVISION
Wichita, Kansas

(If additional description is necessary, use BACK of this sheet)

Name of Plugging Contractor GARVEY DRILLING COMPANY
Address ROUTE 2, GREAT BEND, KANSAS

STATE OF KANSAS, COUNTY OF BARTON, ss.
DON SEARLE (employee of owner) or (owner or operator) of the above-described

well, being first duly sworn on oath, says: That I have knowledge of the facts, statements, and matters herein contained and the log of the above-described well as filed and that the same are true and correct. So help me God.

(Signature) Don Searle
ROUTE 2, GREAT BEND, KANSAS (Address)

SUBSCRIBED AND SWORN TO before me this 13TH day of JULY, 19 60

Arthur J. Nile
Notary Public.

My commission expires APRIL 14, 1963



WELL LOG 15-163-00791-00-00

COMPANY **PETROLEUM, INCORPORATED**
 FARM **MILLER "S" NO. 1**

SEC. **28 T. 9S R. 19W**
 LOC. **NW, SE, NW**

TOTAL DEPTH **3692'**

COUNTY **ROOKS CO., KANSAS**

COMM. **June 21, 1960** COMP. **June 30, 1960**

CONTRACTOR **GARVEY DRILLING COMPANY**

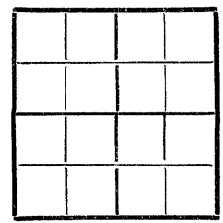

CASING **8 5/8" @ 254' w/150 sax.**

ELEVATION **2178' KB**

PRODUCTION **D & A**

FIGURES INDICATE BOTTOM OF FORMATIONS

40	Top soil & sand
254	Shale
600	Blue shale
1050	Shale & shells
1275	Sand
1395	Shale
1420	Anhydrite
1475	Shale & shells
1560	Shale
1600	Anhydrite
1790	Shale
2000	Shale & shells
3270	Lime & shale
3325	Lime
3400	Lime & shale
3538	Lime
3645	Lime & shale
3692	Chert & lime
3692	T. D.

RECEIVED
 STATE CORPORATION COMMISSION
 JUL 15 1960
 CONSERVATION DIVISION
 Wichita, Kansas

State of KANSAS }
 County of BARTON } ss.

I, VERNE A. MORRIS of GARVEY DRILLING COMPANY

upon oath state that the above and foregoing is a true and correct copy of the log of the #1 MILLER "S" well

Verne A. Morris.

Subscribed and sworn to before me this 11th day of July 1960

My Commission Expires: April 14, 1963

Arthur J. Mole
 NOTARY PUBLIC