

Give All Information Completely  
Make Required Affidavit  
Mail or Deliver Report to:  
Conservation Division  
State Corporation Commission  
211 No. Broadway  
Wichita, Kansas

WELL PLUGGING RECORD

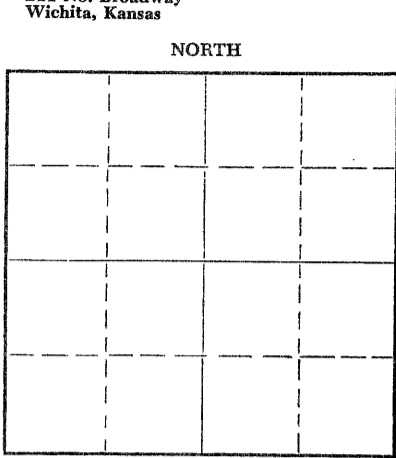

Locate well correctly on above  
Section Plat

Rooks County. Sec. 11 Twp. 9S Rge. (E) 20 (W)  
Location as "NE/CNW $\frac{1}{2}$ SW $\frac{1}{2}$ " or footage from lines SE SE NW  
Lease Owner Jones, Shelburne & Farmer, Inc.  
Lease Name BALDWIN B Well No. 1  
Office Address Russell, Kansas  
Character of Well (completed as Oil, Gas or Dry Hole) Dry  
Date well completed 10-26 19 56  
Application for plugging filed 10-26 19 56  
Application for plugging approved 10-26 19 56  
Plugging commenced 10-26 19 56  
Plugging completed 10-26 19 56  
Reason for abandonment of well or producing formation Dry

If a producing well is abandoned, date of last production \_\_\_\_\_ 19 \_\_\_\_  
Was permission obtained from the Conservation Division or its agents before plugging was commenced? Yes

Name of Conservation Agent who supervised plugging of this well Milton Galyardt  
Producing formation \_\_\_\_\_ Depth to top \_\_\_\_\_ Bottom \_\_\_\_\_ Total Depth of Well 3665 Feet  
Show depth and thickness of all water, oil and gas formations.

OIL, GAS OR WATER RECORDS

CASING RECORD

FORMATION	CONTENT	FROM	TO	SIZE	PUT IN	PULLED OUT
				8-5/8	159	None

Describe in detail the manner in which the well was plugged, indicating where the mud fluid was placed and the method or methods used in introducing it into the hole. If cement or other plugs were used, state the character of same and depth placed, from \_\_\_\_\_ feet to \_\_\_\_\_ feet for each plug set.

1. Filled hole with heavy mud
2. Pushed plug to 155
3. Dumped 1/2 sack hulls on top of plug
4. Mixed 15 sacks cement and dumped on top of hulls
5. Filled hole to top
6. Pushed plug to 40 feet
7. Dumped in 1/2 sack hulls
8. Mixed 10 sacks cement and filled hole to top with same.

(If additional description is necessary, use BACK of this sheet)

Name of Plugging Contractor Jones, Shelburne & Farmer, Inc.  
Address Russell, Kansas

STATE OF Kansas, COUNTY OF Russell, ss.  
JOHN O. FARMER (owner or operator) of the above-described

well, being first duly sworn on oath, says: That I have knowledge of the facts, statements, and matters herein contained and the log of the above-described well as filed and that the same are true and correct. So help me God.

(Signature) John O. Farmer  
Russell, Kansas  
(Address)

SUBSCRIBED AND SWORN TO before me this 29th day of October, 19 56

My commission expires 10-11-58

*Lucian E. Dry*  
Notary Public.

PLUGGING  
FILE SEC 11 T 9 R 20W  
BOOK PAGE 111 LINE 30

STATE CORPORATION COMMISSION  
12/4/56  
DEC 4 - 1956  
CONSERVATION DIVISION  
WICHITA, KANSAS

OPERATOR Jones, Shelburne & Farmer, Inc.

ADDRESS Russell, Kansas

FORMATION RECORD

Give detailed description and thickness of all formations drilled through, contents of sand, whether dry, water, oil or gas.

FARM NAME BALDWIN B WELL NO. 1 COUNTY BOOKS SEC. 11, TWP. 9, RGE. 20

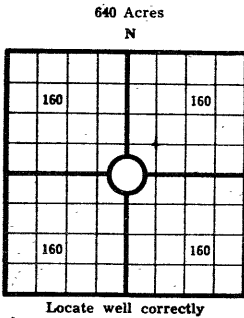

COUNTY Rooks SEC. 11 TWP. 9S RGE. 20W  
 COMPANY OPERATING Jones, Shelburne & Farmer, Inc.  
 OFFICE ADDRESS Russell, Kansas  
 FARM NAME BALDWIN B WELL NO. 1  
 DRILLING STARTED 10-16-56 DRILLING FINISHED 10-26-56  
 DATE OF FIRST PRODUCTION \_\_\_\_\_ COMPLETED \_\_\_\_\_  
 WELL LOCATED SE 1/4 SE 1/4 NW 1/4 North of South  
 Line and \_\_\_\_\_ ft. East of West Line of Quarter Section  
 Elevation (Relative to sea level) DERRICK FLOOR 2134 GROUND 2128  
 CHARACTER OF WELL (Oil, gas or dryhole) Oil

OIL OR GAS SANDS OR ZONES

Name	From	To	Name	From	To
1			4		
2			5		
3			6		

Perforating Record If Any

Shot Record

Formation	From	To	No. of Shots	Formation	From	To	Size of Shot

CASING RECORD

Amount Set								Amount Pulled		Packer Record	
Size	Wt.	Thds.	Make	Ft.	In.	Ft.	In.	Size	Length	Depth Set	Make
8-5/8				159							

Liner Record: Amount \_\_\_\_\_ Kind \_\_\_\_\_ Top \_\_\_\_\_ Bottom \_\_\_\_\_

CEMENTING AND MUDDING

Size	Amount Set		Sacks Cement	Chemical		Method of Cementing	Amount	Mudding Method	Results (See Note)
	Ft.	In.		Gal.	Make				
8-5/8			125						

Note: What method was used to protect sands if outer strings were pulled? \_\_\_\_\_

NOTE: Were bottom hole plugs used? \_\_\_\_\_ If so, state kind, depth set and results obtained \_\_\_\_\_

TOOLS USED

Rotary Tools were used from \_\_\_\_\_ feet to \_\_\_\_\_ Cable tools were used from \_\_\_\_\_ feet to \_\_\_\_\_ feet, and from \_\_\_\_\_ feet to \_\_\_\_\_ feet, and from \_\_\_\_\_ feet to \_\_\_\_\_

Type Rig \_\_\_\_\_

INITIAL PRODUCTION TEST

Describe initial test: whether by flow through tubing or casing or by pumping \_\_\_\_\_

Amount of Oil Production \_\_\_\_\_ bbls. Size of choke, if any \_\_\_\_\_ Length of test \_\_\_\_\_ Water

Production \_\_\_\_\_ bbls. Gravity of oil \_\_\_\_\_ Type of Pump if pump is used, describe \_\_\_\_\_

Formation	Top	Bottom	Formation	Top	Bottom
Surface	0	159			
Shale	159	625			
Shale & Redbed & sand	625	1100			
Dakota sand	1100	1250			
Sand	1250	1390			
Redbed	1390	1613			
Anhydrite	1613	1653			
Shale & shells	1653	1930			
Shale shells & lime	1930	2115			
Shale & lime	2115	2455			
Lime & shale	2455	2565			
Shale & lime	2565	2685			
Lime & shale	2685	3125			
Shale & shells	3125	3210			
Lime & shale	3210	3629			
Arbuckle	3629	3665			
T.D.		3665			

SAMPLE TOPS:

Elevation RB	2133
Anhydrite	1613
Heebner	3325
Toronto	3347
Lansing	3364
Conglomerate	3617
Arbuckle	3629
T.D.	3665
D & A	

PLUGGING  
 FILE SEC 11 T 9 R 20W  
 BOOK PAGE 11 LINE 20

I, the undersigned, being first duly sworn upon oath, state that this well record is true, correct and complete according to the records of this office and to the best of my knowledge and belief.

*W.D. Farmer*  
 Vice-Pres.  
 Name and title of representative of company

Subscribed and sworn to before me this 29th day of October, 19 56  
 My Commission expires 10-11-58  
*Lucien Kennedy*  
 Notary Public