

SKELLY OIL COMPANY

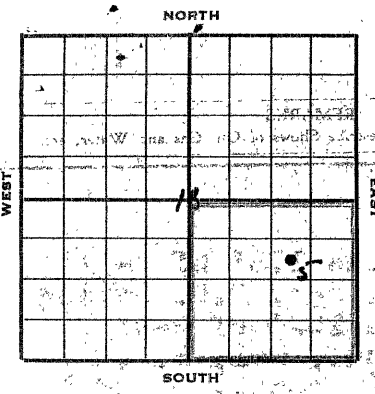

Well Record

Lease Name and No. **John Towns #35060** Well No. **5** Elev. **2240'**
 Lease Description **SE/4 of Section 14-92-20W, Neosho County, Kansas (160 Acres)**
 Location made **Feb. 20, 19 52** by **George Gear**
990 feet from North line **990** feet from East line **SE/4**
 feet from South line feet from West line of **200.10'**

Work com'd **2/27** 19 **52** Rig comp'd **3/2** 19 **52** Drlg. com'd **3/2** 19 **52** Drlg. comp'd **3/16** 19
 Rig Contractor **Claude Wentworth Drilling Company, Inc.**
 Drilling Contractor **Claude Wentworth Drilling Co., Inc., Tulsa, Oklahoma**
 Rotary Drilling from **0'** to **3910'** Cable Tool Drilling from to

Commenced Producing **DRY HOLE** 19 **52** Initial Prod. before shot or acid
 Initial Prod. after shot or acid
 Dry Gas Well Press. Volume
 Casing Head Gas Pressure Volume
 Braden Head (Size) Gas Pressure Volume
 Braden Head (Size) Gas Pressure Volume

PRODUCING FORMATION **DRY HOLE** (Name) Top Bottom TOTAL DEPTH **3910'**

CASING RECORD

OB Size	Wt.	Thds.	Where Set	PULLED OUT			LEFT IN			KIND	Cond'n	CEMENTING	
				Jts.	Feet	In.	Jts.	Feet	In.			Sacks Used	Method Employed
8-5/8"	24/PT						5	178	0	SI 20	C		
8-5/8"	26/PT		290'				5	104	0	SI LW	C	150	Halliburton
(8-5/8" casing set 6' in collar)													

Liner Set at Length Perforated at
 Liner Set at Length Perforated at
 Packer Set at Size and Kind
 Packer Set at Size and Kind

SHOT OR ACID TREATMENT RECORD

	FIRST	SECOND	THIRD	FOURTH
Date				
Acid Used				
Size Shot				
Shot Between	Ft. and Ft.	Ft. and Ft.	Ft. and Ft.	Ft. and Ft.
Size of Shell				
Put in by (Co.)				
Length anchor				
Distance below Cas'g				
Damage to Casing or Casing Shoulder				

SIGNIFICANT GEOLOGICAL FORMATIONS

NAME	Top	Bottom	GAS		OIL		REMARKS
			From	To	From	To	
Keokuk shale	3474'						
Lansing Linn	3513'						
Conglomerate	3785'						

CLEANING OUT RECORDS

	DATE COMMENCED	DATE COMPLETED	PROD. BEFORE	PROD. AFTER	REMARKS
1st					See Reverse for other details
2nd					" " " " "
3rd					" " " " "
4th					" " " " "

PLUGGING BACK AND DEEPENING RECORDS

	Date Commenced	Date Completed	No. Feet Plugged Back or Deepened	Prod. Before	Prod. After	REMARKS
1st						See Reverse for other details
2nd						" " " " "
3rd						" " " " "
4th						" " " " "

(See Reverse for Record of Formation)

RECORD OF FORMATIONS

FORMATION	TOP	BOTTOM	REMARKS
Surface soil, sand, and shale	0	60	
Shells and shale	60	300	Set and cemented 270' of 8-5/8" 80, 244, F.B., 2-5, 3-5 casing (C cond.); and 102' of 8-5/8" 80, 244, 4V thd., 2-1, 3-5 steel casing (C cond.) at 290' with 150 sacks of sulphate resisting cement and 5 sacks of aquagel. Cement circulated.
Shale	300	710	
Sand and shale	710	1010	
Shale and shells	1010	1785	
Schists	1785	1820	
Shale and shells	1820	1850	
Shale	1850	2180	
Shale and lime	2180	2315	
Lime	2315	2410	
Lime and shale	2410	2595	
Lime	2595	2680	
Lime and shale	2680	3355	
Lime	3355	3785	
Conglomerate	3785	3910	

TOP BRIDGE MAIN 1674'
TOP LARSON LINE 3511'
TOP STANWORTH 3785'

TOTAL DEPTH 3910'

Since no shows of oil or gas in commercial quantities were encountered in drilling to 3910', regular authority was granted to plug and abandon the well.

On March 18, the well was plugged as follows:

25 sacks of cement	1910' to 1920'
Mud laden fluid	1920' to 1970'
25 sacks of cement	1970' to 2020'
Mud laden fluid	2020' to 2070'
25 sacks of cement	2070' to 2120'
Surface soil	2120' to 2130'

Plugged and abandoned March 18, 1952.

PHOTO OF ACID TREATMENT RECORD

DATE	TIME	DEPTH	TEMP.	PH	REMARKS

INDICATE Casing Points, Describe Shows of Oil, Gas and Water, etc.

DATE	TIME	DEPTH	TEMP.	PH	REMARKS

PLUGGING
FILE SEC 11 T 9 R 20 W
BOOK PAGE 2 LINE 34

DATE COMPLETED	TIME COMPLETED	DEPTH COMPLETED	TEMP. COMPLETED	PH COMPLETED	REMARKS

PLUGGING BACK AND DEEPENING RECORDS

DATE COMPLETED	TIME COMPLETED	DEPTH COMPLETED	TEMP. COMPLETED	PH COMPLETED	REMARKS

(See Reverse for Record of Formation)