

KANSAS CORPORATION COMMISSION  
OIL & GAS CONSERVATION DIVISION

MAY 30 2007

Form C-1  
December 2002  
Form must be Typed  
Form must be Signed  
Blanks must be Filled  
Ft Scott

For KCC Use: 6-4-07  
Effective Date: \_\_\_\_\_  
District # 3  
SGA?  Yes  No

Must be approved by KCC five (5) days prior to commencing well

Expected Spud Date 6 6 2007  
month day year

Spot  East  
SW SE NW Sec. 36 Twp. 24 S. R. 23  
2310 feet from  N /  S Line of Section  
1650 feet from  E /  W Line of Section

OPERATOR: License# 33397  
Name: Running Foxes Petroleum, Inc.  
Address: 7060-B So. Tucson Way  
City/State/Zip: Centennial, CO 80112  
Contact Person: Carol Sears  
Phone: 303-350-1255

Is SECTION  Regular  Irregular?

(Note: Locate well on the Section Plat on reverse side)

CONTRACTOR: License# 5786  
Name: McGown

County: Bourbon  
Lease Name: Graham Well #: 6-36C  
Field Name: Wildcat

Is this a Prorated / Spaced Field?  Yes  No

Target Formation(s): Bartlesville Sandstone

Nearest Lease or unit boundary: 1650'

Ground Surface Elevation: 875 feet MSL

Water well within one-quarter mile:  Yes  No

Public water supply well within one mile:  Yes  No

Depth to bottom of fresh water: #100

Depth to bottom of usable water: 200 / 10

Surface Pipe by Alternate:  1  2

Length of Surface Pipe Planned to be set: 20 feet

Length of Conductor Pipe required: None

Projected Total Depth: 800'

Formation at Total Depth: Mississippian

Water Source for Drilling Operations:  Well  Farm Pond  Other

DWR Permit #: \_\_\_\_\_

(Note: Apply for Permit with DWR )

Will Cores be taken?  Yes  No

If Yes, proposed zone: \_\_\_\_\_

Well Drilled For: Well Class: Type Equipment:

- |  |                                   |   |  |
|--|-----------------------------------|---|--|
| <input checked="" type="checkbox"/> Oil      | <input type="checkbox"/> Enh Rec  | <input type="checkbox"/> Infield            | <input type="checkbox"/> Mud Rotary            |
| <input type="checkbox"/> Gas                 | <input type="checkbox"/> Storage  | <input type="checkbox"/> Pool Ext.          | <input checked="" type="checkbox"/> Air Rotary |
| <input type="checkbox"/> OWWO                | <input type="checkbox"/> Disposal | <input checked="" type="checkbox"/> Wildcat | <input type="checkbox"/> Cable                 |
| <input type="checkbox"/> Seismic; # of Holes | <input type="checkbox"/> Other    |   |  |
| <input type="checkbox"/> Other               |                                   |   |  |

If OWWO: old well information as follows:

Operator: \_\_\_\_\_

Well Name: \_\_\_\_\_

Original Completion Date: \_\_\_\_\_ Original Total Depth: \_\_\_\_\_

Directional, Deviated or Horizontal wellbore?  Yes  No

If Yes, true vertical depth: \_\_\_\_\_

Bottom Hole Location: \_\_\_\_\_

KCC DKT #: \_\_\_\_\_

AFFIDAVIT

The undersigned hereby affirms that the drilling, completion and eventual plugging of this well will comply with K.S.A. 55 et. seq.

It is agreed that the following minimum requirements will be met:

1. Notify the appropriate district office *prior* to spudding of well;
2. A copy of the approved notice of intent to drill *shall be* posted on each drilling rig;
3. The minimum amount of surface pipe as specified below *shall be set* by circulating cement to the top; in all cases surface pipe *shall be set* through all unconsolidated materials plus a minimum of 20 feet into the underlying formation.
4. If the well is dry hole, an agreement between the operator and the district office on plug length and placement is necessary *prior to plugging*;
5. The appropriate district office will be notified before well is either plugged or production casing is cemented in;
6. If an ALTERNATE II COMPLETION, production pipe shall be cemented from below any usable water to surface within **120 days** of spud date. Or pursuant to Appendix "B" - Eastern Kansas surface casing order #133,891-C, which applies to the KCC District 3 area, alternate II cementing must be completed within 30 days of the spud date or the well shall be plugged. **In all cases, NOTIFY district office** prior to any cementing.

I hereby certify that the statements made herein are true and to the best of my knowledge and belief.

Date: 5/25/07 Signature of Operator or Agent: Carol Sears Title: Land Administrator

Remember to:

- File Drill Pit Application (form GDP-1) with Intent to Drill;
- File Completion Form ACO-1 within 120 days of spud date;
- File acreage attribution plat according to field proration orders;
- Notify appropriate district office 48 hours prior to workover or re-entry;
- Submit plugging report (CP-4) after plugging is completed;
- Obtain written approval before disposing or injecting salt water.
- If this permit has expired (See: authorized expiration date) please check the box below and return to the address below.

Well Not Drilled - Permit Expired

Signature of Operator or Agent: \_\_\_\_\_

Date: \_\_\_\_\_

For KCC Use ONLY

API # 15 - 011-23267-0000

Conductor pipe required None feet

Minimum surface pipe required 20 feet per Alt. **X2**

Approved by: RHS 5-30-07

This authorization expires: 11-30-07

(This authorization void if drilling not started within 6 months of effective date.)

Spud date: \_\_\_\_\_ Agent: \_\_\_\_\_

316  
24  
23E1

**IN ALL CASES PLOT THE INTENDED WELL ON THE PLAT BELOW**

*Plat of acreage attributable to a well in a prorated or spaced field*

*If the intended well is in a prorated or spaced field, please fully complete this side of the form. If the intended well is in a prorated or spaced field complete the plat below showing that the well will be properly located in relationship to other wells producing from the common source of supply. Please show all the wells and within 1 mile of the boundaries of the proposed acreage attribution unit for gas wells and within 1/2 mile of the boundaries of the proposed acreage attribution unit for oil wells.*

API No. 15 - 011-23267-0000  
 Operator: Running Foxes Petroleum, Inc.  
 Lease: Graham  
 Well Number: 6-36C  
 Field: Wildcat  
 Number of Acres attributable to well: 10  
 QTR / QTR / QTR of acreage: SW - SE - NW

Location of Well: County: Bourbon  
2310 feet from  N /  S Line of Section  
1650 feet from  E /  W Line of Section  
 Sec. 36 Twp. 24 S. R. 23  East  West

Is Section:  Regular or  Irregular

If Section is Irregular, locate well from nearest corner boundary.  
 Section corner used:  NE  NW  SE  SW

**PLAT**

*(Show location of the well and shade attributable acreage for prorated or spaced wells.)*

*(Show footage to the nearest lease or unit boundary line.)*

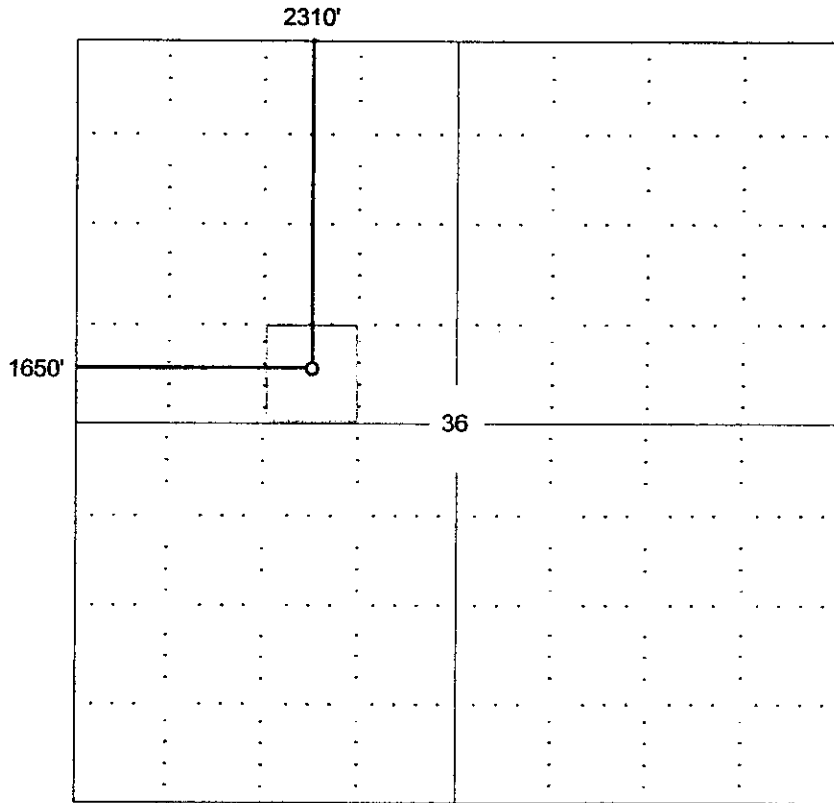

RECEIVED  
 KANSAS CORPORATION COMMISSION

MAY 30 2007

CONSERVATION DIVISION  
 WICHITA, KS

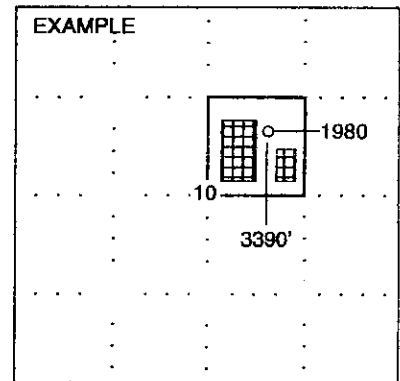

**NOTE: In all cases locate the spot of the proposed drilling location.**

**In plotting the proposed location of the well, you must show:**

1. The manner in which you are using the depicted plat by identifying section lines, i.e. 1 section, 1 section with 8 surrounding sections, 4 sections, etc.
2. The distance of the proposed drilling location from the section's south / north and east / west.
3. The distance to the nearest lease or unit boundary line.
4. If proposed location is located within a prorated or spaced field a certificate of acreage attribution plat must be attached: (C0-7 for oil wells; CG-8 for gas wells).

KANSAS CORPORATION COMMISSION  
OIL & GAS CONSERVATION DIVISION

MAY 30 2007

Form CDP-1

April 2004

Form must be Typed

Ft Scott

APPLICATION FOR SURFACE PIT

CONSERVATION DIVISION  
WICHITA, KS

Submit in Duplicate

Operator Name: <b>Running Foxes Petroleum, Inc.</b>		License Number: <b>33397</b>
Operator Address: <b>7060-B So. Tucson Way</b>		
Contact Person: <b>Carol Sears</b>		Phone Number: <b>(303) 617-7242</b>
Lease Name & Well No.: <b>Graham 6-36C</b>		Pit Location (QQQQ): <b>C SW SE NW</b>
Type of Pit: <input type="checkbox"/> Emergency Pit <input type="checkbox"/> Burn Pit <input type="checkbox"/> Settling Pit <input checked="" type="checkbox"/> Drilling Pit <input type="checkbox"/> Workover Pit <input type="checkbox"/> Haul-Off Pit <small>(If WP Supply API No. or Year Drilled)</small>	Pit is: <input checked="" type="checkbox"/> Proposed <input type="checkbox"/> Existing If Existing, date constructed: _____ Pit capacity: <b>150</b> (bbls)	Sec. <b>36</b> Twp. <b>24S</b> R. <b>23</b> <input checked="" type="checkbox"/> East <input type="checkbox"/> West <b>2310</b> Feet from <input checked="" type="checkbox"/> North / <input type="checkbox"/> South Line of Section <b>1650</b> Feet from <input type="checkbox"/> East / <input checked="" type="checkbox"/> West Line of Section <b>Bourbon</b> County
Is the pit located in a Sensitive Ground Water Area? <input type="checkbox"/> Yes <input checked="" type="checkbox"/> No		Chloride concentration: _____ mg/l <small>(For Emergency Pits and Settling Pits only)</small>
Is the bottom below ground level? <input type="checkbox"/> Yes <input checked="" type="checkbox"/> No	Artificial Liner? <input type="checkbox"/> Yes <input checked="" type="checkbox"/> No	How is the pit lined if a plastic liner is not used?
Pit dimensions (all but working pits): <b>20</b> Length (feet) <b>20</b> Width (feet) <b>N/A</b> <b>N/A: Steel Pits</b> Depth from ground level to deepest point: <b>5</b> (feet)		
If the pit is lined give a brief description of the liner material, thickness and installation procedure.		Describe procedures for periodic maintenance and determining liner integrity, including any special monitoring.
Distance to nearest water well within one-mile of pit <b>N/A</b> feet    Depth of water well _____ feet		Depth to shallowest fresh water <b>N/A</b> feet. Source of information: _____ measured    _____ well owner    _____ electric log    _____ KDWR
<b>Emergency, Settling and Burn Pits ONLY:</b> Producing Formation: _____ Number of producing wells on lease: _____ Barrels of fluid produced daily: _____ Does the slope from the tank battery allow all spilled fluids to flow into the pit? <input type="checkbox"/> Yes <input type="checkbox"/> No		<b>Drilling, Workover and Haul-Off Pits ONLY:</b> Type of material utilized in drilling/workover: <b>Fresh water &amp; Native Mud</b> Number of working pits to be utilized: <b>2</b> Abandonment procedure: <b>Evaporation and backfill</b> _____ Drill pits must be closed within 365 days of spud date.
I hereby certify that the above statements are true and correct to the best of my knowledge and belief.		
<b>5/25/07</b> Date		<b>Carol Sears</b> Signature of Applicant or Agent

15-011-23367-0000

<b>KCC OFFICE USE ONLY</b>			
Date Received: <b>5/30/07</b>	Permit Number: _____	Permit Date: <b>5/30/07</b>	Lease Inspection: <input type="checkbox"/> Yes <input checked="" type="checkbox"/> No