

For KCC Use:  
 Effective Date: 6-13-07  
 District # 4  
 SGA?  Yes  No

KANSAS CORPORATION COMMISSION  
 OIL & GAS CONSERVATION DIVISION

Form C-1  
 December 2002  
 Form must be Typed  
 Form must be Signed  
 All blanks must be Filled

NOTICE OF INTENT TO DRILL

Must be approved by KCC five (5) days prior to commencing well

Expected Spud Date 6-27-07  
 month day year

OPERATOR: License# 5259  
 Name: Mai Oil Operations, Inc.  
 Address: P.O. Box 33  
 City/State/Zip: Russell, Ks. 67665  
 Contact Person: Allen Bangert  
 Phone: 785-483-2169

CONTRACTOR: License# 33350  
 Name: Southwind Drilling, Inc.

<b>Well Drilled For:</b>	<b>Well Class:</b>	<b>Type Equipment:</b>
<input checked="" type="checkbox"/> Oil	<input type="checkbox"/> Enh Rec	<input checked="" type="checkbox"/> Mud Rotary
<input type="checkbox"/> Gas	<input type="checkbox"/> Storage	<input type="checkbox"/> Air Rotary
<input type="checkbox"/> OWWO	<input type="checkbox"/> Disposal	<input type="checkbox"/> Cable
<input type="checkbox"/> Seismic; # of Holes	<input checked="" type="checkbox"/> Wildcat	
<input type="checkbox"/> Other	<input type="checkbox"/> Other	

If OWWO: old well information as follows:  
 Operator: \_\_\_\_\_  
 Well Name: \_\_\_\_\_  
 Original Completion Date: \_\_\_\_\_ Original Total Depth: \_\_\_\_\_

Directional, Deviated or Horizontal wellbore?  Yes  No  
 If Yes, true vertical depth: \_\_\_\_\_  
 Bottom Hole Location: \_\_\_\_\_  
 KCC DKT #: \_\_\_\_\_

Spot  
 S/2 - SE - NE Sec. 4 Twp. 16 S. R. 14  
 East  
 West  
2780 feet from  N /  S Line of Section  
680 feet from  E /  W Line of Section

Is SECTION  Regular  Irregular?  
 (Note: Locate well on the Section Plat on reverse side)

County: Barton  
 Lease Name: Miller-Popp Unit Well #: 1  
 Field Name: Wildcat

Is this a Prorated / Spaced Field?  Yes  No

Target Formation(s): Arbuckle  
 Nearest Lease or unit boundary: 330'  
 Ground Surface Elevation: 1921 feet MSL

Water well within one-quarter mile:  Yes  No  
 Public water supply well within one mile:  Yes  No

Depth to bottom of fresh water: 220'  
 Depth to bottom of usable water: 380'

Surface Pipe by Alternate:  1  2

Length of Surface Pipe Planned to be set: 400'  
 Length of Conductor Pipe required: None

Projected Total Depth: 3450'  
 Formation at Total Depth: Arbuckle

Water Source for Drilling Operations:  
 Well  Farm Pond Other \_\_\_\_\_

DWR Permit #: \_\_\_\_\_  
 (Note: Apply for Permit with DWR )

Will Cores be taken?  Yes  No  
 If Yes, proposed zone: \_\_\_\_\_

*Oil & Gas Leases w/pooling clauses attached.*

AFFIDAVIT

RECEIVED  
 KANSAS CORPORATION COMMISSION

The undersigned hereby affirms that the drilling, completion and eventual plugging of this well will comply with K.S.A. 55 et. seq.  
 It is agreed that the following minimum requirements will be met:

JUN 08 2007

CONSERVATION DIVISION  
 WICHITA, KS

1. Notify the appropriate district office **prior** to spudding of well;
2. A copy of the approved notice of intent to drill **shall be** posted on each drilling rig;
3. The minimum amount of surface pipe as specified below **shall be set** by circulating cement to the top; in all cases surface pipe **shall be set** through all unconsolidated materials plus a **minimum of 20 feet** into the underlying formation.
4. If the well is dry hole, an agreement between the operator and the district office on plug length and placement is **necessary prior to plugging**;
5. The appropriate district office will be notified **before** well is either plugged or production casing is cemented in;
6. If an ALTERNATE II COMPLETION, production pipe shall be cemented from below any usable water to surface within **120 days** of spud date. Or pursuant to Appendix "B" - Eastern Kansas surface casing order #133,891-C, which applies to the KCC District 3 area, alternate II cementing must be completed within 30 days of the spud date or the well shall be plugged. **In all cases, NOTIFY district office** prior to any cementing.

I hereby certify that the statements made herein are true and to the best of my knowledge and belief.

Date: 5-30-07 Signature of Operator or Agent: Allen Bangert Title: Prod. Supt.

**For KCC Use ONLY**  
 API # 15 - 009-25065-0000  
 Conductor pipe required None feet  
 Minimum surface pipe required 400 feet per Alt. 1  
 Approved by: AW 6-8-07  
 This authorization expires: 12-8-07  
 (This authorization void if drilling not started within 6 months of approval date.)  
 Spud date: \_\_\_\_\_ Agent: \_\_\_\_\_

**Remember to:**

- File Drill Pit Application (form CDP-1) with Intent to Drill;
- File Completion Form ACO-1 within 120 days of spud date;
- File acreage attribution plat according to field proration orders;
- Notify appropriate district office 48 hours prior to workover or re-entry;
- Submit plugging report (CP-4) after plugging is completed;
- Obtain written approval before disposing or injecting salt water.

- If this permit has expired (See: authorized expiration date) please check the box below and return to the address below.  
 Well Not Drilled - Permit Expired  
 Signature of Operator or Agent: \_\_\_\_\_  
 Date: \_\_\_\_\_

Mail to: KCC - Conservation Division, 130 S. Market - Room 2078, Wichita, Kansas 67202

4  
16  
14W

**IN ALL CASES PLOT THE INTENDED WELL ON THE PLAT BELOW**

*Plat of acreage attributable to a well in a prorated or spaced field*

**If the intended well is in a prorated or spaced field, please fully complete this side of the form.** If the intended well is in a prorated or spaced field complete the plat below showing that the well will be properly located in relationship to other wells producing from the common source of supply. Please show all the wells and within 1 mile of the boundaries of the proposed acreage attribution unit for gas wells and within 1/2 mile of the boundaries of the proposed acreage attribution unit for oil wells.

API No. 15 - 009-25065-0000  
 Operator: Mai Oil Operations, Inc.  
 Lease: Miller-Popp Unit  
 Well Number: 1  
 Field: Wildcat

Number of Acres attributable to well: \_\_\_\_\_  
 QTR / QTR / QTR of acreage: S/2 - SE - NE

Location of Well: County: Barton  
 2780 \_\_\_\_\_ feet from  N /  S Line of Section  
 680 \_\_\_\_\_ feet from  E /  W Line of Section  
 Sec. 4 Twp. 16 S. R. 14  East  West

Is Section:  Regular or  Irregular

**If Section is Irregular, locate well from nearest corner boundary.**

Section corner used:  NE  NW  SE  SW

**PLAT**

*(Show location of the well and shade acreage for prorated or spaced wells.)*

*(Show footage to the nearest lease or unit boundary line.)*

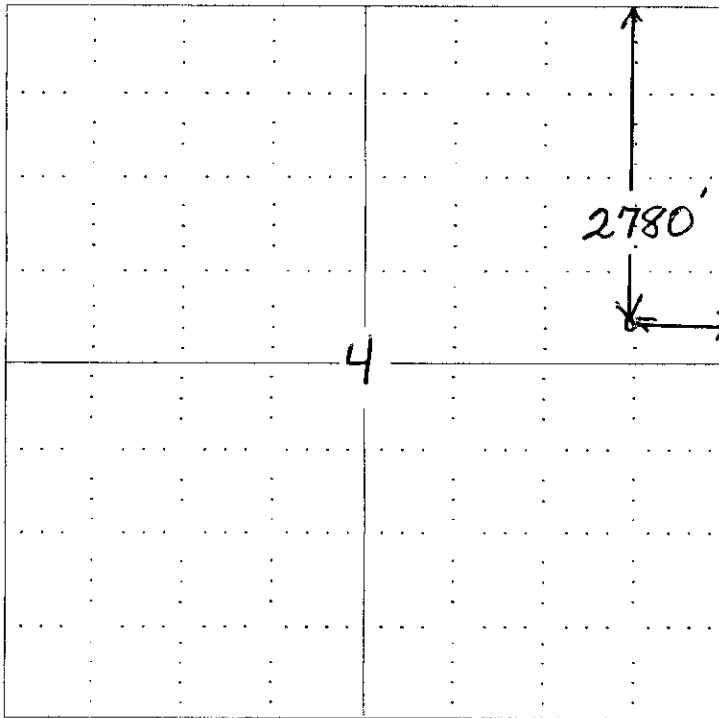

RECEIVED  
 KANSAS CORPORATION COMMISSION  
**JUN 08 2007**  
 CONSERVATION DIVISION  
 WICHITA, KS

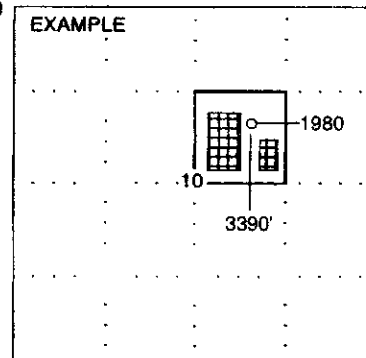

SEWARD CO.

**NOTE: In all cases locate the spot of the proposed drilling location.**

**In plotting the proposed location of the well, you must show:**

1. The manner in which you are using the depicted plat by identifying section lines, i.e. 1 section, 1 section with 8 surrounding sections, 4 sections, etc.
2. The distance of the proposed drilling location from the section's south / north and east / west.
3. The distance to the nearest lease or unit boundary line.
4. If proposed location is located within a prorated or spaced field a certificate of acreage attribution plat must be attached: (CO-7 for oil wells; CG-8 for gas wells).

MAI OIL OPERATIONS, INC.  
MILLER POPP UNIT LEASE  
IN NE. 1/4 & SE. 1/4, SECTION 4, T16S. R14W  
BARTON COUNTY, KANSAS

15-009-25065-0000

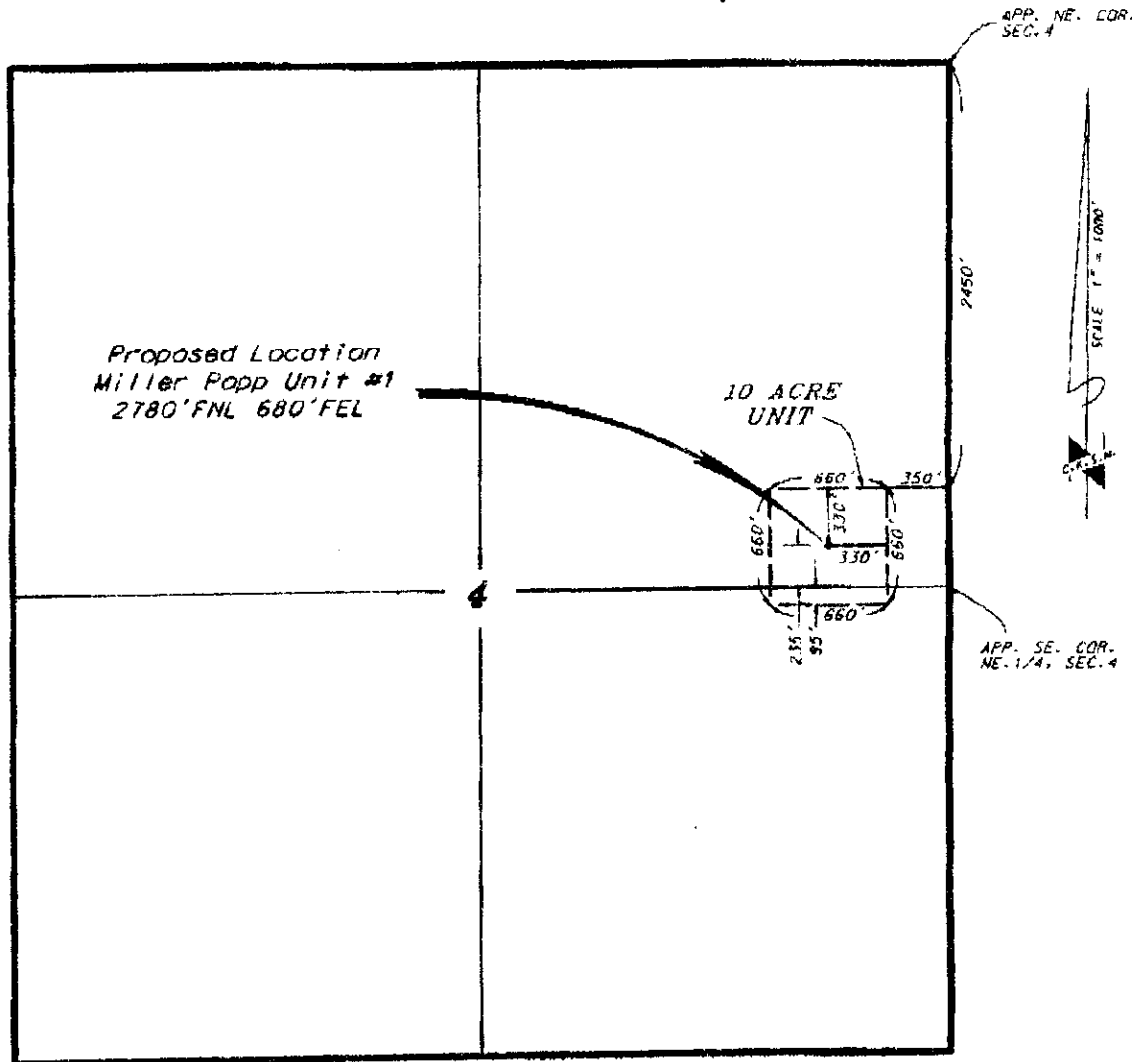

UNIT DESCRIPTION

That part of the Northeast Quarter and Southeast Quarter of Section 4, Township 16 South, Range 14 West of the 6th Principal Meridian, Barton County, Kansas, described as follows:

Commencing at the northeast corner of said Section 15; thence on an assumed bearing of South, along the east line of the Northeast Quarter of said section, a distance of 2450.00 feet; thence on a bearing of West a distance of 350.00 feet to the point of beginning of the unit to be described; thence continuing on a bearing of West a distance of 660.00 feet; thence on a bearing of South a distance of 660.00 feet; thence on a bearing of East a distance of 660.00 feet; thence on a bearing of North a distance of 660.00 feet to the point of beginning. The above described unit contains 10.0 acres.

RECEIVED  
KANSAS CORPORATION COMMISSION

JUN 08 2007

CONSERVATION DIVISION  
WICHITA, KS

June 1, 2007

Date

CENTRAL KANSAS OILFIELD SERVICES, INC. (620)792-1977

\* Controlling data is based upon the best maps and photographs available to us and upon a regular section of land containing 640 acres.

† Approximate section lines were determined using the normal standard of care of oilfield surveyors practicing in the State of Kansas. The section corners, which establish the precise section lines, were not necessarily located, and the exact location of the wellbore location in the section is not guaranteed. Therefore, the operator securing this service and employing this firm and all other parties relying thereon agree to hold Central Kansas Oilfield Services, Inc., its officers and employees harmless from all losses, costs and expenses and hold entities released from any liability from incidental or consequential damages.

‡ Elevations derived from National Geodetic Vertical Datum.

**KANSAS CORPORATION COMMISSION  
OIL & GAS CONSERVATION DIVISION  
APPLICATION FOR SURFACE PIT**

Form CDP-1  
April 2004  
Form must be Typed

*Submit in Duplicate*

Operator Name: <b>Mai Oil Operations, Inc.</b>		License Number: <b>5259</b>
Operator Address: <b>P.O. Box 33, Russell, Ks. 67665</b>		
Contact Person: <b>Allen Bangert</b>		Phone Number: ( <b>785</b> ) <b>483 - 2169</b>
Lease Name & Well No.: <b>Miller-Popp Unit #1</b>		Pit Location (QQQQ): <b>S/2 SE NE</b>
Type of Pit: <input type="checkbox"/> Emergency Pit <input type="checkbox"/> Burn Pit <input type="checkbox"/> Settling Pit <input checked="" type="checkbox"/> Drilling Pit <input type="checkbox"/> Workover Pit <input type="checkbox"/> Haul-Off Pit <small>(If WP Supply API No. or Year Drilled)</small>	Pit is: <input checked="" type="checkbox"/> Proposed <input type="checkbox"/> Existing If Existing, date constructed: _____ Pit capacity: <b>500</b> (bbls)	Sec. <b>3</b> Twp. <b>16</b> R. <b>14</b> <input type="checkbox"/> East <input checked="" type="checkbox"/> West <b>2780</b> Feet from <input checked="" type="checkbox"/> North / <input type="checkbox"/> South Line of Section <b>680</b> Feet from <input checked="" type="checkbox"/> East / <input type="checkbox"/> West Line of Section <b>Barton</b> County
Is the pit located in a Sensitive Ground Water Area? <input type="checkbox"/> Yes <input checked="" type="checkbox"/> No		Chloride concentration: _____ mg/l <small>(For Emergency Pits and Settling Pits only)</small>
Is the bottom below ground level? <input checked="" type="checkbox"/> Yes <input type="checkbox"/> No	Artificial Liner? <input checked="" type="checkbox"/> Yes <input type="checkbox"/> No	How is the pit lined if a plastic liner is not used? <b>Drilling Mud</b>
Pit dimensions (all but working pits): <b>75</b> Length (feet) <b>75</b> Width (feet)    _____ N/A: Steel Pits Depth from ground level to deepest point: <b>3</b> (feet)		
If the pit is lined give a brief description of the liner material, thickness and installation procedure.		Describe procedures for periodic maintenance and determining liner integrity, including any special monitoring.
		RECEIVED KANSAS CORPORATION COMMISSION <b>JUN 08 2007</b> CONSERVATION DIVISION WICHITA, KS
Distance to nearest water well within one-mile of pit <b>N/A</b> feet    Depth of water well _____ feet	Depth to shallowest fresh water _____ feet. Source of information: _____ measured    _____ well owner    _____ electric log    _____ KDWR	
<b>Emergency, Settling and Burn Pits ONLY:</b> Producing Formation: _____ Number of producing wells on lease: _____ Barrels of fluid produced daily: _____ Does the slope from the tank battery allow all spilled fluids to flow into the pit? <input type="checkbox"/> Yes <input type="checkbox"/> No	<b>Drilling, Workover and Haul-Off Pits ONLY:</b> Type of material utilized in drilling/workover: <b>Drilling Mud</b> Number of working pits to be utilized: <b>3</b> Abandonment procedure: <b>Let Dry and Backfill</b> _____ Drill pits must be closed within 365 days of spud date.	
I hereby certify that the above statements are true and correct to the best of my knowledge and belief.		
_____ 5-30-07 Date	_____ <i>Allen Bangert</i> Signature of Applicant or Agent	

15-009-25065-0002

<b>KCC OFFICE USE ONLY</b>			
Date Received: <b>6/8/07</b>	Permit Number: _____	Permit Date: <b>6/8/07</b>	Lease Inspection: <input type="checkbox"/> Yes <input checked="" type="checkbox"/> No

Mail to: KCC - Conservation Division, 130 S. Market - Room 2078, Wichita, Kansas 67202