

For KCC Use: 6-27-07
Effective Date: 6-27-07
District # 1
SGA? Yes No

KANSAS CORPORATION COMMISSION
OIL & GAS CONSERVATION DIVISION
NOTICE OF INTENT TO DRILL

Form C-1
December 2002
Form must be Typed
Form must be Signed
All blanks must be Filled

Must be approved by KCC five (5) days prior to commencing well

Expected Spud Date July 25 2007
month day year

OPERATOR: License# 6015 ✓
Name: Cambria Corporation
Address: P.O. Box 1065
City/State/Zip: Great Bend, Kansas 67530
Contact Person: Robert D. Dougherty
Phone: 620-793-9055

CONTRACTOR: License# 33610 ✓
Name: Fossil Drilling, Inc.

Well Drilled For:	Well Class:	Type Equipment:
<input checked="" type="checkbox"/> Oil ✓	<input type="checkbox"/> Enh Rec	<input checked="" type="checkbox"/> Infield ✓
<input checked="" type="checkbox"/> Gas	<input type="checkbox"/> Storage	<input type="checkbox"/> Pool Ext.
<input type="checkbox"/> OWWO	<input type="checkbox"/> Disposal	<input type="checkbox"/> Wildcat
<input type="checkbox"/> Seismic; # of Holes	<input type="checkbox"/> Other	<input type="checkbox"/> Cable
<input type="checkbox"/> Other		

If OWWO: old well information as follows:
Operator: _____
Well Name: _____
Original Completion Date: _____ Original Total Depth: _____

Directional, Deviated or Horizontal wellbore? Yes No
If Yes, true vertical depth: _____
Bottom Hole Location: _____
KCC DKT #: _____

Spot SW - NE - NW Sec. 32 Twp. 23 S. R. 15 East West
1200 feet from N / S Line of Section
1500 feet from E / W Line of Section
Is SECTION Regular Irregular?

(Note: Locate well on the Section Plat on reverse side)
County: Pawnee
Lease Name: Becker Trust Well #: 2
Field Name: Benson

Is this a Prorated / Spaced Field? Yes No
Target Formation(s): Lansing
Nearest Lease or unit boundary: 1200 feet

Ground Surface Elevation: Est 2035 Topo feet MSL
Water well within one-quarter mile: Yes No
Public water supply well within one mile: Yes No
Depth to bottom of fresh water: 120 feet
Depth to bottom of usable water: 280 feet

Surface Pipe by Alternate: 1 2
Length of Surface Pipe Planned to be set: 340 feet
Length of Conductor Pipe required: none
Projected Total Depth: 3950 feet
Formation at Total Depth: Pre-Cambrian

Water Source for Drilling Operations:
 Well Farm Pond Other _____
DWR Permit #: PNWW 3047
(Note: Apply for Permit with DWR)

Will Cores be taken? Yes No
If Yes, proposed zone: _____

AFFIDAVIT

The undersigned hereby affirms that the drilling, completion and eventual plugging of this well will comply with K.S.A. 55 et. seq.

It is agreed that the following minimum requirements will be met:

1. Notify the appropriate district office **prior** to spudding of well;
2. A copy of the approved notice of intent to drill **shall be** posted on each drilling rig;
3. The minimum amount of surface pipe as specified below **shall be set** by circulating cement to the top; in all cases surface pipe **shall be set** through all unconsolidated materials plus a minimum of 20 feet into the underlying formation.
4. If the well is dry hole, an agreement between the operator and the district office on plug length and placement is necessary **prior to plugging**;
5. The appropriate district office will be notified before well is either plugged or production casing is cemented in;
6. If an ALTERNATE II COMPLETION, production pipe shall be cemented from below any usable water to surface within **120 days** of spud date. Or pursuant to Appendix "B" - Eastern Kansas surface casing order #133,891-C, which applies to the KCC District 3 area, alternate II cementing must be completed within 30 days of the spud date or the well shall be plugged. **In all cases, NOTIFY district office** prior to any cementing.

I hereby certify that the statements made herein are true and to the best of my knowledge and belief.

Date: 6/18/07 Signature of Operator or Agent: Robert D. Dougherty Title: President

For KCC Use ONLY
API # 15 - 145-21558-0000
Conductor pipe required None feet
Minimum surface pipe required 300 feet per Alt 1
Approved by: RA-022-07
This authorization expires: 12-22-07
(This authorization void if drilling not started within 6 months of approval date.)
Spud date: _____ Agent: _____

Remember to:

- File Drill Pit Application (form CDP-1) with Intent to Drill;
- File Completion Form ACO-1 within 120 days of spud date;
- File acreage attribution plat according to field proration orders;
- Notify appropriate district office 48 hours prior to workover or re-entry;
- Submit plugging report (CP-4) after plugging is completed;
- Obtain written approval before disposing or injecting salt water.
- If this permit has expired (See: authorized expiration date) please check the box below and return to the address below.

Well Not Drilled - Permit Expired
Signature of Operator or Agent: _____
Date: _____

Mail to: KCC - Conservation Division, 130 S. Market - Room 2078, Wichita, Kansas 67202

32 23 15W

IN ALL CASES PLOT THE INTENDED WELL ON THE PLAT BELOW

Plat of acreage attributable to a well in a prorated or spaced field

If the intended well is in a prorated or spaced field, please fully complete this side of the form. If the intended well is in a prorated or spaced field complete the plat below showing that the well will be properly located in relationship to other wells producing from the common source of supply. Please show all the wells and within 1 mile of the boundaries of the proposed acreage attribution unit for gas wells and within 1/2 mile of the boundaries of the proposed acreage attribution unit for oil wells.

API No. 15 - 145-215580000
 Operator: Cambria Corporation
 Lease: Becker Trust
 Well Number: 2
 Field: Benson

Number of Acres attributable to well: _____
 QTR / QTR / QTR of acreage: _____ - _____ - _____

Location of Well: County: Pawnee
 _____ 1200 feet from N / S Line of Section
 _____ 1500 feet from E / W Line of Section
 Sec. 32 Twp. 23 S. R. 15 East West

Is Section: Regular or Irregular

If Section Is Irregular, locate well from nearest corner boundary.
 Section corner used: NE NW SE SW

PLAT

(Show location of the well and shade attributable acreage for prorated or spaced wells.)
(Show footage to the nearest lease or unit boundary line.)

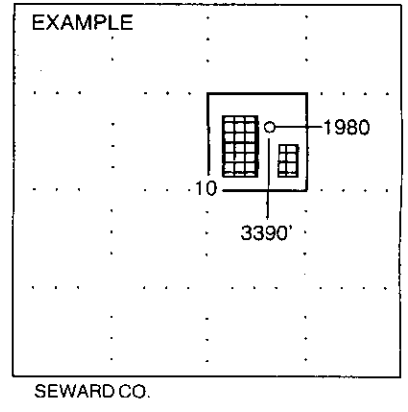
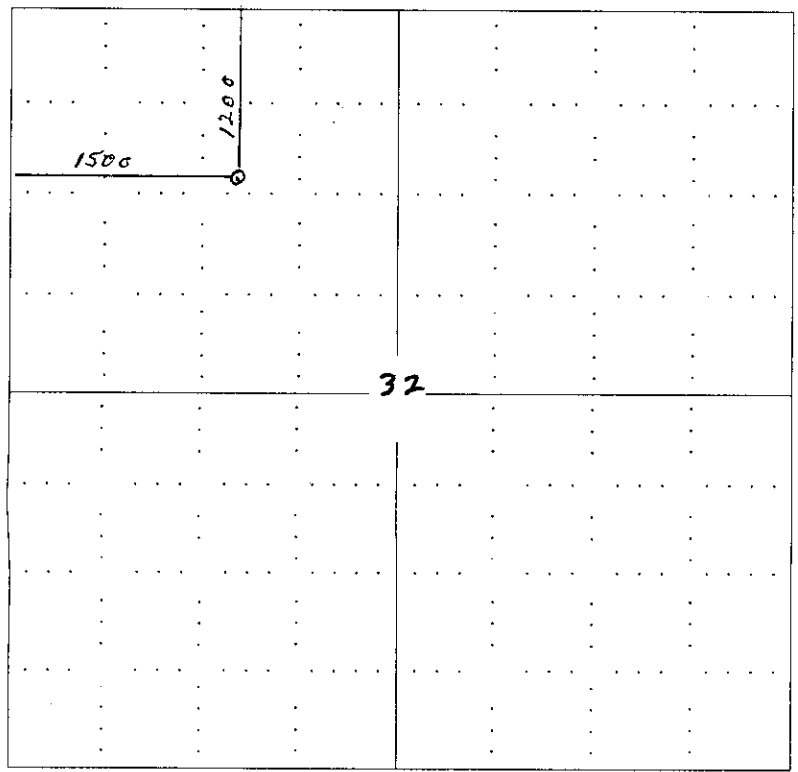

NOTE: In all cases locate the spot of the proposed drilling locaton.

In plotting the proposed location of the well, you must show:

1. The manner in which you are using the depicted plat by identifying section lines, i.e. 1 section, 1 section with 8 surrounding sections, 4 sections, etc.
2. The distance of the proposed drilling location from the section's south / north and east / west.
3. The distance to the nearest lease or unit boundary line.
4. If proposed location is located within a prorated or spaced field a certificate of acreage attribution plat must be attached: (CO-7 for oil wells; CG-8 for gas wells).

**KANSAS CORPORATION COMMISSION
OIL & GAS CONSERVATION DIVISION
APPLICATION FOR SURFACE PIT**

Form CDP-1
April 2004
Form must be Typed

Submit in Duplicate

Operator Name: Cambria Corporation		License Number: 6015
Operator Address: P.O. Box 1065 Great Bend, Kansas 67530		
Contact Person: Robert D. Dougherty		Phone Number: (620) 793 - 9055
Lease Name & Well No.: Becker Trust #2		Pit Location (QQQQ): SW SW ne NW
Type of Pit: <input type="checkbox"/> Emergency Pit <input type="checkbox"/> Burn Pit <input type="checkbox"/> Settling Pit <input checked="" type="checkbox"/> Drilling Pit <input type="checkbox"/> Workover Pit <input type="checkbox"/> Haul-Off Pit <small>(If WP Supply API No. or Year Drilled)</small>	Pit is: <input checked="" type="checkbox"/> Proposed <input type="checkbox"/> Existing If Existing, date constructed: _____ Pit capacity: 160 (bbls)	Sec. 32 Twp. 23 R. 15 <input type="checkbox"/> East <input checked="" type="checkbox"/> West 1200 Feet from <input checked="" type="checkbox"/> North / <input type="checkbox"/> South Line of Section 1500 Feet from <input type="checkbox"/> East / <input checked="" type="checkbox"/> West Line of Section Pawnee County
Is the pit located in a Sensitive Ground Water Area? <input checked="" type="checkbox"/> Yes <input type="checkbox"/> No		Chloride concentration: _____ mg/l <small>(For Emergency Pits and Settling Pits only)</small>
Is the bottom below ground level? <input checked="" type="checkbox"/> Yes <input type="checkbox"/> No	Artificial Liner? <input checked="" type="checkbox"/> Yes <input type="checkbox"/> No	How is the pit lined if a plastic liner is not used?
Pit dimensions (all but working pits): 100 Length (feet) 100 Width (feet) _____ N/A: Steel Pits Depth from ground level to deepest point: 5 (feet)		
If the pit is lined give a brief description of the liner material, thickness and installation procedure. 10 mil plastic		Describe procedures for periodic maintenance and determining liner integrity, including any special monitoring. daily
Distance to nearest water well within one-mile of pit 250 feet Depth of water well 73 feet		Depth to shallowest fresh water 50 feet. Source of information: <input checked="" type="checkbox"/> measured _____ well owner _____ electric log _____ KDWR
Emergency, Settling and Burn Pits ONLY: Producing Formation: _____ Number of producing wells on lease: _____ Barrels of fluid produced daily: _____ Does the slope from the tank battery allow all spilled fluids to flow into the pit? <input type="checkbox"/> Yes <input type="checkbox"/> No		Drilling, Workover and Haul-Off Pits ONLY: Type of material utilized in drilling/workover: Mud Number of working pits to be utilized: 3 Abandonment procedure: Fill in and close _____ Drill pits must be closed within 365 days of spud date.
I hereby certify that the above statements are true and correct to the best of my knowledge and belief.		
<u>6/18/2007</u> Date	<u>Robert D. Dougherty</u> Signature of Applicant or Agent	RECEIVED KANSAS CORPORATION COMMISSION JUN 20 2007 CONSERVATION DIVISION WICHITA, KS
KCC OFFICE USE ONLY		
Date Received: <u>6/20/07</u>	Permit Number: _____	Permit Date: _____ Lease Inspection: <input checked="" type="checkbox"/> Yes <input type="checkbox"/> No

15-145-21558-0000



*Kathleen Sebelius, Governor
Thomas E. Wright, Chairman
Robert E. Krehbiel, Commissioner
Michael C. Moffet, Commissioner*

June 22, 2007

Mr. Robert D. Dougherty
Cambria Corporation
PO Box 1065
Great Bend, KS 67530

RE: Drilling Pit Application
Becker Trust Lease Well No. 2
NW/4 Sec. 32-23S-15W
Pawnee County, Kansas

Dear Mr. Dougherty:

District staff has inspected the above referenced location and has determined that the reserve pit shall be constructed **without slots**, the bottom shall be flat and reasonably level and the free fluids must be removed. The fluids are to be removed from the reserve pit as soon as the Hutchinson Salt section has been drilled through and displacement of the fluids into the reserve pit has occurred. The fluids should be removed again as soon as practical after drilling operations have ceased.

If production casing is set all completion fluids shall be removed from the working pits daily. NO completion fluids or non-exempt wastes shall be placed in the reserve pit.

The fluids should be taken to an authorized disposal well. Please call the District Office at (620) 225-8888 when the fluids have been removed. Please file form CDP-5 (August 2004), Exploration and Production Waste Transfer, within 30 days of fluid removal. Conservation division forms are available through our office and on the KCC web site: www.kcc.state.ks.us/conservation/forms.

A copy of this letter should be posted in the doghouse along with the approved Intent to Drill.

If you have any questions or concerns please feel free to contact the undersigned at the above address.

Sincerely,

Kathy Haynes
Department of Environmental Protection and Remediation

cc: File