

For KCC Use: 6-27-2001
Effective Date: 4
District #: 4
SGA? Yes No

KANSAS CORPORATION COMMISSION
OIL & GAS CONSERVATION DIVISION

Form C-1
September 1999
Form must be Typed
Form must be Signed
All blanks must be Filled

NOTICE OF INTENT TO DRILL

Must be approved by KCC five (5) days prior to commencing well

Expected Spud Date 6-29-2001
month day year

OPERATOR: License# 9449
Name: GREAT EASTERN ENERGY & DEVELOPMENT
Address: BOX 150
City/State/Zip: BOGUE KANSAS 67625
Contact Person: MICHEAL A. DAVIGNON
Phone: 915-682-1178

CONTRACTOR: License# 30606
Name: MURFIN DRGLG INC.

Spot East
 C . NW . SW Sec. 19 Twp. 9 S. R. 20 West
1980 feet from N (circle one) Line of Section
600' feet from E / W (circle one) Line of Section
Is SECTION Regular Irregular?

(Note: Locate well on the Section Plat on reverse side)

County: ROOKS
Lease Name: COPELAND Well #: 1
Field Name: GRA-ROOK

Is this a Prorated / Spaced Field? Yes No
Target Information(s): ARBUCKLE

Nearest Lease or unit boundary: _____
Ground Surface Elevation: 2270EST feet MSL

Water well within one-quarter mile: Yes No
Public water supply well within one mile: Yes No

Depth to bottom of fresh water: 180
Depth to bottom of usable water: 980 B/DAKOTA

Surface Pipe by Alternate: 1 2
Length of Surface Pipe Planned to be set: 225'

Length of Conductor Pipe required: -0-
Projected Total Depth: 3820'

Producing Formation Target: ARBUCKLE
Water Source for Drilling Operations:

Well Farm Pond Other _____
DWR Permit #: _____

(Note: Apply for Permit with DWR)

Will Cores be taken? Yes No
If Yes, proposed zone: _____

Well Drilled For:	Well Class:	Type Equipment:
<input checked="" type="checkbox"/> Oil	<input type="checkbox"/> Enh Rec	<input checked="" type="checkbox"/> Infield
<input type="checkbox"/> Gas	<input type="checkbox"/> Storage	<input type="checkbox"/> Pool Ext.
<input type="checkbox"/> OWD	<input type="checkbox"/> Disposal	<input type="checkbox"/> Wildcat
<input type="checkbox"/> Seismic; _____ of Holes	<input type="checkbox"/> Other	<input type="checkbox"/> Cable
<input type="checkbox"/> Other: _____		

If OWWO: old well information as follows:
Operator: _____
Well Name: _____
Original Completion Date: _____ Original Total Depth: _____

Directional, Deviated or Horizontal wellbore? Yes No

If Yes, true vertical depth: _____

Bottom Hole Location: _____

KCC DKT #: _____

AFFIDAVIT

The undersigned hereby affirms that the drilling, completion and eventual plugging of this well will comply with K.S.A. 65-101, et. seq.

It is agreed that the following minimum requirements will be met:

1. Notify the appropriate district office prior to spudding of well;
2. A copy of the approved notice of intent to drill shall be posted on each drilling rig;
3. The minimum amount of surface pipe as specified below shall be set by circulating cement to the top; in all cases surface pipe shall be set through all unconsolidated materials plus a minimum of 20 feet into the underlying formation.
4. If the well is dry hole, an agreement between the operator and the district office on plug length and placement is necessary prior to plugging;
5. The appropriate district office will be notified before well is either plugged or production casing is cemented in;
6. If an ALTERNATE II COMPLETION, production pipe shall be cemented from below any usable water to surface within 120 days of spud date. In all cases, NOTIFY district office prior to any cementing.

I hereby certify that the statements made herein are true and to the best of my knowledge and belief.

Date: 6-19-01 Signature of Operator or Agent: Michael Davignon Title: Agent

For KCC Use ONLY
API # 15 - 163-23327-0000
Conductor pipe required NONE feet
Minimum surface pipe required 200 feet per Alt. (2)
Approved by: JK 6-22-2001
This authorization expires: 12-22-2001
(This authorization valid if drilling not started within 6 months of effective date.)
Spud date: _____ Agent: _____

Remember to:

- File Drill Pit Application (form CDP-1) with Intent to Drill;
- File Completion Form ACO-1 within 120 days of spud date;
- File acreage attribution plat according to field proration orders;
- Notify appropriate district office 48 hours prior to workover or re-entry;
- Submit plugging report (CP-4) after plugging is completed;
- Obtain written approval before disposing or injecting salt water.

19
9
20W

IN ALL CASES PLOT THE INTENDED WELL ON THE PLAT BELOW

Plat of acreage attributable to a well in a prorated or spaced field

If the intended well is in a prorated or spaced field, please fully complete this side of the form. If the intended well is in a prorated or spaced field complete the plat below showing that the well will be properly located in relationship to other wells producing from the common source of supply. Please show all the wells and within 1 mile of the boundaries of the proposed acreage attribution unit for gas wells and within 1/2 mile of the boundaries of the proposed acreage attribution unit for oil wells.

API No. 15 - _____ Location of Well: County: ROOKS

Operator: GREAT EASTERN ENERGY & DEVELOPMENT 1980 feet from S N (circle one) Line of Section

Lease: COPELAND 660 feet from E / W (circle one) Line of Section

Well Number: 1 Sec. 19 Twp. 9 S. R. 20 East West

Field: _____ Is Section X Regular or _____ Irregular

Number of Acres attributable to well: _____ If Section is Irregular, locate well from nearest corner boundary.

QTR / QTR / QTR of acreage: C - NW - SW Section corner used: NE NW SE SW

PLAT

*(Show location of the well and shade attributable acreage for prorated or spaced wells.)
(Show footage to the nearest lease or unit boundary line.)*

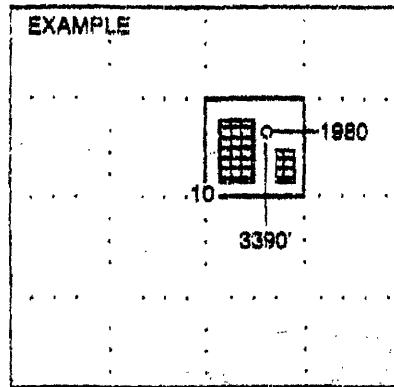
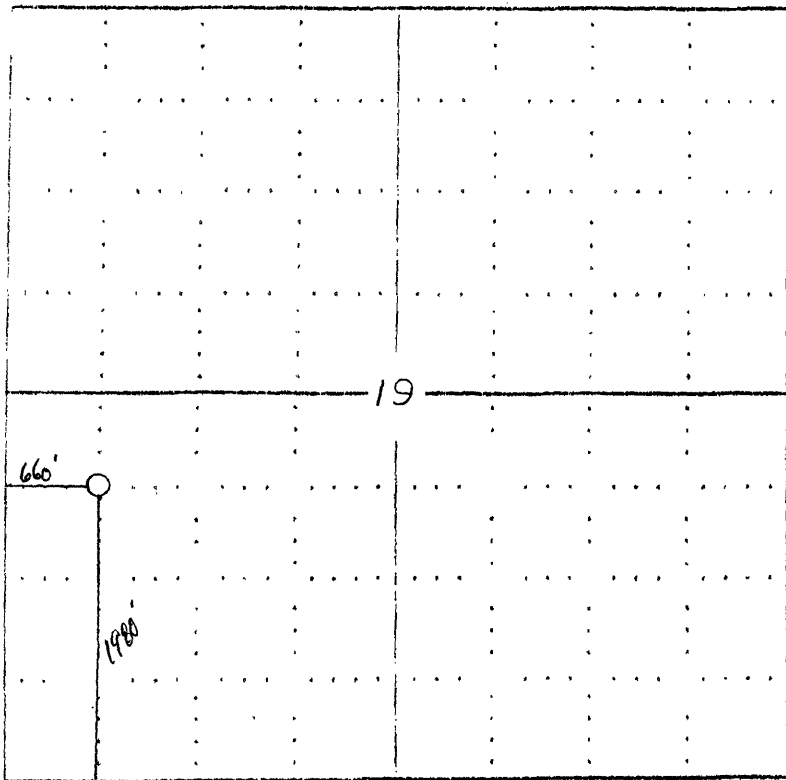

NOTE: In all cases locate the spot of the proposed drilling location.

In plotting the proposed location of the well, you must show:

1. The manner in which you are using the depicted plat by identifying section lines, i.e. 1 section, 1 section with 8 surrounding sections, 4 sections, etc.
2. The distance of the proposed drilling location from the section's south / north and east / west.
3. The distance to the nearest lease or unit boundary line.
4. If proposed location is located within a prorated or spaced field a certificate of acreage attribution plat must be attached: (CO-7 for oil wells, CG-8 for gas wells).

CO-7 WITH SECTION

APR 21 2001