

EFFECTIVE DATE: 6-30-91

FORM MUST BE TYPED

State of Kansas

FORM MUST BE SIGNED

FORM C-1 4/90

NOTICE OF INTENTION TO DRILL

ALL BLANKS MUST BE FILLED

Must be approved by the K.C.C. five (5) days prior to commencing well

Expected Spud Date: 06/30/91 CE NE 4 Sec 27 Twp 09 S Rg 20 WW East West

OPERATOR: License # 3456 3960 feet from South Line of Section 1320 feet from East Line of Section (Note: Locate well on Section Plat on Reverse Side)

Name: AFG ENERGY, INC.
Address: P.O. BOX 605
City/State/Zip: RUSSELL, KS 67665
Contact Person: TERRY W. PIESKER
Phone: 913-483-6213

County: ROOKS
Lease Name: RATHBUN Well# 11
Field Name: NORTH HAMPTON

CONTRACTOR: License # 8241
Name: EMPHASIS OIL OPERATIONS

Is this a Prorated Field? XX yes XX no
Target Formation(s): ARBUCKLE
Nearest lease or unit boundary: 1320
Ground Surface Elevation: EST 2265 feet MSL
Domestic well within 330 feet: XX yes XX no
Municipal well within one mile: XX yes XX no
Depth to bottom of fresh water: 90
Depth to bottom of usable water: 1125
Surface Pipe by Alternate: 1 XX
Length of Surface Pipe Planned to be set: 275
Length of Conductor Pipe required: 3920
Projected Total Depth: ARBUCKLE
Formation at Total Depth: ARBUCKLE
Water Source for Drilling Operations: XX well XX farm pond XX other

Well Drilled For: Well Class: Type Equipment:
XX Oil XX Inj XX Infield XX Mud Rotary
XX Gas XX Storage XX Pool Ext XX Air Rotary
XX OWWO XX Disposal XX Wildcat XX Cable
XX Seismic; XX # of Holes

If OWWO; old well information as follows:
Operator: XXXX
Well Name: XXXX
Comp Date: XXXX Old Total Depth: XXXX

Directional, Deviated or Horizontal Wellbore? XX yes XX no
If yes, total depth location: XXXX

DWR Permit# XXXX
Will Cores Be Taken? XX yes XX no
If yes, proposed zone: XXXX

AFFIDAVIT

The undersigned hereby affirms that the drilling, completion and eventual plugging of this well will comply with K.S.A. 55-101, et. seq.

- It is agreed that the following minimum requirements will be met:
1. The appropriate district office shall be notified before setting surface pipe;
 2. The minimum amount of surface pipe as specified above shall be set by circulating cement to the top; in all cases surface pipe shall be set through all unconsolidated materials plus a minimum of 20 feet into the underlying formation;
 3. If the well is dry, a plugging proposal shall be submitted to the district office. An agreement between the operator and the district office on plug length and placement is necessary prior to plugging;
 4. The appropriate district office will be notified before well is either plugged or production casing is cemented in;
 5. If an Alternate II completion, production pipe shall be cemented from below any usable water to surface within 120 days of spud date. In all cases, notify district office prior to any cementing.

I hereby certify that the statements made herein are true and to the best of my knowledge and belief.
Date: 06/25/91 Signature of Operator or Agent: B. Krueger Title: AS AGENT

101

FOR KCC USE:
API # 15- 163-23173-00-00
Conductor Pipe required NONE feet
Minimum surface pipe required 250 feet per Alt. X ②
Approved by: DA 6-25-91
EFFECTIVE DATE: 6-30-91
This authorization expires: 12-25-91
(This authorization void if drilling not started within 6 months of effective date.)
Spud date: _____ Agent: _____

STATE OF KANSAS
CONSERVATION DIVISION
Wichita, Kansas
APPROVED
6/25/91
JUN 25 1991
27 9 20

REMEMBER TO:

- File Drill Pit Application (form CDP-1) with Intent to Drill;
- File Completion Form ACO-1 within 120 days of spud date;
- File acreage attribution plat according to field proration orders;
- Notify appropriate district office 48 hours prior to workover or re-entry;
- Submit plugging report (CP-4) after plugging is completed;
- Obtain written approval before disposing or injecting salt water.

PLAT OF ACREAGE ATTRIBUTABLE TO A WELL

State Corporation Commission, Conservation Division
200 Colorado Derby Bldg. Wichita, Kansas 67202

OPERATOR AFG ENERGY, INC. LOCATION OF WELL:
 LEASE RATHBUN 3960 feet north of SE corner
 WELL NUMBER 11 1320 feet west of SE corner
 FIELD NORTH HAMPTON 4 Sec. 27 T 09 R 20 WW
 COUNTY ROOKS
 NO. OF ACRES ATTRIBUTABLE TO WELL _____ IS SECTION REGULAR IRREGULAR?
 DESCRIPTION OF ACREAGE _____ IF IRREGULAR, LOCATE WELL FROM NEAREST
 CORNER BOUNDARY.

NOTE: If plat depicted is insufficient for your circumstances, you may attach your own scaled or surveyed plat.

PLAT

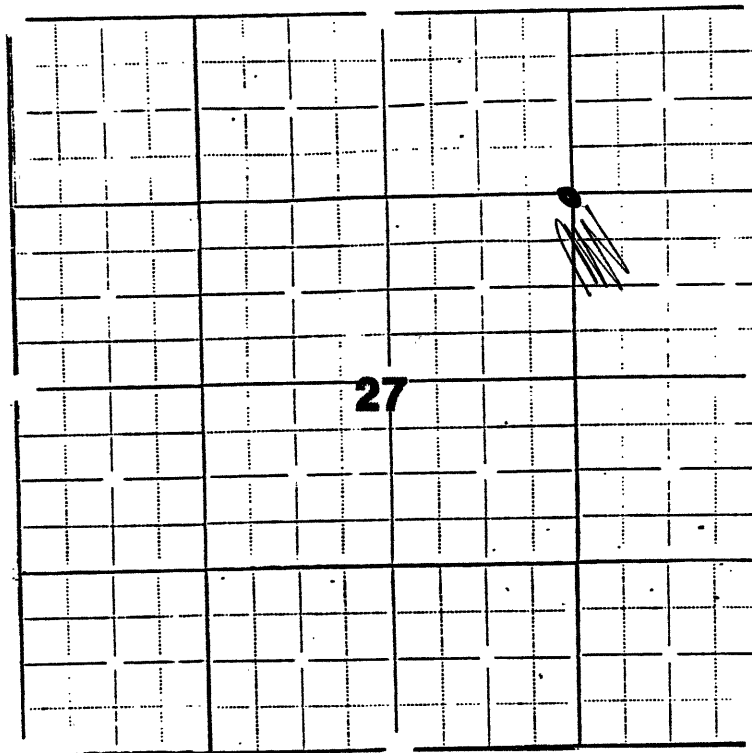

In plotting the proposed location of the well, you must show:

- 1) The manner in which you are using the depicted plat by identifying section lines, i.e. 1 section, 1 section with 8 surrounding partial sections, 4 sections, 16 sections, etc.;
- 2) the well's location relative to the location of other wells producing from the same common source of supply in adjoining drilling units, pursuant to K.A.R. 82-3-108, 82-3-207, 82-3-312, or special orders of the Commission;
- 3) the distance of the proposed drilling location from the section's east and south lines; and
- 4) the distance to the nearest lease or unit boundary line.

I hereby certify that the statements made herein are true and to the best of my knowledge and belief.

Signature of Operator or Agent B. Krause
 Date 08/25/91 Title Search, Inc. AS AGENT
 316-256-5415