

FOR KCC USE:

Old API #15-163-00 038

OWWO

FORM C-1 7/91

FORM MUST BE TYPED

FORM MUST BE SIGNED

ALL BLANKS MUST BE FILLED

EFFECTIVE DATE: 2-4-2001

DISTRICT # 4

SGA? Yes No

State of Kansas

NOTICE OF INTENTION TO DRILL

Must be approved by the K.C.C. five (5) days prior to commencing well.

Expected Spud Date February 18, 2001

Spot NE NE NW Sec 29 Twp 9 S, Rg 20 East West

OPERATOR: License # 5399 American Energies Corporation
Address: 155 North Market, Suite 710
City/State/Zip: Wichita, Kansas 67202

330 feet from South North line of Section
2310 feet from East West line of Section
IS SECTION X REGULAR IRREGULAR?

CONTRACTOR: License #: 06454 Cheyenne Well Service

(NOTE: Locate well on the Section Plat on Reverse Side)
County: Rooks
Lease Name: Graham Well #: A #2
Field Name: Kern West

Well Drilled For: Well Class: Type Equipment:
Oil Enh Rec Infield Mud Rotary
Gas Storage Pool Ext Air Rotary
OWWO Disposal Wildcat Cable
Seismic; # of Holes Other Service Rig

Is this a Prorated/Spaced Field? yes X no
Target Formation(s): Cedar Hills
Nearest lease or unit boundary: 330

If OWWO: old well information as follows:
Operator: Continental Oil
Well Name: Graham 1
Comp. Date: 7/16/46 Old Total Depth 3956

Ground Surface Elevation: 2267 feet MSL
Water well within one-quarter mile: yes X no
Public water supply well within one mile: yes X no

Directional, Deviated or Horizontal wellbore? yes X
If yes, true vertical depth:
Bottom Hole Location:

Depth to bottom of fresh water: 180
Depth to bottom of usable water: 700
Surface Pipe by Alternate: 1 X 2
Length of Surface Pipe Planned to be set: 200 240 SET
Length of Conductor pipe required: N/A (10 3/4")
Projected Total Depth: 1800'

Formation at Total Depth: Stone Corral
Water Source for Drilling Operations:
well farm pond Other

Will Cores Be Taken? yes X no
If yes, proposed zone:

AFFIDAVIT

The undersigned hereby affirms that the drilling, completion and eventual plugging of this well will comply with K.S.A. 55-101, et. seq.
It is agreed that the following minimum requirements will be met:

- 1. Notify the appropriate district office prior to spudding of well;
2. A copy of the approved notice of intent to drill shall be posted on each drilling rig;
3. The minimum amount of surface pipe as specified below shall be set by circulating cement to the top; in all cases surface pipe shall be set through all unconsolidated materials plus a minimum of 20 feet into the underlying formation;
4. If the well is dry hole, an agreement between the operator and the district office on plug length and placement is necessary prior to plugging;
5. The appropriate district office will be notified before well is either plugged or production casing is cemented in;
6. IF AN ALTERNATE II COMPLETION, PRODUCTION PIPE SHALL BE CEMENTED FROM BELOW ANY USABLE WATER TO SURFACE WITHIN 120 DAYS OF SPUD DATE. IN ALL CASES, NOTIFY DISTRICT OFFICE PRIOR TO ANY CEMENTING.

I hereby certify that the statements made herein are true and to the best of my knowledge and belief.

Date: 1/25/01 Signature of Operator or Agent: Alan L. DeGood Title: President

FOR KCC USE: 163-00038-00-01
Conductor pipe required NONE feet
Minimum surface pipe required 240 feet per Alt. X(2)
Approved by: JK 1-30-2001
This authorization expires: 7-30-2001
(This authorization void if drilling not started within 6 months of effective date.)
Spud date: Agent:

RECEIVED KANSAS CORPORATION COMMISSION

JAN 26 2001

CONSERVATION DIVISION WICHITA, KS

REMEMBER TO:

- File Drill Pit Application (form CDP-1) with Intent to Drill;
- File Completion Form ACO-1 within 120 days of spud date;
- File acreage attribution plat according to field proration orders;
- Notify appropriate district office 48 hours prior to workover or re-entry;
- Submit plugging report (CP-4) after plugging is completed;
- Obtain written approval before disposing or injecting salt water.

Mail to: KCC - Conservation Division, 130 S. Market - Room 2078, Wichita, Kansas 67202.

Handwritten initials and marks on the right margin.

IN ALL CASES PLOT THE INTENDED WELL ON THE PLAT BELOW

PLAT OF ACREAGE ATTRIBUTABLE TO A WELL IN A PRORATED OR SPACED FIELD

If the intended well is in a prorated or spaced field, please fully complete this side of the form. If the intended well is in a prorated or spaced field complete the plat below showing that the well will be properly located in relationship to other wells producing from the common source of supply. Please show all the wells within 1 mile of the boundaries of the proposed acreage attribution unit for gas wells and within 1/2 mile of the boundaries of the proposed acreage attribution unit for oil wells.

API NO. 15- 163-00 038 (old number)
 OPERATOR American Energies Corporation LOCATION OF WELL: COUNTY Rooks
 LEASE Graham 330 feet from south/north line of section
 WELL NUMBER A #2 2310 feet from east/west line of section
 FIELD Kern West SECTION 29 TWP 9S RG 20W

NUMBER OF ACRES ATTRIBUTABLE TO WELL _____ IS SECTION X REGULAR OR _____ IRREGULAR
 QTR/QTR/QTR OF ACREAGE _____ IF SECTION IS IRREGULAR, LOCATE WELL FROM NEAREST CORNER BOUNDARY.

Section corner used: NE X NW SE SW

PLAT

(Show location of the well and shade attributable acreage for prorated or spaced wells.)
 (Show footage to the nearest lease or unit boundary line.)

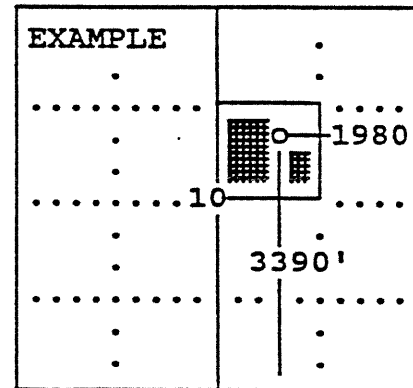
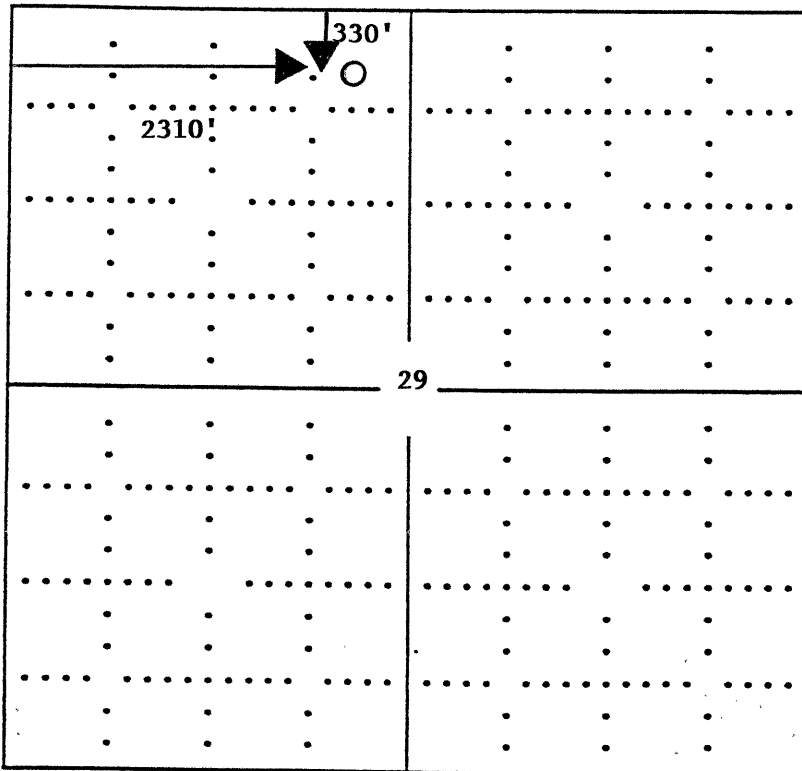

SEWARD CO.

In plotting the proposed location of the well, you must show:

- 1) The manner in which you are using the depicted plat by identifying section lines, i.e. 1 section, 1 section with 8 surrounding sections, 4 sections, etc.;
- 2) the distance of the proposed drilling location from the section's south/north and east/west; and
- 3) the distance to the nearest lease or unit boundary line.

NEW WELL COMPLETION AND/OR ABANDONMENT RECORD

A.F.E. No. 3908

1 Dist. West Kansas Field Palco Area Lease Lena Graham Well No. 1
 2 Co. Reeks State Kansas Contractor Lohmann-Johnson Drlg Co. T.D. 3958' P.D. ft
 3 Landing Flange Elev. DF 2272 ft. Depth Measured From D.F. Height of Measuring Point from Landing Flange 3 ft
 4 Date: Spudded 7-16-46 Drilling Completed 7-29-46 Plugged 7-30-46 Rig Released 7-30-46

CASING, LINER AND TUBING RECORD

SIZE O. D. IN.	WT. LB./FT.	THREADS NO. & TYPE	GRADE AND MAKE	NEW OR S. H.	E. L. L. W. SMLS.	DEPTH SET FT.	MEASUREMENTS INC. THREADS			TOP OF LINER	NO. OF JOINTS	HOLE SIZE
							QUANTITY SET	QUANTITY PULLED	QUANTITY LEFT IN HOLE			
10 3/4	29	S.E. 3ga	Armco	New	SW	243	240'	none	240'		6	13 3/4

CEMENTING RECORD

METHOD	MAKE AND TYPE CEMENT	SACKS USED	SQUEEZED AWAY	NO. OF BATCHES	FINAL PRESSURE	SLURRY WT. LB./GAL.	HOURS SET	DEPTH		REMARKS: TEMP. CALIPER, OTHER LOGS.
								FROM	TO	
Halli-burton	Portland	240		1		15	40	0'	243'	Surface Casing

ACIDIZATION AND SHOT RECORD

DATE	PRODUCTION OR P. I.		HOW TEST MADE	GAL. ACID	SHOT QTS.	DEPTH		NAME OF ZONE	TYPE FORMATION	REMARKS
	BEFORE	AFTER				FROM	TO			
None										

SECTION PERFORATED

NAME OF PAY	DEPTH		SIZE OF HOLE	HOLES PER FOOT	DATE	SERVICE CO. OR TYPE SLOTS	REMARKS
	FROM	TO					
None							

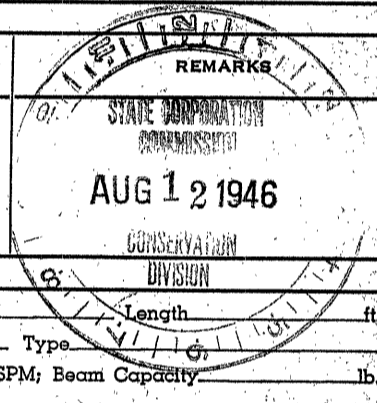

PRODUCING EQUIPMENT

29 RODS: Number None Size _____ in., Number _____ Size _____ in., Total Singles _____ Length _____ ft.
 30 PUMP: Size None Plunger Diam. _____ Make _____ Type _____
 31 PUMPING UNIT: Make None Type _____ Stroke _____ in. @ _____ SPM; Beam Capacity _____ lb.
 32 Torque @ 20 SPM _____ in. lbs.; Gear Box _____ H.P., Prime Mover Make _____
 33 H.P. @ _____ RPM. Other Remarks _____
 34 GAS ANCHOR None
 35 OTHER LIFT EQUIPMENT None
 36 _____
 37 PACKER: Set at None ft. Make _____

PRODUCING STRATA

NAME	TOP	BASE	POROSITY %	PERM. md.	NET THICKNESS ft.	REMARKS: STATE CONTENTS OF ALL PRODUCING STRATA, O. G & W.. GIVING FLUID CONTACTS, D. S. T., ETC.
Arbuckle	3907'	3958'			51	No show of oil.

REMARKS: Drilled to a total depth of 3958' in Arbuckle lime; ran Schlumberger survey, no show of oil; filled hole with heavy mud to within 200' of the top where a wood plug was set and cemented with 20 sacks of cement; hole was then filled with heavy mud to within 40' of the top where a second wood plug was set and capped with 10 sacks of cement; plugged and abandoned 7-30-46.

Material left in hole cleared on Material Transfer No. F30482

PLUGGING
 FILE SEC 29 T 9 R 200
 BOOK PAGE 66 LINE 24

56 Estimate Total Cost \$ 20,826.00 Conoco Interest 100 % Operated by Continental Oil Company
 57 Potential Dry Hole b/d Mcf/d _____ @ _____ % TP and % CP on _____ Hr. Test Meas. Est. Allowable _____ b/d
 58 Other Production or Well Test Results _____

59 _____
 60 Signed R. P. Dunn District Superintendent
 61 Signed _____ Division Superintendent
 62 Signed _____ Region Manager
 63 Signed W. E. Goering District Engineer
 64 Prepared by W. E. Goering Date 8-7-46

DISTRIBUTED TO
 Mgr. P. & D. WCM Acct'g. EHL
 Region LPC District FLD
 Others LEP
 State Corp. Comm.
 Gulf Oil Co. (2)
 Barnsdall Oil Co. (2)